

Part 1

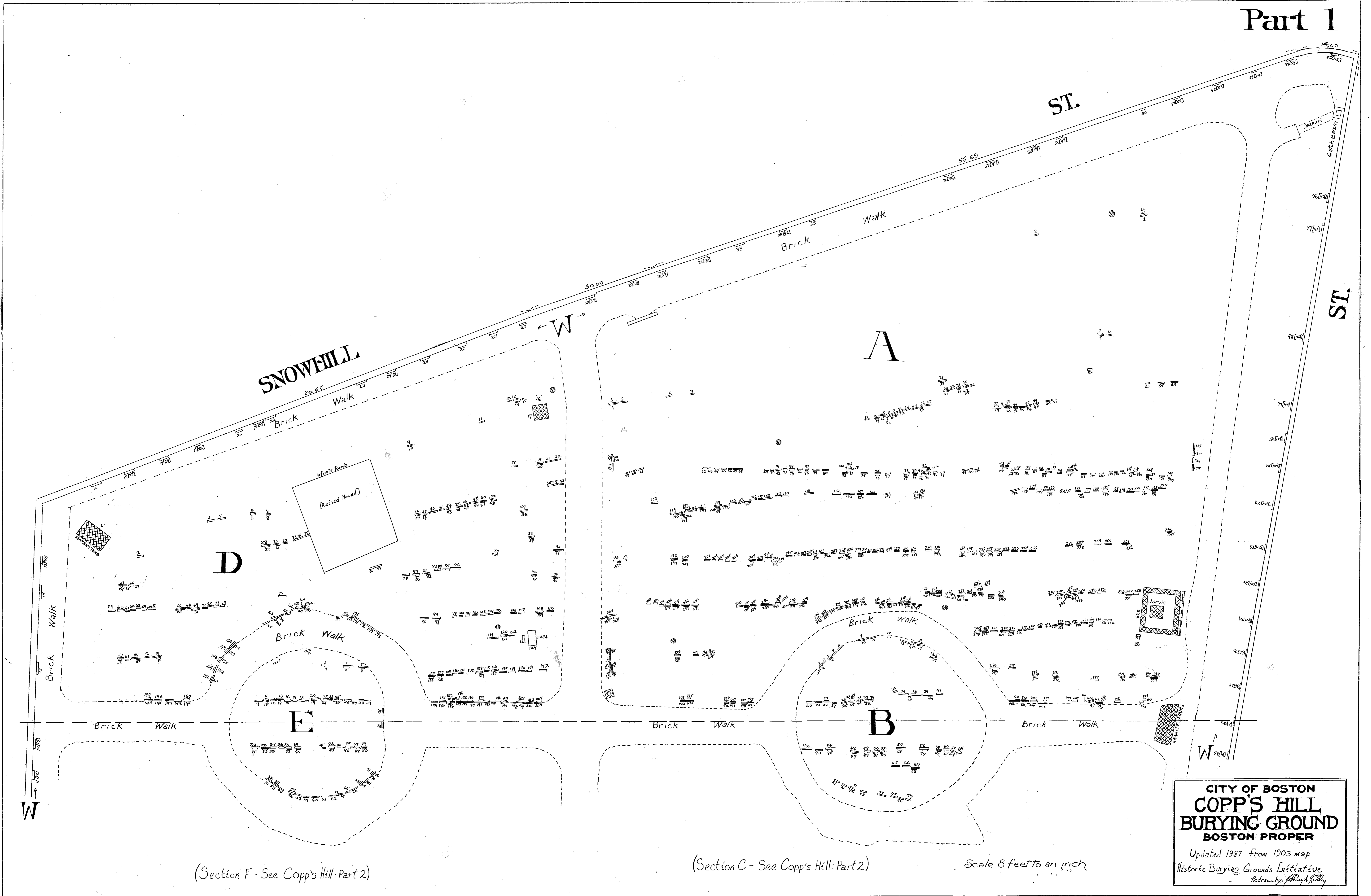

(Section F - See Copp's Hill: Part 2)

(Section C - See Copp's Hill: Part 2)

Scale 8 feet to an inch

**CITY OF BOSTON  
COPP'S HILL  
BURYING GROUND  
BOSTON PROPER**

Updated 1987 from 1903 map  
Historic Burying Grounds Initiative  
Redrawn by *Alfred Kelly*

[Section D - See Copp's Hill: Part 1]

[Section A - See Copp's Hill: Part 1]

[Section E - See Copp's Hill: Part 1]

[Section B - See Copp's Hill: Part 1]

ST.

FULL

[Section J - See Copp's Hill: Part 3]

88,743. Sq. Ft. Area of Cemetery  
272. " " Grant Lot  
89,015. " " Total Area

CHARTER

CITY OF BOSTON  
COPP'S HILL  
BURYING GROUND  
BOSTON PROPER  
Revised 1987 from 1903 Map  
Historic Burying Grounds Initiative  
Redrawn by: Piffay A. Kelly

Scale 8 feet to an inch

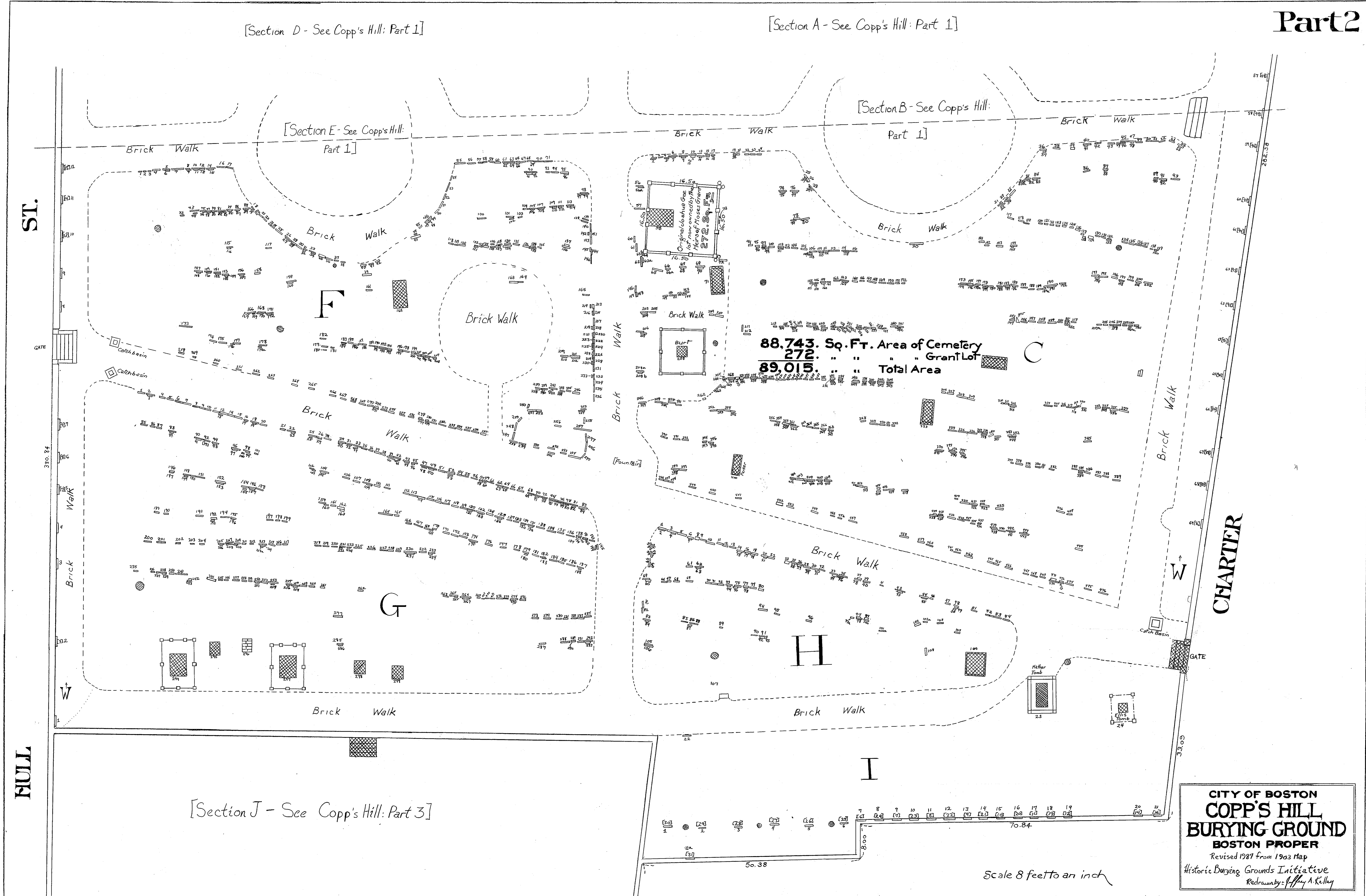

ST.

BULL

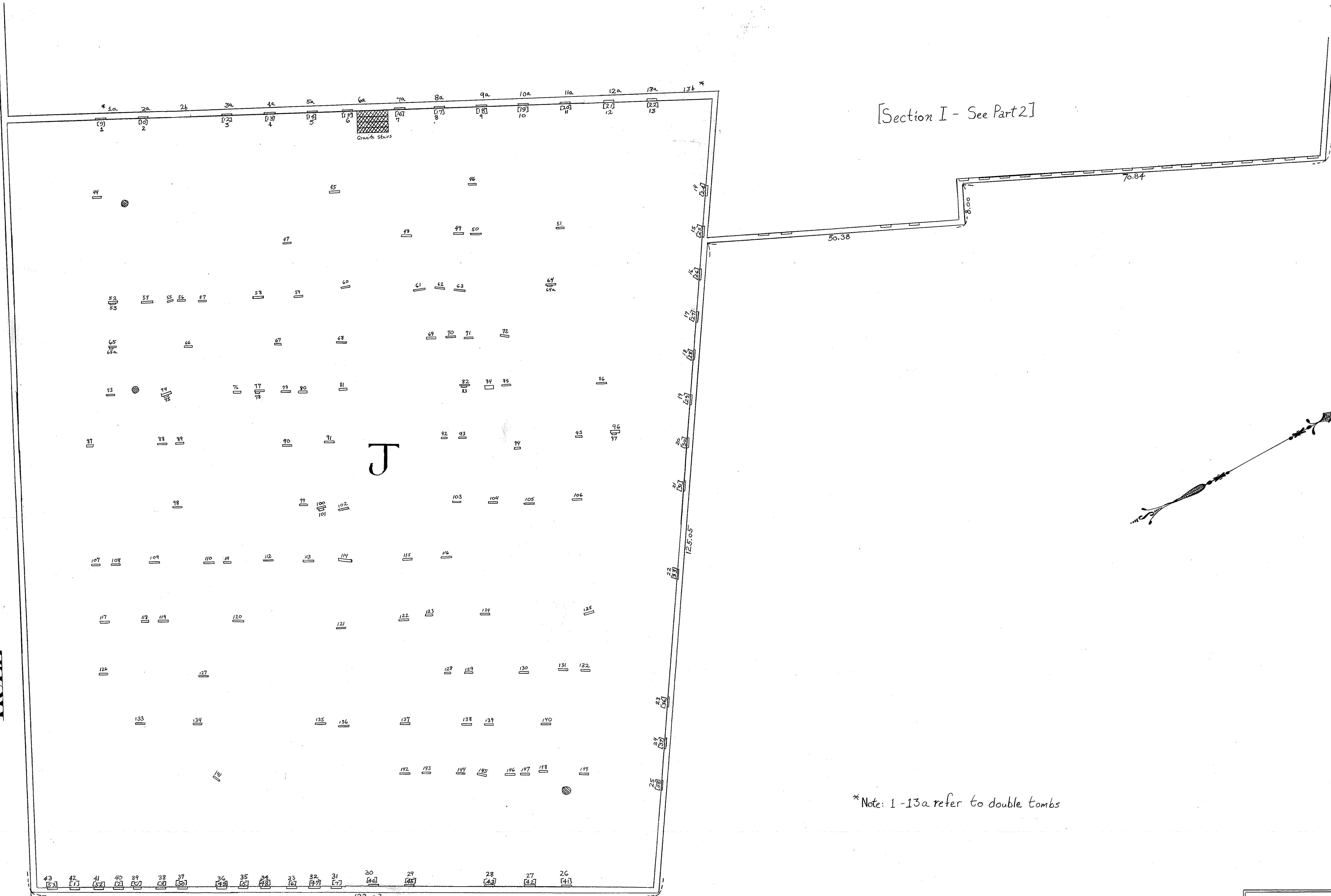

\* Note: 1-13a refer to double tombs

CITY OF BOSTON  
 COPP'S HILL  
 BURYING GROUND  
 BOSTON PROPER  
 Revised 1987 from 1903 Map  
 Historic Burying Grounds Initiative  
 Redrawn by: Jeffrey A. Kelly

Scale 8 feet to an inch