



<p><b>APPLICATION</b>                  CERTIFICATE of APPROPRIATENESS-or-                  DESIGN APPROVAL-or-EXEMPTION</p> <p>Deliver or mail to:                  Environment Department                  Boston City Hall, Rm 709                  Boston, MA 02201</p>	<p><b>For Office Use Only</b></p> <p>APPLICATION # _____</p> <p>RECEIVED _____</p> <p>FEE _____</p> <p>HEARING DATE _____</p>
--	---

DO NOT RETURN THIS FORM BY FAX OR EMAIL

DO NOT STAMP THIS BOX

I. PROPERTY ADDRESS 443 Marlborough Street, Boston, MA 02115

NAME of BUSINESS/PROPERTY N/A

The names, telephone numbers, postal and e-mail addresses requested below will be used for all subsequent communications relating to this application. Environment Department personnel cannot be responsible for illegible, incomplete or inaccurate contact information provided by applicants.

II. APPLICANT Rodolfo Machado and Jorge Silvetti

CONTACT NAME Rodolfo Machado RELATIONSHIP TO PROPERTY Owner

MAILING ADDRESS 137 Marlborough Street # 7, Boston, MA ZIP 02116

PHONE 617-437-0104 (Home) 617-459-3728 (Cell) EMAIL rodolfom@machado-silvetti.com

PROPERTY OWNER Rodolfo Machado and Jorge Silvetti CONTACT NAME Rodolfo Machado

MAILING ADDRESS 137 Marlborough Street # 7, Boston, MA ZIP 02116

PHONE 617-437-0104 (Home) 617-459-3728 (Cell) EMAIL rodolfom@machado-silvetti.com

ARCHITECT N/A CONTACT NAME N/A

MAILING ADDRESS N/A ZIP N/A

PHONE N/A EMAIL N/A

CONTRACTOR Cambridge Landscape Co., Inc. CONTACT NAME Joseph Nardelli

MAILING ADDRESS 100 Smith Place, Cambridge, MA ZIP 02138

PHONE 617-661-8591 EMAIL info@cambridgelandscape.com

III. DESCRIPTION OF PROPOSED WORK

**A BRIEF OUTLINE OF THE PROPOSED WORK MUST BE GIVEN IN THE SPACE PROVIDED BELOW, OR THE APPLICATION WILL NOT BE ACCEPTED.** This description provides the basis for the official notice and subsequent decision, and it must clearly represent the entirety of the project. Additional pages may be attached, if necessary, to provide more detailed information.

Prior to the removal of the ailanthus tree, police detail services will be obtained and parking permits will be obtained for the parking spaces in front of the building located at 443 Marlborough Street. The parking spaces will be secured 48 hours prior to the time that work is to begin. A police detail will be ordered 48 hours prior to the beginning of work. On the day of removal, Cambridge Landscape Co. Inc., will install safety cones and signs at the work site. Work will then begin and the tree will be removed skillfully and safely by raising and lowering the wood and the branches to the ground where they will be chipped in the chip truck. The stump will be ground below grade. After completion of the removal, staff members of Cambridge Landscape Co. Inc. will clean up the work area and will remove all the resultant debris. After the ailanthus tree is removed and the site cleaned up, Cambridge Landscape Co. Inc. will plant a 2.5" green shadow magnolia tree.

The crown of the adjacent ailanthus will be pruned to remove dead, diseased and dying branches.

REQUIRED DOCUMENTATION: Please include all required documentation with this application; review instructions carefully for details.

ESTIMATED COST OF PROPOSED WORK: \$9,700

IV. DULY AUTHORIZED SIGNATURES (both required)

The facts set forth above in this application and accompanying documents are a true statement made under penalty of perjury.

APPLICANT [Signature] OWNER\* [Signature]
\*(If building is a condominium or cooperative, the chairman must sign.)
PRINT Rodolfo Machado, Jorge Silvetti PRINT Rodolfo Machado, Jorge Silvetti

Environment Department personnel cannot be responsible for verifying the authority of the above individuals to sign this application. Misrepresentation of signatory authority may result in the invalidation of the application. UNSIGNED OR PARTIALLY SIGNED FORMS WILL BE REJECTED

THIS APPLICATION IS NOT COMPLETE WITHOUT SIGNATURES, FEES AND REQUIRED DOCUMENTATION. The checklist below is for reference only: Please refer to the detailed application instructions for deadlines, fee schedule and required documentation specific to your proposal.

- COMPLETED APPLICATION FORM
APPLICATION FEE (Check or money order made payable to City of Boston; see fee schedule in Instructions)
DESCRIPTION OF WORK (A brief description must be included on the front page; additional pages of detailed information may be attached. Applications that only note "see attached" will not be accepted.)
PHOTOS OF EXISTING CONDITIONS
DRAWINGS AND SPECIFICATIONS AS REQUIRED (See "documentation requirements" in instructions)

Land In BOSTON Belonging to THOMAS P. GERRITY, JR. Deed in Book 8771 Page 228  
Land Court Certificate No. in Book Page In SUFFOLK Registry OF DEEDS  
Recorded Plan OF LAND IN BOSTON BY FULLER & WHITNEY, SURV. & C. E. Date of Plan SEPTEMBER 1, 1885  
in SUFFOLK Registry OF DEEDS IN Book 1725 No. 438 Filed Plan No.

**BOUNDARY EXAMINATION**

Loan No.

THE BOSTON FIVE CENTS SAVINGS BANK #48182  
RODOLFO MACHADO - JORGE SILVETTI  
443 MARLBOROUGH STREET, BOSTON

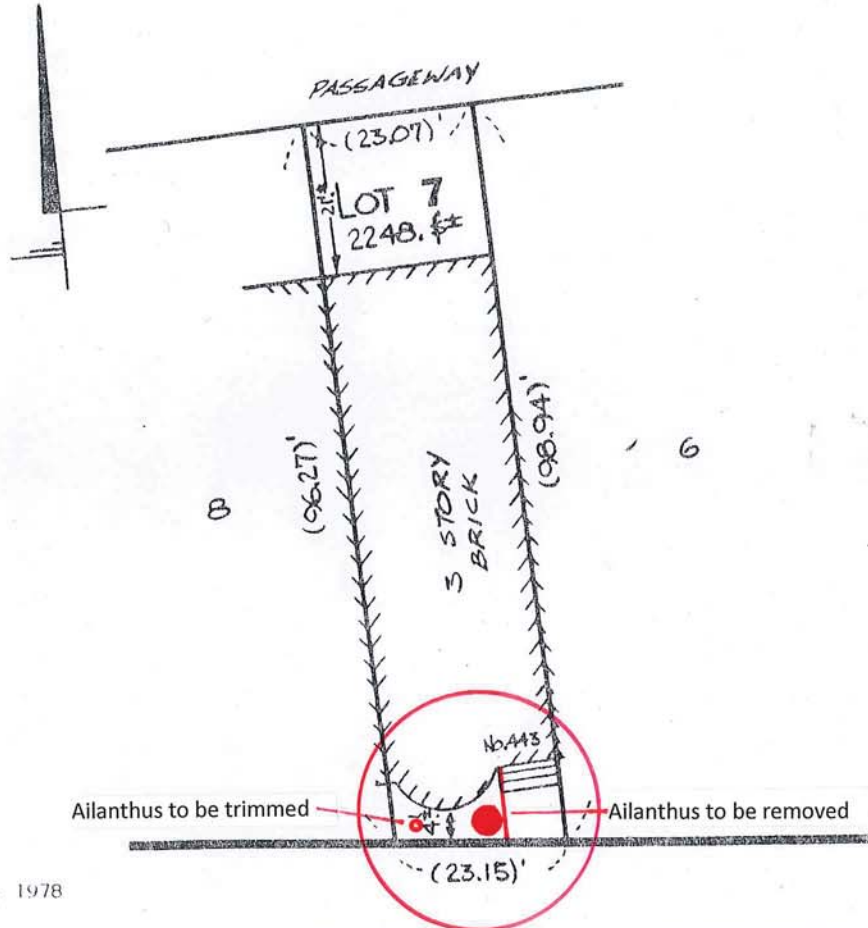

Oct. 24, 1978

JN 25909  
Scale 1" = 20'

MARLBOROUGH STREET

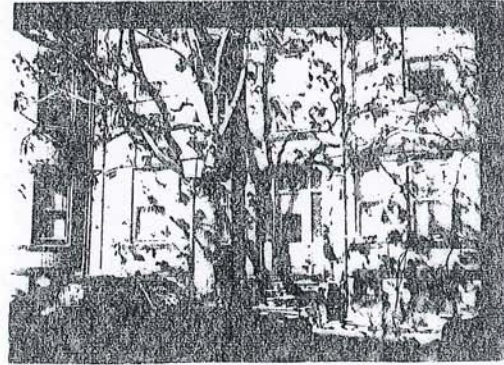
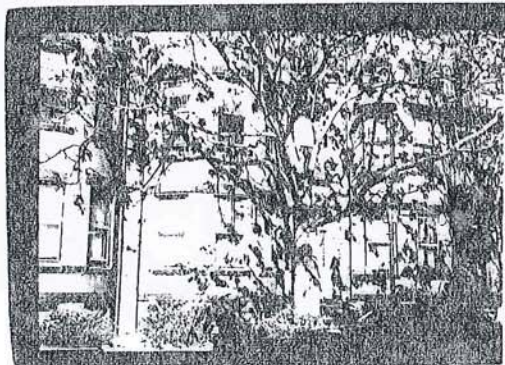



11 May 2017

Mr. Rodolfo Machado  
560 Harrison Avenue #301  
Boston, MA 02118

Project 170704 – Structural Effect of Existing Tree, 443 Marlborough Street, Boston, MA

Dear Mr. Machado:

Per your request, we visited the above building on 7 May 2017 to observe the existing tree and its effect on the building structure. We also reviewed photographs you provided of the interior below-grade space showing the granite block foundation wall. We understand from you that the interior of this wall has been recently repaired and repointed.

The existing tree adjacent to the entrance path is approximately 5 ft diameter near the base and 1 ft away from the building at grade. We observed the perimeter sidewalk curb and entrance brick have moved outwards and upwards, respectively.

We note that any existing soil places lateral pressure on an adjacent foundation wall. At this location, the lateral pressure is increased significantly by the scale and proximity of the tree. This high pressure will cause continuing local damage to the wall over time, requiring repairs from the interior and possibly from the exterior as well. Over time, as the tree grows, the loads will continue to increase and as a result the repairs will become more serious.

We advise that early removal of the existing tree will reduce the lateral pressure loads and consequently reduce the need for such repairs in the future.

Sincerely yours,

Paul E. Kassabian, P.E.  
Associate Principal  
MA License No. 45467

I:\BOS\Users\PEKassabian\WP\016PEKassabian-L.ptl.docx

# Cambridge Landscape Co. Inc.

Deal with a reputable company that is certified and insured. Our insurance certificate will be furnished upon request.

100 Smith Place, Cambridge, MA 02138  
(617) 661-8591 (978) 369-4644 Fax: (617) 661-3900

Pruning

DATE: 5-2-17

NAME: Rodolfo MACHADO

ADDRESS: 443 MARLBOROUGH ST

TOWN: Boston

Stump Removal

EMAIL: Rodolfo@machado-silvetti.com

PHONE (H) \_\_\_\_\_

(W) \_\_\_\_\_

BILLING ADDRESS (IF DIFFERENT) \_\_\_\_\_

RECOMMENDED EQUIPMENT \_\_\_\_\_

Below is a complete description of the work and prices to be performed by the SELLER and both parties agree that any addition or change in the work or prices must be agreed to in writing.

JOB DESCRIPTION

Spraying

Take down and Remove ALIANTHUS	9700.
GRIND STUMP below Grade, REMOVE	
ALL GRINDING DEBRIS	

Injection

PRUNE ADJACENT ALIANTHUS CROWN CLEAN	
TO REMOVE dead, diseased, AND DYING BRANCHES.	

PARKING PERMITS AND POLICE DETAIL	
-----------------------------------	--

Tree Removal

SUPPLY AND INSTALL ONE 2.5"	
GREEN SHADOW MAGNOLIA	

9700.

Acceptance:

Work cannot be performed without a signed acceptance order. Proposal good for 30 days.

 **RODOLFO MACHADO**  
CLIENT

  
REPRESENTATIVE





























