





A/C

2

15 Braemore Road
Proposed new retaining wall and landscaping

garage

Gravel/dirt parking lot

Existing Retaining Wall

Proposed Retaining Wall
(with new steps)

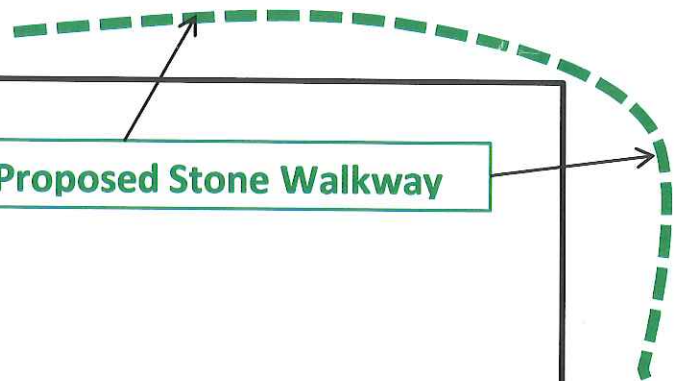
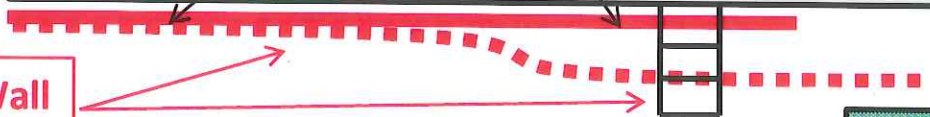

Proposed Stone Walkway

Fire escape
(three story)

Driveway

Front entry

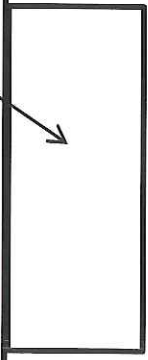
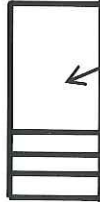

Pachysandra

BRAEMORE ROAD

North
↓





TREES TO
BE
REMOVED

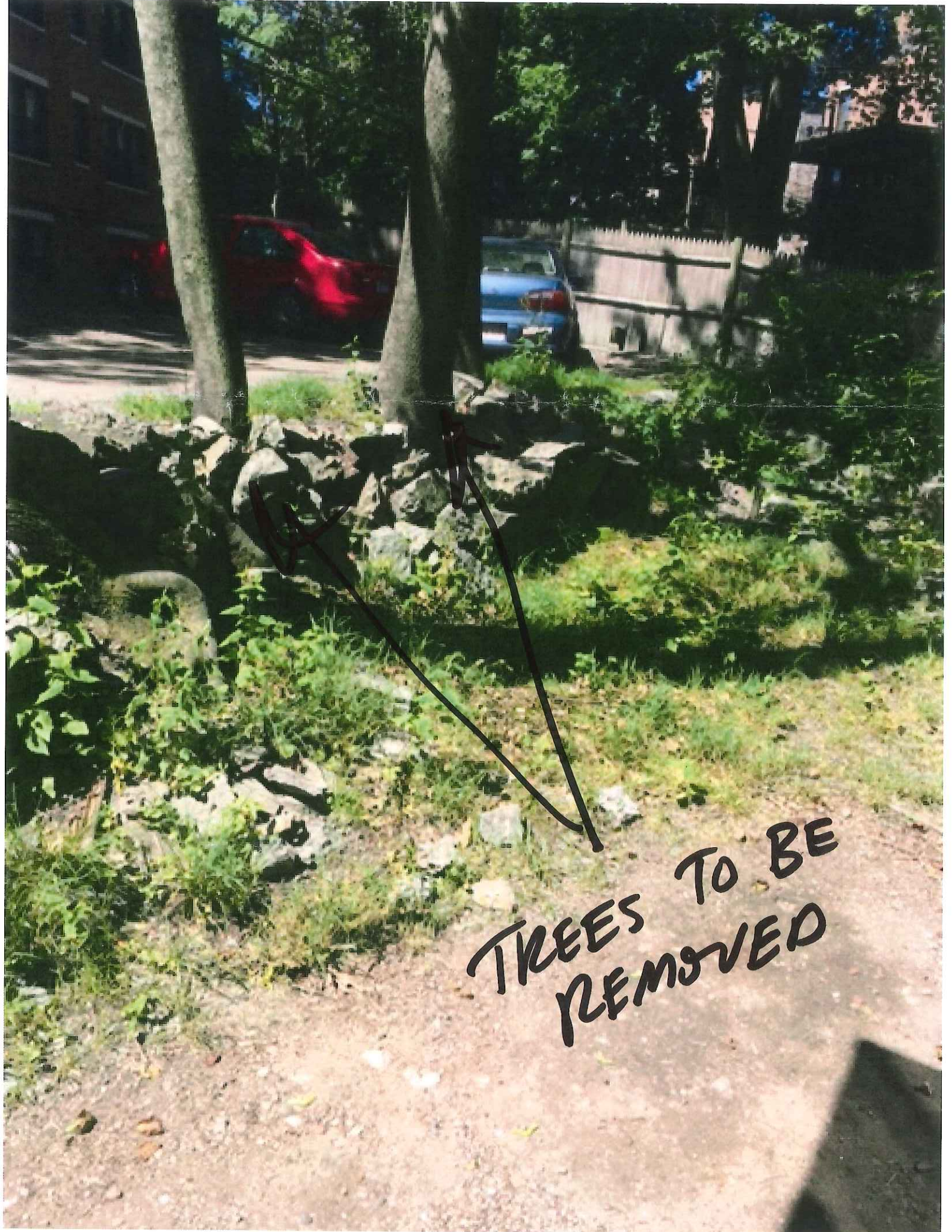

TREES TO BE
REMOVED

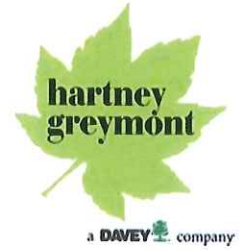

September 13, 2017

To Whom It May Concern,

I visited the property of Gina Pagonis at 15 Braemore Rd in Brighton yesterday. I was contracted by Gina to assess the health and condition of four trees located behind the house growing through the retaining wall of the parking area. All four trees are Norway Maples, I measured their sizes as; 23", 6", 15" and 11". These sizes were all measured as DBH, (diameter at breast height, measured at 4.5').

These trees appear to be in varying states of decline, including multiple dead stems and significant dieback. The trees that appear to have a fuller canopy have significant lean towards the house or parking area and would cause serious damage if they failed.

It is likely that when the existing wall is rebuilt that any trees that remain will cause further damage to the retaining wall due to their growing location. It is my recommendation that all four of the trees in question be removed due to their current condition and the risk that they pose to the house and vehicles parked below. Pruning can help to reduce the risk, but as I mentioned earlier the trees appear to be in a state of decline and would likely need to be removed within three years anyway. Please feel free to contact me with any questions or concerns related this letter, thank you.

Best,

A handwritten signature in black ink that reads 'D. J. Cohen'.

Daniel J. Cohen

MA Certified Arborist

ISA Certified Arborist

MA Certified Landscape Professional

MA Certified Horticulturalist



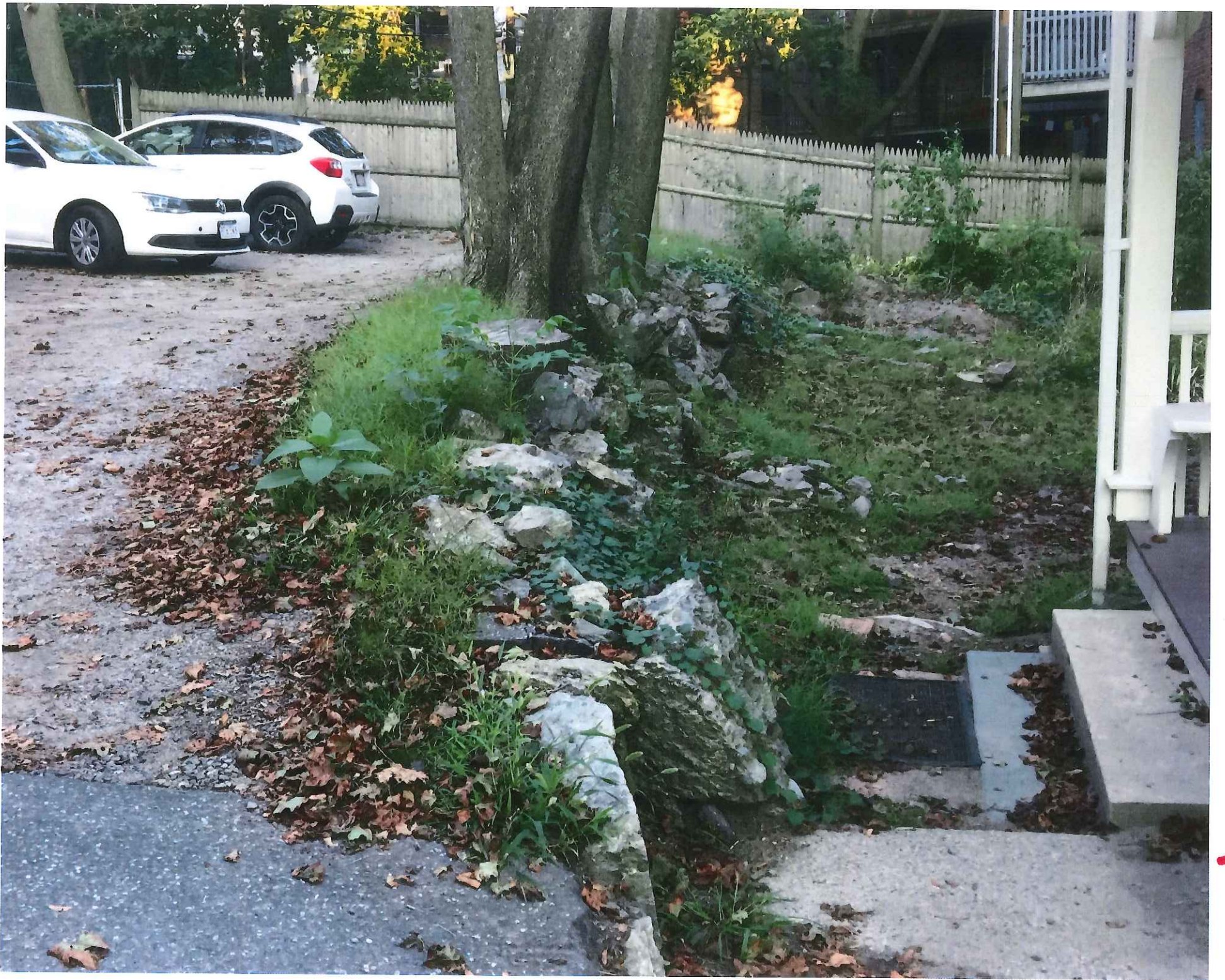



8



EXAMPLE OF
PACHYSANDRA

