

cherry tree on
back patio

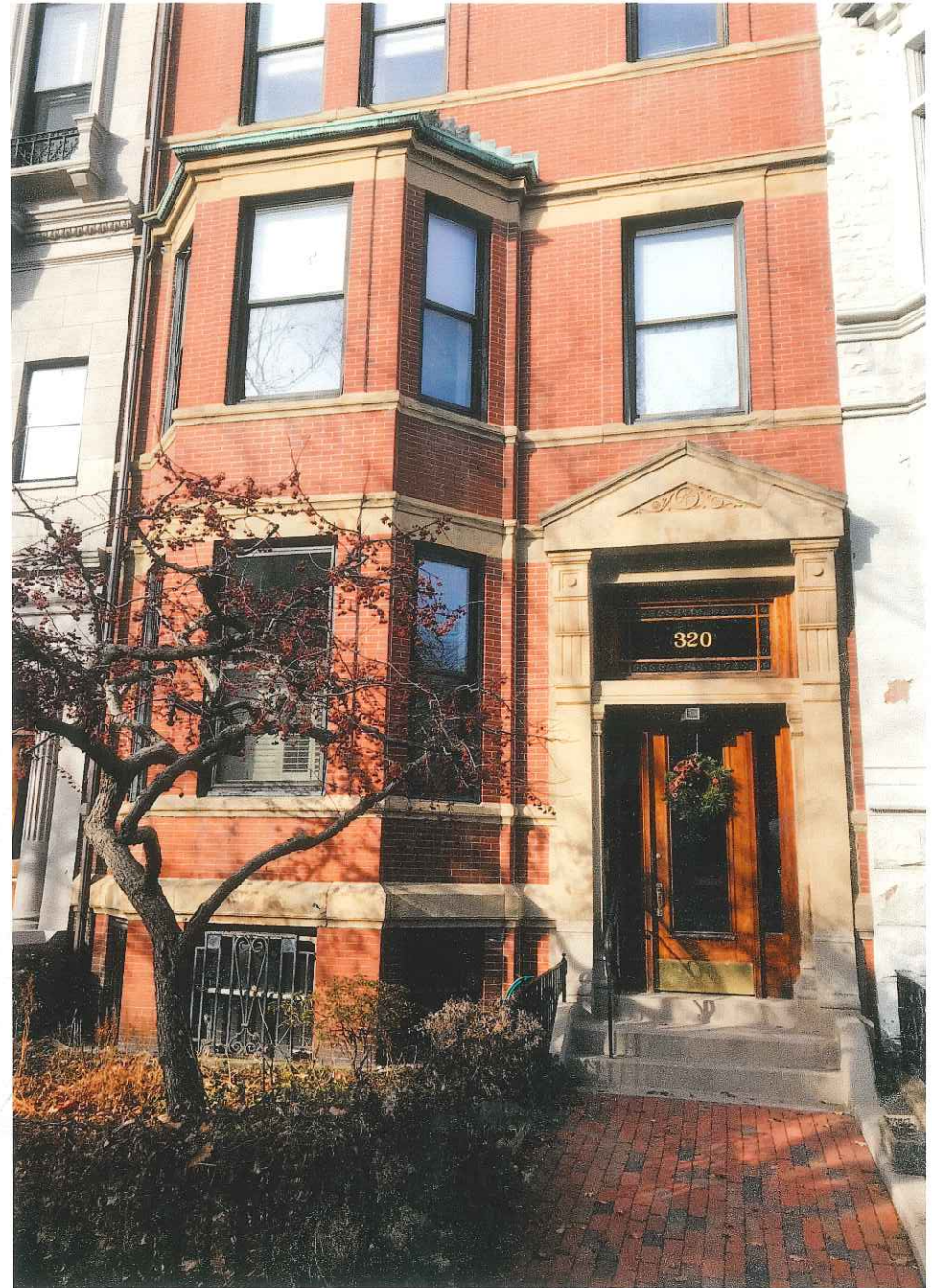

320 Beacon St. pg 1 of 2

street facade

Back patio

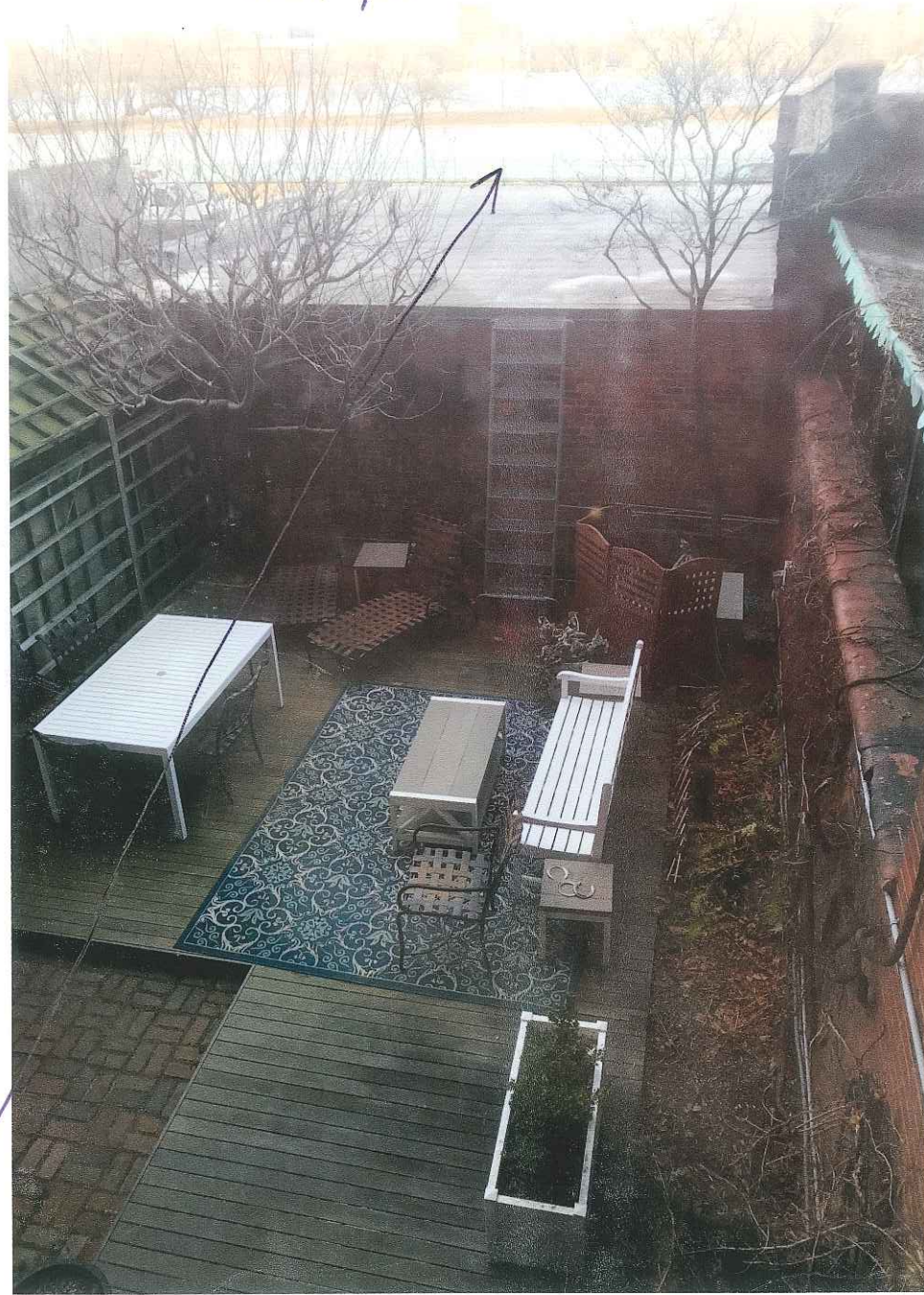

sewer
line

320 Beacon St. pg 2 of 2

cherry
tree on
patio



view from alley behind
320 Beacon St.



SEWER & PIPE CLEANING, INC.

TO: Dianne Hodgetts, 320 Beacon St #1, Boston, MA. 02116

RE: Back Bay Architectural Commission

Dear Commissioners:

We recently completed an extensive repair of the main sewer pipe at 320 Beacon Street, Boston, MA. 02116. This pipe, which runs through the interior of the building across the back patio, through the garage, and out to the street, was blocked and disintegrated. Once the pipe was dug up and exposed, it was evident that it had been damaged and compromised by the roots of the cherry tree, which is on the back patio and is planted directly over the sewer line. This repair cost in excess of \$15,000 and caused extensive interior damage to expose the pipe. The pipe is now repaired, but if this tree is not removed, there will be further and continuing damage to the sewer line running underneath it. We strongly recommend removal of this tree to protect the sewer line.

Thank you,

Kristen Madden
Project Manager

4 Breed Avenue
Woburn, MA 01801
Phone (781) 569-6695 Fax (781) 569-6694