

I. PROPERTY ADDRESS The Boston Common. 139 Tremont St, Boston, MA 02111

NAME of BUSINESS/PROPERTY _____

The names, telephone numbers, postal and e-mail addresses requested below will be used for all subsequent communications relating to this application. Environment Department personnel cannot be responsible for illegible, incomplete or inaccurate contact information provided by applicants.

II. APPLICANT King Boston (The Boston Foundation)

CONTACT NAME Marie St. Fleur RELATIONSHIP TO PROPERTY none

III. DESCRIPTION OF PROPOSED WORK

A BRIEF OUTLINE OF THE PROPOSED WORK *MUST BE PROVIDED IN THE SPACE BELOW, OR THE APPLICATION WILL NOT BE ACCEPTED.* This description **MUST** include ALL proposed work, as the basis for the official notice and subsequent decision. Additional pages may be attached, if necessary, to provide more details.

This application is seeking advisory review.

The project is a memorial to honor Rev. Dr. Martin Luther King Jr. and Coretta Scott King and their time and work together in Boston. The memorial seeks to be a call to action and commemorate their legacy in the City of Boston, the nation and the world.

The memorial recontextualized a photograph of the two of them. It will evoke the simple, yet powerful, act of an embrace. Beneath the arms of Dr. King and Coretta Scott, passersby will be reminded of our shared human connections. This memorial will envelop participants, allowing them to be simultaneously vulnerable and protected. At the same time, we hope to solidify the ideals of inclusion that the Kings sought to defend in their united life of activism. We seek to call people into the act of empathy, an idea Coretta Scott King captured when she said:

"Love is such a powerful force. It's there for everyone to embrace-that kind of unconditional love for all of humankind. That is the kind of love that impels people to go into the community and try to change conditions for others, to take risks for what they believe in."

Memorial consists of a plaza with a twenty-two foot high metal statue. The statue features a portal to open people to the interior and an oculus at the top open up to the sky.

By highlighting the act of embrace, this sculpture shifts the emphasis from a singular hero worship to collective action, imploring those curious enough to investigate closer. The material used will further encourage introspection and action. The memorial will be a mirror finish, reflecting the changing natural environment of the park and the viewers themselves.

EXISTING SITE PHOTOS

King Boston

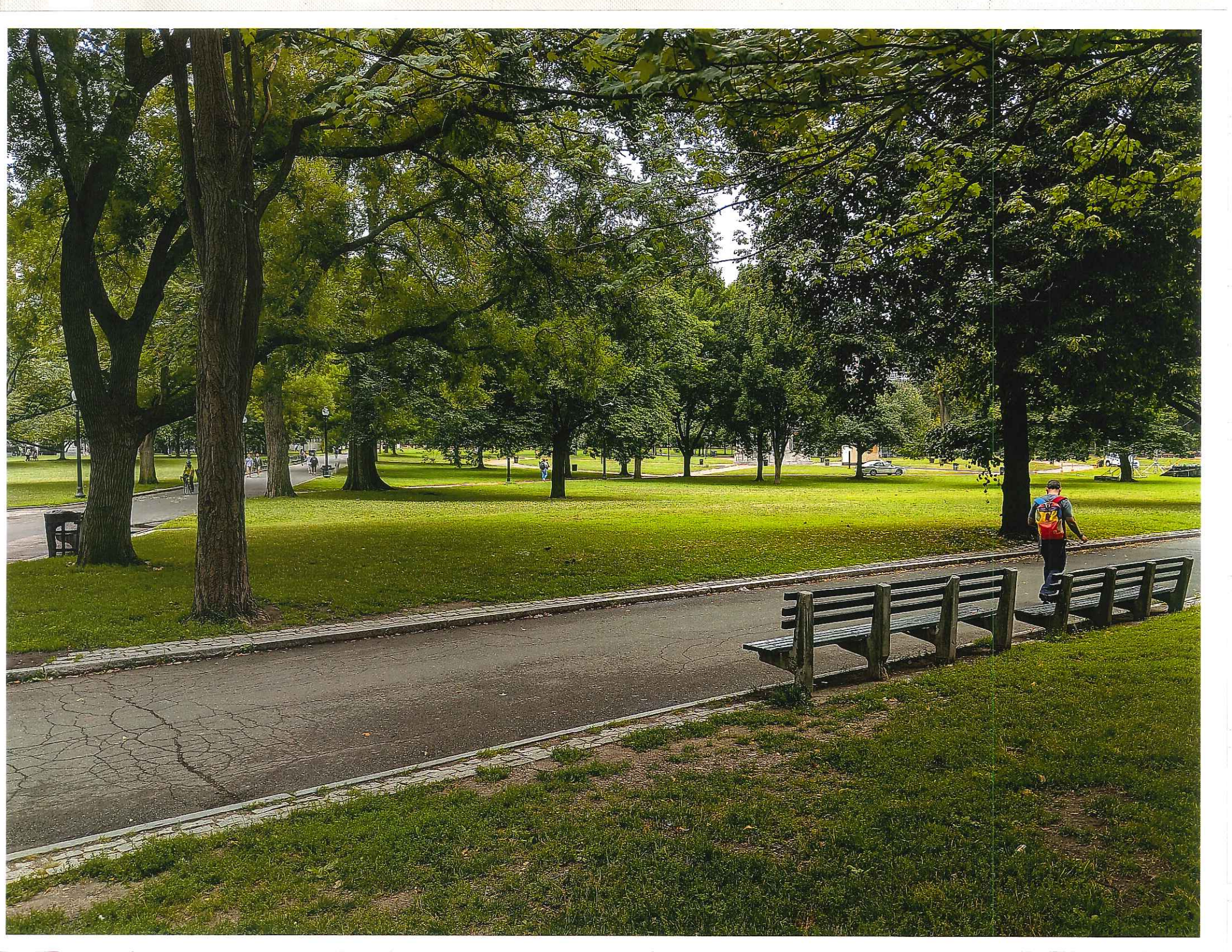









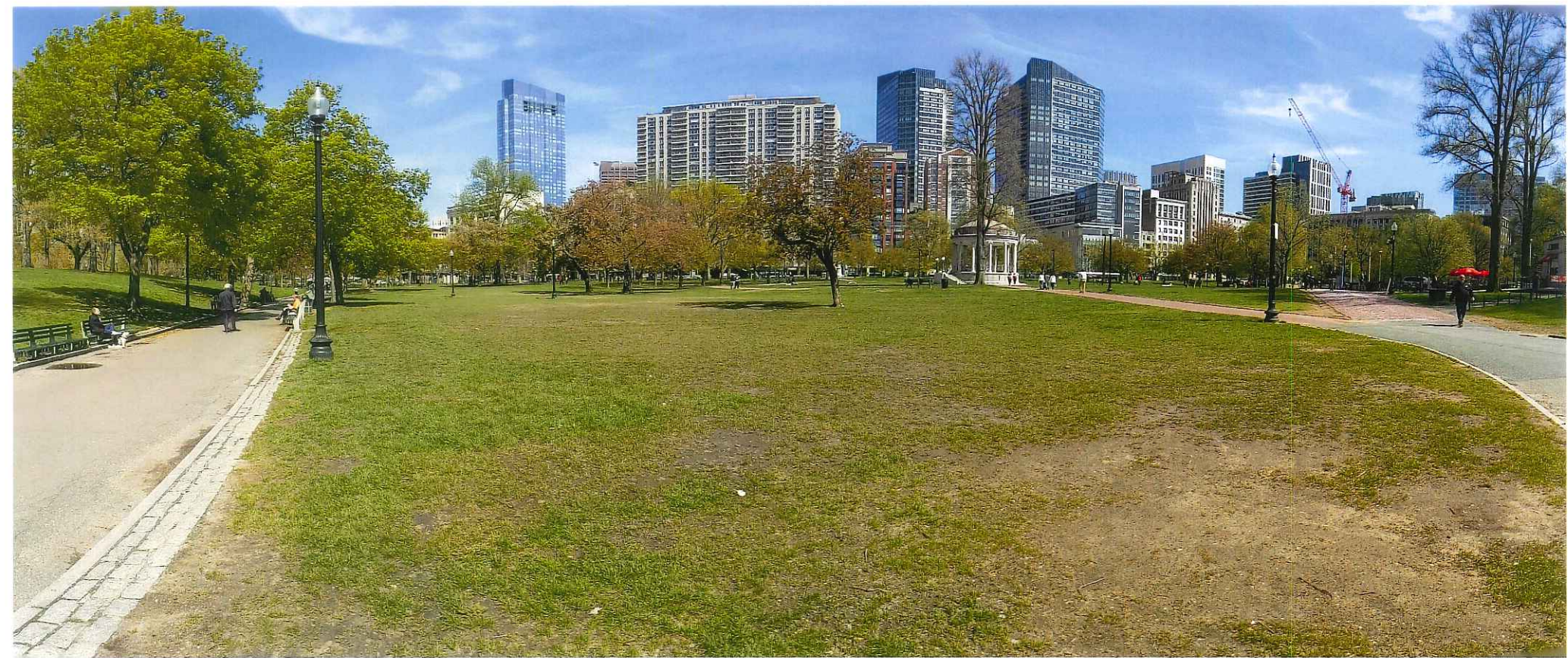

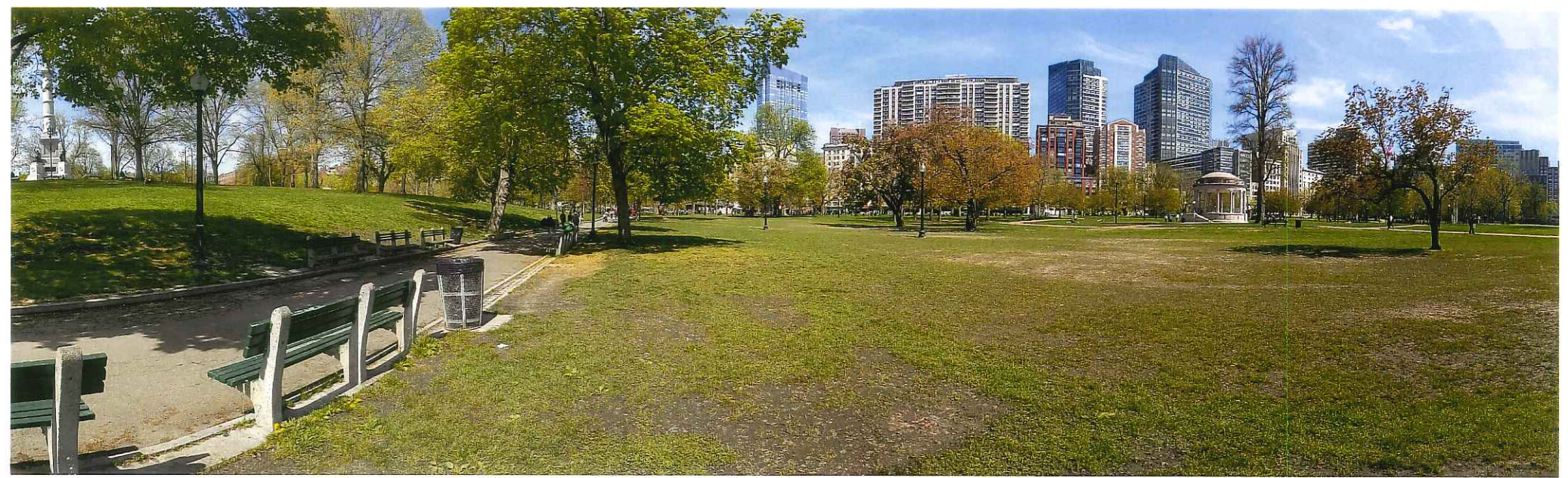



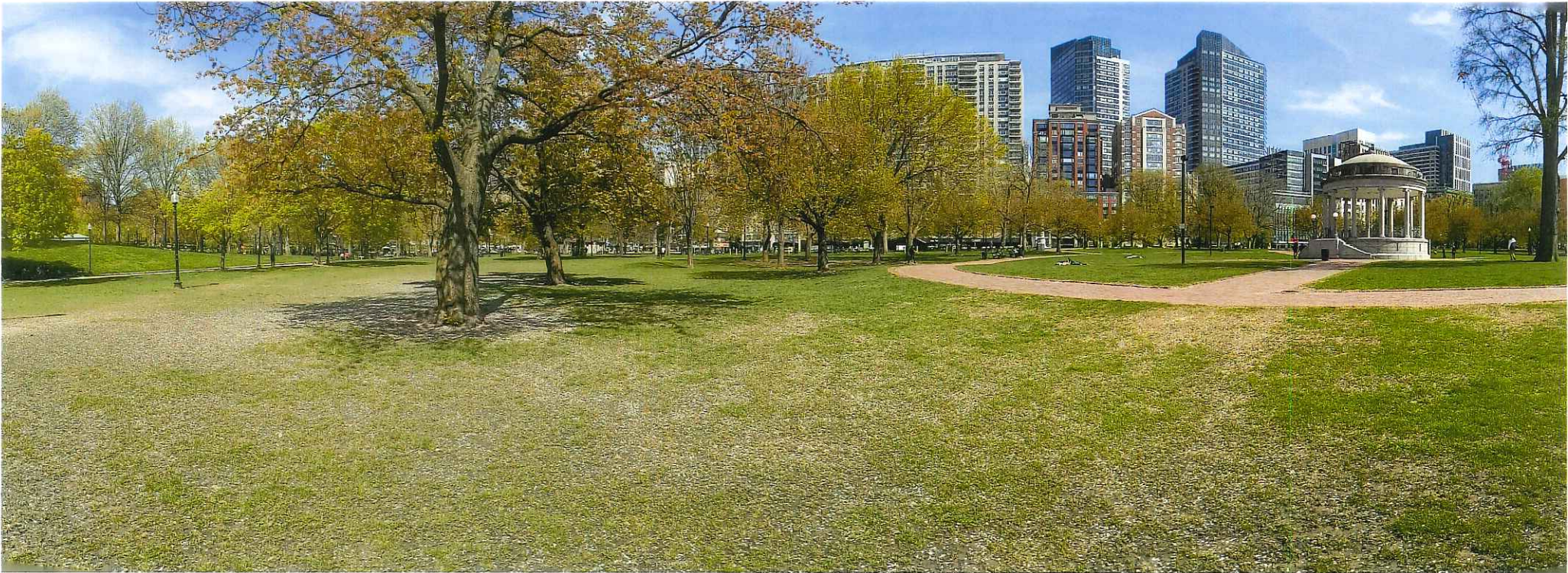





RENDERINGS

King Boston







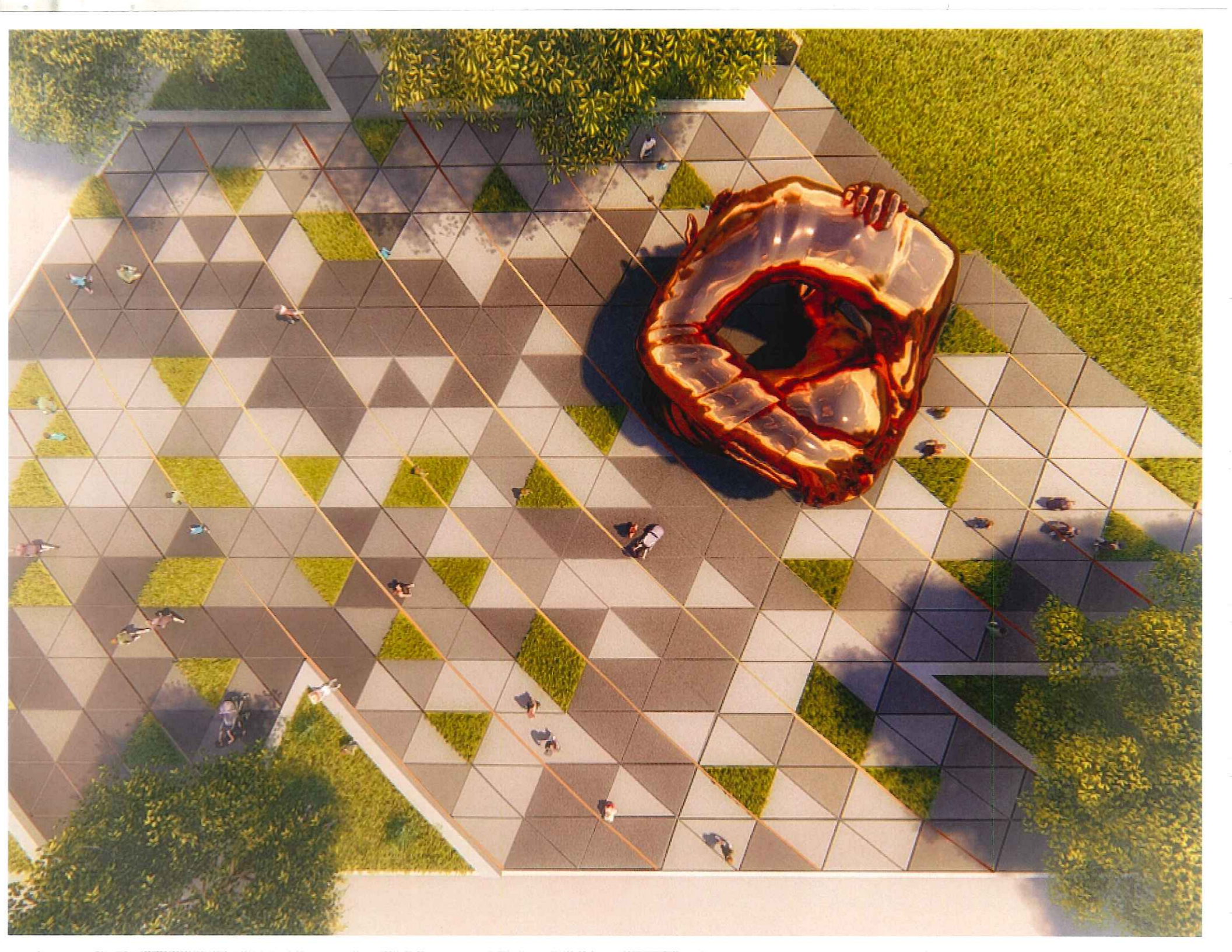

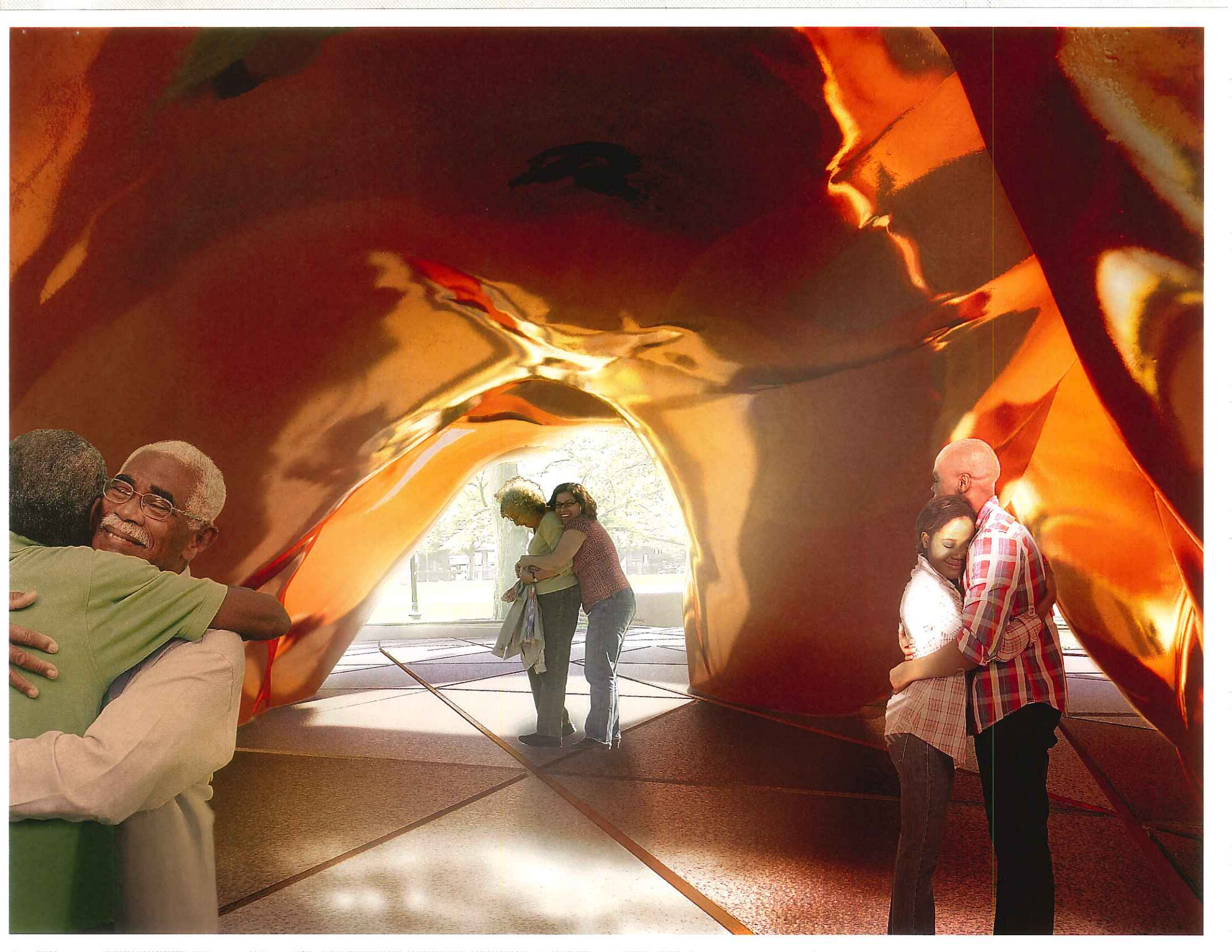



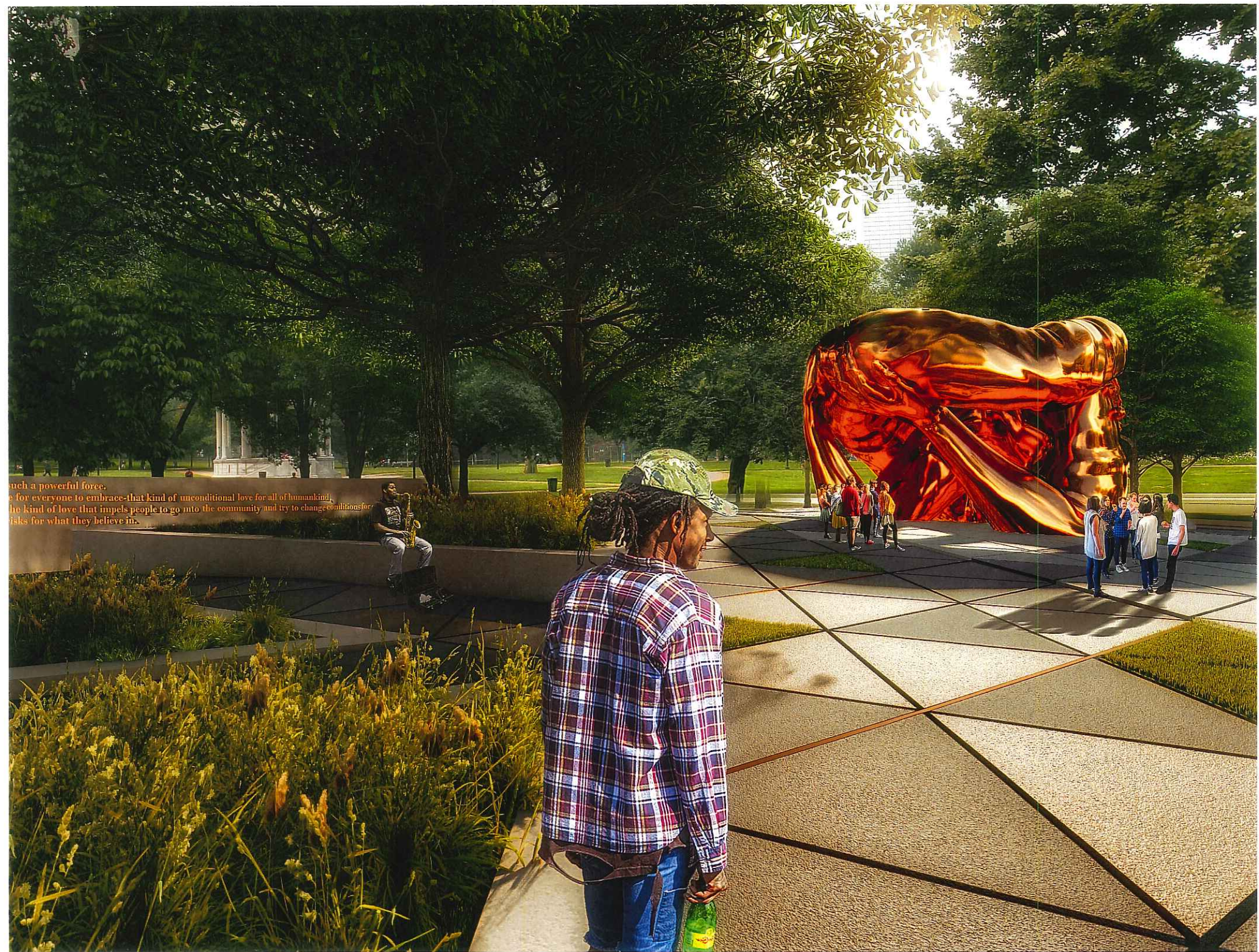

such a powerful force.
e for everyone to embrace that kind of unconditional love for all of humankind,
the kind of love that impels people to go into the community and try to change conditions for
risks for what they believe in.

Context

Memorializing the Kings

A FREEDOM MARCH

On **April 23, 1965**, Martin Luther King, Jr., led one of Boston's first freedom marches from Roxbury to Boston Common. Galvanized by his presence, 22,000 people gathered together to hear him speak in one of the city's most enormous demonstrations for civil rights.

WILLIS THOMAS



Twelfth Baptist Church

KING BOSTON MEMORIAL | PROJECT INTRODUCTION

King Educational Center

Dudley Square

Parkman Bandstand

The Embrace
Mark Willis Thomas x MASS

State House

Boston Common

Route of King's 1965 freedom march

Context

Memorializing the Kings



MASS. HANKS WILLIS THOMAS

KING BOSTON MEMORIAL | PROJECT INTRODUCTION

Back Bay

MLK entry to the Common

AXIS TO DUDLEY

3 The Embrace

1 Plaza

2 Amphitheatre

Site 2

Site 1

Site 3

Charles St.

BLACK HERITAGE TRAIL

Beacon St.

The Freedom Trail

Beacon St.

Arlington St.

Charles St.

Tremont

Bolyston St.

T

T

T

Context

Site

3 The Embrace

21ft tall
31ft diameter

1 Plaza

15,400 sq ft

2 Amphitheatre

10,200 sq ft

Parkman Memorial Bandstand

33 ft diameter
Bandstand green: 42,800 sq ft

MASS.

FRANK THOMAS

Context

Site

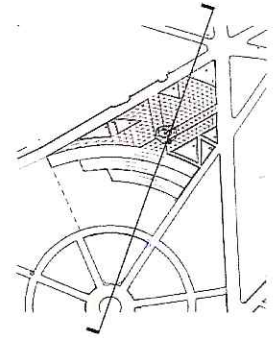

← COMMUNITY AMPHITHEATER CIVIC PLAZA →

Parkman Bandstand
Dudley Square
The King Educational Center

Massachusetts State House
54th Regiment Memorial
Black Heritage Trail

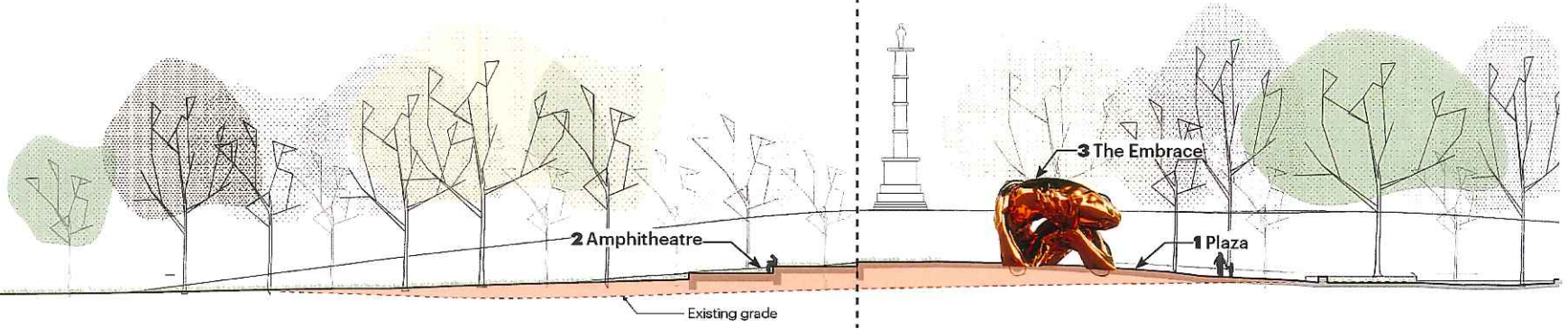

Plaza

A Place for Gathering & Engagement



MASS.

HANKS
WELLS
THOMAS

KING BOSTON MEMORIAL | PROJECT INTRODUCTION