



APP # 20.151 FPC

347-351 Congress Street

Applicant: David Durgin, The 347 Congress Street LLC

Hearing Date: 9/12/19

Summary: Replace existing mechanically fastened EPDM roof with new EPDM roof and remove all exterior gutters, rain leaders, downspouts and corresponding street connections. All drains and rain water downspouts will be relocated to the interior of the building. A 16" high parapet extension setback approximately 18" from the existing roofline is proposed to be installed to ensure the proper flow of rain water and melted snow to drawings and to prevent the buildup of snow along the edge of the roofline.

Reason: To alleviate dangerous icing conditions during winter months that have resulted in ice pack near the top of the drains that has fallen on vehicles in past years as it melts.

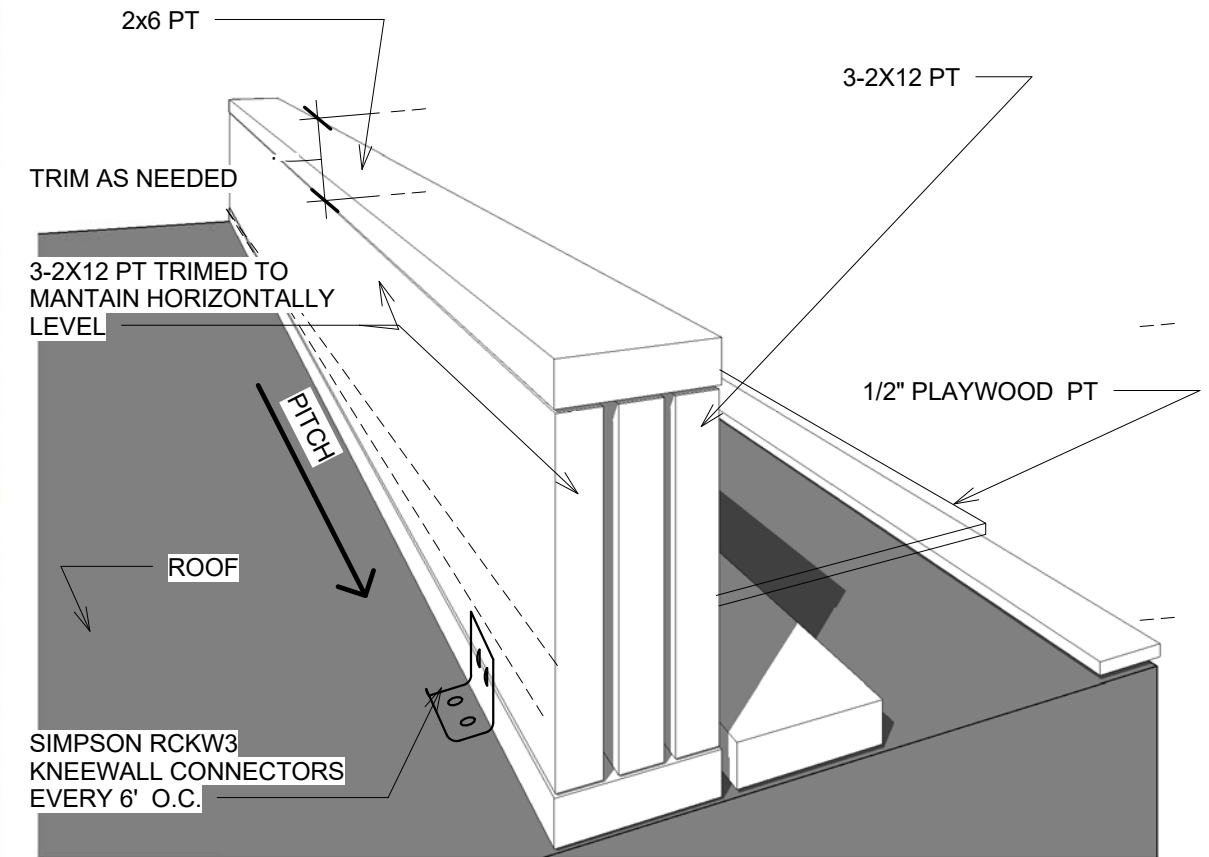

1 3D View 1

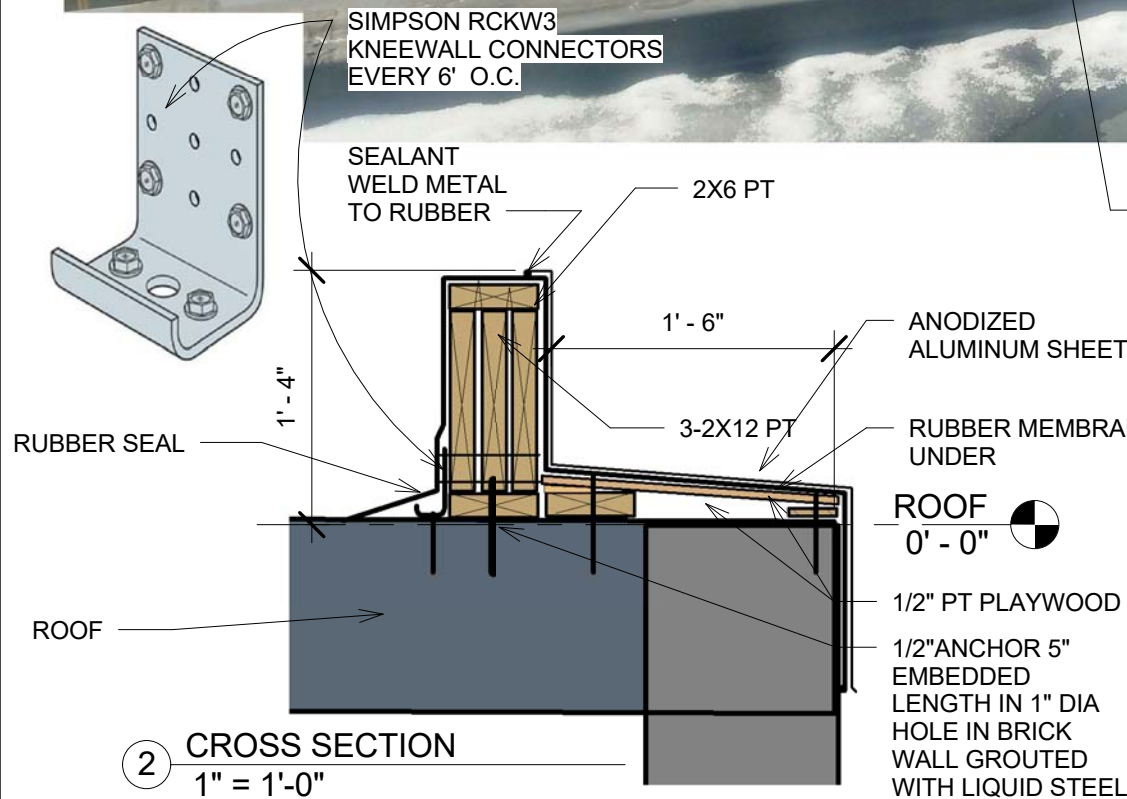

2 CROSS SECTION
1" = 1'-0"

EDGE OR CORNER SEAMS:
THE TWO METHODS FOR SECURING EDGE OR CORNER SEAMS, SHOWN HERE, USE THE SINGLE LOCK PRINCIPLE. THE MEMBER FORMING THE UNDERSIDE OF THE LOCK WOULD NORMALLY BE CLEATED BEFORE THE UPPER MEMBER IS ENGAGED. DEPENDING ON PREVAILING CONDITIONS, ONE OPTION IS TO DRESS DOWN THE LOCK AS SHOWN.

GENERAL SPECIFICATIONS

MATERIALS
ANODIZED ALUMINUM SHEET FOR BUILDING CONSTRUCTIONS OR EQUIVALENT. ONLY DOMESTIC MATERIALS SHALL BE USED WHEN AVAILABLE. ANY SHEET METAL SHOWN ON DRAWINGS AND NOT OTHERWISE SPECIFIED SHALL BE 16 oz. COLD ROLLED ALUMINUM. SHEETS SHALL CONFORM TO ASTM SPECIFICATIONS B209 OR FEDERAL SPECIFICATION QQ-C-5762Q2QQQ OR EQUIVALENT.



LALA ASSOCIATES ENGINEERS LLC
37 OLD VILLAGE ROAD, ACTON, MA 01720
LIC.#40460-C(EXP 6/30/20)

LALAEENGINEERS@GMAIL.COM / 978 337 5252

KENSINGTON INVESTMENT COMPANY

347 CONGRESS ST
BOSTON MA

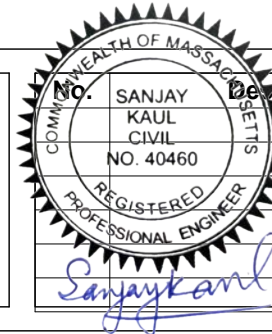

Description	Date

PROPOSED ROOF PARAPET

Project number	19160
Date	7/31/2019
Drawn by	DRV
Checked by	KL

A1

Scale 1" = 1'-0"







EMERSON
Network Power
Liebert



5 W 3rd St



GRAND COOL GALLERY