



**Jamaica Pond Park Pathways & Entrances:
Phase 2 Additional Work**
Jamaica Pond Park, Jamaica Plain
October 22, 2019

SCOPE OF WORK

- **Cobblestone spillway for stormwater improvement**

STORMWATER MANAGEMENT SPILLWAYS - EXISTING AND PROPOSED

- **COBBLESTONE SPILLWAY (PROPOSED)**
- **COBBLESTONE SPILLWAY (EXISTING)**
- **COBBLESTONE SPILLWAY (CONSTRUCTED IN 2019 PER 19.551.142)**

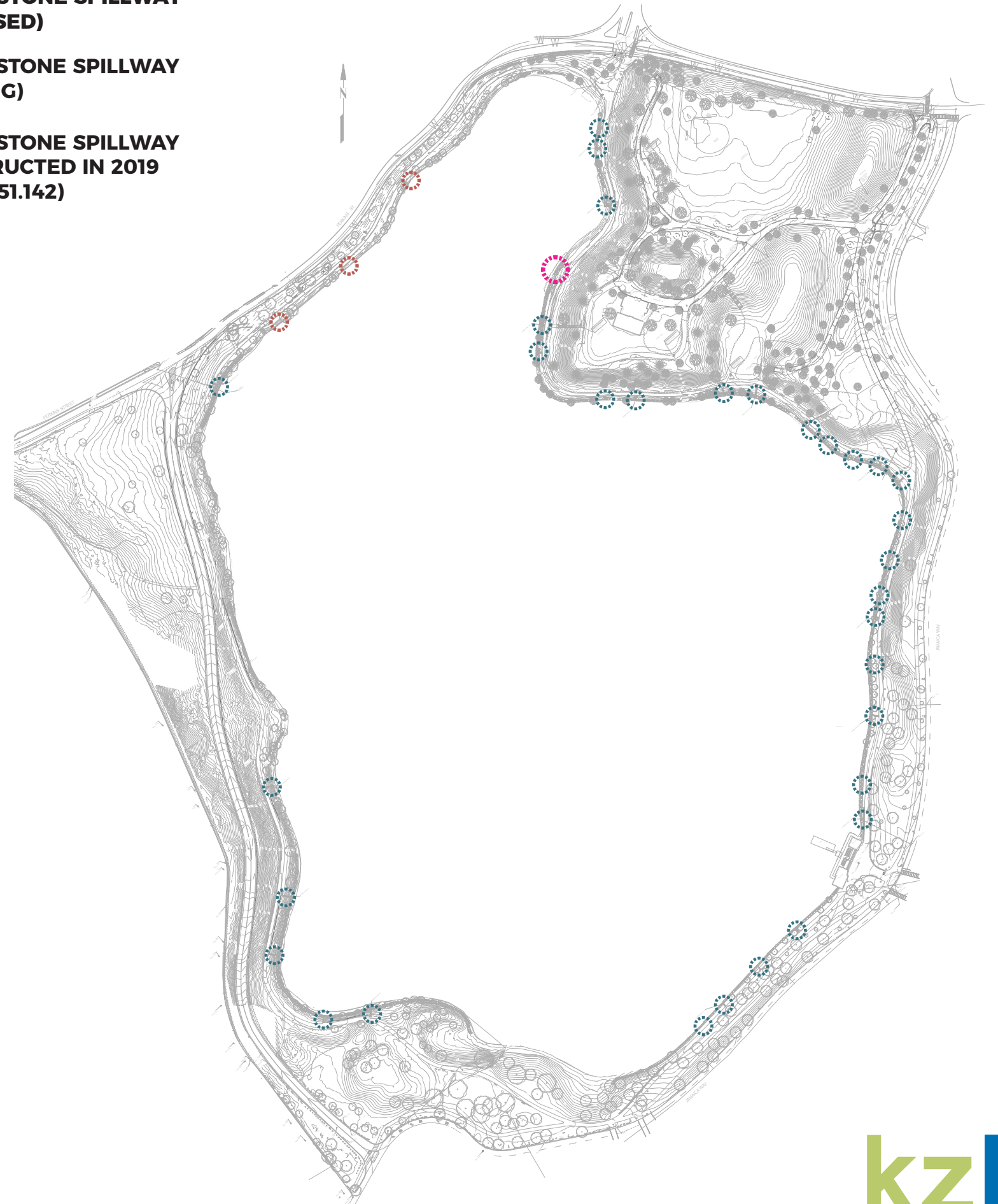

Jamaica Pond Park Pathways & Entrances: Phase 2 Additional Work

Jamaica Pond Park, Jamaica Plain

October 22, 2019

Cobblestone spillways at Jamaica Pond Park:



Example of an existing cobblestone spillway, prior to retrofit.



Example of a new cobblestone spillway under construction. Inlet with sediment trap in lower right. Proposed spillway would be constructed in the same way.



Location of proposed cobblestone spillway; Sediment shows evidence of puddling.



Example of a new cobblestone spillway nearing completion. Proposed spillway would be constructed in the same way.

Jamaica Pond Park Pathways & Entrances: Phase 2 Additional Work

Jamaica Pond Park, Jamaica Plain

October 22, 2019

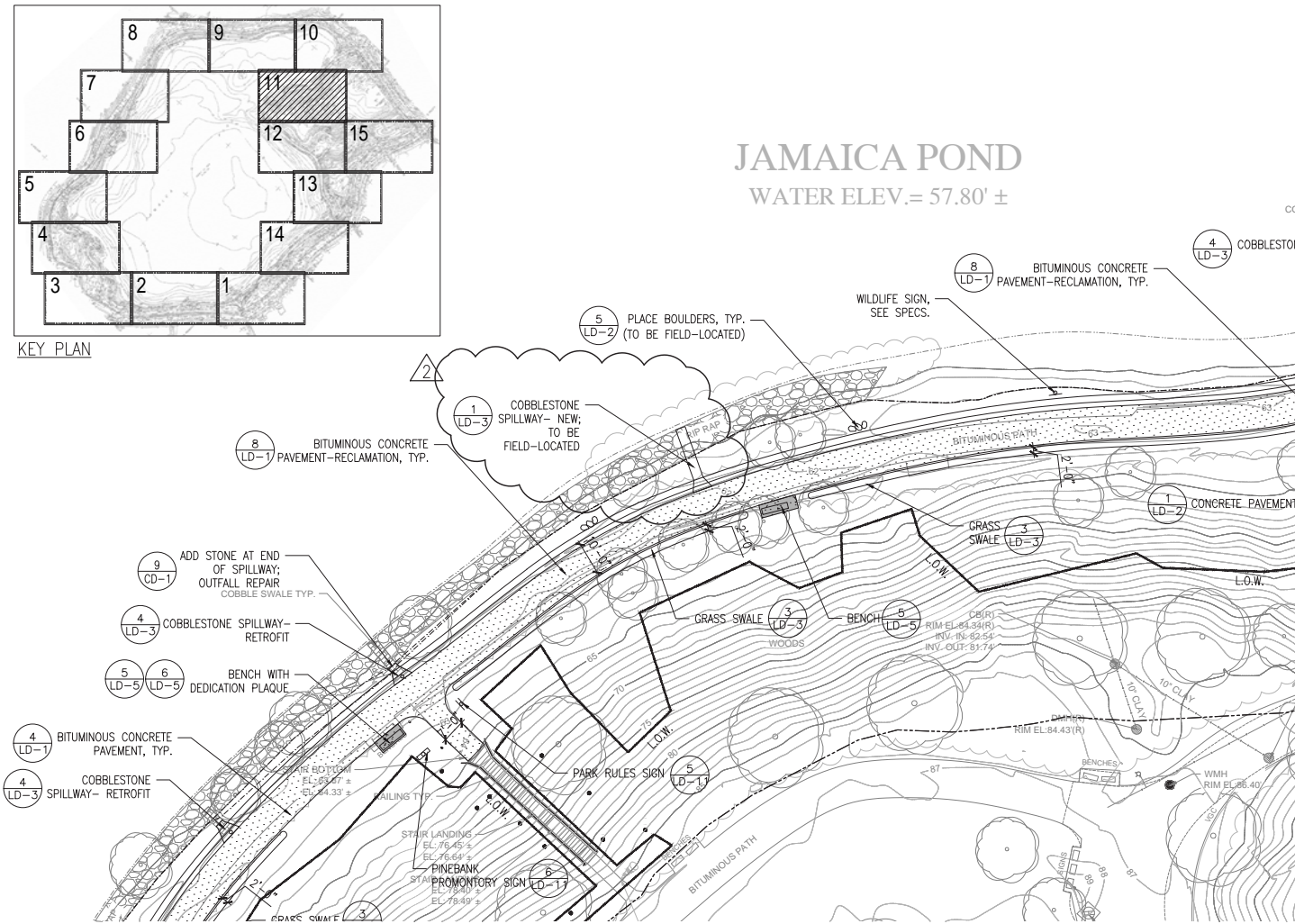

Location of proposed cobblestone spillway in NE corner of Jamaica Pond Park

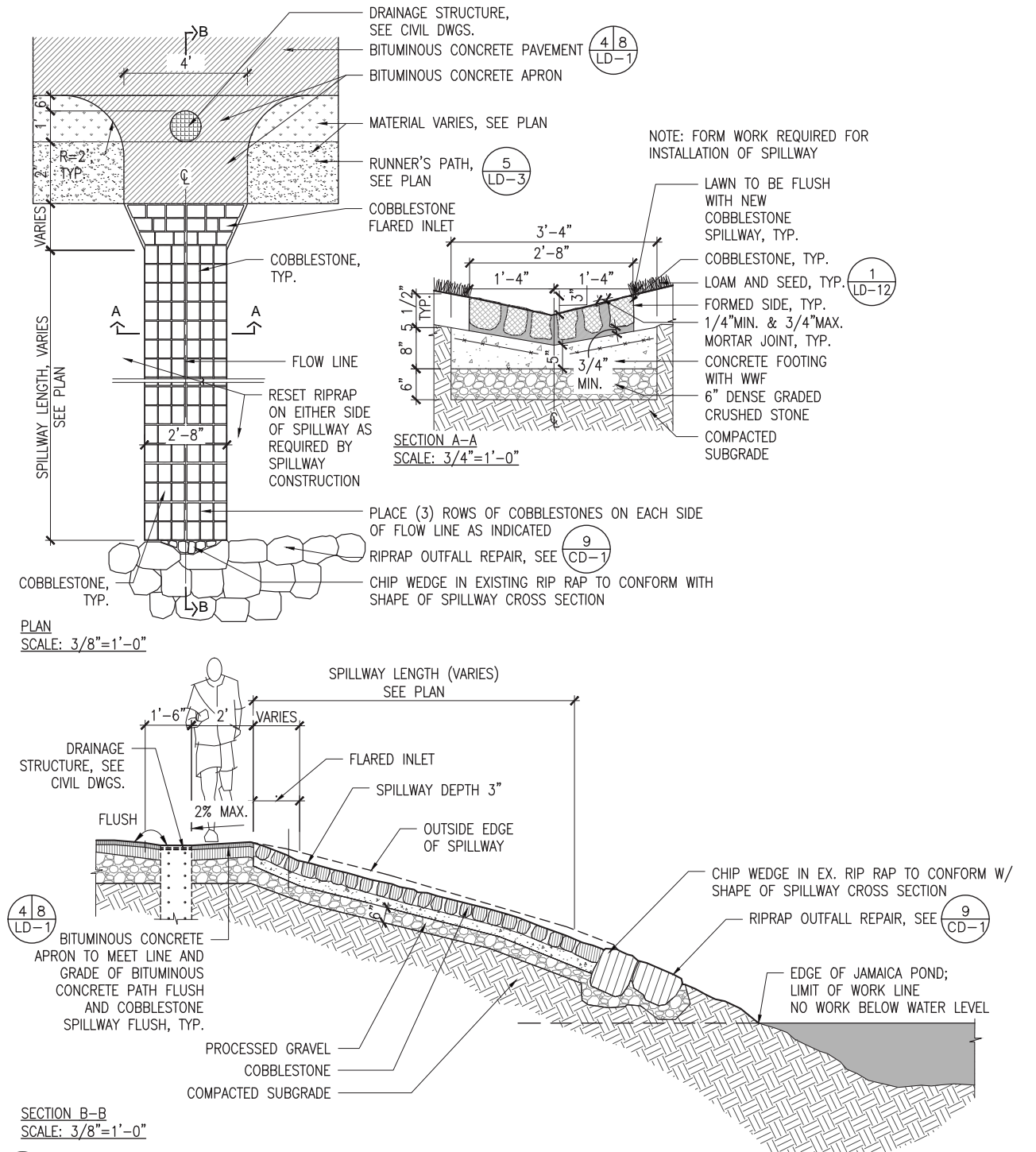

1 COBBLESTONE SPILLWAY
SCALE: 3/8" = 1'-0"

Construction detail for the proposed cobblestone spillway in NE corner of Jamaica Pond Park