



CONSULTANTS:

PROJECT:

**BCM GREEN ROOF**

308 CONGRESS ST.  
BOSTON, MA 02210

CLIENT:



**BOSTON CHILDREN'S MUSEUM**

308 CONGRESS ST.  
BOSTON, MA 02210



PREPARED BY A LICENSED ARCHITECT  
Any changes to this item can be a violation of the law unless altered by a licensed architect. Any alteration made to this item must be accompanied by a specific description of change or changes made; date change was made, as well as the seal of the licensed architect who made or oversaw the changes.

MARK	DATE	DESCRIPTION

05-7-21	ISSUED FOR CONSTRUCTION
---------	-------------------------

PROJECT NO.:	20022
DRAWN BY:	JK
CHECKED BY:	SAW
DRAWING SCALE:	AS NOTED

SHEET TITLE:  
**DEMO AND PROPOSED ROOF PLAN**

SHEET:  
**A-101**

DO NOT SCALE DRAWING

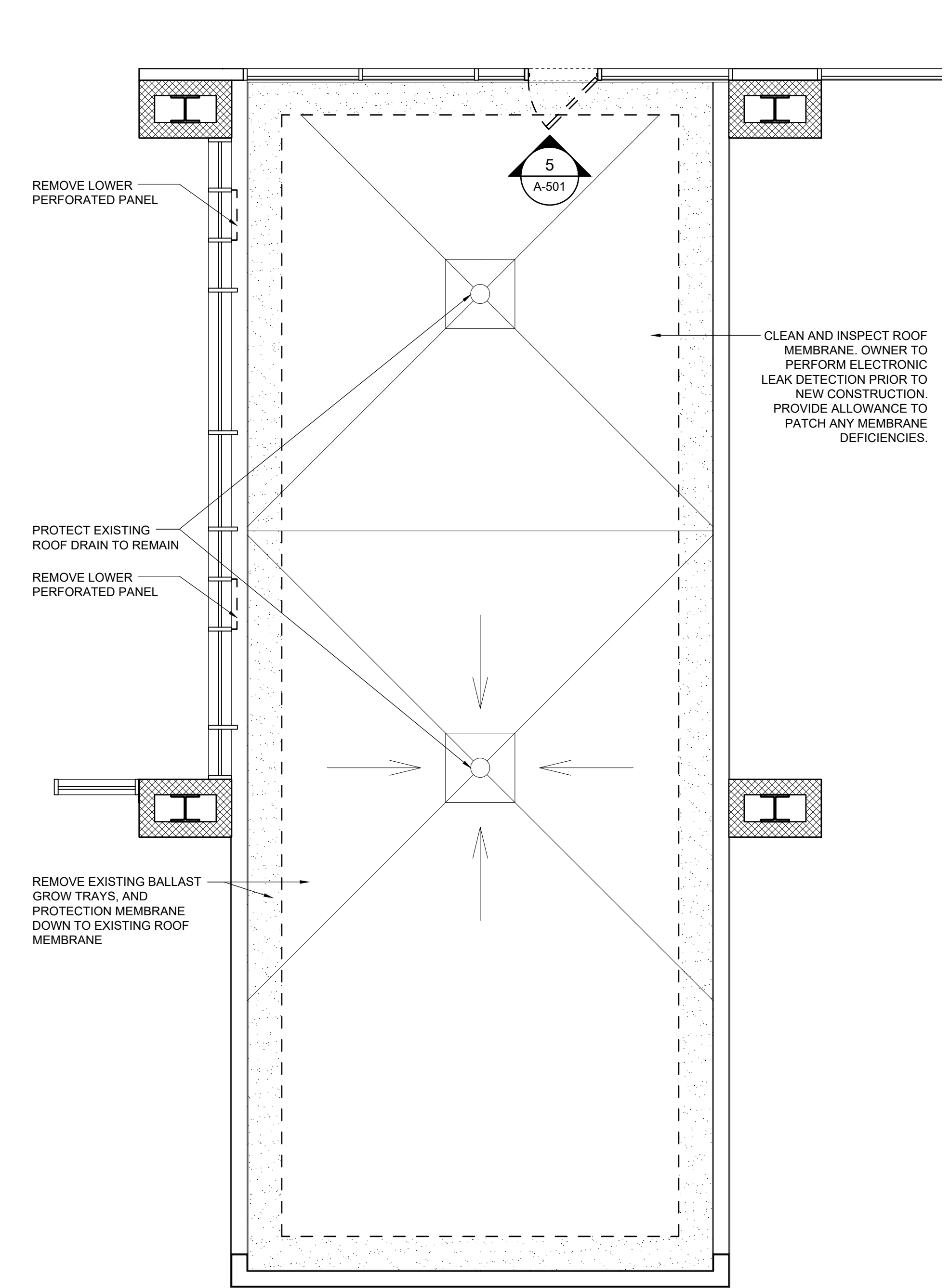

1 DEMO ROOF PLAN  
1/4"=1'-0"

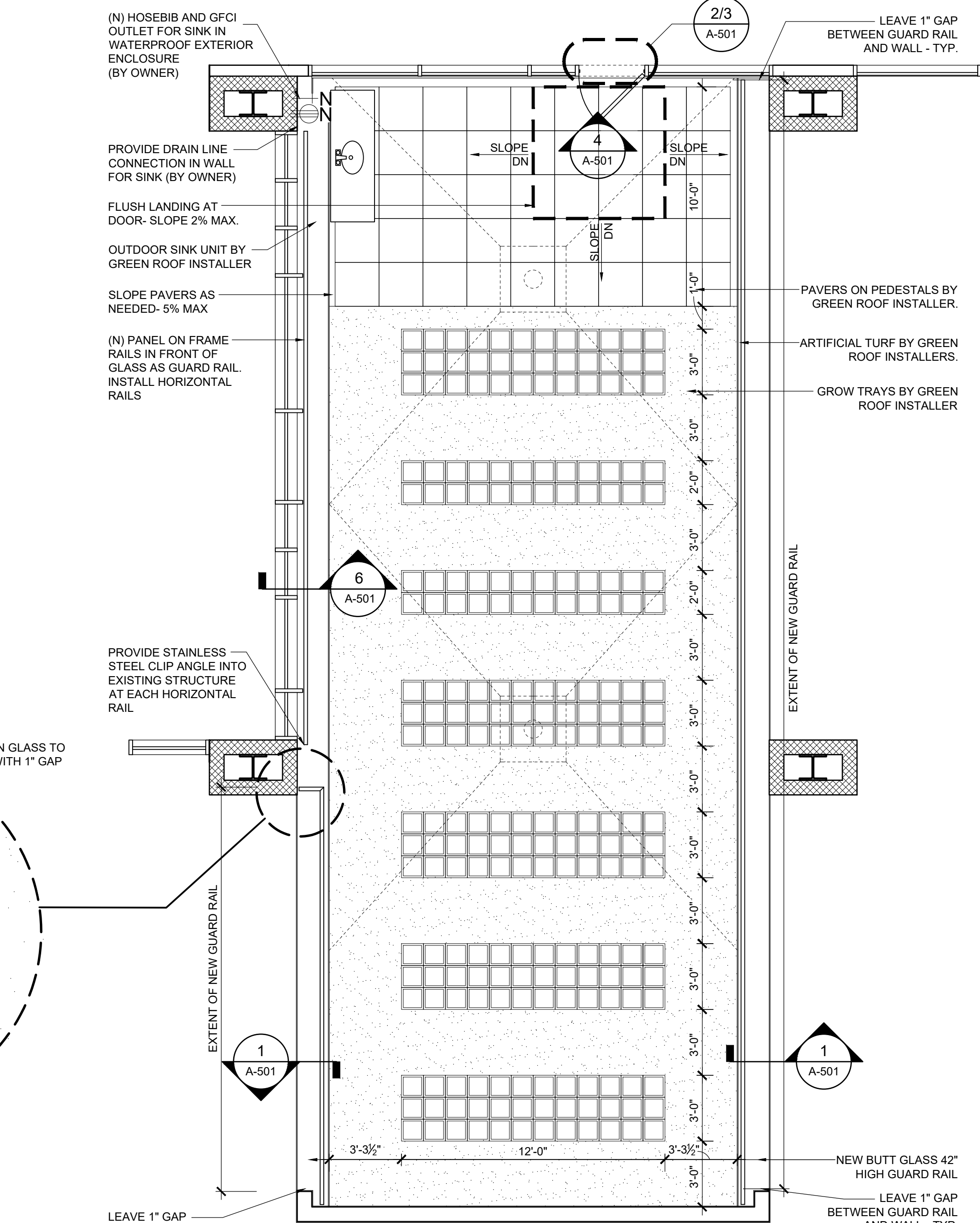

2 PROPOSED ROOF PLAN  
1/4"=1'-0"

COPYRIGHT © STEPHEN J. WESSLING ARCHITECTS INC. 2020

D:\projects\2022\11\_16\_2022\2022\_022 BCM Green Roof\2022\_A-101\_Demo and Proposed Roof Plan.dwg  
May 16, 2024 10:42:00  
User: j.wessling  
Xref: j.wessling\2022\_022 BCM Green Roof\2022\_A-101\_Demo and Proposed Roof Plan.dwg

PROJECT:  
**BCM GREEN ROOF**  
308 CONGRESS ST.  
BOSTON, MA 02210

CLIENT:  
  
**BOSTON CHILDREN'S MUSEUM**  
308 CONGRESS ST.  
BOSTON, MA 02210

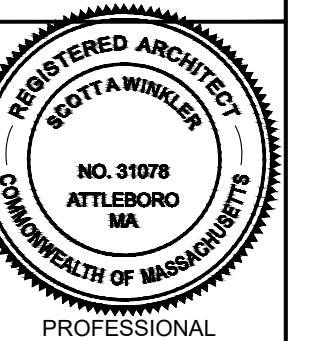

PREPARED BY A LICENSED ARCHITECT  
Any changes to this item can be a violation of the law unless altered by a licensed architect. Any alteration made to this item must be accompanied by a specific description of change or changes made; date change was made, as well as the seal of the licensed architect who made or oversaw the changes.

MARK	DATE	DESCRIPTION
05-7-21	ISSUED FOR CONSTRUCTION	

PROJECT NO.:	20022
DRAWN BY:	JK
CHECKED BY:	SAW
DRAWING SCALE:	AS NOTED

SHEET TITLE:  
**PROPOSED ROOF DETAILS**

SHEET:  
**A-501**  
DO NOT SCALE DRAWING

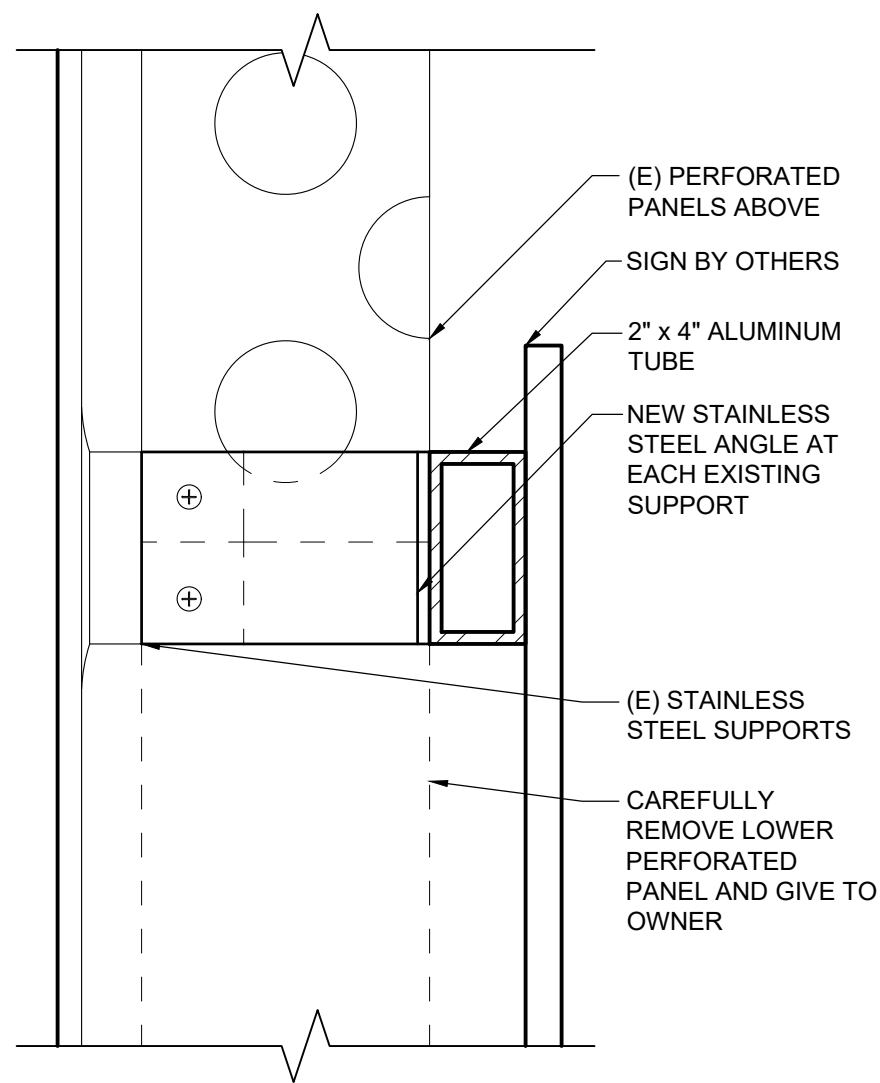

**6** SIGN ATTACHMENT DETAIL - TYP. FOR 3 RAILS  
3"=1'-0"

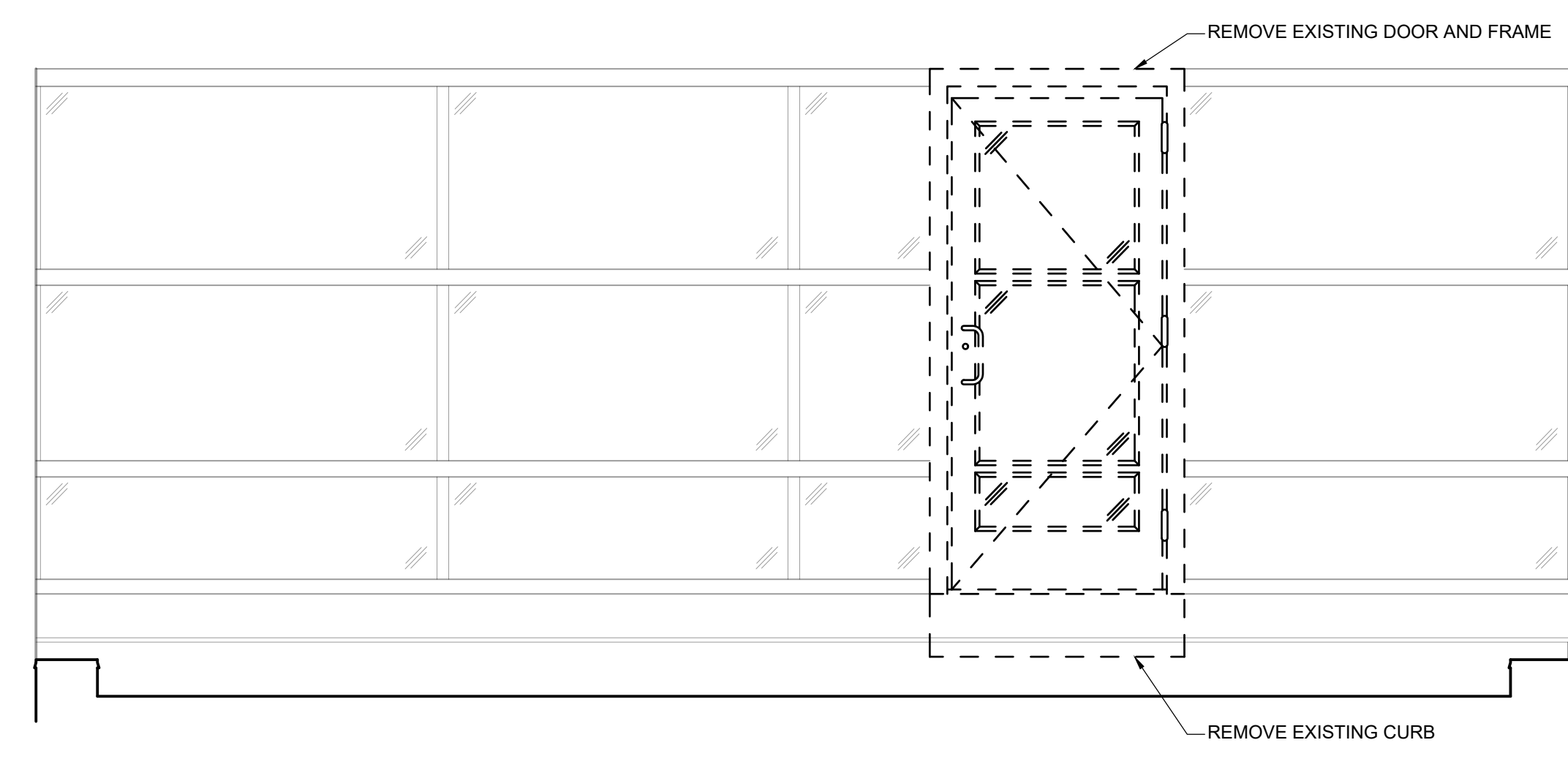

**5** EXISTING ELEVATION  
1/2" = 1'-0"

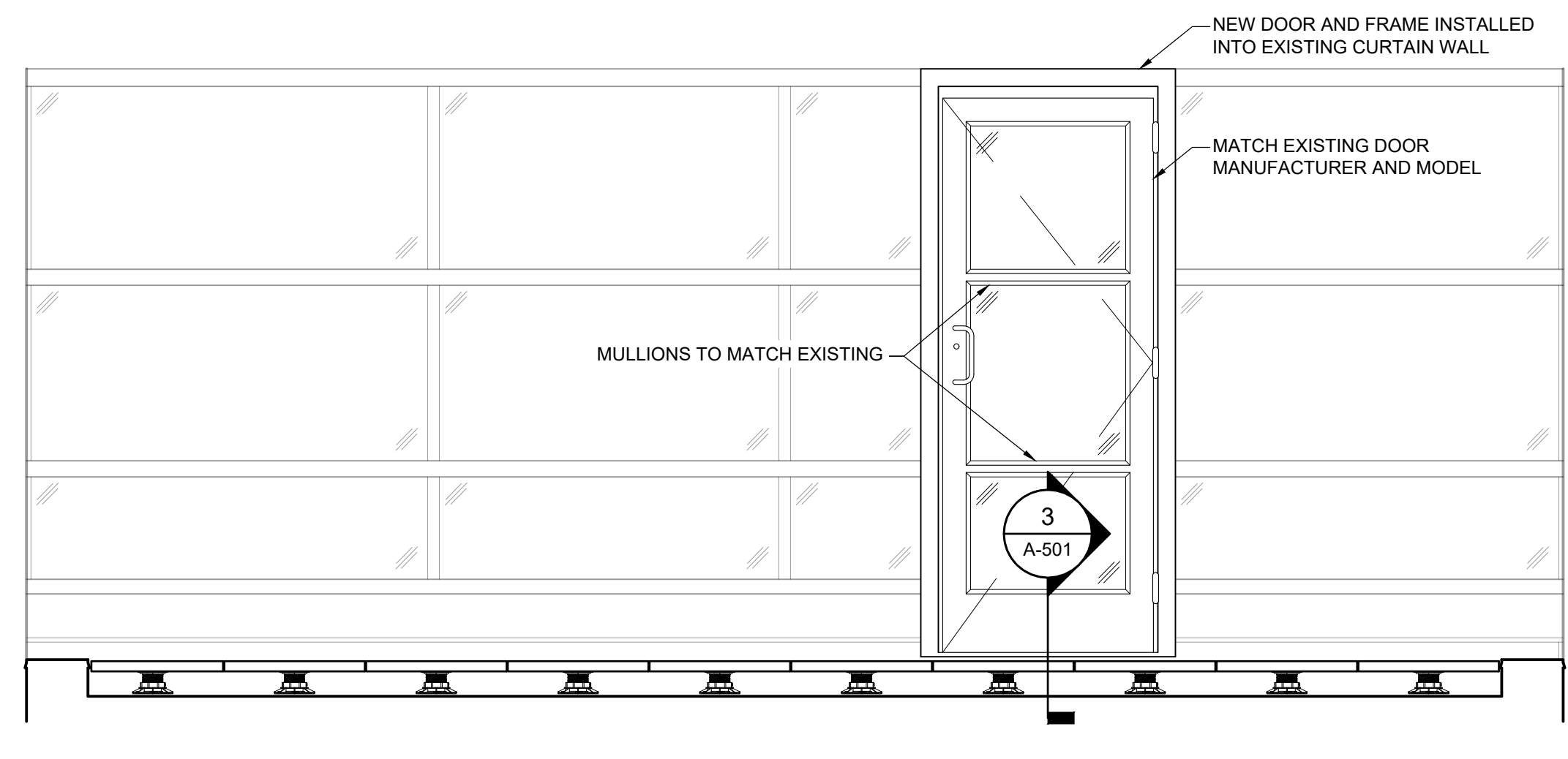

**4** PROPOSED ELEVATION  
1/2" = 1'-0"

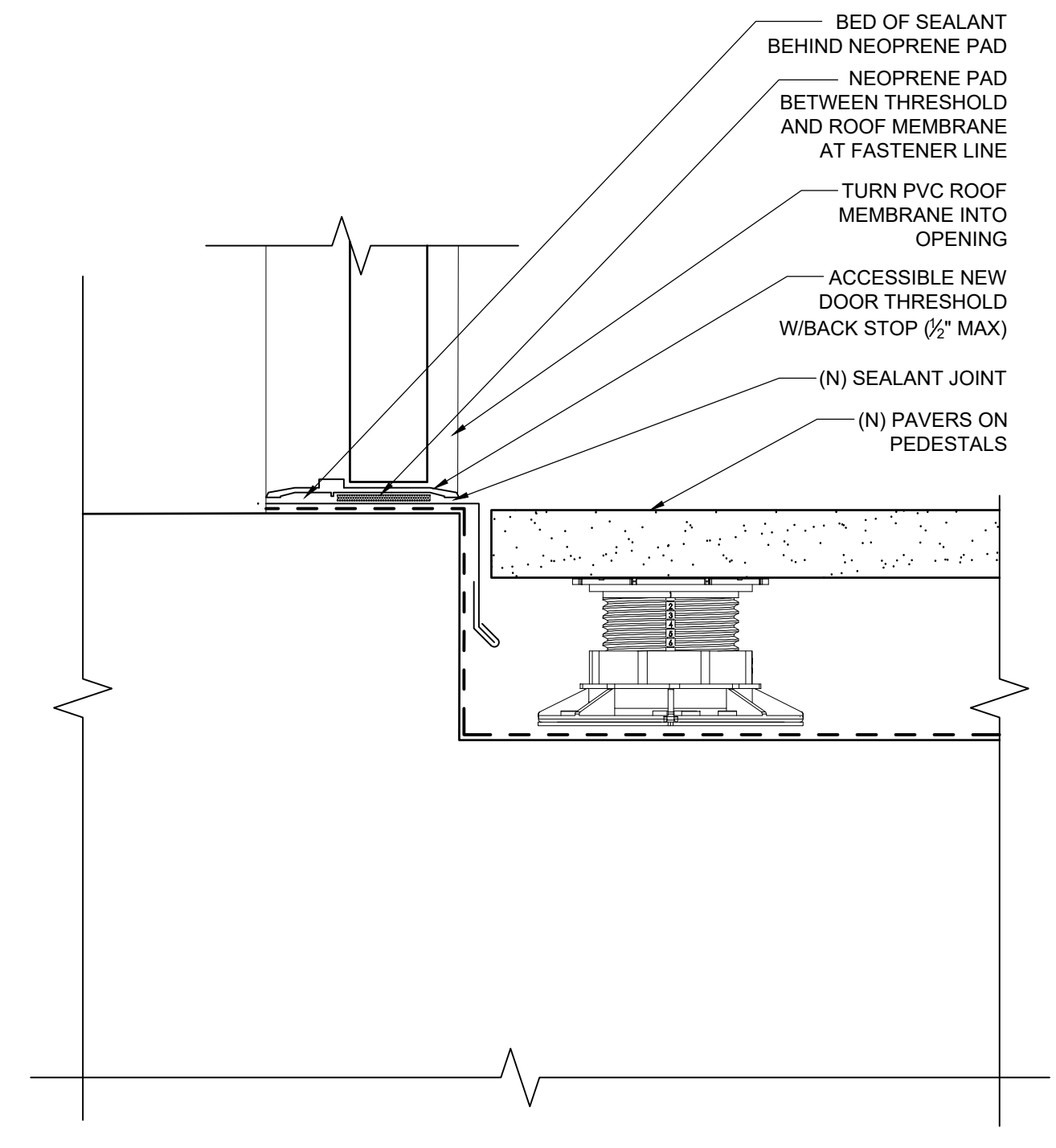

**3** SECTION AT DOOR THRESHOLD  
3"=1'-0"

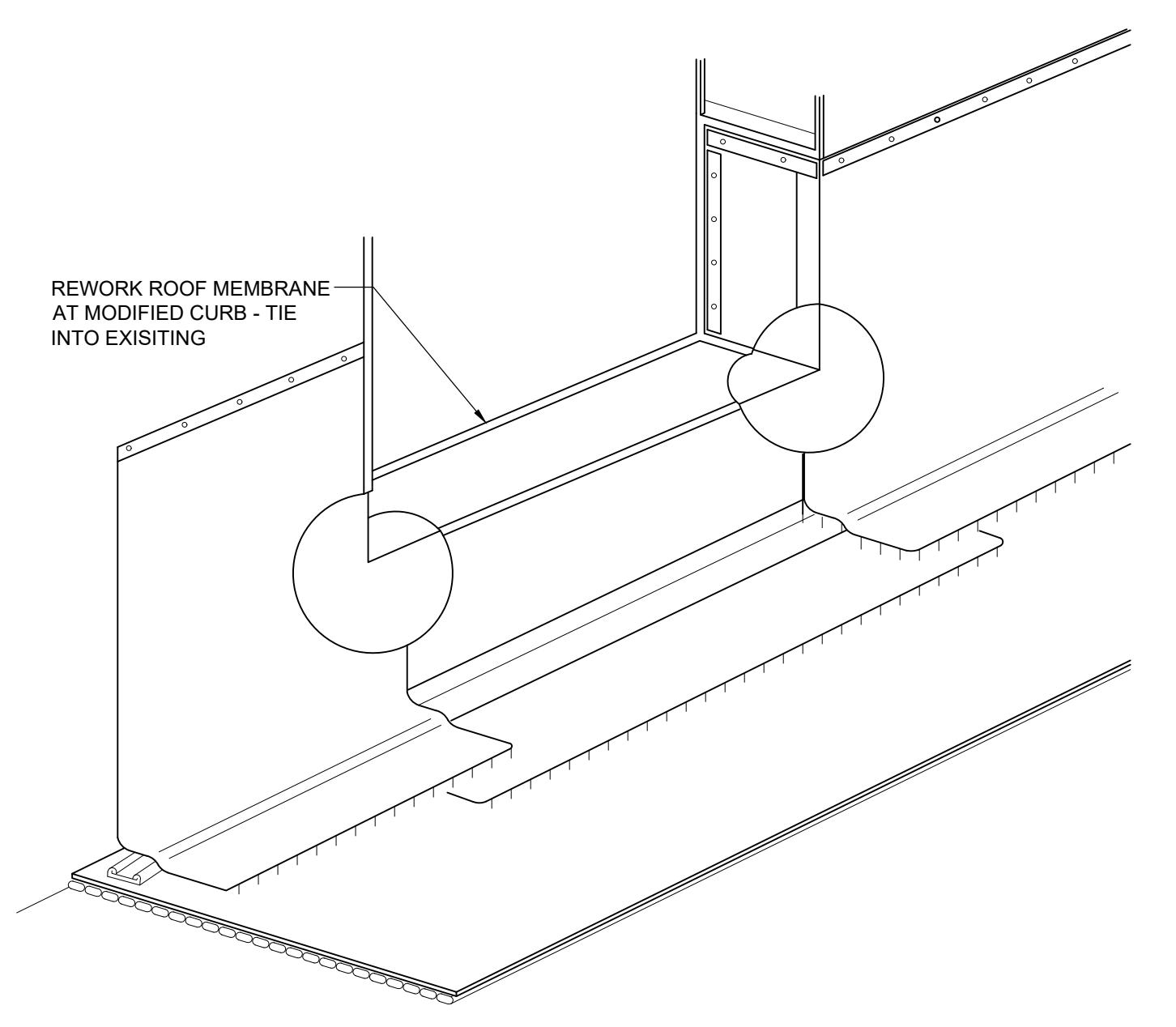

**2** ISOMETRIC AT DOOR THRESHOLD  
3"=1'-0"

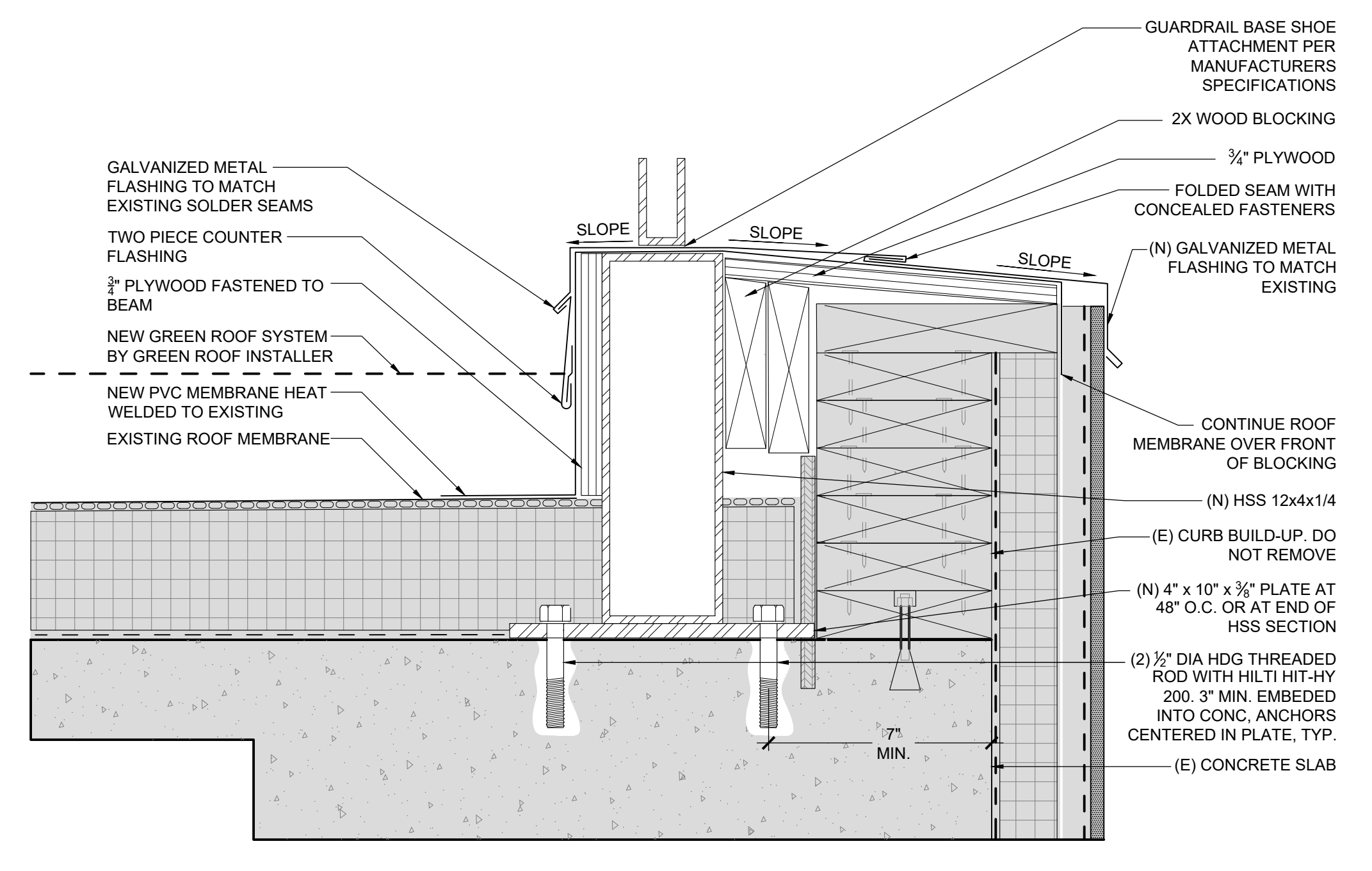

**1** GUARD RAIL DETAIL AT PARAPET  
3"=1'-0"

I:\Projects\2022\20022 - BCM Green Roof\Drawings\2022 A-501\_Proposed Details.dwg  
 May 06, 2024, 14:23:01  
 User: L1, Path: I:\Projects\2022\20022 - BCM Green Roof\Drawings\2022 A-501\_Proposed Details.dwg  
 Xref: I:\Projects\2022\20022 - BCM Green Roof\Drawings\2022 A-501\_Proposed Elevation.dwg

COPYRIGHT © STEPHEN J. WESSLING ARCHITECTS INC., 2020



Architect:  
 Architect  
 Address  
 T - 000-000-0000  
 F - 000-000-0000  
 www.website.com

General Contractor:  
 Owner  
 Address  
 T - 000-000-0000  
 F - 000-000-0000  
 www.website.com

Notes Relevant to This Sheet:

SUNRISE ERECTORS INC.



290 PINE ST. CANTON, MA, 02021  
 Phone: (781) 828 - 8814  
 Fax: (781) 828 - 8244  
 Fax2: (781) 828 - 7881  
 www.sunriseerectors.com

Shop Drawings

Details I

SEI Project Number: Project Number  
 Date: 05/04/21  
 Checked by: ..  
 Drawn by: ..  
 Scale: 6" = 1'-0"

4.00  
 of 3

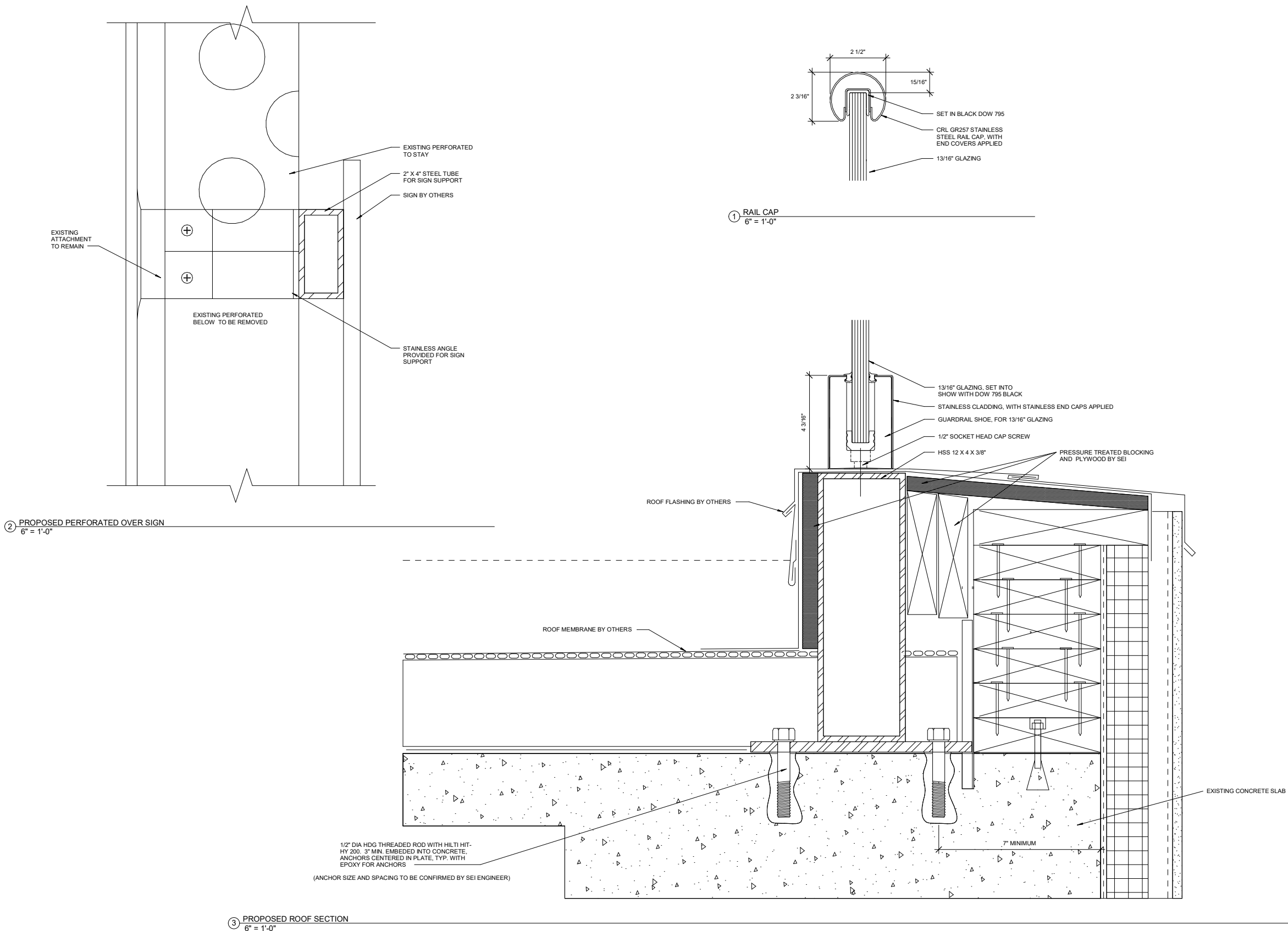

5/5/2021 4:01:08 PM F:\OFFICE EMPLOYEE FOLDERS\William.J.Habegger\BCM GreenRoof\BCM GreenRoof Revit.rvt

**Architect:**  
 Architect  
 Address  
 T - 000-000-0000  
 F - 000-000-0000  
 www.website.com

**General Contractor:**  
 Owner  
 Address  
 T - 000-000-0000  
 F - 000-000-0000  
 www.website.com

Notes Relevant to This Sheet:

SUNRISE ERECTORS INC.



290 PINE ST. CANTON, MA, 02021  
 Phone: (781) 828 - 8814  
 Fax: (781) 828 - 8244  
 Fax2: (781) 828 - 7881  
 www.sunriseerectors.com

**Shop Drawings**

**Railing Elevations**

SEI Project Number: Project Number  
 Date: 05/04/21  
 Checked by: ..  
 Drawn by: ..  
 Scale: As indicated

**3.00**  
 of 3

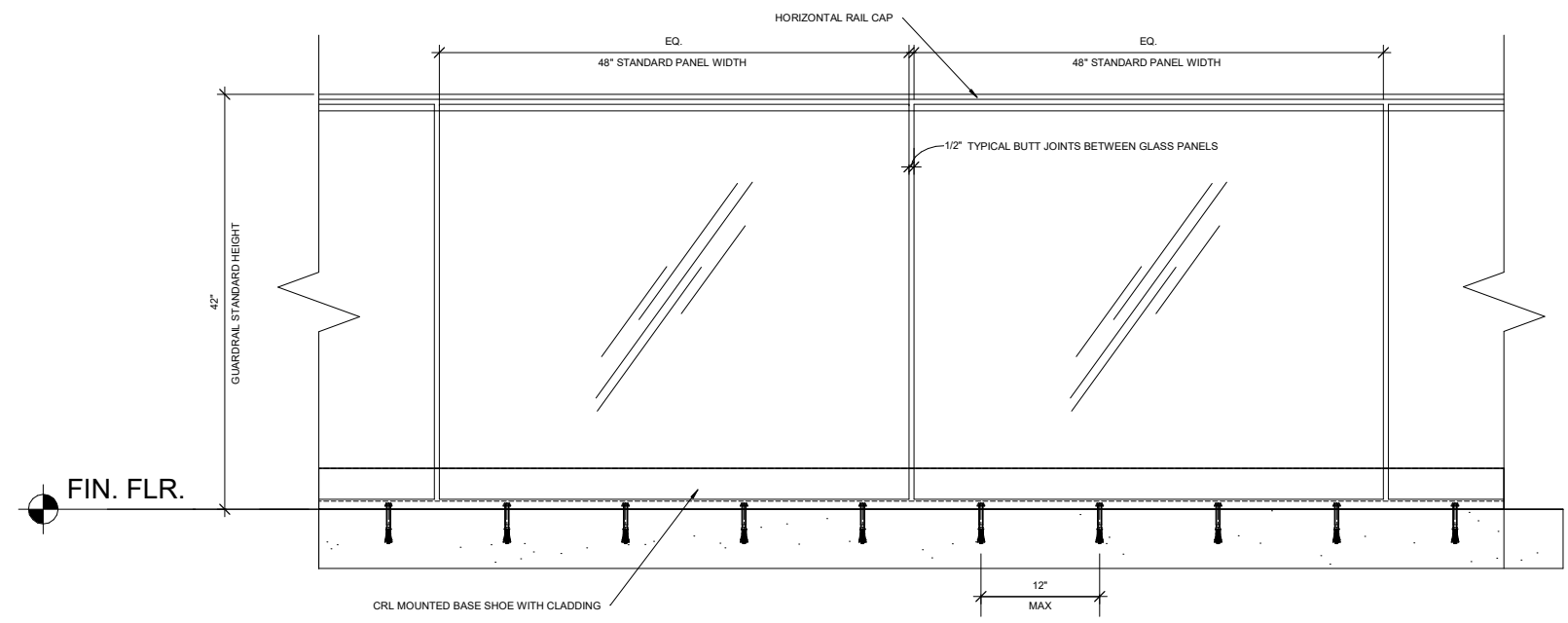

① RAILING TYPICAL ELEV.  
 1 1/2" = 1'-0"

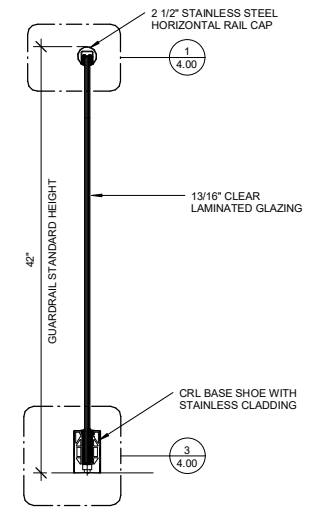

② RAIL SECTION  
 1 1/2" = 1'-0"

FULL RAIL ELEVATIONS TO BE VERIFIED  
 IN FIELD FOR ACCURATE SIZING; LAID  
 OUT AS TYPICAL 48" X 41" GLASS PANELS  
 WITH 1/2" JOINTS

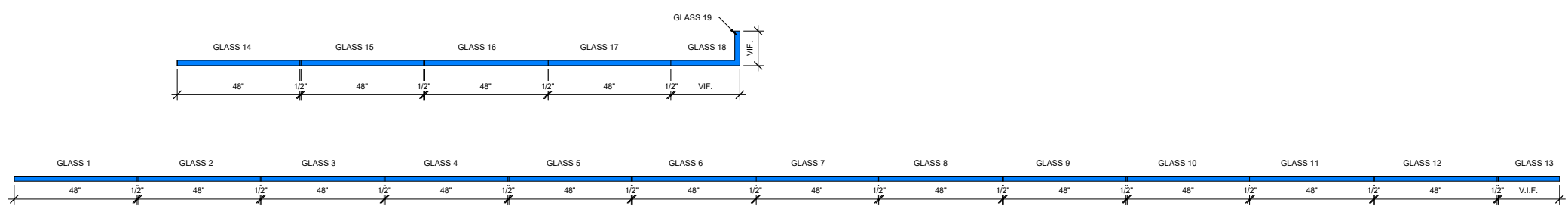

③ RAIL LAYOUTS  
 1/2" = 1'-0"

**Oldcastle BuildingEnvelope**  
 201 M Street  
 Perrysburg, OH 43551  
 800-537-4064  
 4/28/2021  
 ORDER #: 173301 1  
 CUST NAME: SUNRISE ERECTORS INC.  
 JOB NAME: CHILDREN'S MUSEUM  
 DESC: 3/8 CLEAR TEMP  
 .060 SENTRYGLAS INTERLAYER  
 3/8 CLEAR TEMP  
 ALL EDGES POLISHED  
 CHILDREN'S MUSEUM



**TRANSMITTAL LETTER**  
AIA DOCUMENT D819

**Sunrise Erectors, Inc.**  
290 Pine Street  
Canton, Ma 02021

Transmittal Number: 1  
Date: 04/29/2021  
Page 1 of 1

To:  
Wessling Architects  
1250 Hancock St Suite 815N  
Quincy, MA 02269  
Ahn Scott Walker

Job Site:  
Children's Museum Railing

Regarding:  
OBE Glass Guard Rail Samples

COPIES	DATE	DESCRIPTION
1	04/30/2021	OBE Tempered Laminated Glass 3/8" tempered X .060 SGP interlayer X 3/8" tempered
1	04/30/2021	CRL Guard Rail Aluminum Shoe finish sample
1	04/30/2021	CRL 2 1/2" Diameter Stainless Steel Cap Bolt sample
1	04/30/2021	CRL Stainless Steel Shoe Cladding

Remarks: \_\_\_\_\_

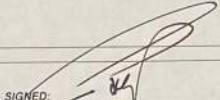
SIGNED:   
Chip Chisholm  
Sunrise Erectors, Inc.

