



423 Marlborough Street • Boston, MA 02115

February, 2022

Boston Conservation Commission  
Boston City Hall  
1 City Hall Square, Room 709  
Boston, MA 02201

Re: Request for Determination of Applicability for Tree Planting Project  
Applicant: Charlesgate Alliance

Dear Conservation Commission Members:

On behalf of the Charlesgate Alliance, I am pleased to submit this Request for Determination of Applicability for permission to plant 15 trees in Charlesgate Park.

Charlesgate Alliance plans to plant these trees in areas that will not be disturbed in the final construction of the new park. The new park design, which will come before you in the future, will incorporate storm water treatment as well as other feature which will address the health and viability of the Muddy River and the adjacent areas under your protection.

These 15 locations are in areas that will not be altered in the final design and will signal the first step, along with the wall removal project you recently approved, for the transformation of this long neglected area. This continues our long collaboration with the DCR and MASSDOT for the revitalization of this critical park connection and resource area.

We will be able plant these trees well within the three year period of this approval as funding allows. The work will be done with a DCR approved contractor that has previously done maintenance in the park and tree planting and is familiar with the strict compliance requirements of the Commission.

We look forward to discussing this project with you. Please feel free to call the undersigned at 917-359-4052 or write to [mpok384@gmail.com](mailto:mpok384@gmail.com) with any questions or to schedule a site visit.

Sincerely,

A handwritten signature in cursive script that reads "Margaret Pokorny".

Margaret Pokorny, Board Member, Charlesgate Alliance

Cc: DCR, Pricilla Geigis, Patrice Kish, Jennifer Norwood  
MMOC, Fran Gershwin

**REQUEST FOR DETERMINATION OF  
APPLICABILITY**

**PLANTING OF 15 TREES IN CHARLESGATE PARK**

Charlesgate Alliance

423 Marlborough St.

Boston, MA 02115

February, 2022

## **Table of Contents**

WPA Form 1-Request for Determination of Applicability(RDA)

Figure 1- Continuation of Work Description Narrative

Figure 2-USGS Locus Map

Figure 3-FEMA Flood Plain/BLSF/ Firmette

Figure 4-Site Map/Planting Plan Map

Figure 5-Planting specification

Figure 6-Two photographs of the Grove area looking north to Beacon and South along Charlesgate East

Figure 7-Conceptual map of Charlesgate Revitalization Plan showing the Grove area in upper right hand quadrant

Appendix B-Abutter Information

Abutter Information

Affidavit of Service

Notice to Abutters (English and Spanish)

Babel Notice

Certificate of Translation

List of Abutters

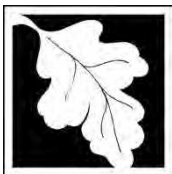

# WPA Form 1- Request for Determination of Applicability

Massachusetts Wetlands Protection Act M.G.L. c. 131, §40

## A. General Information

**Important:**

When filling out forms on the computer, use only the tab key to move your cursor - do not use the return key.

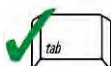

1. Applicant:

Charlesgate Alliance/ Margaret Pokorny \_\_\_\_\_ mpok384@gmail.com \_\_\_\_\_  
 Name E-Mail Address  
 423 Marlborough St. \_\_\_\_\_  
 Mailing Address  
 Boston \_\_\_\_\_ MA \_\_\_\_\_ 02215 \_\_\_\_\_  
 City/Town State Zip Code  
 917-359-4052 \_\_\_\_\_  
 Phone Number Fax Number (if applicable)

2. Representative (if any):

\_\_\_\_\_  
 Firm  
 \_\_\_\_\_  
 Contact Name E-Mail Address  
 \_\_\_\_\_  
 Mailing Address  
 \_\_\_\_\_  
 City/Town State Zip Code  
 \_\_\_\_\_  
 Phone Number Fax Number (if applicable)

## B. Determinations

1. I request the Boston \_\_\_\_\_ make the following determination(s). Check any that apply:  
 Conservation Commission

- a. whether the **area** depicted on plan(s) and/or map(s) referenced below is an area subject to jurisdiction of the Wetlands Protection Act.
- b. whether the **boundaries** of resource area(s) depicted on plan(s) and/or map(s) referenced below are accurately delineated.
- c. whether the **work** depicted on plan(s) referenced below is subject to the Wetlands Protection Act.
- d. whether the area and/or work depicted on plan(s) referenced below is subject to the jurisdiction of any **municipal wetlands ordinance** or **bylaw** of:

\_\_\_\_\_  
 Name of Municipality

- e. whether the following **scope of alternatives** is adequate for work in the Riverfront Area as depicted on referenced plan(s).

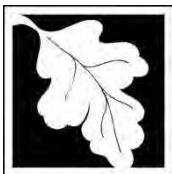

# WPA Form 1- Request for Determination of Applicability

Massachusetts Wetlands Protection Act M.G.L. c. 131, §40

## C. Project Description

1. a. Project Location (use maps and plans to identify the location of the area subject to this request):

Parkland bounded by Beacon St., Charlesgate East  
Commonwealth Avenue and Muddy River  
and small area near corner of Beacon and  
Charlesgate West

.Boston  
City/Town

Parcel/Lot Number

b. Area Description (use additional paper, if necessary):

The project is located within Charlesgate Park, a 10 acre site under and around the Bowker Overpass. The primary project area is a triangular area along the east side of the Muddy River bounded by the south side of Beacon St. and Charlesgate East. It is referred to as "The Grove" and is composed of a brick patio, paths, mature trees and turf, and is shown on the two attached photographs. The secondary project area is a very small area near the corner of Charlesgate West and the south side of Beacon St. composed of turf and some trees. Both planting areas are within the buffer zone. The location of two trees to be planted in the Grove are within the Riverfront area.

c. Plan and/or Map Reference(s):

Tree Planting Plan  
Title

5/12/ 2021  
Date

Title

Date

Title

Date

2. a. Work Description (use additional paper and/or provide plan(s) of work, if necessary):

The Applicant seeks a negative determination for the work, which consists of planting fifteen(15) trees, fourteen in the Grove and, one in the secondary project area. The species to be planted are all native to the area and are listed on the Tree Planting Map. The Grove contains mature Black Locust trees which the Applicant proposes to underplant with Birch trees and other native species. The planting locations and species selection are indicated on the Tree Planting Plan.

All of the new trees will be planted within the 100 foot buffer zone. Two trees in the Grove will be located within the Riverfront Area.

Prior to start of work, construction fencing will be installed around the work area and compost logs will be installed at the limits of the work to prevent sediment from entering the Muddy River. Spill containment equipment will be accessible in the event of fuel leakage from any equipment on site. Any disturbed areas will be restored to preplanting grades with loam and seeded with a lawn seed mixture. Compost logs will remain in place when work is completed until the disturbed area is stabilized and turf is re-established.

The proposed planting of 15 trees stands on its own as a project. It is not anticipated to have any adverse impact on wetland resource areas, and will actually enhance the resource areas. The planting is also part of a large public improvement project called the Charlesgate Revitalization Project.

CONTINUED IN ATTACHMENT FIGURE #2



**Massachusetts Department of Environmental Protection**

Bureau of Resource Protection - Wetlands

**WPA Form 1- Request for Determination of Applicability**

City/Town \_\_\_\_\_

Massachusetts Wetlands Protection Act M.G.L. c. 131, §40

---

**C. Project Description (cont.)**

b. Identify provisions of the Wetlands Protection Act or regulations which may exempt the applicant from having to file a Notice of Intent for all or part of the described work (use additional paper, if necessary).

310CMR 10.02(2)(b)2,d--Plantings of native species of trees, shrubs, or groundcover, but excluding turf lawns. Work is a minor activity within the buffer zone and not subject to regulation under the act.

The planting of new trees we believe to be a Resource Area Enhancement and is in line with this over all goal as well as a climate resilience measure. The planting of new trees is a climate resilient measure as trees improve both air and water quality, prevent erosion, lower air temperature, and provide wildlife habitat.

3. a. If this application is a Request for Determination of Scope of Alternatives for work in the Riverfront Area, indicate the one classification below that best describes the project.

- Single family house on a lot recorded on or before 8/1/96
- Single family house on a lot recorded after 8/1/96
- Expansion of an existing structure on a lot recorded after 8/1/96
- Project, other than a single-family house or public project, where the applicant owned the lot before 8/7/96
- New agriculture or aquaculture project
- Public project where funds were appropriated prior to 8/7/96
- Project on a lot shown on an approved, definitive subdivision plan where there is a recorded deed restriction limiting total alteration of the Riverfront Area for the entire subdivision
- Residential subdivision; institutional, industrial, or commercial project
- Municipal project
- District, county, state, or federal government project
- Project required to evaluate off-site alternatives in more than one municipality in an Environmental Impact Report under MEPA or in an alternatives analysis pursuant to an application for a 404 permit from the U.S. Army Corps of Engineers or 401 Water Quality Certification from the Department of Environmental Protection.

b. Provide evidence (e.g., record of date subdivision lot was recorded) supporting the classification above (use additional paper and/or attach appropriate documents, if necessary.)

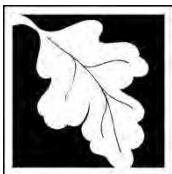

# WPA Form 1- Request for Determination of Applicability

Massachusetts Wetlands Protection Act M.G.L. c. 131, §40

## D. Signatures and Submittal Requirements

I hereby certify under the penalties of perjury that the foregoing Request for Determination of Applicability and accompanying plans, documents, and supporting data are true and complete to the best of my knowledge.

I further certify that the property owner, if different from the applicant, and the appropriate DEP Regional Office were sent a complete copy of this Request (including all appropriate documentation) simultaneously with the submittal of this Request to the Conservation Commission.

Failure by the applicant to send copies in a timely manner may result in dismissal of the Request for Determination of Applicability.

Name and address of the property owner:

Pricilla Geigis, Deputy Commissioner, DCR. (Patrice Kish and Jennifer Norwood, DCR contacts)

Name

251 Causeway St. Ste 600

Mailing Address

Boston

City/Town

MA

State

02214

Zip Code

Signatures:

I also understand that notification of this Request will be placed in a local newspaper at my expense in accordance with Section 10.05(3)(b)(1) of the Wetlands Protection Act regulations.

Margaret Pokorny

Signature of Applicant

Feb. 2022

Date

\_\_\_\_\_  
Signature of Representative (if any)

\_\_\_\_\_  
Date

## **Addenda to Figure 1 Narrative**

### **RDA Application of Charlesgate Alliance for Tree Planting**

#### **PLANTING**

Prior to planting coir rolls will be placed along the river bank from Beacon St. to a point at least 10 feet past the last planting location. These will remain in place until the restored turf areas around the new trees are established. The trees will be staked and gators will be placed on the stakes to facilitate watering for the first two years after planting. It is our intention to plant one tree at a time. Most of these holes will be dug by hand. There will be no stockpiling of excavated soil from the planting holes to be stockpiled overnight. If there is any excess soil after the holes are backfilled DCR has asked that it be spread in any depressed areas on site and not removed. The excavated soil will be temporarily stored on a non-permeable tarp alongside the planting site while the new tree is placed in the hole. All wires on the root ball will be removed.

The new tree locations will be added to the Tree Inventory Data base which is kept by the Emerald Necklace Conservancy (ENC). Maintenance will be continued by both ENC and the Charlesgate Alliance and the cost of replacement should any of the plantings fail will be covered by CA. Their condition will be checked, monitored, and duly recorded in the tree inventory data base along with the other new plantings in the Emerald Necklace. The trees will be under a two-year guarantee by the landscape contractor. Watering will be done either by an arrangement with the Landscape Contractor or included in the new watering program which the ENC will have in place this spring.

#### **PLANTING LOCATIONS**

There are 15 new planting locations being presented. All of these locations are in areas that will not be disturbed when the final park design is installed. The locations are all within in the 100' buffer zone adjacent to the Muddy River between Beacon Street and Commonwealth Avenue, all but one on the east side of the Muddy River.

12 locations are in an area called the Grove. This is a planting of mature Black Locust trees in the area at the corner of Beacon St. and Charlesgate East. They are all beyond the 25' limit of the riverfront area. Two additional trees are within the 25' limit and are in the Top of Bank area. One location is on the west side of the river along Charlesgate West. This location is also just within the 100' buffer zone.

#### **SPECIES SELECTION**

All species selected are from an approved list of Native Species. This list has also been approved by DCR. *Acer rubrum*, *Amalanchier canadensis*, *Betula alleghaniensis*, *Cercis canadensis*, *Fagus grandifolia*, *Nyssa sylvatica*, *Quercus bicolor* are the varieties. The planting location for each species is indicated on the map included in this application.



FIGURE 1- CONTINUATION OF WORK DESCRIPTION NARRATIVE 2a.

The trees will be planted by a backhoe where the locations can be reached from the paved patio and path areas. All other trees will be planted by hand.

Best practices will be followed including:

- \*Fully biodegradable controls around any loose material stockpiles(like soil)
- \*Fully biodegradable controls along the edge of the river
- \*Tree protection BMP for existing trees including trees and root zone
- \*Ground protection BMP to minimize compaction

DCR has requested that should there be any excess soil following the planting that that material be used to fill in sinkholes or uneven areas nearby and not removed from the site. Should there be any unusable stones those would be removed from the site by the contractor.

No trees will be planted in the flood plain. See attached FEMA Flood Plain/BLSF/Firmette map.

Tree planting locations for the 15 trees were determined by the project's landscape architect, Landing Studio, as locations that will not be disturbed when the final park design, which is being developed with the DCR, is installed. There will be more than 100 new trees planted as part of this final design, but these 15 will already be well established by the time that occurs. The Commission has recently reviewed the DCR's proposal to remove two non-structural walls under the Bowker, which is also part of the total revitalization project. The masterplan for this site which is still in development is included in this packet. In due course this will all be coming before the Boston Conservation Commission.

## **CLIMATE RESILIENCY**

The benefits of the Urban Forest have been widely discussed and appreciated as more attention is paid to climate change. When this park vision is completed, there will be more than 100 new trees added to this this particular urban forest. These 15 are just the beginning. While much research has come forward about the social benefits of trees with regard to mental and physical health and crime rates there has been also been documentation regarding other benefits. Carbon sequestration is one of the most important functions of a healthy tree canopy. The impact on the heat islands in urban areas is another important feature. Shade can reduce energy costs as well as reducing the solar radiation reflected back into the environment. Urban trees can help mitigate storms and flooding by catching rain in their canopies and increasing the infiltration rate during rain event. This also relieves pressure on sewer systems by limiting the hazardous combined sewer overflows. In the case of Charlesgate trees help prevent erosion and infiltration into the Muddy River.



**Charlesgate Park**  
Between Charlesgate East & Charlesgate West,  
and Beacon St & Commonwealth Avenue,  
Boston MA

**NOTES TO USERS**

This map is for use in administering the National Flood Insurance Program. It does not necessarily identify all areas subject to flooding, particularly from local drainage sources of small size. The community map repository should be consulted for possible updated or additional flood hazard information.

To obtain more detailed information in areas where **Base Flood Elevations (BFEs)** and/or **floodways** have been determined, users are encouraged to consult the Flood Profiles and Floodway Data and/or Summary of Stillwater Elevations tables contained within the Flood Insurance Study (FIS) Report that accompanies this FIRM. Users should be aware that BFEs shown on the FIRM represent rounded whole-foot elevations. These BFEs are intended for flood insurance rating purposes only and should not be used as the sole source of flood elevation information. Accordingly, flood elevation data presented in the FIS Report should be utilized in conjunction with the FIRM for purposes of construction and/or floodplain management.

**Coastal Base Flood Elevations** shown on this map apply only landward of 0' North American Vertical Datum of 1988 (NAVD 88). Users of this FIRM should be aware that coastal flood elevations are also provided in the Summary of Stillwater Elevations table in the Flood Insurance Study Report for this jurisdiction. Elevations shown in the Summary of Stillwater Elevations table should be used for construction and/or floodplain management purposes when they are higher than the elevations shown on this FIRM.

Boundaries of the **floodways** were computed at cross sections and interpolated between cross sections. The floodways were based on hydraulic considerations with regard to requirements of the National Flood Insurance Program. Floodway widths and other pertinent floodway data are provided in the Flood Insurance Study Report for this jurisdiction.

The AE Zone category has been divided by a **Limit of Moderate Wave Action (LIMWA)**. The LIMWA represents the approximate landward limit of the 1.5-foot breaking wave. The effects of wave hazards between the VE Zone and the LIMWA (or between the shoreline and the LIMWA for areas where VE Zones are not identified) will be similar to, but less severe than those in the VE Zone.

Certain areas not in Special Flood Hazard Areas may be protected by **flood control structures**. Refer to Section 2.4 "Flood Protection Measures" of the Flood Insurance Study Report for information on flood control structures for this jurisdiction.

The **projection** used in the preparation of this map was Massachusetts State Plane Mainland Zone (FIPS zone 2001). The **horizontal datum** was NAD 83, GRS 1980 spheroid. Differences in datum, spheroid, projection or UTM zones used in the production of FIRMs for adjacent jurisdictions may result in slight positional differences in map features across jurisdiction boundaries. These differences do not affect the accuracy of this FIRM.

Flood elevations on this map are referenced to the North American Vertical Datum of 1988. These flood elevations must be compared to structure and ground elevations referenced to the same vertical datum. For information regarding conversion between the National Geodetic Vertical Datum of 1929 and the North American Vertical Datum of 1988, visit the National Geodetic Survey website at <http://www.ngs.noaa.gov> or contact the National Geodetic Survey at the following address:

NGS Information Services  
NOAA, NNGS12  
National Geodetic Survey  
SSMC-3, #9202  
1315 East-West Highway  
Silver Spring, Maryland 20910-3282  
(301) 713-3242

To obtain current elevation, description, and/or location information for **bench marks** shown on this map, please contact the Information Services Branch of the National Geodetic Survey at (301) 713-3242, or visit its website at <http://www.ngs.noaa.gov>.

**Base map** information shown on this FIRM is derived from Massachusetts Geographic Information System (MassGIS) digital ortho-photography produced at 45 centimeter (2005) and 30 centimeter (2008) resolution. Aerial photography is dated Spring 2005 and Spring 2008.

The **profile baselines** depicted on this map represent the hydraulic modeling baselines that match the flood profiles in the FIS report. As a result of improved topographic data, the **profile baseline**, in some cases, may deviate significantly from the channel centerline or appear outside the SFHA.

Based on updated topographic information, this map reflects more detailed and up-to-date **stream channel configurations** and **floodplain delineations** than those shown on the previous FIRM for this jurisdiction. As a result, the Flood Profiles and Floodway Data Tables for multiple streams in the Flood Insurance Study Report (which contains authoritative hydraulic data) may reflect stream channel distances that differ from what is shown on the map. Also, the road to floodplain relationships for unrevised streams may differ from what is shown on previous maps.

**Corporate limits** shown on this map are based on the best data available at the time of publication. Because changes due to annexations or de-annexations may have occurred after this map was published, map users should contact appropriate community officials to verify current corporate limit locations.

Please refer to the separately printed **Map Index** for an overview map of the county showing the layout of map panels, community map repository addresses, and a Listing of Communities table containing National Flood Insurance Program dates for each community as well as a listing of the panels on which each community is located.

For information on available products associated with this FIRM visit the **Map Service Center (MSC)** website at <http://msc.fema.gov>. Available products may include previously issued Letters of Map Change, a Flood Insurance Study Report, and/or digital versions of this map. Many of these products can be ordered or obtained directly from the MSC website.

If you have **questions about this map**, how to order products, or the National Flood Insurance Program in general, please call the **FEMA Map Information eXchange (FMIX)** at 1-877-FEMA-MAP (1-877-336-2627) or visit the FEMA website at <http://www.fema.gov/business/nfp>.

Only coastal structures that are certified to provide protection from the 1-percent-annual-chance flood are shown on this panel. However, all structures taken into consideration for the purpose of coastal flood hazard analysis and mapping are present in the DFIRM database in S\_Gen\_Struct.



**LEGEND**

- SPECIAL FLOOD HAZARD AREAS (SFHAs) SUBJECT TO INUNDATION BY THE 1% ANNUAL CHANCE FLOOD. The 1% annual chance flood (100-year flood), also known as the base flood, is the flood area that has a 1% chance of being equaled or exceeded in any given year. The Special Flood Hazard Area is the area subject to flooding by the 1% annual chance flood. Areas of Special Flood Hazard include Zones A, AE, AH, AO, AR, AV, and VE. The Base Flood Elevation is the water-surface elevation of the 1% annual chance flood.
  - ZONE A** No Base Flood Elevations determined.
  - ZONE AE** Base Flood Elevations determined.
  - ZONE AH** Flood depths of 1 to 3 feet (usually areas of ponding); Base Flood Elevations determined.
  - ZONE AO** Flood depths of 1 to 3 feet (usually sheet flow on sloping terrain); average depths determined. For areas of alluvial fan flooding, velocities also determined.
  - ZONE AR** Special Flood Hazard Areas formerly protected from the 1% annual chance flood by a flood control system that was subsequently described. Zone AR indicates that the former flood control system is being restored to provide protection from the 1% annual chance or greater flood.
  - ZONE AR9** Area to be protected from 1% annual chance flood by a Federal flood protection system under construction; no Base Flood Elevations determined.
  - ZONE AV** Coastal flood zone with velocity hazard (wave action); no Base Flood Elevations determined.
  - ZONE VE** Coastal flood zone with velocity hazard (wave action); Base Flood Elevations determined.
  - FLOODWAY AREAS IN ZONE AE
- The floodway is the channel of a stream plus any adjacent floodplain areas that must be kept free of encroachment that the 1% annual chance flood can be carried without substantial increases in flood heights.
- OTHER FLOOD AREAS**
  - ZONE X** Areas of 0.2% annual chance flood; areas of 1% annual chance flood with average depths of less than 1 foot or with drainage areas less than 1 square mile; and areas protected by levees from 1% annual chance flood.
  - OTHER AREAS**
  - ZONE X** Areas determined to be outside the 0.2% annual chance floodplain.
  - ZONE D** Areas in which flood hazards are undetermined, but possible.
  - COASTAL BARRIER RESOURCES SYSTEM (CBRS) AREAS
  - OTHERWISE PROTECTED AREAS (OPAs)
- CBRS areas and OPAs are normally located within or adjacent to Special Flood Hazard Areas.
- 1% Annual Chance Floodplain Boundary
  - 0.2% Annual Chance Floodplain Boundary
  - Floodway boundary
  - Zone D boundary
  - CBRS and OPA boundary
  - Boundary dividing Special Flood Hazard Area Zones and boundary dividing Special Flood Hazard Areas of different Base Flood Elevations, flood depths, or flood velocities.
  - Limit of Moderate Wave Action
  - Limit of Moderate Wave Action coincident with Zone Break
  - Base Flood Elevation line and value; elevation in feet\*
  - Base Flood Elevation value where uniform within zone; elevation in feet\*
- \*Referenced to the North American Vertical Datum of 1988

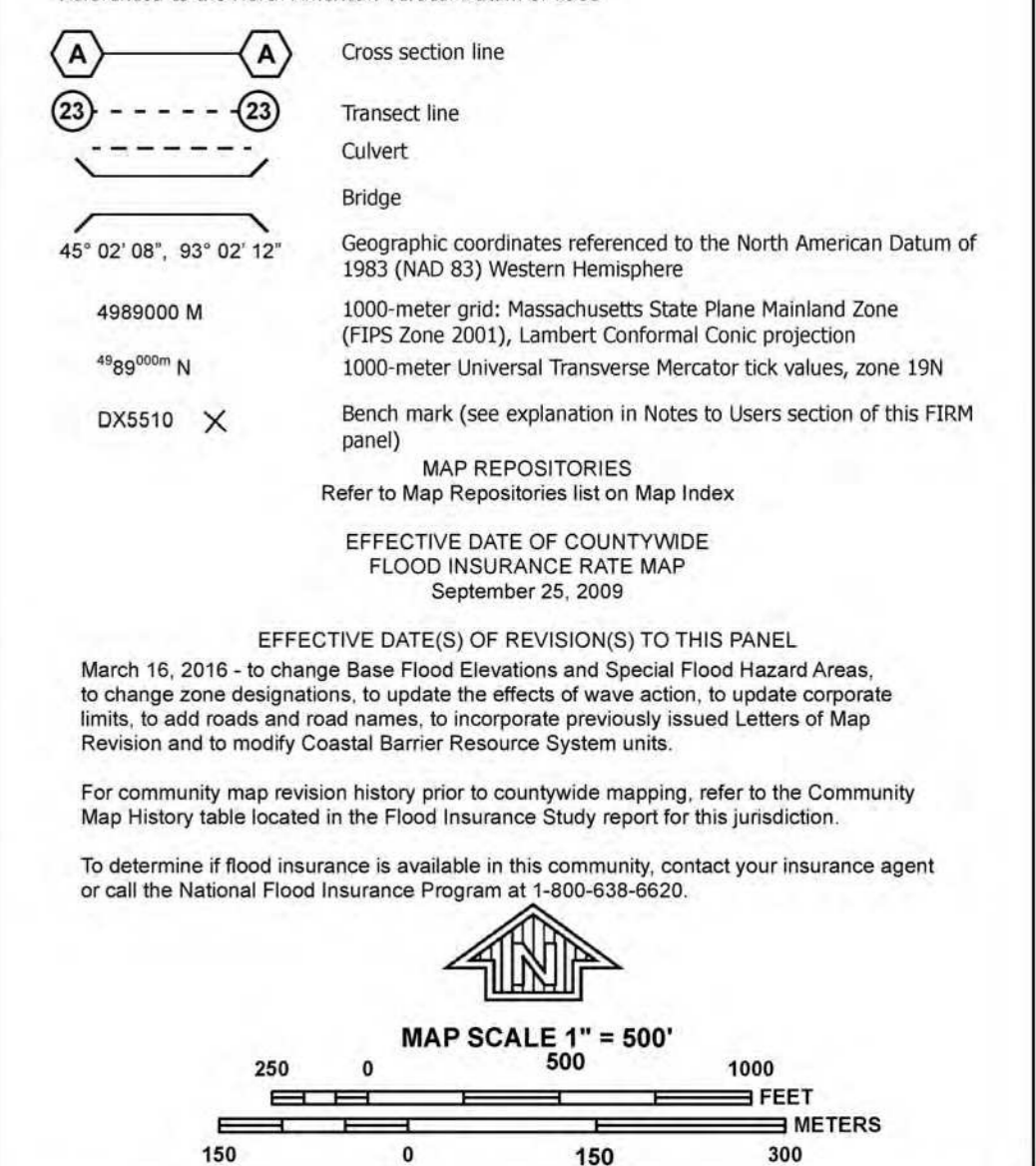

**NATIONAL FLOOD INSURANCE PROGRAM**

**FIRM FLOOD INSURANCE RATE MAP SUFFOLK COUNTY, MASSACHUSETTS (ALL JURISDICTIONS)**

**PANEL 0077J**

**PANEL 77 OF 176**  
(SEE MAP INDEX FOR FIRM PANEL LAYOUT)

**CONTAINS:**

COMMUNITY	NUMBER	PANEL	SUFFIX
BOSTON, CITY OF	250286	0077	J

Notice to User: The **Map Number** shown below should be used when placing map orders; the **Community Number** shown above should be used on insurance applications for the subject community.

**MAP NUMBER 25025C0077J**  
**MAP REVISED MARCH 16, 2016**

**Federal Emergency Management Agency**

TREE	QTY	BOTANICAL NAME	COMMON NAME	SIZE
AR	3	ACER RUBRUM	RED MAPLE	2 1/2 - 3" CAL
AC	1	AMELANCHIER CANADENSIS	SERVICEBERRY (MULTI-STEM)	2 1/2 - 3" CAL
BA	6	BETULA ALLEGANIENSIS	YELLOW BIRCH	2 1/2 - 3" CAL
CC	1	QUERCUS CANADENSIS	EASTERN REDBUD	2 1/2 - 3" CAL
FG	2	FAGUS GRANDIFOLIA	AMERICAN BEECH	2 1/2 - 3" CAL
NS	1	NYSSA SYLVATICA	BLACK TUPELO	2 1/2 - 3" CAL
QB	1	QUERCUS BICOLOR	SWAMP WHITE OAK	2 1/2 - 3" CAL

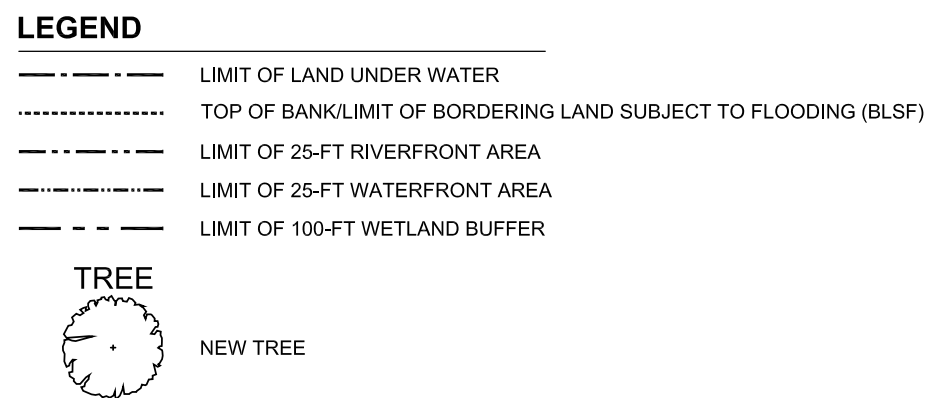

**EXISTING CONDITIONS LEGEND**

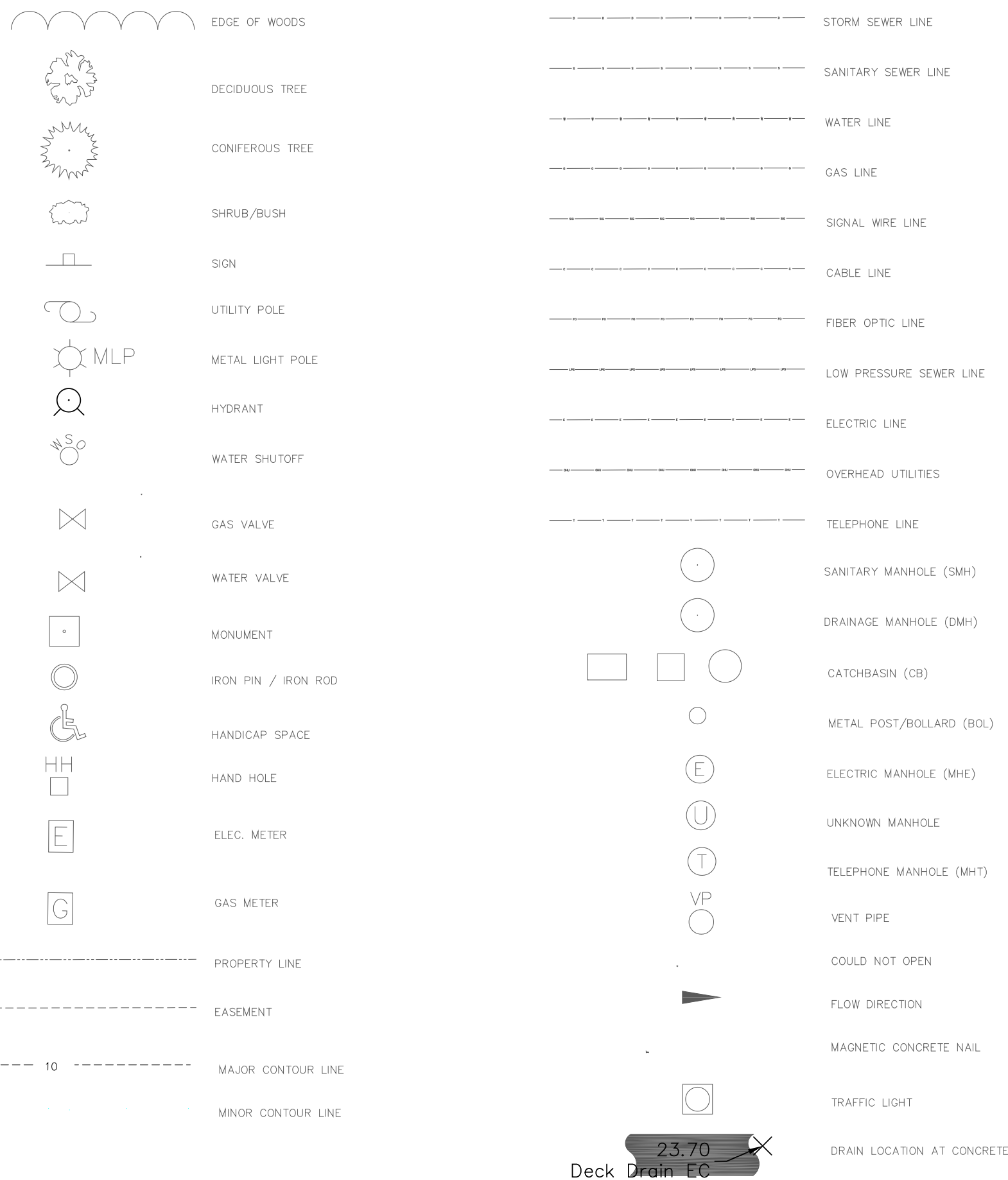

**SURVEY NOTES:**

- UNDERGROUND UTILITY LOCATIONS SHOWN HEREON ARE BASED ON UTILITY EVIDENCE VISIBLE AT GROUND SURFACE AND RECORD DRAWINGS AND ARE SUBJECT TO FIELD VERIFICATION BY EXCAVATION. UTILITIES SHOWN DO NOT PURPORT TO CONSTITUTE OR REPRESENT ALL UTILITIES LOCATED UPON OR ADJACENT TO THE SURVEYED PREMISES.
- SURVEY PERFORMED BY WESTON & SAMPSON PE, LS, LA, PC, IN JULY 2019 AND OCTOBER 2019.
- CONTOURS AND ELEVATIONS SHOWN ON NAVD88 VERTICAL DATUM BASED ON GPS OBSERVATIONS.
- NORTH ORIENTATION IS BASED ON GPS OBSERVATIONS TAKEN AT THE TIME OF THE FIELD SURVEY. MAPPING PREPARED ON NAD83 STATE PLANE COORDINATE SYSTEM - MASSACHUSETTS MAINLAND ZONE.

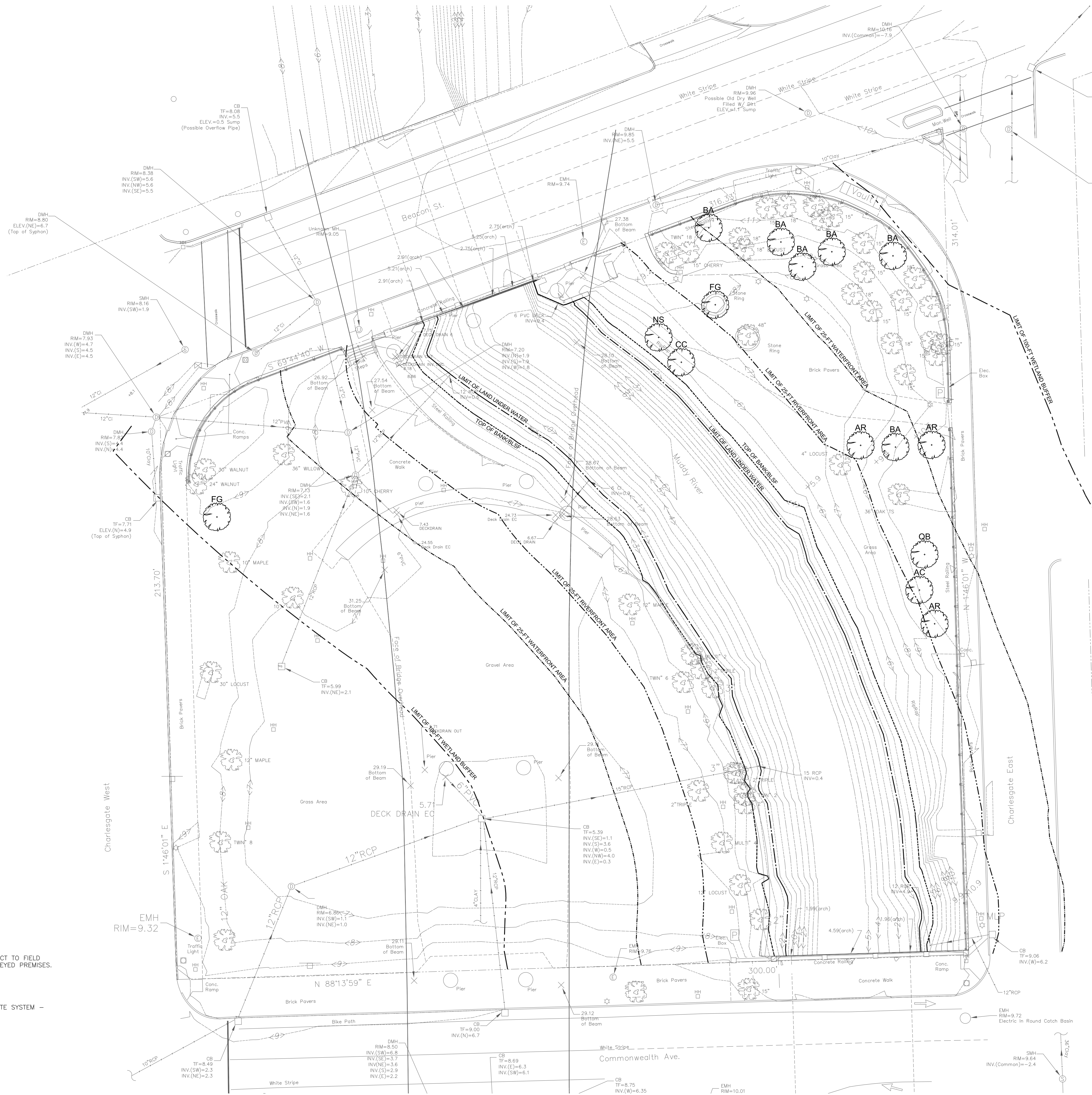

PREPARED BY  
**LANDING STUDIO**  
 130 Cross Street  
 Somerville, MA 02145  
 T. 617.308.0816  
 E. mariejawadams@Landing-Studio.com

**Architect**  
 Landing Studio  
 130 Cross Street  
 Somerville, MA 02145

**Civil Engineer**  
 Weston and Sampson  
 85 Devonshire Street, 3rd Floor  
 Boston, MA 02109

**Landscape Architect**  
 Weston and Sampson  
 85 Devonshire Street, 3rd Floor  
 Boston, MA 02109

**Hydraulics and Hydrology**  
 Weston and Sampson  
 85 Devonshire Street, 3rd Floor  
 Boston, MA 02109

**Traffic Engineer**  
 Howard Stein Hudson  
 11 Beacon Street  
 Boston, MA 02108

**Geotechnical Engineer**  
 Weston and Sampson  
 85 Devonshire Street, 3rd Floor  
 Boston, MA 02109

**Electrical Engineer**  
 Weston and Sampson  
 85 Devonshire Street, 3rd Floor  
 Boston, MA 02109

**Structural Engineer**  
 Gill Engineering Associates, Inc  
 63 Kendrick Street  
 Needham, MA 02494

**Environmental/Permitting**  
 Weston and Sampson  
 85 Devonshire Street, 3rd Floor  
 Boston, MA 02109

DRAWING TITLE PROJECT  
**TREE PLANTING PLAN** **CHARLESGATE REVITALIZATION PROJECT**  
**CHARLESGATE PARK, BOSTON, MA 02215**

REVISIONS			
NO.	REVISION	DATE	BY
1	DCR COMMENTS	02/22	

CURRENT ISSUE:  
 FOR CONSERVATION COMMISSION

SCALE: \_\_\_\_\_  
 DATE: 02/22/2022  
 DRAWN BY: \_\_\_\_\_  
 CHECKED BY: \_\_\_\_\_  
 STAMP: \_\_\_\_\_

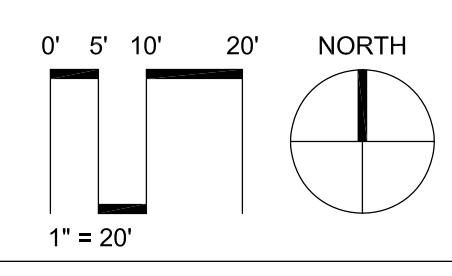

SHEET

TREE	QTY	BOTANICAL NAME	COMMON NAME	SIZE
AR	3	ACER RUBRUM	RED MAPLE	2 1/2 - 3" CAL
AC	1	AMELANCHIER CANADENSIS	SERVICEBERRY (MULTI-STEM)	2 1/2 - 3" CAL
BA	6	BETULA ALLEGANIENSIS	YELLOW BIRCH	2 1/2 - 3" CAL
CC	1	CERDIS CANADENSIS	EASTERN REDBUD	2 1/2 - 3" CAL
FG	2	FAGUS GRANDIFOLIA	AMERICAN BEECH	2 1/2 - 3" CAL
NS	1	NYSSA SYLVATICA	BLACK TUPELO	2 1/2 - 3" CAL
QB	1	QUERCUS BICOLOR	SWAMP WHITE OAK	2 1/2 - 3" CAL

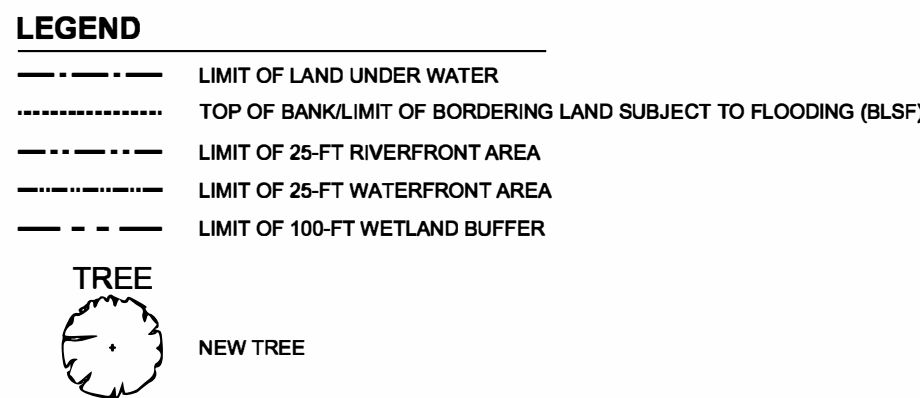

**EXISTING CONDITIONS LEGEND**

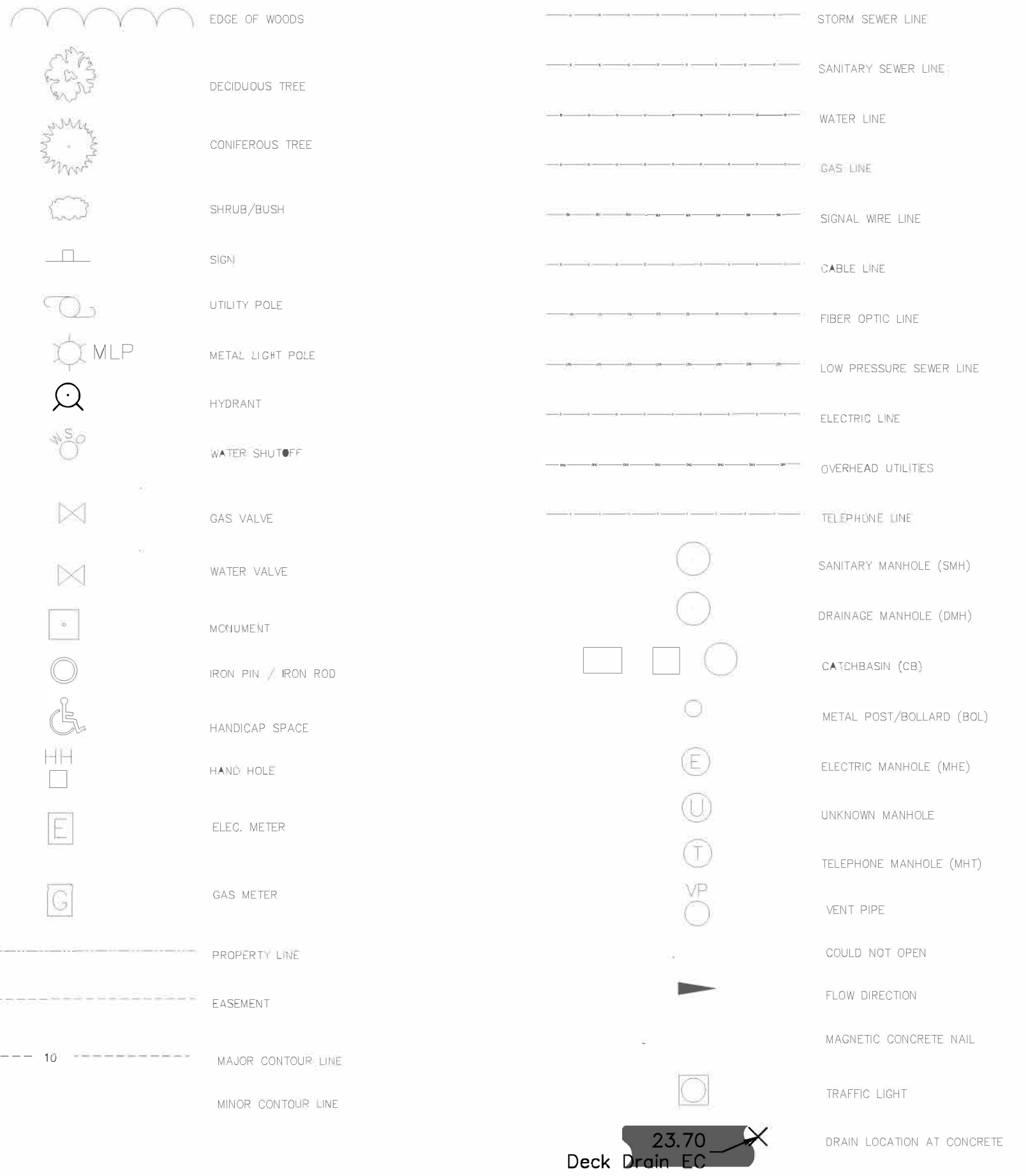

**SURVEY NOTES:**

- UNDERGROUND UTILITY LOCATIONS SHOWN HEREON ARE BASED ON UTILITY EVIDENCE VISIBLE AT GROUND SURFACE AND RECORD DRAWINGS AND ARE SUBJECT TO FIELD VERIFICATION BY EXCAVATION. UTILITIES SHOWN DO NOT PURPORT TO CONSTITUTE OR REPRESENT ALL UTILITIES LOCATED UPON OR ADJACENT TO THE SURVEYED PREMISES.
- SURVEY PERFORMED BY WESTON & SAMPSON PE, LS, LA, PC, IN JULY 2019 AND OCTOBER 2019.
- CONTOURS AND ELEVATIONS SHOWN ON NAVD83 VERTICAL DATUM BASED ON GPS OBSERVATIONS.
- NORTH ORIENTATION IS BASED ON GPS OBSERVATIONS TAKEN AT THE TIME OF THE FIELD SURVEY. MAPPING PREPARED ON NAD83 STATE PLANE COORDINATE SYSTEM - MASSACHUSETTS MAINLAND ZONE.

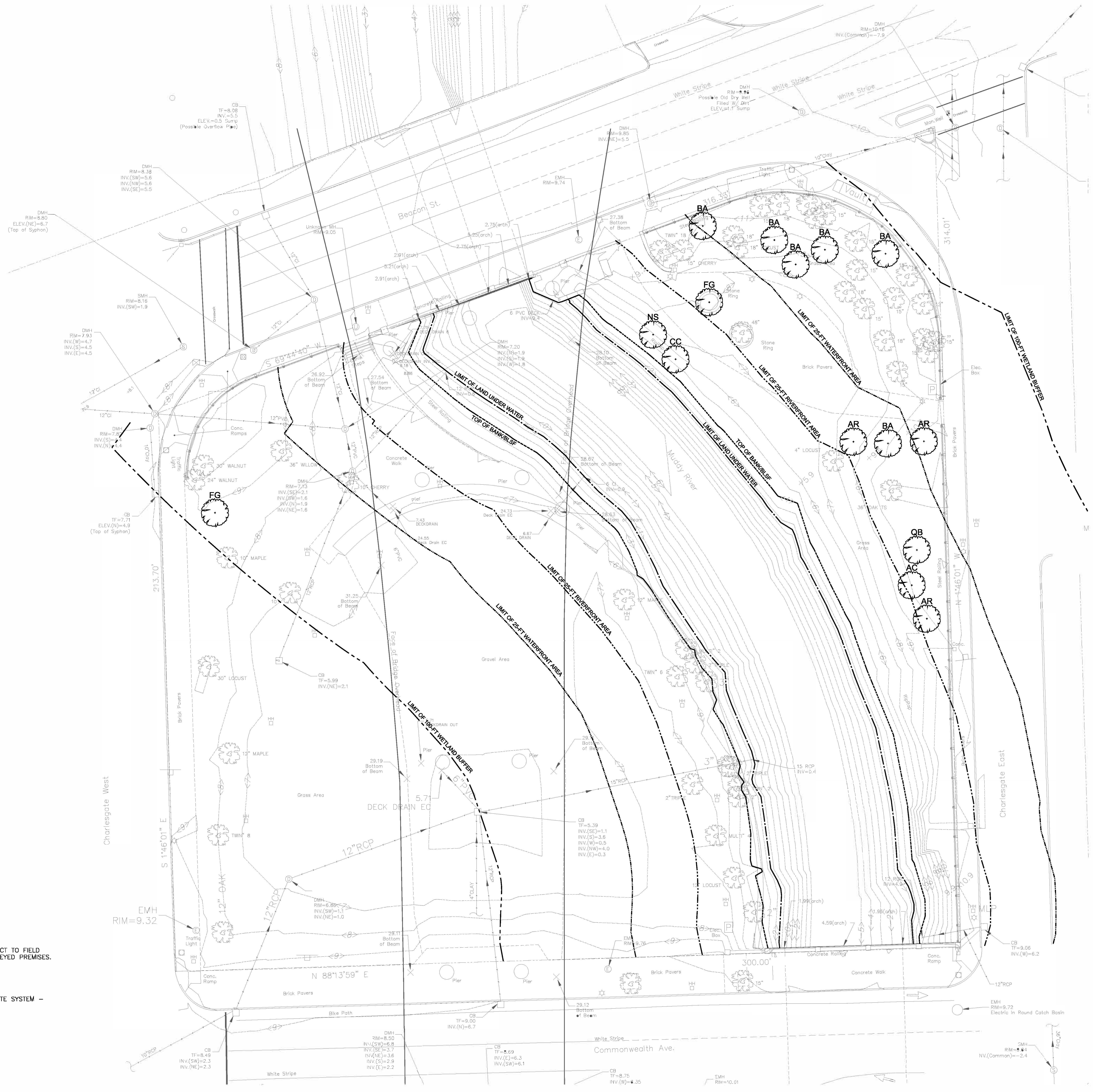

PREPARED BY  
**LANDING STUDIO**  
 130 Cross Street  
 Somerville, MA 02145  
 T. 617.308.0818  
 E.mariawedams@Landing-Studio.com

**Architect**  
 Landing Studio  
 130 Cross Street  
 Somerville, MA 02145

**Civil Engineer**  
 Weston and Sampson  
 85 Devonshire Street, 3rd Floor  
 Boston, MA 02109

**Landscape Architect**  
 Weston and Sampson  
 85 Devonshire Street, 3rd Floor  
 Boston, MA 02109

**Hydraulics and Hydrology**  
 Weston and Sampson  
 85 Devonshire Street, 3rd Floor  
 Boston, MA 02109

**Traffic Engineer**  
 Howard Stein Hudson  
 11 Beacon Street  
 Boston, MA 02108

**Geotechnical Engineer**  
 Weston and Sampson  
 85 Devonshire Street, 3rd Floor  
 Boston, MA 02109

**Electrical Engineer**  
 Weston and Sampson  
 85 Devonshire Street, 3rd Floor  
 Boston, MA 02109

**Structural Engineer**  
 CBI Engineering Associates, Inc  
 83 Kendrick Street  
 Needham, MA 02494

**Environmental/Permitting**  
 Weston and Sampson  
 85 Devonshire Street, 3rd Floor  
 Boston, MA 02109

DRAWING TITLE PROJECT  
**TREE PLANTING PLAN** **CHARLESGATE REVITALIZATION PROJECT**  
**CHARLESGATE PARK, BOSTON, MA 02215**

REVISIONS			
NO.	REVISION	DATE	BY
1	DCR COMMENTS	02/22	



CURRENT ISSUE FOR CONSERVATION COMMISSION  
 SCALE  
 DATE 02/22/2022  
 DRAWN BY  
 CHECKED BY  
 STAMP

0' 5' 10' 20' NORTH  
 1" = 20'





Newton  
Arlington

Downtown

CLEARANCE 10 FT 6 IN

Newton  
Arlington

CARS ONLY







**LEGEND**

-  Asphalt
-  Concrete
-  Asphalt Paver
-  Turfstone w/ Stone
-  Turfstone w/ Grass
-  Proposed Lawn
-  Existing Shrub Zone
-  Water
-  Bioretention
-  Rubber Playground
-  Placed Stone
-  Existing Granite Armoring
-  Stone Dust Path
-  Rice Stone
-  Tree Removal
-  Lights
-  Proposed Trees
-  Existing Trees
-  Top of Bank
-  Bench



**AFFIDAVIT OF SERVICE  
FOR ABUTTER NOTIFICATION**

**Under the Massachusetts Wetlands Protection Act  
and Boston Wetlands Ordinance**

I, Margaret Pokorny, hereby certify under pains and penalties of perjury that that at least one week prior to the public hearing, I gave notice to abutters in compliance with the second paragraph of Massachusetts General Laws Chapter 131, section 40, and the DEP Guide to Abutter Notification dated April 8, 1994, in connection with the following matter:

A Request for a Determination of Applicability was filed under the Massachusetts Wetlands Protection Act and/or the Boston Wetlands Ordinance by the Charlesgate Alliance for the planting of 15 trees located at Charlesgate Park, Beacon Street to Commonwealth Avenue and Charlesgate East to Charlesgate West.

The Abutter Notification For, the list of abutters to whom it was given, and their addresses are attached to this Affidavit of Service.

Margaret Pokorny  
Name

February 10, 2022  
Date



## NOTIFICACIÓN PARA PROPIETARIOS Y/O VECINOS COLINDANTES COMISIÓN DE CONSERVACIÓN DE BOSTON

De conformidad con la Ley de protección de los humedales de Massachusetts, el Capítulo 131, Sección 40 de las Leyes Generales de Massachusetts y la Ordenanza sobre los humedales de Boston, por la presente queda usted notificado como propietario o vecino colindante de un proyecto presentado ante la Comisión de Conservación de Boston.

A. **Charlesgate Alliance** ha presentado una solicitud a la Comisión de Conservación de Boston pidiendo permiso para modificar una zona sujeta a protección en virtud de la Ley de protección de los humedales (Leyes generales, capítulo 131, sección 40) y la Ordenanza sobre los humedales de Boston.

B. La dirección del lote donde se propone la actividad es **Beacon Street a Commonwealth Ave y Charlesgate East para Charlesgate West.**

C. El proyecto consiste en **plantar 15 arboles nuevos.**

D. Se pueden obtener copias del Aviso de Intención comunicándose con la Comisión de Conservación de Boston en [CC@boston.gov](mailto:CC@boston.gov).

E. Las copias de la notificación de intención pueden obtenerse de **Margaret Pokorny, entrando en contacto con ella por correo electrónico [mpok384@gmail.com](mailto:mpok384@gmail.com) o (917) 354-4052** entre las **9 am y las 4 pm, de lunes a viernes.**

F. De acuerdo con el Decreto Ejecutivo de la Mancomunidad de Massachusetts que suspende ciertas disposiciones de la Ley de reuniones abiertas, la audiencia pública se llevará a cabo virtualmente en <https://zoom.us/j/6864582044>. Si no puede acceder a Internet, puede llamar al 1-929-205-6099, ingresar ID de reunión 686 458 2044 # y usar # como su ID de participante.

G. La información relativa a la fecha y hora de la audiencia pública puede solicitarse a la **Comisión de Conservación de Boston** por correo electrónico a [CC@boston.gov](mailto:CC@boston.gov) o llamando al **(617) 635-4416** entre las **9 AM y las 5 PM, de lunes a viernes.**

NOTA: La notificación de la audiencia pública, incluida su fecha, hora y lugar, se publicará en el **Boston Herald** con al menos cinco (5) días de antelación.

NOTA: La notificación de la audiencia pública, incluida su fecha, hora y lugar, se publicará en [www.boston.gov/public-notices](http://www.boston.gov/public-notices) y en el Ayuntamiento de Boston con no menos de cuarenta y ocho (48) horas de antelación. Si desea formular comentarios, puede asistir a la audiencia pública o enviarlos por escrito a [CC@boston.gov](mailto:CC@boston.gov) o al Ayuntamiento de Boston, Departamento de Medio Ambiente, Sala 709, 1 City Hall Square, Boston, MA 02201.

NOTA: También puede comunicarse con la Comisión de Conservación de Boston o con la Oficina Regional del Noreste del Departamento de Protección Ambiental para obtener más información sobre esta solicitud o la Ley de Protección de Humedales. Para comunicarse con el DEP, llame a la Región Noreste: (978) 694-3200.

NOTA: si tiene previsto asistir a la audiencia pública y necesita servicios de interpretación, sírvase informar al personal en [CC@boston.gov](mailto:CC@boston.gov) antes de las 12 PM del día anterior a la audiencia.



**NOTIFICATION TO ABUTTERS  
BOSTON CONSERVATION COMMISSION**

In accordance with the Massachusetts Wetlands Protection Act, Massachusetts General Laws Chapter 131, Section 40, and the Boston Wetlands Ordinance, you are hereby notified as an abutter to a project filed with the Boston Conservation Commission.

A. Charlesgate Alliance has filed a Notice of Intent with the Boston Conservation Commission seeking permission to alter an Area Subject to Protection under the Wetlands Protection Act (General Laws Chapter 131, section 40) and Boston Wetlands Ordinance.

B. The address of the lot where the activity is proposed is Beacon St to Commonwealth Ave & Charlesgate East to Charlesgate West.

C. The project involves the planting of 15 new trees.

D. Copies of the Notice of Intent may be obtained by contacting the Boston Conservation Commission at [CC@boston.gov](mailto:CC@boston.gov).

E. Copies of the Notice of Intent may be obtained from Margaret Pokorny by contacting them at mpok384@gmail.com or (917) 354-4052 between the hours of 9am to 4pm, Monday through Friday.

F. In accordance with the Chapter 20 of the Acts of 2021, the public hearing will take place **virtually** at <https://zoom.us/j/6864582044>. If you are unable to access the internet, you can call 1-929-205-6099, enter Meeting ID 686 458 2044 # and use # as your participant ID.

G. Information regarding the date and time of the public hearing may be obtained from the **Boston Conservation Commission** by emailing [CC@boston.gov](mailto:CC@boston.gov) or calling **(617) 635-3850** between the hours of **9 AM to 5 PM, Monday through Friday**.

NOTE: Notice of the public hearing, including its date, time, and place, will be published at least five (5) days in advance in the **Boston Herald**.

NOTE: Notice of the public hearing, including its date, time, and place, will be posted on [www.boston.gov/public-notices](http://www.boston.gov/public-notices) and in Boston City Hall not less than forty-eight (48) hours in advance. If you would like to provide comments, you may attend the public hearing or send written comments to [CC@boston.gov](mailto:CC@boston.gov) or Boston City Hall, Environment Department, Room 709, 1 City Hall Square, Boston, MA 02201

NOTE: If you would like to provide comments, you may attend the public hearing or send written comments to [CC@boston.gov](mailto:CC@boston.gov) or Boston City Hall, Environment Department, Room 709, 1 City Hall Square, Boston, MA 02201

NOTE: You also may contact the Boston Conservation Commission or the Department of Environmental Protection Northeast Regional Office for more information about this application or the Wetlands Protection Act. To contact DEP, call: the Northeast Region: (978) 694-3200.

NOTE: If you plan to attend the public hearing and are in need of interpretation, please notify staff at [CC@boston.gov](mailto:CC@boston.gov) by 12 PM the day before the hearing.



## BABEL NOTICE

English:

**IMPORTANT!** This document or application contains **important information** about your rights, responsibilities and/or benefits. It is crucial that you understand the information in this document and/or application, and we will provide the information in your preferred language at no cost to you. If you need them, please contact us at [cc@boston.gov](mailto:cc@boston.gov) or 617-635-3850.

Spanish:

**¡IMPORTANTE!** Este documento o solicitud contiene **información importante** sobre sus derechos, responsabilidades y/o beneficios. Es fundamental que usted entienda la información contenida en este documento y/o solicitud, y le proporcionaremos la información en su idioma preferido sin costo alguno para usted. Si los necesita, póngase en contacto con nosotros en el correo electrónico [cc@boston.gov](mailto:cc@boston.gov) o llamando al 617-635-3850.

Haitian Creole:

**AVI ENPÒTAN!** Dokiman oubyen aplikasyon sa genyen **enfòmasyon ki enpòtan** konsènan dwa, responsablite, ak/oswa benefis ou yo. Li enpòtan ke ou konprann enfòmasyon ki nan dokiman ak/oubyen aplikasyon sa, e n ap bay enfòmasyon an nan lang ou prefere a, san ou pa peye anyen. Si w bezwen yo, tanpri kontakte nou nan [cc@boston.gov](mailto:cc@boston.gov) oswa 617-635-3850.

Traditional Chinese:

**非常重要！**這份文件或是申請表格包含關於您的權利，責任，和／或福利的重要信息。請您務必完全理解這份文件或申請表格的全部信息，這對我們來說十分重要。我們會免費給您提供翻譯服務。如果您有需要請聯系我們的郵箱 [cc@boston.gov](mailto:cc@boston.gov) 電話# 617-635-3850..

Vietnamese:

**QUAN TRỌNG!** Tài liệu hoặc đơn yêu cầu này chứa **thông tin quan trọng** về các quyền, trách nhiệm và/hoặc lợi ích của bạn. Việc bạn hiểu rõ thông tin trong tài liệu và/hoặc đơn yêu cầu này rất quan trọng, và chúng tôi sẽ cung cấp thông tin bằng ngôn ngữ bạn muốn mà không tính phí. Nếu quý vị cần những dịch vụ này, vui lòng liên lạc với chúng tôi theo địa chỉ [cc@boston.gov](mailto:cc@boston.gov) hoặc số điện thoại 617-635-3850.

Simplified Chinese:

**非常重要！**这份文件或是申请表格包含关于您的权利，责任，和／或福利的重要信息。请您务必完全理解这份文件或申请表格的全部信息，这对我们来说十分重要。我们会免费给您提供翻译服务。如果您有需要请联系我们的邮箱 [cc@boston.gov](mailto:cc@boston.gov) 电话# 617-635-3850.

Cape Verdean Creole:

**INPURTANTI!** Es dukumentu ó aplikason ten **informason inpurtanti** sobri bu direitus, rasponsabilidadi i/ó benefisius. Ê krusial ki bu intendi informason na es dukumentu i/ó aplikason ó nu ta da informason na língua di bu preferênsia sen ninhun kustu pa bó. Si bu prisiza del, kontata-nu na [cc@boston.gov](mailto:cc@boston.gov) ó 617-635-3850.

Arabic:

**مهم!** يحتوي هذا المستند أو التطبيق على معلومات مهمة حول حقوقك ومسؤولياتك أو فوائده. من الأهمية أن تفهم المعلومات الواردة في هذا المستند أو التطبيق. سوف نقدم المعلومات بلغتك المفضلة دون أي تكلفة عليك. إذا كنت في حاجة إليها، يرجى الاتصال بنا على

[cc@boston.gov](mailto:cc@boston.gov) أو 617-635-3850.

Russian:

**ВАЖНО!** В этом документе или заявлении содержится **важная информация** о ваших правах, обязанностях и/или льготах. Для нас очень важно, чтобы вы понимали приведенную в этом документе и/или заявлении информацию, и мы готовы бесплатно предоставить вам информацию на предпочитаемом вами языке. Если Вам они нужны, просьба связаться с нами по адресу электронной почты [cc@boston.gov](mailto:cc@boston.gov), либо по телефону 617-635-3850.

Portuguese:

**IMPORTANTE!** Este documento ou aplicativo contém **Informações importantes** sobre os seus direitos, responsabilidades e/ou benefícios. É importante que você compreenda as informações contidas neste documento e/ou aplicativo, e nós iremos fornecer as informações em seu idioma de preferência sem nenhum custo para você. Se precisar deles, fale conosco: [cc@boston.gov](mailto:cc@boston.gov) ou 617-635-3850.

French:

**IMPORTANT !** Ce document ou cette demande contient des **informations importantes** concernant vos droits, responsabilités et/ou avantages. Il est essentiel que vous compreniez les informations contenues dans ce document et/ou cette demande, que nous pouvons vous communiquer gratuitement dans la langue de votre choix. Si vous en avez besoin, veuillez nous contacter à [cc@boston.gov](mailto:cc@boston.gov) ou au 617-635-3850.

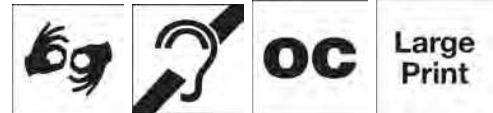



MAPA Translations, Inc  
216 Concord Rd  
Wayland, MA 01778  
[info@mapatranslation.com](mailto:info@mapatranslation.com)  
[www.mapatranslation.com](http://www.mapatranslation.com)

## Affidavit of Authenticity

The undersigned, **MAPA Translations, Inc.**, hereby states as proof that the below translation provided to **Charlesgate Alliance** is a certified translation:

02/08/2022 Spanish Translation

Client: Charlesgate Alliance  
Division: City of Boston  
Project: City of Boston Environment (Boston Conservation Commission)  
Document: Notification to Abutters  
Word Count: 476  
Requested by Margaret Pokorny on 2-7-22  
Job Number: FEB2022-102

I declare, to the best of my knowledge and belief, the information herein is true, correct, and complete.

Name: Drita Protopapa

Date: February 8, 2022

Signature: *Drita Protopapa*



OBJECTID	PID	PID_LONG	GIS_ID	FULL_ADDRE CITY	ZIPCODE
60616	503809000	503809104	503809000	416 COMMO BOSTON	2215
60687	503809000	503809252	503809000	416 COMMO BOSTON	2215
81248	503870210	503870296	503870210	4 CHARLESG. BOSTON	2215
60664	503809000	503809200	503809000	416 COMMO BOSTON	2215
114235	503911000	503911010	503911000	591 BEACON BOSTON	2215
60710	503809000	503809302	503809000	400 COMMO BOSTON	2215
148696	503703000	503703139	503703000	534 BEACON BOSTON	2215
62084	503870010	503870022	503870010	10 CHARLES( BOSTON	2215
33411	503707000	503707018	503707000	60 CHARLES( BOSTON	2215
148642	503703000	503703034	503703000	534 BEACON BOSTON	2215
82196	503893000	503893006	503893000	461 COMMO BOSTON	2215
148665	503703000	503703080	503703000	534 BEACON BOSTON	2215
60610	503809000	503809092	503809000	416 COMMO BOSTON	2215
60670	503809000	503809212	503809000	416 COMMO BOSTON	2215
75134	503916000	503916054	503916000	466 COMMO BOSTON	2215
81217	503870210	503870234	503870210	4 CHARLESG. BOSTON	2215
60624	503809000	503809120	503809000	416 COMMO BOSTON	2215
81231	503870210	503870262	503870210	4 CHARLESG. BOSTON	2215
75174	503916000	503916530	503916000	464 COMMO BOSTON	2215
75180	503916000	503916542	503916000	464 COMMO BOSTON	2215
62090	503870010	503870034	503870010	10 CHARLES( BOSTON	2215
125141	503834010	503834022	503834010	409 COMMO BOSTON	2215
125147	503834010	503834034	503834010	409 COMMO BOSTON	2215
148656	503703000	503703062	503703000	534 BEACON BOSTON	2215
75128	503916000	503916042	503916000	466 COMMO BOSTON	2215
81225	503870210	503870250	503870210	4 CHARLESG. BOSTON	2215
148702	503703000	503703145	503703000	534 BEACON BOSTON	2215
60699	503809000	503809276	503809000	416 COMMO BOSTON	2215
148682	503703000	503703114	503703000	534 BEACON BOSTON	2215
149037	503894000	503894010	503894000	463 COMMO BOSTON	2215
148705	503703000	503703148	503703000	534 BEACON BOSTON	2215
60650	503809000	503809172	503809000	416 COMMO BOSTON	2215
148633	503703000	503703016	503703000	534 BEACON BOSTON	2215
170004	503917000	503917000	503917000	20 CHARLES( BOSTON	2215
60673	503809000	503809220	503809000	416 COMMO BOSTON	2215
75120	503916000	503916028	503916000	466 COMMO BOSTON	2215
33402	503707000	503707000	503707000	60 CHARLES( BOSTON	2215
60601	503809000	503809074	503809000	416 COMMO BOSTON	2215
60607	503809000	503809086	503809000	416 COMMO BOSTON	2215
81257	503870210	503870314	503870210	4 CHARLESG. BOSTON	2215
97218	503914000	503914002	503914000	585 BEACON BOSTON	2215
125135	503834010	503834010	503834010	409 COMMO BOSTON	2215

148662	503703000	503703074	503703000	534 BEACON BOSTON	2215
60656	503809000	503809184	503809000	416 COMMO BOSTON	2215
75137	503916000	503916060	503916000	466 COMMO BOSTON	2215
75214	503916000	503916610	503916000	464 COMMO BOSTON	2215
81214	503870210	503870228	503870210	4 CHARLESG. BOSTON	2215
125158	503834010	503834045	503834010	409 COMMO BOSTON	2215
148639	503703000	503703028	503703000	534 BEACON BOSTON	2215
60630	503809000	503809132	503809000	416 COMMO BOSTON	2215
75114	503916000	503916018	503916000	466 COMMO BOSTON	2215
81237	503870210	503870274	503870210	4 CHARLESG. BOSTON	2215
33408	503707000	503707012	503707000	60 CHARLESC BOSTON	2215
60693	503809000	503809264	503809000	416 COMMO BOSTON	2215
148676	503703000	503703102	503703000	534 BEACON BOSTON	2215
81208	503870210	503870216	503870210	4 CHARLESG. BOSTON	2215
125164	503834010	503834051	503834010	409 COMMO BOSTON	2215
60587	503809000	503809030	503809000	416 COMMO BOSTON	2215
60636	503809000	503809144	503809000	416 COMMO BOSTON	2215
75157	503916000	503916100	503916000	466 COMMO BOSTON	2215
75194	503916000	503916570	503916000	464 COMMO BOSTON	2215
49034	503837010	503837010	503837010	413 419 COI BOSTON	2215
49040	503837010	503837022	503837010	413 415 COI BOSTON	2215
81245	503870210	503870290	503870210	4 CHARLESG. BOSTON	2215
81251	503870210	503870302	503870210	4 CHARLESG. BOSTON	2215
60644	503809000	503809160	503809000	416 COMMO BOSTON	2215
60593	503809000	503809058	503809000	416 COMMO BOSTON	2215
75151	503916000	503916088	503916000	466 COMMO BOSTON	2215
75200	503916000	503916582	503916000	464 COMMO BOSTON	2215
75177	503916000	503916536	503916000	464 COMMO BOSTON	2215
49043	503837010	503837028	503837010	413 415 COI BOSTON	2215
75154	503916000	503916094	503916000	466 COMMO BOSTON	2215
148693	503703000	503703136	503703000	534 BEACON BOSTON	2215
75131	503916000	503916048	503916000	466 COMMO BOSTON	2215
75108	503916000	503916010	503916000	466 COMMO BOSTON	2215
62087	503870010	503870028	503870010	10 CHARLESC BOSTON	2215
33414	503707000	503707024	503707000	60 CHARLESC BOSTON	2215
60684	503809000	503809246	503809000	416 COMMO BOSTON	2215
82193	503893000	503893000	503893000	461 COMMO BOSTON	2215
60707	503809000	503809296	503809000	400 COMMO BOSTON	2215
62081	503870010	503870016	503870010	10 CHARLESC BOSTON	2215
114238	503911000	503911016	503911000	591 BEACON BOSTON	2215
75171	503916000	503916524	503916000	464 COMMO BOSTON	2215
75183	503916000	503916548	503916000	464 COMMO BOSTON	2215
148699	503703000	503703142	503703000	534 BEACON BOSTON	2215

75217	503916000	503916616	503916000	464 COMMO BOSTON	2215
125138	503834010	503834016	503834010	409 COMMO BOSTON	2215
114232	503911000	503911004	503911000	591 BEACON BOSTON	2215
60613	503809000	503809098	503809000	416 COMMO BOSTON	2215
60713	503809000	503809310	503809000	400 COMMO BOSTON	2215
81228	503870210	503870256	503870210	4 CHARLESG. BOSTON	2215
60667	503809000	503809206	503809000	416 COMMO BOSTON	2215
62093	503870010	503870040	503870010	10 CHARLESC BOSTON	2215
125144	503834010	503834028	503834010	409 COMMO BOSTON	2215
148653	503703000	503703056	503703000	534 BEACON BOSTON	2215
60604	503809000	503809080	503809000	416 COMMO BOSTON	2215
81260	503870210	503870320	503870210	4 CHARLESG. BOSTON	2215
60627	503809000	503809126	503809000	416 COMMO BOSTON	2215
60676	503809000	503809230	503809000	416 COMMO BOSTON	2215
75117	503916000	503916024	503916000	466 COMMO BOSTON	2215
148636	503703000	503703022	503703000	534 BEACON BOSTON	2215
149040	503894000	503894016	503894000	463 COMMO BOSTON	2215
148659	503703000	503703068	503703000	534 BEACON BOSTON	2215
75168	503916000	503916518	503916000	464 COMMO BOSTON	2215
62101	503870010	503870056	503870010	10 CHARLESC BOSTON	2215
148685	503703000	503703120	503703000	534 BEACON BOSTON	2215
75191	503916000	503916564	503916000	464 COMMO BOSTON	2215
81234	503870210	503870268	503870210	4 CHARLESG. BOSTON	2215
33405	503707000	503707006	503707000	60 CHARLESC BOSTON	2215
60653	503809000	503809178	503809000	416 COMMO BOSTON	2215
75140	503916000	503916066	503916000	466 COMMO BOSTON	2215
75211	503916000	503916604	503916000	464 COMMO BOSTON	2215
81211	503870210	503870222	503870210	4 CHARLESG. BOSTON	2215
97221	503914000	503914008	503914000	585 BEACON BOSTON	2215
149034	503894000	503894004	503894000	463 COMMO BOSTON	2215
49037	503837010	503837016	503837010	413 415 COI BOSTON	2215
81254	503870210	503870308	503870210	4 CHARLESG. BOSTON	2215
170411	503895000	503895000	503895000	465 COMMO BOSTON	2215
60633	503809000	503809138	503809000	416 COMMO BOSTON	2215
75111	503916000	503916014	503916000	466 COMMO BOSTON	2215
75148	503916000	503916082	503916000	466 COMMO BOSTON	2215
75160	503916000	503916502	503916000	464 COMMO BOSTON	2215
60647	503809000	503809166	503809000	416 COMMO BOSTON	2215
81205	503870210	503870210	503870210	4 CHARLESG. BOSTON	2215
125161	503834010	503834048	503834010	409 COMMO BOSTON	2215
60690	503809000	503809258	503809000	416 COMMO BOSTON	2215
60696	503809000	503809270	503809000	416 COMMO BOSTON	2215
148673	503703000	503703096	503703000	534 BEACON BOSTON	2215

148679	503703000	503703108	503703000	534 BEACON BOSTON	2215
60590	503809000	503809050	503809000	416 COMMO BOSTON	2215
75197	503916000	503916576	503916000	464 COMMO BOSTON	2215
75203	503916000	503916588	503916000	464 COMMO BOSTON	2215
170419	503895000	503895016	503895000	465 COMMO BOSTON	2215
148630	503703000	503703010	503703000	534 BEACON BOSTON	2215
148694	503703000	503703137	503703000	534 BEACON BOSTON	2215
60639	503809000	503809150	503809000	416 COMMO BOSTON	2215
75178	503916000	503916538	503916000	464 COMMO BOSTON	2215
60662	503809000	503809196	503809000	416 COMMO BOSTON	2215
75155	503916000	503916096	503916000	466 COMMO BOSTON	2215
62088	503870010	503870030	503870010	10 CHARLES( BOSTON	2215
148648	503703000	503703046	503703000	534 BEACON BOSTON	2215
60685	503809000	503809248	503809000	416 COMMO BOSTON	2215
75132	503916000	503916050	503916000	466 COMMO BOSTON	2215
148671	503703000	503703092	503703000	534 BEACON BOSTON	2215
60708	503809000	503809298	503809000	400 COMMO BOSTON	2215
75109	503916000	503916012	503916000	466 COMMO BOSTON	2215
49046	503837010	503837034	503837010	419 COMMO BOSTON	2215
114233	503911000	503911006	503911000	591 BEACON BOSTON	2215
114239	503911000	503911018	503911000	591 BEACON BOSTON	2215
62082	503870010	503870018	503870010	10 CHARLES( BOSTON	2215
60622	503809000	503809116	503809000	416 COMMO BOSTON	2215
33409	503707000	503707014	503707000	60 CHARLES( BOSTON	2215
125139	503834010	503834018	503834010	409 COMMO BOSTON	2215
148700	503703000	503703143	503703000	534 BEACON BOSTON	2215
75172	503916000	503916526	503916000	464 COMMO BOSTON	2215
81229	503870210	503870258	503870210	4 CHARLES( BOSTON	2215
62096	503870010	503870046	503870010	10 CHARLES( BOSTON	2215
33417	503707000	503707030	503707000	7 BAY STATE BOSTON	2215
136159	504175003	504175003	504175003	CHARLES( BOSTON	2215
60668	503809000	503809208	503809000	416 COMMO BOSTON	2215
81223	503870210	503870246	503870210	4 CHARLES( BOSTON	2215
148654	503703000	503703058	503703000	534 BEACON BOSTON	2215
75126	503916000	503916038	503916000	466 COMMO BOSTON	2215
60628	503809000	503809128	503809000	416 COMMO BOSTON	2215
75143	503916000	503916072	503916000	466 COMMO BOSTON	2215
148660	503703000	503703070	503703000	534 BEACON BOSTON	2215
75186	503916000	503916554	503916000	464 COMMO BOSTON	2215
75192	503916000	503916566	503916000	464 COMMO BOSTON	2215
149035	503894000	503894006	503894000	463 COMMO BOSTON	2215
33406	503707000	503707008	503707000	60 CHARLES( BOSTON	2215
146504	504175004	504175004	504175004	CHARLES( BOSTON	2215

62102	503870010	503870058	503870010	10 CHARLES	BOSTON	2215
148637	503703000	503703024	503703000	534 BEACON	BOSTON	2215
62079	503870010	503870012	503870010	10 CHARLES	BOSTON	2215
60605	503809000	503809082	503809000	416 COMMO	BOSTON	2215
60679	503809000	503809236	503809000	416 COMMO	BOSTON	2215
75163	503916000	503916508	503916000	464 COMMO	BOSTON	2215
75212	503916000	503916606	503916000	464 COMMO	BOSTON	2215
81212	503870210	503870224	503870210	4 CHARLES	BOSTON	2215
125156	503834010	503834043	503834010	409 COMMO	BOSTON	2215
75112	503916000	503916016	503916000	466 COMMO	BOSTON	2215
148688	503703000	503703126	503703000	534 BEACON	BOSTON	2215
49038	503837010	503837018	503837010	413 415 CO	BOSTON	2215
60585	503809000	503809000	503809000	416 400 CO	BOSTON	2215
60599	503809000	503809070	503809000	416 COMMO	BOSTON	2215
60648	503809000	503809168	503809000	416 COMMO	BOSTON	2215
75206	503916000	503916594	503916000	464 COMMO	BOSTON	2215
81206	503870210	503870212	503870210	4 CHARLES	BOSTON	2215
81243	503870210	503870286	503870210	4 CHARLES	BOSTON	2215
81255	503870210	503870310	503870210	4 CHARLES	BOSTON	2215
125162	503834010	503834049	503834010	409 COMMO	BOSTON	2215
75198	503916000	503916578	503916000	464 COMMO	BOSTON	2215
170414	503895000	503895006	503895000	465 COMMO	BOSTON	2215
148625	503703000	503703000	503703000	534 538 BE	BOSTON	2215
148631	503703000	503703012	503703000	534 BEACON	BOSTON	2215
148674	503703000	503703098	503703000	534 BEACON	BOSTON	2215
148680	503703000	503703110	503703000	534 BEACON	BOSTON	2215
75149	503916000	503916084	503916000	466 COMMO	BOSTON	2215
60642	503809000	503809156	503809000	416 COMMO	BOSTON	2215
60691	503809000	503809260	503809000	416 COMMO	BOSTON	2215
81249	503870210	503870298	503870210	4 CHARLES	BOSTON	2215
60711	503809000	503809304	503809000	400 COMMO	BOSTON	2215
75106	503916000	503916007	503916000	466 COMMO	BOSTON	2215
170417	503895000	503895012	503895000	465 COMMO	BOSTON	2215
114236	503911000	503911012	503911000	591 BEACON	BOSTON	2215
60688	503809000	503809254	503809000	416 COMMO	BOSTON	2215
75129	503916000	503916044	503916000	466 COMMO	BOSTON	2215
62085	503870010	503870024	503870010	10 CHARLES	BOSTON	2215
148645	503703000	503703040	503703000	534 BEACON	BOSTON	2215
148691	503703000	503703132	503703000	534 BEACON	BOSTON	2215
148668	503703000	503703086	503703000	534 BEACON	BOSTON	2215
60705	503809000	503809290	503809000	400 COMMO	BOSTON	2215
114230	503911000	503911000	503911000	591 BEACON	BOSTON	2215
75123	503916000	503916032	503916000	466 COMMO	BOSTON	2215

75135	503916000	503916056	503916000	466 COMMO BOSTON	2215
60659	503809000	503809190	503809000	416 COMMO BOSTON	2215
60671	503809000	503809214	503809000	416 COMMO BOSTON	2215
81220	503870210	503870240	503870210	4 CHARLESG. BOSTON	2215
81232	503870210	503870264	503870210	4 CHARLESG. BOSTON	2215
75169	503916000	503916520	503916000	464 COMMO BOSTON	2215
125150	503834010	503834037	503834010	409 COMMO BOSTON	2215
60619	503809000	503809110	503809000	416 COMMO BOSTON	2215
125142	503834010	503834024	503834010	409 COMMO BOSTON	2215
148697	503703000	503703140	503703000	534 BEACON BOSTON	2215
60665	503809000	503809202	503809000	416 COMMO BOSTON	2215
81226	503870210	503870252	503870210	4 CHARLESG. BOSTON	2215
148651	503703000	503703052	503703000	534 BEACON BOSTON	2215
75175	503916000	503916532	503916000	464 COMMO BOSTON	2215
75189	503916000	503916560	503916000	464 COMMO BOSTON	2215
33403	503707000	503707002	503707000	60 CHARLES( BOSTON	2215
60651	503809000	503809174	503809000	416 COMMO BOSTON	2215
75166	503916000	503916514	503916000	464 COMMO BOSTON	2215
148657	503703000	503703064	503703000	534 BEACON BOSTON	2215
62099	503870010	503870052	503870010	10 CHARLES( BOSTON	2215
148634	503703000	503703018	503703000	534 BEACON BOSTON	2215
170005	503917000	503917001	503917000	20 CHARLES( BOSTON	2215
60625	503809000	503809122	503809000	416 COMMO BOSTON	2215
60631	503809000	503809134	503809000	416 COMMO BOSTON	2215
60702	503809000	503809284	503809000	400 COMMO BOSTON	2215
75115	503916000	503916020	503916000	466 COMMO BOSTON	2215
125136	503834010	503834012	503834010	409 COMMO BOSTON	2215
60602	503809000	503809076	503809000	416 COMMO BOSTON	2215
60608	503809000	503809088	503809000	416 COMMO BOSTON	2215
75209	503916000	503916600	503916000	464 COMMO BOSTON	2215
75215	503916000	503916612	503916000	464 COMMO BOSTON	2215
81209	503870210	503870218	503870210	4 CHARLESG. BOSTON	2215
81240	503870210	503870280	503870210	4 CHARLESG. BOSTON	2215
125153	503834010	503834040	503834010	409 COMMO BOSTON	2215
125159	503834010	503834046	503834010	409 COMMO BOSTON	2215
75195	503916000	503916572	503916000	464 COMMO BOSTON	2215
149032	503894000	503894000	503894000	463 COMMO BOSTON	2215
60645	503809000	503809162	503809000	416 COMMO BOSTON	2215
60682	503809000	503809242	503809000	416 COMMO BOSTON	2215
60694	503809000	503809266	503809000	416 COMMO BOSTON	2215
60588	503809000	503809032	503809000	400 COMMO BOSTON	2215
75146	503916000	503916078	503916000	466 COMMO BOSTON	2215
75103	503916000	503916002	503916000	466 COMMO BOSTON	2215

111150	503912000	503912000	503912000	589 BEACON BOSTON	2215
60596	503809000	503809064	503809000	416 COMMO BOSTON	2215
81246	503870210	503870292	503870210	4 CHARLESG. BOSTON	2215
81252	503870210	503870304	503870210	4 CHARLESG. BOSTON	2215
125165	503834010	503834052	503834010	409 COMMO BOSTON	2215
75152	503916000	503916090	503916000	466 COMMO BOSTON	2215
49035	503837010	503837012	503837010	413 415 COI BOSTON	2215
148628	503703000	503703006	503703000	534 BEACON BOSTON	2215
148677	503703000	503703104	503703000	534 BEACON BOSTON	2215
75130	503916000	503916046	503916000	466 COMMO BOSTON	2215
75201	503916000	503916584	503916000	464 COMMO BOSTON	2215
33415	503707000	503707026	503707000	7 BAY STATE BOSTON	2215
125145	503834010	503834030	503834010	409 COMMO BOSTON	2215
49044	503837010	503837030	503837010	419 COMMO BOSTON	2215
170418	503895000	503895014	503895000	465 COMMO BOSTON	2215
81081	503896000	503896000	503896000	467 COMMO BOSTON	2215
148669	503703000	503703088	503703000	534 BEACON BOSTON	2215
75107	503916000	503916008	503916000	466 COMMO BOSTON	2215
148646	503703000	503703042	503703000	534 BEACON BOSTON	2215
82194	503893000	503893002	503893000	461 COMMO BOSTON	2215
148692	503703000	503703134	503703000	534 BEACON BOSTON	2215
75124	503916000	503916034	503916000	466 COMMO BOSTON	2215
125151	503834010	503834038	503834010	409 COMMO BOSTON	2215
60706	503809000	503809292	503809000	400 COMMO BOSTON	2215
75184	503916000	503916550	503916000	464 COMMO BOSTON	2215
132184	504175005	504175005	504175005	BEACON ST BOSTON	2215
75170	503916000	503916522	503916000	464 COMMO BOSTON	2215
60660	503809000	503809192	503809000	416 COMMO BOSTON	2215
125137	503834010	503834014	503834010	409 COMMO BOSTON	2215
114231	503911000	503911002	503911000	591 BEACON BOSTON	2215
60614	503809000	503809100	503809000	416 COMMO BOSTON	2215
60620	503809000	503809112	503809000	416 COMMO BOSTON	2215
81221	503870210	503870242	503870210	4 CHARLESG. BOSTON	2215
81227	503870210	503870254	503870210	4 CHARLESG. BOSTON	2215
62094	503870010	503870042	503870010	10 CHARLES( BOSTON	2215
60666	503809000	503809204	503809000	416 COMMO BOSTON	2215
148652	503703000	503703054	503703000	534 BEACON BOSTON	2215
75118	503916000	503916026	503916000	466 COMMO BOSTON	2215
75141	503916000	503916068	503916000	466 COMMO BOSTON	2215
75190	503916000	503916562	503916000	464 COMMO BOSTON	2215
33404	503707000	503707004	503707000	60 CHARLES( BOSTON	2215
75167	503916000	503916516	503916000	464 COMMO BOSTON	2215
62100	503870010	503870054	503870010	10 CHARLES( BOSTON	2215

60697	503809000	503809272	503809000	416 COMMO BOSTON	2215
75210	503916000	503916602	503916000	464 COMMO BOSTON	2215
125154	503834010	503834041	503834010	409 COMMO BOSTON	2215
125160	503834010	503834047	503834010	409 COMMO BOSTON	2215
60626	503809000	503809124	503809000	416 COMMO BOSTON	2215
148686	503703000	503703122	503703000	534 BEACON BOSTON	2215
97222	503914000	503914010	503914000	585 BEACON BOSTON	2215
60603	503809000	503809078	503809000	416 COMMO BOSTON	2215
60677	503809000	503809232	503809000	416 COMMO BOSTON	2215
75161	503916000	503916504	503916000	464 COMMO BOSTON	2215
81235	503870210	503870270	503870210	4 CHARLESG. BOSTON	2215
60654	503809000	503809180	503809000	416 COMMO BOSTON	2215
60703	503809000	503809286	503809000	400 COMMO BOSTON	2215
81261	503870210	503870322	503870210	4 CHARLESG. BOSTON	2215
60634	503809000	503809140	503809000	416 COMMO BOSTON	2215
60646	503809000	503809164	503809000	416 COMMO BOSTON	2215
148629	503703000	503703008	503703000	534 BEACON BOSTON	2215
75147	503916000	503916080	503916000	466 COMMO BOSTON	2215
170412	503895000	503895002	503895000	465 COMMO BOSTON	2215
60597	503809000	503809066	503809000	416 COMMO BOSTON	2215
60683	503809000	503809244	503809000	416 COMMO BOSTON	2215
81241	503870210	503870282	503870210	4 CHARLESG. BOSTON	2215
22323	503704001	503704001	503704001	BEACON ST BOSTON	2215
75204	503916000	503916590	503916000	464 COMMO BOSTON	2215
75104	503916000	503916004	503916000	466 COMMO BOSTON	2215
60591	503809000	503809052	503809000	416 COMMO BOSTON	2215
81247	503870210	503870294	503870210	4 CHARLESG. BOSTON	2215
82197	503893000	503893008	503893000	461 COMMO BOSTON	2215
60640	503809000	503809152	503809000	416 COMMO BOSTON	2215
60663	503809000	503809198	503809000	416 COMMO BOSTON	2215
57036	503704002	503704002	503704002	BEACON ST BOSTON	2215
60686	503809000	503809250	503809000	416 COMMO BOSTON	2215
148672	503703000	503703094	503703000	534 BEACON BOSTON	2215
60709	503809000	503809300	503809000	400 COMMO BOSTON	2215
110321	503817500	503817500	503817500	400 P COMM BOSTON	2115
49041	503837010	503837024	503837010	413 415 COI BOSTON	2215
148695	503703000	503703138	503703000	534 BEACON BOSTON	2215
33412	503707000	503707020	503707000	60 CHARLESC BOSTON	2215
75110	503916000	503916013	503916000	466 COMMO BOSTON	2215
47126	503704003	503704003	503704003	BEACON ST BOSTON	2215
62083	503870010	503870020	503870010	10 CHARLESC BOSTON	2215
148643	503703000	503703036	503703000	534 BEACON BOSTON	2215
114234	503911000	503911008	503911000	591 BEACON BOSTON	2215



148666	503703000	503703082	503703000	534 BEACON BOSTON	2215
49047	503837010	503837036	503837010	419 COMMO BOSTON	2215
148689	503703000	503703128	503703000	534 BEACON BOSTON	2215
60657	503809000	503809186	503809000	416 COMMO BOSTON	2215
60611	503809000	503809094	503809000	416 COMMO BOSTON	2215
60623	503809000	503809118	503809000	416 COMMO BOSTON	2215
75181	503916000	503916544	503916000	464 COMMO BOSTON	2215
81218	503870210	503870236	503870210	4 CHARLESG. BOSTON	2215
75121	503916000	503916030	503916000	466 COMMO BOSTON	2215
75127	503916000	503916040	503916000	466 COMMO BOSTON	2215
33418	503707000	503707032	503707000	7 BAY STATE BOSTON	2215
125148	503834010	503834035	503834010	409 COMMO BOSTON	2215
148703	503703000	503703146	503703000	534 BEACON BOSTON	2215
148649	503703000	503703048	503703000	534 BEACON BOSTON	2215
148655	503703000	503703060	503703000	534 BEACON BOSTON	2215
75173	503916000	503916528	503916000	464 COMMO BOSTON	2215
62091	503870010	503870036	503870010	10 CHARLES( BOSTON	2215
60617	503809000	503809106	503809000	416 COMMO BOSTON	2215
81224	503870210	503870248	503870210	4 CHARLESG. BOSTON	2215
75213	503916000	503916608	503916000	464 COMMO BOSTON	2215
149038	503894000	503894012	503894000	463 COMMO BOSTON	2215
125157	503834010	503834044	503834010	409 COMMO BOSTON	2215
148706	503703000	503703149	503703000	534 BEACON BOSTON	2215
112138	503893500	503893500	503893500	475 P COMM BOSTON	2115
60700	503809000	503809278	503809000	416 COMMO BOSTON	2215
60674	503809000	503809222	503809000	416 COMMO BOSTON	2215
62097	503870010	503870048	503870010	10 CHARLES( BOSTON	2215
75144	503916000	503916074	503916000	466 COMMO BOSTON	2215
148683	503703000	503703116	503703000	534 BEACON BOSTON	2215
81215	503870210	503870230	503870210	4 CHARLESG. BOSTON	2215
81258	503870210	503870316	503870210	4 CHARLESG. BOSTON	2215
97219	503914000	503914004	503914000	585 BEACON BOSTON	2215
60680	503809000	503809238	503809000	416 COMMO BOSTON	2215
75164	503916000	503916510	503916000	464 COMMO BOSTON	2215
81238	503870210	503870276	503870210	4 CHARLESG. BOSTON	2215
148663	503703000	503703076	503703000	534 BEACON BOSTON	2215
75138	503916000	503916062	503916000	466 COMMO BOSTON	2215
75187	503916000	503916556	503916000	464 COMMO BOSTON	2215
62080	503870010	503870014	503870010	10 CHARLES( BOSTON	2215
148640	503703000	503703030	503703000	534 BEACON BOSTON	2215
75207	503916000	503916596	503916000	464 COMMO BOSTON	2215
81207	503870210	503870214	503870210	4 CHARLESG. BOSTON	2215
60600	503809000	503809072	503809000	416 COMMO BOSTON	2215

75158	503916000	503916102	503916000	466 COMMO BOSTON	2215
81244	503870210	503870288	503870210	4 CHARLES G. BOSTON	2215
75193	503916000	503916568	503916000	464 COMMO BOSTON	2215
126551	503913000	503913000	503913000	587 BEACON BOSTON	2215
60637	503809000	503809146	503809000	416 COMMO BOSTON	2215
60643	503809000	503809158	503809000	416 COMMO BOSTON	2215
148626	503703000	503703002	503703000	534 BEACON BOSTON	2215
148632	503703000	503703014	503703000	534 BEACON BOSTON	2215
60594	503809000	503809060	503809000	416 COMMO BOSTON	2215
148675	503703000	503703100	503703000	534 BEACON BOSTON	2215
75150	503916000	503916086	503916000	466 COMMO BOSTON	2215
170415	503895000	503895008	503895000	465 COMMO BOSTON	2215
170702	504155000	504155000	504155000	CHARLES G. BOSTON	2215
82198	503893000	503893010	503893000	461 COMMO BOSTON	2215
60712	503809000	503809308	503809000	400 COMMO BOSTON	2215
75153	503916000	503916092	503916000	466 COMMO BOSTON	2215
75105	503916000	503916006	503916000	466 COMMO BOSTON	2215
49042	503837010	503837026	503837010	413 415 COI BOSTON	2215
62086	503870010	503870026	503870010	10 CHARLES C BOSTON	2215
33413	503707000	503707022	503707000	60 CHARLES C BOSTON	2215
148644	503703000	503703038	503703000	534 BEACON BOSTON	2215
148667	503703000	503703084	503703000	534 BEACON BOSTON	2215
148690	503703000	503703130	503703000	534 BEACON BOSTON	2215
114237	503911000	503911014	503911000	591 BEACON BOSTON	2215
60658	503809000	503809188	503809000	416 COMMO BOSTON	2215
75136	503916000	503916058	503916000	466 COMMO BOSTON	2215
81219	503870210	503870238	503870210	4 CHARLES G. BOSTON	2215
60612	503809000	503809096	503809000	416 COMMO BOSTON	2215
75182	503916000	503916546	503916000	464 COMMO BOSTON	2215
60672	503809000	503809216	503809000	416 COMMO BOSTON	2215
125149	503834010	503834036	503834010	409 COMMO BOSTON	2215
148650	503703000	503703050	503703000	534 BEACON BOSTON	2215
75122	503916000	503916031	503916000	466 COMMO BOSTON	2215
148698	503703000	503703141	503703000	534 BEACON BOSTON	2215
148704	503703000	503703147	503703000	534 BEACON BOSTON	2215
60618	503809000	503809108	503809000	416 COMMO BOSTON	2215
75176	503916000	503916534	503916000	464 COMMO BOSTON	2215
62092	503870010	503870038	503870010	10 CHARLES C BOSTON	2215
125143	503834010	503834026	503834010	409 COMMO BOSTON	2215
60652	503809000	503809176	503809000	416 COMMO BOSTON	2215
148635	503703000	503703020	503703000	534 BEACON BOSTON	2215
60675	503809000	503809229	503809000	416 COMMO BOSTON	2215
75165	503916000	503916512	503916000	464 COMMO BOSTON	2215

148684	503703000	503703118	503703000	534 BEACON BOSTON	2215
62098	503870010	503870050	503870010	10 CHARLES( BOSTON	2215
149039	503894000	503894014	503894000	463 COMMO BOSTON	2215
148658	503703000	503703066	503703000	534 BEACON BOSTON	2215
75139	503916000	503916064	503916000	466 COMMO BOSTON	2215
75216	503916000	503916614	503916000	464 COMMO BOSTON	2215
81210	503870210	503870220	503870210	4 CHARLES( BOSTON	2215
81216	503870210	503870232	503870210	4 CHARLES( BOSTON	2215
60632	503809000	503809136	503809000	416 COMMO BOSTON	2215
75116	503916000	503916022	503916000	466 COMMO BOSTON	2215
81233	503870210	503870266	503870210	4 CHARLES( BOSTON	2215
81239	503870210	503870278	503870210	4 CHARLES( BOSTON	2215
60701	503809000	503809280	503809000	416 COMMO BOSTON	2215
75188	503916000	503916558	503916000	464 COMMO BOSTON	2215
81259	503870210	503870318	503870210	4 CHARLES( BOSTON	2215
97220	503914000	503914006	503914000	585 BEACON BOSTON	2215
149033	503894000	503894002	503894000	463 COMMO BOSTON	2215
148664	503703000	503703078	503703000	534 BEACON BOSTON	2215
60681	503809000	503809240	503809000	416 COMMO BOSTON	2215
75159	503916000	503916104	503916000	466 COMMO BOSTON	2215
75196	503916000	503916574	503916000	464 COMMO BOSTON	2215
75208	503916000	503916598	503916000	464 COMMO BOSTON	2215
60695	503809000	503809268	503809000	416 COMMO BOSTON	2215
81253	503870210	503870306	503870210	4 CHARLES( BOSTON	2215
171798	504198001	504198001	504198001	BROOKLINE BOSTON	2215
75145	503916000	503916076	503916000	466 COMMO BOSTON	2215
125166	503834010	503834053	503834010	409 COMMO BOSTON	2215
60589	503809000	503809034	503809000	416 COMMO BOSTON	2215
60595	503809000	503809062	503809000	416 COMMO BOSTON	2215
60638	503809000	503809148	503809000	416 COMMO BOSTON	2215
69443	503915000	503915000	503915000	583 BEACON BOSTON	2215
60689	503809000	503809256	503809000	416 COMMO BOSTON	2215
75102	503916000	503916000	503916000	466 464 COI BOSTON	2215
49036	503837010	503837014	503837010	413 415 COI BOSTON	2215
170416	503895000	503895010	503895000	465 COMMO BOSTON	2215
148678	503703000	503703106	503703000	534 BEACON BOSTON	2215
148627	503703000	503703004	503703000	534 BEACON BOSTON	2215
148647	503703000	503703044	503703000	534 BEACON BOSTON	2215
75202	503916000	503916586	503916000	464 COMMO BOSTON	2215
33416	503707000	503707028	503707000	7 BAY STATE BOSTON	2215
125146	503834010	503834032	503834010	409 COMMO BOSTON	2215
75179	503916000	503916540	503916000	464 COMMO BOSTON	2215
75156	503916000	503916098	503916000	466 COMMO BOSTON	2215

148670	503703000	503703090	503703000	534 BEACON BOSTON	2215
75133	503916000	503916052	503916000	466 COMMO BOSTON	2215
49045	503837010	503837032	503837010	419 COMMO BOSTON	2215
82195	503893000	503893004	503893000	461 COMMO BOSTON	2215
148641	503703000	503703032	503703000	534 BEACON BOSTON	2215
60669	503809000	503809210	503809000	416 COMMO BOSTON	2215
33410	503707000	503707016	503707000	60 CHARLES( BOSTON	2215
125140	503834010	503834020	503834010	409 COMMO BOSTON	2215
125152	503834010	503834039	503834010	409 COMMO BOSTON	2215
60609	503809000	503809090	503809000	416 COMMO BOSTON	2215
60621	503809000	503809114	503809000	416 COMMO BOSTON	2215
81230	503870210	503870260	503870210	4 CHARLES( BOSTON	2215
60661	503809000	503809194	503809000	416 COMMO BOSTON	2215
81222	503870210	503870244	503870210	4 CHARLES( BOSTON	2215
62089	503870010	503870032	503870010	10 CHARLES( BOSTON	2215
62095	503870010	503870044	503870010	10 CHARLES( BOSTON	2215
60615	503809000	503809102	503809000	416 COMMO BOSTON	2215
75125	503916000	503916036	503916000	466 COMMO BOSTON	2215
148701	503703000	503703144	503703000	534 BEACON BOSTON	2215
75142	503916000	503916070	503916000	466 COMMO BOSTON	2215
81213	503870210	503870226	503870210	4 CHARLES( BOSTON	2215
60698	503809000	503809274	503809000	416 COMMO BOSTON	2215
148681	503703000	503703112	503703000	534 BEACON BOSTON	2215
75119	503916000	503916027	503916000	466 COMMO BOSTON	2215
60649	503809000	503809170	503809000	416 COMMO BOSTON	2215
60655	503809000	503809182	503809000	416 COMMO BOSTON	2215
62078	503870010	503870010	503870010	10 CHARLES( BOSTON	2215
148638	503703000	503703026	503703000	534 BEACON BOSTON	2215
97217	503914000	503914000	503914000	585 BEACON BOSTON	2215
149036	503894000	503894008	503894000	463 COMMO BOSTON	2215
148661	503703000	503703072	503703000	534 BEACON BOSTON	2215
60606	503809000	503809084	503809000	416 COMMO BOSTON	2215
60704	503809000	503809288	503809000	400 COMMO BOSTON	2215
75185	503916000	503916552	503916000	464 COMMO BOSTON	2215
148687	503703000	503703124	503703000	534 BEACON BOSTON	2215
60629	503809000	503809130	503809000	416 COMMO BOSTON	2215
60678	503809000	503809234	503809000	416 COMMO BOSTON	2215
75113	503916000	503916017	503916000	466 COMMO BOSTON	2215
75162	503916000	503916506	503916000	464 COMMO BOSTON	2215
81236	503870210	503870272	503870210	4 CHARLES( BOSTON	2215
33407	503707000	503707010	503707000	60 CHARLES( BOSTON	2215
125155	503834010	503834042	503834010	409 COMMO BOSTON	2215
125163	503834010	503834050	503834010	409 COMMO BOSTON	2215

49039	503837010	503837020	503837010	413 415 COI	BOSTON	2215
81256	503870210	503870312	503870210	4 CHARLES	G. BOSTON	2215
60586	503809000	503809010	503809000	400 COMMO	BOSTON	2215
60598	503809000	503809068	503809000	416 COMMO	BOSTON	2215
60635	503809000	503809142	503809000	416 COMMO	BOSTON	2215
75205	503916000	503916592	503916000	464 COMMO	BOSTON	2215
81242	503870210	503870284	503870210	4 CHARLES	G. BOSTON	2215
60692	503809000	503809262	503809000	416 COMMO	BOSTON	2215
81250	503870210	503870300	503870210	4 CHARLES	G. BOSTON	2215
170413	503895000	503895004	503895000	465 COMMO	BOSTON	2215
60592	503809000	503809054	503809000	416 COMMO	BOSTON	2215
60641	503809000	503809154	503809000	416 COMMO	BOSTON	2215
75199	503916000	503916580	503916000	464 COMMO	BOSTON	2215

OWNER	ADDRESSEE	MAIL_ADDRESS	MAIL_CS	STATE	MAIL_ZIPCODE	Shape_Area
OZDEMIR NA	C/O SAIT E C	416 COMMO BOSTON		MA	2215	42284.8674
AUDREY HOF	C/O JAY M P,	416 COMMO BOSTON		MA	2215	42284.8674
DAO MARIA CARLOTA	4 CHARLESG,	BOSTON		MA	2215	11699.074
TANG TRACY TIANLY	416 COMMO	BOSTON		MA	2215	42284.8674
LEE DANIEL YENHONG	591 BEACON	BOSTON		MA	2215	1317.28149
NEWBURY S	C/O LONGW	429 NEWBU BOSTON		MA	2115	42284.8674
GIULIANO FAMILY TRUST	534 BEACON	BOSTON		MA	2215	13411.3491
BADER JAMIE	10 CHARLES	BOSTON		MA	2215	7560.31372
KASDON MU	C/O CHARLES	867 BOYLST(BOSTON		MA	2116	8534.74146
YOSHIDA TERENCE R	534 BEACON	BOSTON		MA	2215	13411.3491
JAMES P COLTON REVOC	461 COMMO	BOSTON		MA	2215	3568.74731
BAKER ELIZABETH K	534 BEACON	BOSTON		MA	2215	13411.3491
FULKERSON JUDITH T	PO BOX 149	CENTER SAN NH			3227	42284.8674
FECHTOR KENNETH	416 COMMO	BOSTON		MA	2215	42284.8674
MALEKIAN SHAHLA	45 EAGLE DR	NOVATO		CA	94949	18172.7205
KHOKHAR SABA	4 CHARLESG,	BOSTON		MA	2215	11699.074
GOKCE NOY	C/O NOYAN	53 SHEFFIEL NEWTONVIL		MA	2460	42284.8674
HONG LIU N	300 WASHIN	DREAMGATE NEWTON		MA	2458	11699.074
THAKOR BH	1 CPL CHARL	C/O SHILPA T WOBURN		MA	1801	18172.7205
MEMORIAL F HANNAH DO	P O BOX 456	WINCHESTEF		MA	1890	18172.7205
TSAO WEN-NA	10 CHARLES	BOSTON		MA	2215	7560.31372
REEF HOWARD S	409 COMMO	BOSTON		MA	2215	12127.156
PIERRE R VIL PIERRE VILLE	409 COMMO	BOSTON		MA	2215	12127.156
FANDINO CA	C/O REINA D	25 WORCEST BOSTON		MA	2118	13411.3491
GHANI NAVEED	466 COMMO	BOSTON		MA	2215	18172.7205
DISTEFANO ERICA T	4 CHARLESG,	BOSTON		MA	2215	11699.074
OSADZINSKI RICHARD	534 BEACON	BOSTON		MA	2215	13411.3491
FRAAS STEFAN	392 MARLBC	BOSTON		MA	2115	42284.8674
IACOI JOHN M TS	534 BEACON	BOSTON		MA	2215	13411.3491
GEVONDIAN ROUSANNA	463 COMMO	BOSTON		MA	2215	2609.16284
DAVID & VICI	12 LOCKE ST	C/O DAVID & ANDOVER		MA	1810	13411.3491
ZIMMERMAN RALPH	416 COMMO	BOSTON		MA	2215	42284.8674
TINGLEY ADELAIDE M	534 BEACON	BOSTON		MA	2215	13411.3491
DAUGHTERS	C/O KATHLEE	20 CHARLES(BOSTON		MA	2215	10283.8818
LINDSAY CAF	C/O CAROLY	416 COMMO BOSTON		MA	2215	42284.8674
SEBAOUN JE	C/O CHARLES	867 BOYLST(BOSTON		MA	2115	18172.7205
SIXTY CHARLES	GATE WES	60 CHARLES(BOSTON		MA	2215	8534.74146
PSALTOS JOHN	416 COMMO	BOSTON		MA	2215	42284.8674
PINE CONE PROPERTIES L	236 NAHANT	NAHANT		MA	1908	42284.8674
LOPEZ ERNE	C/O NORMA	2 MARBLE R N ANDOVER		MA	1845	11699.074
FIVE85 BEAC	C/O URI TAS	P O BOX 214 BALTIMORE		MD	21282	1544.49976
THE BRADLEY CONDO TR	409 COMMO	BOSTON		MA	2215	12127.156

NAJAFABADI REZA	534 BEACON BOSTON	MA	2215	13411.3491
XIONG WEI	416 COMMO BOSTON	MA	2215	42284.8674
JUNG ELIOT S	1 ALDERWOOD SYOSSET	NY	11791	18172.7205
SACHDEO AMIT	464 COMMO BOSTON	MA	2215	18172.7205
LIU CHING-HUI	11 MANOR # WELLESLEY	MA	2482	11699.074
ALVARADO JOSEPH	409 COMMO BOSTON	MA	2215	12127.156
FARNUM STELLA MARY	534 BEACON BOSTON	MA	2215	13411.3491
JUDY A HABIB TRUST-200	416 COMMO BOSTON	MA	2215	42284.8674
IL QUADRO S C/O GHERAR	VIA PROTAG ROMA ITALY		124	18172.7205
SAUDER GLENN E	4 CHARLES ST BOSTON	MA	2215	11699.074
VONACHEN FRANK W	40 LAKEVIEW FRAMINGHAM	MA	1701	8534.74146
KURAGAYALA NANDINI	2304 S LAKE CEDAR PARK TX		78613	42284.8674
PAPADOPOULOS STAVROS	34 GRANDVIEW CHELMSFORD MA		1824	13411.3491
SEKHAR BOO 4 CHARLES ST	C/O PHALGU BOSTON MA		2215	11699.074
SARGIS KEVIN M	76 BEDFORD LEXINGTON MA		2420	12127.156
MARILL NINJA C/O THOMAS	142 BRATTLE CAMBRIDGE MA		2138	42284.8674
BEAVERS LIN C/O LINDA B	1606 PALMA BRADENTON FL		34209	42284.8674
HURWITZ JOEL L	47 CATHERINE PEABODY MA		1960	18172.7205
THEBRAEM C/O LAUREN	57 UPLAND # BROOKLINE MA		2445	18172.7205
MEADS OF COMMONWEALTH	413 COMMO BOSTON MA		2215	12394.9827
ABERIZK KARA	413-415 COM BOSTON MA		2215	12394.9827
LIU YUNQIAN C/O Z & C PR	56 KENDALL QUINCY MA		2171	11699.074
CHAPMAN JOSEPH D	4 CHARLES ST BOSTON MA		2215	11699.074
MEYER RICKI C/O RICKI B I	416 COMMO BOSTON MA		2215	42284.8674
MCMILLEN JI C/O HM PAY	PO BOX 31 PORTLAND ME		4101	42284.8674
RICHBERG AMIRAM	466 COMMO BOSTON MA		2215	18172.7205
ODETTE FRANCIS J	464 COMMO BOSTON MA		2215	18172.7205
SHU JIAJUN	464 COMMO BOSTON MA		2215	18172.7205
ST PIERRE M C/O MICHELL	413-415 COM BOSTON MA		2215	12394.9827
SHPUNT ALEXANDER	45 BEAR PAV PORTOLA VA CA		94028	18172.7205
ADKISSON GREGORY	534 BEACON BOSTON MA		2215	13411.3491
LEHMAN MATT	466 COMMO BOSTON MA		2215	18172.7205
GROSSBART TED A	466 COMMO BOSTON MA		2215	18172.7205
ADLER AMY	10 CHARLES ST BOSTON MA		2215	7560.31372
KASDON MU C/O CHARLES	867 BOYLSTON BOSTON MA		2116	8534.74146
PHK SOMERS C/O PAULA F	900 BEACH R VERO BEACH FL		32963	42284.8674
FOUR 61 CONDOMINIUM	461 COMMO BOSTON MA		2215	3568.74731
COMMUNITY C/O ROBERT	418 COMMO BOSTON MA		2215	42284.8674
DONALD C YI C/O DONALD	6507 145 A S EDMONTON ALBERTA CAI		0	7560.31372
LIU XIA	3416 MATA # PLANO TX		75025	1317.28149
MONAGHAN IMELDA	464 COMMO BOSTON MA		2215	18172.7205
ROKOFF KENNETH	464 COMMO BOSTON MA		2215	18172.7205
BUCCI MARY C/O MARY B	534 BEACON BOSTON MA		2215	13411.3491

483-66 TOWERS LLC	464 COMMO BOSTON	MA	2215	18172.7205
PIERRE R VIL C/O PIERRE \	409 COMMO BOSTON	MA	2215	12127.156
RADOVINSKY C/O RADOVI	591 BEACON BOSTON	MA	2215	1317.28149
CSAPO VANESSA MARIE	416 COMMO BOSTON	MA	2215	42284.8674
FULEIHAN G C/O NABIL F	76 MANOR # WELLESLEY	MA	2482	42284.8674
MISRA MEGHNA V	4 CHARLESG, BOSTON	MA	2215	11699.074
KILIC NURI ETAL	207 FULLER : BROOKLINE	MA	2446	42284.8674
WANG JINGPU	10 CHARLES( BOSTON	MA	2215	7560.31372
BURNS MATTHEW G	409 COMMO BOSTON	MA	2215	12127.156
FALLAHI IRAN	1421 NARRC MONTGOME AL		36111	13411.3491
FULKERSON JUDITH	PO BOX 149 CENTER SAN NH		3227	42284.8674
KERRY A SMI C/O KERRY A	4 CHARLESG, BOSTON	MA	2215	11699.074
HABIB JUDY	416 COMMO BOSTON	MA	2215	42284.8674
TARTAGLIA F C/O JOANN	416 COMMO BOSTON	MA	2215	42284.8674
DIMA LILIANA	466 COMMO BOSTON	MA	2215	18172.7205
SLOAN C DIANNE	534 BEACON BOSTON	MA	2215	13411.3491
KOTNANI PADMAJA	89 CORTLAN BOXBOROU(	MA	1719	2609.16284
KING KEVIN I C/O KEVIN K	534 BEACON BOSTON	MA	2215	13411.3491
WEINER ALAN M	464 COMMO BOSTON	MA	2215	18172.7205
MASTERSON JOHN	10 CHARLES( BOSTON	MA	2215	7560.31372
DERMODY ALICIA	534 BEACON BOSTON	MA	2215	13411.3491
RAUMIN HAI C/O HARLEY	464 COMMO BOSTON	MA	2215	18172.7205
KOTELIANSKI VICTOR E	4 CHARLESG, BOSTON	MA	2215	11699.074
PYES MERRIL	40 MCINTOS BEDFORD	NH	3110	8534.74146
SPITALNY GLORIA	416 COMMO BOSTON	MA	2215	42284.8674
NORTH TERRI	466 COMMO BOSTON	MA	2215	18172.7205
FRENCH CHRISTOPHER	464 COMMO BOSTON	MA	2215	18172.7205
DAVISON ALI C/O GLEN M	7 SQUIRREL WAYLAND	MA	1778	11699.074
FIVE 85 BEA( C/O URI TAS P	O BOX 214 BALTIMORE	MD	21282	1544.49976
RIVERA V LU C/O ALEJANI	463 COMMO BOSTON	MA	2215	2609.16284
GNATOVICH STANA M	413-415 COM BOSTON	MA	2215	12394.9827
MAGILL KEITH	4 CHARLESG, BOSTON	MA	2215	11699.074
FOUR 65 COMMONWEAL	465 COMMO BOSTON	MA	2215	2554.05957
SULLIVAN D/ C/O CHARLES	31 WESTWA CHATHAM	MA	2633	42284.8674
ZHOU YUXIN	466 COMM( BOSTON	MA	2215	18172.7205
WAN SIUYU SIU YU LILLY	16 ARBOR R( ROSYLYN	NY	11577	18172.7205
MONAGHAN IMELDA	43 BOW ST NEWTON	MA	2459	18172.7205
BANN DAVID SUYUNG	416 COMMO BOSTON	MA		42284.8674
CHARLES( GATE CONDOMI	4 CHARLESG, BOSTON	MA	2215	11699.074
KREMER PAULA	409 COMMO BOSTON	MA	2215	12127.156
ALSHARIKH # C/O CENTUR	575 BOYLST( BOSTON	MA	2116	42284.8674
TAMARA AND DANYA LLC	416 COMMO BOSTON	MA	2215	42284.8674
DOROTHEOL C/O ACHILLE,	1128 REDWC HUDSON	OH	44236	13411.3491



YE MICHELLE	534 BEACON BOSTON	MA	2215	13411.3491
STARR RICH/ C/O RICK ST/	970 16TH PL/ VERO BEACH	FL	32960	42284.8674
DUONG SHARON	59-33 GATES RIDGEWOOD	NY	11385	18172.7205
SPORTS STAI C/O JUDITH I	66 WESTWO ELLENVILLE	NY	12428	18172.7205
ZHEN ZHAO	465 COMMO BOSTON	MA	2215	2554.05957
O'MALLEY FRANCESCA AN	534 BEACON BOSTON	MA	2215	13411.3491
SUN WAI-YAN	375 MAIN ST LYNNFIELD	MA	1940	13411.3491
SYNODINOS MARIA	949 AMESBL HAVERHILL	MA	1830	42284.8674
JOURNEYS INVESTMENTS	142 HIGHLAN WINCHESTEF	MA	1890	18172.7205
SICILIANO DONNA A	89 WINTHRC BROOKLINE	MA	2445	42284.8674
ZHONG XIAOTIAN	466 COMMO BOSTON	MA	2215	18172.7205
M CHARLES	GATE EAST LL 10 CHARLES(	BOSTON MA	2215	7560.31372
RATANASIRINTRAWOOT I	60 HOBBS RI WALTHAM	MA	2452	13411.3491
XU BOWEI	416 COMMO BOSTON	MA	2215	42284.8674
STEPHROCO INC	35 ALLISON I KATONAH	NY	10536	18172.7205
WALTER WE C/O WALTER	534 BEACON BOSTON	MA	2215	13411.3491
COMMUNITI C/O ROBERT	418 COMMO BOSTON	MA	2215	42284.8674
LEVY IGAL	466 COMMO BOSTON	MA	2215	18172.7205
KAUR SHUBJEET	419 COMMO BOSTON	MA	2215	12394.9827
591 BEACON C591 BEACO	93 FISHER A' BROOKLINE	MA	2445	1317.28149
DEMIDOV VADIM	591 BEACON BOSTON	MA	2215	1317.28149
DOWD BARBARA B	10 CHARLES( BOSTON	MA	2215	7560.31372
BAHRI AJAY	416 COMMO BOSTON	MA	2215	42284.8674
ALI MIR	60 CHARLES( BOSTON	MA	2215	8534.74146
KREMER PAULA	409 COMMO BOSTON	MA	2215	12127.156
SCULLY ABIGAIL H	534 BEACON BOSTON	MA	2215	13411.3491
HOLT ERIC B C/O ERIC B F	11916 KEATI TAMPA	FL	33626	18172.7205
AIZAWA ESTATE MNGT LL	27 MAYFLOV WINCHESTEF	MA	1890	11699.074
FINCKER MAEVA	10 CHARLES( BOSTON	MA	2215	7560.31372
GUO LIFEI	60 CHARLES( BOSTON	MA	2215	8534.74146
MASS TURNPIKE AUTHOR	CHARLESGA1 BOSTON	MA	2215	31289.9233
WROE CAND C/O THOMA(	PO BOX 879 EAST DENNI(	MA	2641	42284.8674
JEN PROPERTIES LTD	234 FISHER / BROOKLINE	MA	2445	11699.074
STOBER ARIELLA	534 BEACON BOSTON	MA	2215	13411.3491
FRIEDMAN ROBERT	24 LONGELL WAYNE	NJ	7470	18172.7205
JUDY A HABIB TRUST-200	416 COMMO BOSTON	MA	2215	42284.8674
466 UNIT 605 LLC	931 SALEM E FRAMINGHA	MA		18172.7205
R&L LLC C/O MIN REI	7755 VILLAG BEAUMONT TX		77713	13411.3491
PRETORIUS C/O ABRAHA	6778 N 83RC SCOTTSDALE	AZ	85250	18172.7205
ROSS ALEXA/ ALEXANDER	7 HASTINGS WELLESLEY	MA	2481	18172.7205
CALLANAN J/ C/O NANCY (	102 RIVER R/ HANOVER	MA	2339	2609.16284
KASDON MU C/O CHARLE(	867 BOYLST( BOSTON	MA	2116	8534.74146
METROPOLITAN DISTRICT	CHARLESGA1 BOSTON	MA	2215	70386.2588

HUANG DANIEL J	242 CLENT R GREAT NECK NY	11021	7560.31372
INGALLS ALICIA	255 NEWBU BOSTON MA	2116	13411.3491
LAMBERT G/ C/O GARY A	36 COBBLES` N EASTON MA	2356	7560.31372
ALMATHKOC C/O CENTUR	575 BOYLST( BOSTON MA	2116	42284.8674
MCDERMOTT MICHAEL	416 COMMO BOSTON MA	2215	42284.8674
LEHMAN MATTHEW	464 COMMO BOSTON MA	2215	18172.7205
NATTEAU NICHOLAS J	464 COMMO BOSTON MA	2215	18172.7205
SCOUROS EVANGELOS	4 CHARLESG, BOSTON MA	2215	11699.074
REEF HOWARD S	409 COMMO BOSTON MA	2215	12127.156
POWELL ADAM COOPER	11 BEACH ST BOSTON MA	2111	18172.7205
BUCCI MARY D	16A GATES L WAKEFIELD MA	1880	13411.3491
BARCA ERIK	413-415 CON BOSTON MA	2215	12394.9827
SOMERSET CONDO TR	416 COMMO BOSTON MA	2215	42284.8674
HENDI JUSTIN	416 COMMO BOSTON MA	2215	42284.8674
SALAMIPOUR HAMID	416 COMMO BOSTON MA	2215	42284.8674
SUN YIJING	464 COMMO BOSTON MA	2215	18172.7205
MAHONEY WILLIAM F TS	4 CHARLESG, BOSTON MA	2215	11699.074
BERENJIAN AZITA	4 CHARLESG, BOSTON MA	2215	11699.074
KOZMA ROBERT	4 CHARLESG, BOSTON MA	2215	11699.074
KOHLBERG C C/O KURT KC	409 COMMO BOSTON MA	2215	12127.156
FARKAS JEFFREY	464 COMMO BOSTON MA	2215	18172.7205
CAPOSSELA TONI-LEE	507 COLUME BOSTON MA	2118	2554.05957
CHARLESVIEW CONDOMIIP	534 BEACON BOSTON MA	2215	13411.3491
MATHEW PAUL	416 MARLBC BOSTON MA	2115	13411.3491
TAO JIANGUO	534 BEACON BOSTON MA	2215	13411.3491
KHULLAR CH, C/O CHANDE	83 WINTERG EDISON NJ	8820	13411.3491
MCDONALD MADELEINE T	95 MAIN ST MARSHFIELD MA	2050	18172.7205
HAZEN LISA A	416 COMMO BOSTON MA	2215	42284.8674
M & K BERN: I MELVIN BEI	416 COMMO BOSTON MA	2215	42284.8674
GANESHAPP, C/O RUKMIN	4 CHARLESG, BOSTON MA	2215	11699.074
FULEIHAN N, C/O NABIL F	76 MANOR # WELLESLEY MA	2482	42284.8674
ET BUSINESS CHARLESGA	1867 BOYLST( BOSTON MA	2116	18172.7205
KANO BASSII C/O AVERY F	597A TREMC BOSTON MA	2118	2554.05957
SERAFYN JENNIFER	12 BUTLER S DORCHESTEF MA		1317.28149
BAIRD CHRIS C/O CHRISTC	416 COMMO BOSTON MA	2215	42284.8674
SHEE RAE WEN	466 COMMO BOSTON MA	2215	18172.7205
XU LU	10 CHARLES( BOSTON MA	2215	7560.31372
PRICE REBEKAH J	534 BEACON BOSTON MA	2215	13411.3491
ADKISSON GREGORY	170 MARTIN WHITE PLAIN NY	10602	13411.3491
KEENE LAUREN	534 BEACON BOSTON MA	2215	13411.3491
JJM REAL ES` C/O JOSEPH	400 COMMO BOSTON MA	2215	42284.8674
FIVE 91 BEACON ST COND	591 BEACON BOSTON MA	2215	1317.28149
LEHR MARK C/O LYDIA E	466 COMMO BOSTON MA	2215	18172.7205

BALAKRISHNAN REVATHI	466 COMMO BOSTON	MA	2215	18172.7205
JILANI FARIDA	219 WEST H' GOSHEN	CT	6756	42284.8674
BEAVERS ALEX	1606 PALMA BRADENTON	FL	34209	42284.8674
WOO ALLEN C	4 CHARLESG. BOSTON	MA	2215	11699.074
MCLEAN DARIA L	4 CHARLESG. BOSTON	MA	2215	11699.074
WEINER ALAN M	464 COMMO BOSTON	MA	2215	18172.7205
BURNS MATTHEW G	409 COMMO BOSTON	MA	2215	12127.156
WERTHER CAROL	416 COMMO BOSTON	MA	2215	42284.8674
GIDDINGS DAVID THEODC	955 LAUREL\ CARMEL	IN	46032	12127.156
BOSTON CH/ C/O SHIH-CH	200 LINCOLN BOSTON	MA	2111	13411.3491
SAILLANT VIRGINIA M	416 COMMO BOSTON	MA	2215	42284.8674
GU RUOXI	227 BABCOCK BOSTON	MA	2115	11699.074
HOOPER MARTHA C	534 BEACON BOSTON	MA	2215	13411.3491
LAHMADI WAHID	16 PARTRIDGE ESSEX	VT	5452	18172.7205
BI-COASTAL C/O LYDIA M	6343 CAPRIC AGOURA HIL	CA	91301	18172.7205
GRAZIOSE DAVID ANTHO	60 CHARLESC BOSTON	MA	2215	8534.74146
SWEDER KEN C/O KENNET	416 COMMO BOSTON	MA	2215	42284.8674
BRAEMORE C/O SBC2 PR 28	DAMREEL SOUTH BOST	MA	2127	18172.7205
STETSON AT C/O DAVID S	4 BOYCE FAF LINCOLN	MA	1773	13411.3491
YAT-CHUNG KOH	10 CHARLESC BOSTON	MA	2215	7560.31372
LAMM DAVID T	534 BEACON BOSTON	MA	2215	13411.3491
DAUGHTERS C/O KATHLEE	20 CHARLESC BOSTON	MA	2215	10283.8818
AMSALEM ANNIE M	10 HAMLET S NEWTON CE	MA	2459	42284.8674
LO CHI CHEUNG	416 COMMO BOSTON	MA	2215	42284.8674
AFRITERRA L C/O GERLAD	1201 5TH AV ST PETERSBI	FL	33705	42284.8674
LITE ARTHUR R TS	4 WOODCLIF HOLBROOK	MA	2343	18172.7205
CORNELL JAMES K	409 COMMO BOSTON	MA	2215	12127.156
SUNFLOWER C/O LONGFE	PO BOX 815( WELLESLEY	MA	2481	42284.8674
CANDAN MIC C/O M CAND	88 - 30 51ST ELMHURST	NY	11373	42284.8674
NUN-BIN JUI C/O URI BIN	9 HIGHLAND WESTFORD	MA	1886	18172.7205
GRAPPO MICHAEL J	896 BEACON BOSTON	MA	2215	18172.7205
CATHERINE CHARLESGATE	492 BEACON BOSTON	MA	2115	11699.074
TOUPIN DAVID	4 CHARLESG. BOSTON	MA	2215	11699.074
CORNELL JAMES K	409 COMMO BOSTON	MA	2215	12127.156
GARDINER N C/O KINGSLE	625 MAIN ST MILLIS	MA	2054	12127.156
MAGNO MAI C/O MARIFE	101 NAVIGA SCOTTS VALI	CA	95066	18172.7205
FOUR 63 COMM AV CONC	463 COMMO BOSTON	MA	2215	2609.16284
SIEFERT FAMILY HOLDING	28 CRESTWC NORTH REAI	MA	1864	42284.8674
EDELSTEIN RALPH J TS	82 BOYLES S BEVERLY	MA	1915	42284.8674
TOMS JAMES H TS	24 LINCOLN MEDFORD	MA	2155	42284.8674
BAILEY ANTHONY M	416 COMMO BOSTON	MA	2215	42284.8674
EWA-HENSH C/O EKEI HEI	466 COMMO BOSTON	MA	2215	18172.7205
XIAO REALTY TRUST	200 PARKER NEWTON	MA	2459	18172.7205

587-589 BEACON STREET	103 HEMENV	BOSTON	MA	2115	1541.89087
BEAUMONT JORDAN W	173 OAK ST	NEWTON	MA	2464	42284.8674
MAFFEI ROS C/O ROSEMA	4 CHARLES	BOSTON	MA	2215	11699.074
LUCAS ELMER DOUGLAS	6301 SHAR	CHARLOTTE	NC	28210	11699.074
SARGIS KEVIN M	76 BEDFORD	LEXINGTON	MA	2420	12127.156
CRESSWELL C/O CYNTHIA	70 WEST AV	HANOVER,	MA	2339	18172.7205
HICKS CHRISTIAN B	413 415 COM	BOSTON	MA	2215	12394.9827
HULASI RAVI ALVIN	26C LAKE ST	SOMERVILLE	MA	2143	13411.3491
MJ JOHNSON C/O PATRICE	534 BEACON	BOSTON	MA	2215	13411.3491
GREENBAUM C/O JASON C	3971 SANTA	SAN DIEGO	CA	92130	18172.7205
GRAPPO MICHAEL	896 BEACON	BOSTON	MA	2215	18172.7205
RUZICKA MICHAEL	7 BAY STATE	BOSTON	MA	2215	8534.74146
SARGIS KEVIN M	76 BEDFORD	LEXINGTON	MA	2420	12127.156
KUENSTNER PAUL E	419 COMMO	BOSTON	MA	2215	12394.9827
REIDHAAR-OLSON JOHN F	465 COMMO	BOSTON	MA	2215	2554.05957
ARENELLA G C/O FOUR 6	PO BOX 456	SOMERVILLE	MA	2145	2277.44263
OSADZINSKI C/O ERICA O	534 BEACON	BOSTON	MA	2215	13411.3491
XIAO REALTY TRUST	200 PARKER	NEWTON	MA	2459	18172.7205
TANG NING	1914 PINE ST	SAN FRANCISCO	CA	94109	13411.3491
SHARON HUCUL REVOCAE	461 COMMO	BOSTON	MA	2215	3568.74731
NEELEY ANDRENA C	534 BEACON	BOSTON	MA	2215	13411.3491
CHIU WENDY C/O NICHOL	466 COMMO	BOSTON	MA	2215	18172.7205
OASIS HOTEL C/O OASIS H	409 COMMO	BOSTON	MA	2215	12127.156
QUINN JAME C/O GARY M	400 COMMO	BOSTON	MA	2215	42284.8674
KIM EUN JA	464 COMMO	BOSTON	MA	2215	18172.7205
METROPOLITAN DIST COM	BEACON	BOSTON	MA	2215	221695.312
ZHAO BIN	464 COMMO	BOSTON	MA	2215	18172.7205
CHING WONG TRUST	50 KEUNE CC	STATEN ISLAND	NY	10304	42284.8674
KOHLBERG CURT	409 COMMO	BOSTON	MA	2215	12127.156
CABRAL JOSEPH	591 BEACON	BOSTON	MA	2215	1317.28149
MORREALE F C/O CARMIN	416 COMMO	BOSTON	MA	2215	42284.8674
LAZARIS BAF C/O BARBAR	416 COMMO	BOSTON	MA	2215	42284.8674
DUNG VO ANH	4 CHARLES	BOSTON	MA	2215	11699.074
LEE DEREK H C/O DERICK I	4 CHARLES	BOSTON	MA	2215	11699.074
GALLAGHER PAUL DONAL	10 CHARLES	BOSTON	MA	2215	7560.31372
ZEH SUMMER B	29 GRAYSON	NEWTON	MA	2462	42284.8674
LIU QIN	153 WALPOL	DOVER	MA	2090	13411.3491
STOOKEY JEFFREY	67 MOUNT	BOSTON	MA	2108	18172.7205
DONG XI XI	466 COMMO	BOSTON	MA	2215	18172.7205
464-466 COM C/O 454-466	464 COMMO	BOSTON	MA	2215	18172.7205
KOOP REALT C/O TODD K	4 SQUIRREL	WAYLAND	MA	1778	8534.74146
WEINER ALAN M	464 COMMO	BOSTON	MA	2215	18172.7205
GERAGHTY JAMES A	10 CHARLES	BOSTON	MA	2215	7560.31372

SOMERSET CP LLC	416 COMMO BOSTON	MA	2215	42284.8674
TSIROZIDOU IRENE	74 LOTHROP BEVERLY	MA	1915	18172.7205
CORNELL JAMES K	409 COMMO BOSTON	MA	2215	12127.156
KREMER PAULA	409 COMMO BOSTON	MA	2215	12127.156
LIN WEN-JUI	416 COMMO BOSTON	MA	2215	42284.8674
KRIEZIS CONSTANTINE	534 BEACON BOSTON	MA	2215	13411.3491
FIVE 85 BEACON C/O URI TAS	P O BOX 214 BALTIMORE	MD	21282	1544.49976
BERMAN VIC C/O NELSON	292 NEWBU BOSTON	MA	2115	42284.8674
SULISTIO LEE LEE	416 COMMO BOSTON	MA	2215	42284.8674
LEHMAN MATTHEW	464 COMMO BOSTON	MA	2215	18172.7205
DUNG VO ANH	4 CHARLES ST. BOSTON	MA	2215	11699.074
GOKCE NOYAN C/O NOYAN	53 SHEFFIELD NEWTONVIL	MA	2460	42284.8674
MORREALE C/O CARMIN	400 COMMO BOSTON	MA	2215	42284.8674
HUANG CHUYAN	4 CHARLES ST. BOSTON	MA	2215	11699.074
MEHANNA ROBERT	416 COMMO BOSTON	MA	2215	42284.8674
KAMAL MOHAMMED	416 COMMO BOSTON	MA	2215	42284.8674
THREE LAPA C/O KUN LI Z	534 BEACON BOSTON	MA	2215	13411.3491
JING LU MD INC	500 N GARD MONTEREY	CA	91754	18172.7205
DAI WENHAI	465 COMMO BOSTON	MA	2215	2554.05957
COSGROVE GARTH R	416 COMMO BOSTON	MA	2215	42284.8674
ESSERREMM C/O CABOT	213 NEWBU BOSTON	MA	2116	42284.8674
SCHAEFER AIC/O ANNE-C	811 MARTIN GROTON	MA	1450	11699.074
COMMWLTH OF MASS	BEACON BOSTON	MA	2215	68243.5105
YU JIE	464 COMMO BOSTON	MA	2215	18172.7205
HOLT MARK I	43 BOW RD NEWTON	MA	2459	18172.7205
STEERFORTH REALTY TRU	50 CONGRES BOSTON	MA	2109	42284.8674
HABERIS JOHN	1401 BEACON BROOKLINE	MA	2446	11699.074
ZHOU LIPING	461 COMMO BOSTON	MA	2215	3568.74731
VERLY JACQUE C/O JACQUE	386 RUE D.L. B4031 ANGLR	BELGIUM	0	42284.8674
STOY JOSEPH C/O EDWARI	416 COMMO BOSTON	MA	2215	42284.8674
METROPOLITAN DISTRICT	BEACON BOSTON	MA	2215	15743.1919
REICHLIN ABBOTT L	416 COMMO BOSTON	MA	2215	42284.8674
LAINÉ JUHA-PEKKA	534 BEACON BOSTON	MA	2215	13411.3491
NEWBURY S C/O LONGW	429 NEWBU BOSTON	MA	2115	42284.8674
CITY OF BOS PUBLIC IMPR	1 CITY HALL I BOSTON	MA	2201	77383.6543
PHOBOS LLC	413-415 COM BOSTON	MA	2215	12394.9827
BAKER ELIZABETH	534 BEACON BOSTON	MA	2215	13411.3491
PETERSON NATHANIEL	60 CHARLES ST BOSTON	MA	2215	8534.74146
CARNEIRO JEANNETTE D	466 COMMO BOSTON	MA	2215	18172.7205
METROPOLITAN DISTRICT	BEACON BOSTON	MA	2215	9952.86523
ANDERSON ROLAND III	10 CHARLES ST BOSTON	MA	2215	7560.31372
ROCHFORD TIMOTHY	534 BEACON BOSTON	MA	2215	13411.3491
ANJOMI ELAHEH	8 LEXINGTON CHARLESTON	MA	2129	1317.28149

BENTLEY JOHN R	26 VALLEYW COS COB	CT	6807	13411.3491
LITTLE MARK C/O MARK &	512 WINDSC NISKAYUNA	NY	12309	12394.9827
KORZON JEFFREY	534 BEACON BOSTON	MA	2215	13411.3491
SINDI FAIGA C/O YASMIN	416 COMMO BOSTON	MA	2215	42284.8674
EMIROGLU MEHMET H	416 COMMO BOSTON	MA	2215	42284.8674
ANAND REAI C/O GAURIK, PO BOX 1245	CONCORD	MA	1742	42284.8674
SON WESLEY KYUHAN	464 COMMO BOSTON	MA	2215	18172.7205
TALEGHANI PARASTOO V, 4 CHARLESG,	BOSTON	MA	2215	11699.074
MARDIROSSIAN DICKRAN	15 LONGME, BELMONT	MA	2478	18172.7205
464-466 COM C/O 464-466 464	COMMO BOSTON	MA	2215	18172.7205
VFRE LLC C/O PARKER ONE CONSTI	BOSTON	MA	2129	8534.74146
PIERRE R VIL PIERRE VILLE	409 COMMO BOSTON	MA	2215	12127.156
KORZON JEFFREY	534 BEACON BOSTON	MA	2215	13411.3491
MADABACO 5150 DONNA C/O DANIEL	TARZANA	CA	91356	13411.3491
ELLIOT L SAL C/O ELLIOT S	534 BEACON BOSTON	MA	2215	13411.3491
SRIKANTHAN THILLAIAMP	526 WASHIN WINCHESTEF	MA	1890	18172.7205
TABG YUYANG	153 WALPOL DOVER	MA	2030	7560.31372
REBA PROPE KESSLER FIN	855 BOYLST(BOSTON	MA	2116	42284.8674
QUAN STUAI C/O STUART	4 CHARLESG, BOSTON	MA	2215	11699.074
ARONIN NEIL	464 COMMO BOSTON	MA	2215	18172.7205
STEWART ELIZABETH	463 COMMO BOSTON	MA	2215	2609.16284
GIDDINGS DAVID THEODC	955 LAUREL\ CARMEL	IN	46032	12127.156
RATANASIRII C/O P RATAN	534 BEACON BOSTON	MA	2215	13411.3491
CITY OF BOS PUBLIC IMPR	1 CITY HALL I BOSTON	MA	2201	42235.9688
WANG JING	27 CLARK LA\ WALTHAM	MA	2451	42284.8674
LO CHI CHEUNG	416 COMMO BOSTON	MA	2215	42284.8674
BROWN ROBERT	7 CHARLES V CHELMSFORI	MA	1824	7560.31372
FONG BRUCI 5646 BERGA C/O BRUCE F	SAN JOSE	CA	95118	18172.7205
VIJAYKUMAR PUVALAI M	5744 THOMAS MACON	GA		13411.3491
SCHNEIDER JAMES R	4 CHARLESG, BOSTON	MA	2215	11699.074
WONG CHRISTINA	4 CHARLESG, BOSTON	MA	2215	11699.074
FIVE 85 BEA( C/O URI TAS P O BOX 214	BALTIMORE	MD	21282	1544.49976
KENEALLY AMY	416 COMMO BOSTON	MA	2215	42284.8674
JIN YAN	464 COMMO BOSTON	MA	2215	18172.7205
ANASTOS ALLA	4 CHARLESG, BOSTON	MA	2215	11699.074
GIULIANO FAMILY TRUST	534 BEACON BOSTON	MA	2215	13411.3491
CHAN ADELINE	352 CONCOR LEXINGTON	MA	2421	18172.7205
ROOSTAIE M C/O MARC R	484 COMMO BOSTON	MA	2215	18172.7205
LATHROP KEITH C	10 CHARLES( BOSTON	MA	2215	7560.31372
LIBBY KEVIN R	534 BEACON BOSTON	MA	2215	13411.3491
SACHDEO AMIT	464 COMMO BOSTON	MA	2215	18172.7205
FLYNN CHRIS C/O CHRISTC	4 CHARLESG, BOSTON	MA	2115	11699.074
GORESH ALEXANDRA LEIG	416 COMMO BOSTON	MA	2215	42284.8674

ROOSTAIE M 484 COMMO C/O MRR M/ BOSTON	MA	2215	18172.7205
FAHEY ELIZABETH 4 CHARLES G, BOSTON	MA	2215	11699.074
HENDERSON WILLIAM TH 464 COMMO BOSTON	MA	2215	18172.7205
587-589 BEACON STREET 103 HEMENV BOSTON	MA	2115	1548.93726
WEINER ALA C/O ALAN W 464 COMON' BOSTON	MA	2215	42284.8674
LAU BOHGHEE 416 COMMO BOSTON	MA	2215	42284.8674
CHIN KERRIS C/O KERRIS C PO BOX 244 LINCOLN	ME	4457	13411.3491
YU QING 534 BEACON BOSTON	MA	2215	13411.3491
STOY JOSEPH C/O JOSEPH 416 COMMO BOSTON	MA	2215	42284.8674
SUN 2016 TF C/O WAI-YAI 375 MAIN ST LYNNFIELD	MA	1940	13411.3491
466 UNIT 705 LLC 931 SALEM E FRAMINGHAM	MA		18172.7205
ZHU YANNAN 465 COMMO BOSTON	MA	2215	2554.05957
MASSACHUSETTS DEPART CHARLES GAT BOSTON	MA	2215	180568.175
MARCONE MIKE P P O BOX 157 BOSTON	MA	2215	3568.74731
FULEIHAN N, C/O NABIL F 76 MANOR / WELLESLEY	MA	2482	42284.8674
LI HOW CHEI C/O LI HOW 466 COMMO BOSTON	MA	2215	18172.7205
HOLT ERIC B C/O ERIC B F 11916 KEATI TAMPA	FL	33626	18172.7205
COMMONW C/O JARED A 413 COMMO BOSTON	MA	2215	12394.9827
LOPEZ ERNESTO 2 MARBLER I N ANDOVER	MA	1845	7560.31372
KASDON MU C/O CHARLES 867 BOYLST ( BOSTON	MA	2116	8534.74146
CHOI TINA E 534 BEACON BOSTON	MA	2215	13411.3491
KHAN REHAN ABBAS 534 BEACON BOSTON	MA	2115	13411.3491
SUN 2016 TF 375 MAIN ST C/O WAI-YAI LYNNFIELD	MA	1940	13411.3491
KARMA ALAIN 591 BEACON BOSTON	MA	2215	1317.28149
PAPADEMETRIOU CONST/ 416 COMMO BOSTON	MA	2215	42284.8674
BAKER STEVE 3508 BELMA NEPTUNE	NJ	7753	18172.7205
JIANG JINHAO 4 CHARLES G, BOSTON	MA	2215	11699.074
JEANETTE L ANTONUCCIO 126 ABOND/ PALM BEACH	FL	33410	42284.8674
PINE CONE PROPERTIES L 236 NAHANT NAHANT	MA	1908	18172.7205
XIE ZHEN 416 COMMO BOSTON	MA	2215	42284.8674
BURNS MATTHEW G 409 COMMO BOSTON	MA	2215	12127.156
TOOMEY TAYLOR AGNES 534 BEACON BOSTON	MA	2215	13411.3491
DUMONT BERNARD 5 SMITH LAN FOXBORO	MA	2035	18172.7205
STETSON ATHENA N 4 BOYCE FAF LINCOLN	MA	1773	13411.3491
TSENG HELEN 534 BEACON BOSTON	MA	2215	13411.3491
ALTHANI KH/ 213 NEWBU C/O CABOT / BOSTON	MA	2116	42284.8674
SCHMIDT JEAN E TS P O BOX 111 GROTON	MA	1450	18172.7205
WAHID AND C/O WAHID / 10 CHARLES ( BOSTON	MA	2215	7560.31372
GARDINER N C/O KINGSLE 625 MAIN ST MILLIS	MA	2054	12127.156
ECEMIS MUS C/O MUSTAF 29 WOODCH CHESTNUT H MA		2467	42284.8674
PATEL VASANT R 147 HIGH ST WINCHESTEF MA		1890	13411.3491
SWEDER KEI C/O KENNET 416 COMMO BOSTON	MA	2215	42284.8674
JIN YAN 464 COMMO BOSTON	MA	2210	18172.7205

534 BEACON DAVID & VIC	12 LOCKE ST ANDOVER	MA	1810	13411.3491
FAN HENGMEI	10 CHARLES	BOSTON MA	2215	7560.31372
XIANG YUNKE	463 COMMO	BOSTON MA	2215	2609.16284
DANG STEVE C/O ASHLEY	9 TILDEN RD CANTON	MA	2021	13411.3491
ABOU-EZZI GEORGE	60 LONG PA	NORTH AND MA	1845	18172.7205
KEN & LEON, C/O KEN T CI	29 GROVE C	FISHKILL NY	12524	18172.7205
GROSSMAN GENE M	200 RIDGEVI	PRINCETON NJ	8540	11699.074
TSUTSUMI KAI	492 BEACON	BOSTON MA		11699.074
KELLAN ROB C/O ROBERT	49 SUTTON I	NORTH AND MA	1845	42284.8674
QU SIYIN C/O SIYIN QI	466 COMMO	BOSTON MA	2215	18172.7205
MARETT DANA CHRISTINE	4 CHARLES	SG, BOSTON MA	2215	11699.074
YANG XIN	4 CHARLES	SG, BOSTON MA	2215	11699.074
BROWN PAUL A JR	416 COMMO	BOSTON MA	2215	42284.8674
CISNEROS ARACELI BEAM	464 COMMO	BOSTON MA	2215	18172.7205
BANGERT MICHAEL J	4 CHARLES	SG, BOSTON MA	2215	11699.074
FIVE 85 BEA C/O URI TAS	P O BOX 214	BALTIMORE MD	21282	1544.49976
ROY JOHN S	463 COMM	C BOSTON MA	2215	2609.16284
TING SHIH-CI C/O SHIH-CH	200 LINCOLN	BOSTON MA	2111	13411.3491
SHAHAB RANA K A	SAUDI ARAM	DHAHRAN SAUDI ARABIA	31311	42284.8674
ZHENG CONGWEI	466 COMM	N BOSTON MA	2215	18172.7205
ORGAD GUN C/O BOSTON	58 GAINSBO	BOSTON MA	2115	18172.7205
BAHHADY IMAD	113 BULLARI	SHARON MA	2215	18172.7205
ZA REALTY T C/O ZAHEER	4 DAMASCU	MARLBORO NJ	7746	42284.8674
CAREY KATRINA L	4 CHARLES	SG, BOSTON MA	2215	11699.074
MASS TURNPIKE AUTHOR	BROOKLINE	, BOSTON MA	2215	200738.386
HA-TRANG F C/O QUANG	466 COMMO	BOSTON MA	2215	18172.7205
GARDINER N C/O KINGSLE	625 MAIN ST	MILLIS MA	2054	12127.156
KEMPER STEPHEN G	416 COMMO	BOSTON MA	2215	42284.8674
CHAN DAVID	416 COMMO	BOSTON MA	2215	42284.8674
SOMERSET L C/O MATRIX	60 WALNUT	WELLESLEY MA	2481	42284.8674
LDJ DEVELOP	190 HIGH ST	C/O PREMIEI BOSTON MA	2110	2075.88208
SABETI PARDIS	416 COMMO	BOSTON MA	2215	42284.8674
BRAEMORE C/O SAUNDE	20 PARK PLA	BOSTON MA	2116	18172.7205
DIMEO BRAC C/O KIMBERI	75 CHAPMAN	PROVIDENCE RI	2905	12394.9827
PINE CONE PROPERTIES L	236 NAHANT	NAHANT MA	1908	2554.05957
TSENG HELEN	534 BEACON	BOSTON MA	2215	13411.3491
PAEZ JUAN CARLOS	534 BEACON	BOSTON MA	2215	13411.3491
ADKISSON GREGORY H	170 MARTIN	WHITE PLAIN NY	10602	13411.3491
PSALTOS DIMITRIOS JOHN	464 COMMO	BOSTON MA	2215	18172.7205
RENCUS ODED	7 BAY STATE	BOSTON MA	2215	8534.74146
ALVARADO JOSEPH	409 COMMO	BOSTON MA	2215	12127.156
BHIMAVARAPU KUMAR R	80 BALANCI	CANTON MA	2021	18172.7205
NATTEAU NICHOLAS L	464 COMMO	BOSTON MA	2215	18172.7205



SCULLY ABIGAIL H	534 BEACON BOSTON	MA	2215	13411.3491
PRIYA SAPRA PRIYA SAPRA	17 SAVOY ST BOSTON	MA	2215	18172.7205
LEE S MING C/O JENNIE I	419 COMMO BOSTON	MA	2215	12394.9827
FISHER HARVEY E	461 COMMO BOSTON	MA	2215	3568.74731
VELICHKOV VESSEL	5 VALLEY RO HANOVER	NH	3755	13411.3491
E.B.A. COMMONWEALTH	41A WINGAË GLOUCESTER	MA	1930	42284.8674
GOODMAN JAMES J	60 CHARLES( BOSTON	MA	2215	8534.74146
OASIS HOTEL C/O OASIS H	409 COMMO BOSTON	MA	2215	12127.156
OASIS HOTEL C/O OASIS H	409 COMMO BOSTON	MA	2215	12127.156
KHABIRI FARZAD TS	358 WILDWC PIEDMONT	CA	94611	42284.8674
KARABOTS DENISE E	416 COMMO BOSTON	MA	2215	42284.8674
LISSAUER JEFFREY	4 CHARLES( BOSTON	MA	2215	11699.074
AMERI SARA C/O SARAH /	416 COMMO BOSTON	MA	2215	42284.8674
ELIE REALTY INVESTMENT	4 CHARLES( BOSTON	MA	2215	11699.074
GODLEY BENJAMIN E	10 CHARLES( BOSTON	MA	2215	7560.31372
MARIK LLC	20 LINDEN S' ALLSTON	MA	2134	7560.31372
ANDRES REA C/O JOHN A	416 COMMO BOSTON	MA	2215	42284.8674
SEBAOUN P/ C/O CHARLES	867 BOYLST( BOSTON	MA	2116	18172.7205
YOSHIDA TERENCE	534 BEACON BOSTON	MA	2215	13411.3491
ZHANG ZONG	466 COMMO BOSTON	MA	2215	18172.7205
LIU TZU-YU	4 CHARLES( BOSTON	MA	2215	11699.074
JEANLOZ THEODORE	416 COMMO BOSTON	MA	2215	42284.8674
SIVANAND SHARANYA	534 BEACON BOSTON	MA	2215	13411.3491
SHAVER LISA M	466 COMMO BOSTON	MA	2215	18172.7205
SALAMIPOUR HAMID	416 COMMO BOSTON	MA	2215	42284.8674
HORNER DAVID G	416 COMMO BOSTON	MA	2215	42284.8674
BARNES MANSION	10 CHARLES( BOSTON	MA	2215	7560.31372
TEWANI KAN C/O KAMLES	37 JEFFERS( FREEHOLD	NJ	7728	13411.3491
FIVE 85 BEACON ST COND	585 BEACON BOSTON	MA	2215	1544.49976
SERAFYN JEL C/O JENNIFE	463 COMMO BOSTON	MA	2215	2609.16284
SAF-BND TR/ C/O SHADI A	15 LAURA RI WABAN	MA	2468	13411.3491
ANCONA DEBORAH	416 COMMO BOSTON	MA	2215	42284.8674
MITCHELL ST C/O LAWREN	400 COMMO BOSTON	MA	2215	42284.8674
CALALANG IGNATIUS	992 E BENRI( GILBERT	AZ	85295	18172.7205
PETROFF LIVING TRUST	227 RIVERBE GROTON	MA	1450	13411.3491
HABIB JUDY A	416 COMMO BOSTON	MA	2115	42284.8674
MARGARIDA RAUL	416 COMMO BOSTON	MA	2215	42284.8674
NG THOMAS K	4719 UNIVE SEATTLE	WA	98105	18172.7205
LEHMAN MATTHEW	464 COMMO BOSTON	MA	2215	18172.7205
HORN BERT/ C/O BERTHO	176 LITTLE C CHATHAM	NH	3813	11699.074
GENT CHRISTOPHER G	60 CHALRES( BOSTON	MA	2215	8534.74146
REEF HOWARD S	409 COMMO BOSTON	MA	2215	12127.156
KOHLBERG C C/O JURT KC	409 COMMO BOSTON	MA	2215	12127.156

LEWIS GEOR C/O GEORGE	413 COMMO BOSTON	MA	2215	12394.9827
ROBERT J RA C/O ROBERT	2923 INDIGC NAPLES	FL	34105	11699.074
ZAYTMAN GI C/O GREGO	63 WEBSTER NEWTON	MA	2465	42284.8674
KILIC NURI	207 FULLER : BROOKLINE	MA	2446	42284.8674
DAOUST PAUL R	416 COMMO BOSTON	MA	2215	42284.8674
LO WEI-YU T C/O FUNG A	85 LINDEN S' ALLSTON	MA	2134	18172.7205
SYKES JAMES N TS	4 CHARLESG. BOSTON	MA	2215	11699.074
M & K BERN: C/O I MELVI	416 COMMO BOSTON	MA	2215	42284.8674
GALMARINI MARIA EUGE	4 CHARLESG. BOSTON	MA	2215	11699.074
OSTROVSKY DMITRY	465 COMMO BOSTON	MA	2215	2554.05957
AL GOSAIBI EBTISSAM KH	416 COMMO BOSTON	MA	2215	42284.8674
PERRY DEBORAH H	416 COMMO BOSTON	MA	2215	42284.8674
CHU FELIX	464 COMMO BOSTON	MA	2215	18172.7205

Shape\_\_Length

925.550295

925.550295

457.887509

925.550295

165.295074

925.550295

488.34545

448.907964

417.992252

488.34545

301.794828

488.34545

925.550295

925.550295

540.483343

457.887509

925.550295

457.887509

540.483343

540.483343

448.907964

453.246998

453.246998

488.34545

540.483343

457.887509

488.34545

925.550295

488.34545

272.252128

488.34545

925.550295

488.34545

416.154955

925.550295

540.483343

417.992252

925.550295

925.550295

457.887509

173.576204

453.246998

488.34545  
925.550295  
540.483343  
540.483343  
457.887509  
453.246998  
488.34545  
925.550295  
540.483343  
457.887509  
417.992252  
925.550295  
488.34545  
457.887509  
453.246998  
925.550295  
925.550295  
540.483343  
540.483343  
453.014835  
453.014835  
457.887509  
457.887509  
925.550295  
925.550295  
540.483343  
540.483343  
540.483343  
453.014835  
540.483343  
488.34545  
540.483343  
540.483343  
448.907964  
417.992252  
925.550295  
301.794828  
925.550295  
448.907964  
165.295074  
540.483343  
540.483343  
488.34545

540.483343  
453.246998  
165.295074  
925.550295  
925.550295  
457.887509  
925.550295  
448.907964  
453.246998  
488.34545  
925.550295  
457.887509  
925.550295  
925.550295  
540.483343  
488.34545  
272.252128  
488.34545  
540.483343  
448.907964  
488.34545  
540.483343  
457.887509  
417.992252  
925.550295  
540.483343  
540.483343  
457.887509  
173.576204  
272.252128  
453.014835  
457.887509  
258.613342  
925.550295  
540.483343  
540.483343  
540.483343  
925.550295  
457.887509  
453.246998  
925.550295  
925.550295  
488.34545

488.34545  
925.550295  
540.483343  
540.483343  
258.613342  
488.34545  
488.34545  
925.550295  
540.483343  
925.550295  
540.483343  
448.907964  
488.34545  
925.550295  
540.483343  
488.34545  
925.550295  
540.483343  
453.014835  
165.295074  
165.295074  
448.907964  
925.550295  
417.992252  
453.246998  
488.34545  
540.483343  
457.887509  
448.907964  
417.992252  
952.829858  
925.550295  
457.887509  
488.34545  
540.483343  
925.550295  
540.483343  
488.34545  
540.483343  
540.483343  
272.252128  
417.992252  
1096.50939

448.907964  
488.34545  
448.907964  
925.550295  
925.550295  
540.483343  
540.483343  
457.887509  
453.246998  
540.483343  
488.34545  
453.014835  
925.550295  
925.550295  
925.550295  
540.483343  
457.887509  
457.887509  
457.887509  
453.246998  
540.483343  
258.613342  
488.34545  
488.34545  
488.34545  
488.34545  
540.483343  
925.550295  
925.550295  
457.887509  
925.550295  
540.483343  
258.613342  
165.295074  
925.550295  
540.483343  
448.907964  
488.34545  
488.34545  
488.34545  
925.550295  
165.295074  
540.483343

540.483343  
925.550295  
925.550295  
457.887509  
457.887509  
540.483343  
453.246998  
925.550295  
453.246998  
488.34545  
925.550295  
457.887509  
488.34545  
540.483343  
540.483343  
417.992252  
925.550295  
540.483343  
488.34545  
448.907964  
488.34545  
416.154955  
925.550295  
925.550295  
925.550295  
540.483343  
453.246998  
925.550295  
925.550295  
540.483343  
540.483343  
457.887509  
457.887509  
453.246998  
453.246998  
540.483343  
272.252128  
925.550295  
925.550295  
925.550295  
925.550295  
540.483343  
540.483343



172.880084  
925.550295  
457.887509  
457.887509  
453.246998  
540.483343  
453.014835  
488.34545  
488.34545  
540.483343  
540.483343  
417.992252  
453.246998  
453.014835  
258.613342  
240.506736  
488.34545  
540.483343  
488.34545  
301.794828  
488.34545  
540.483343  
453.246998  
925.550295  
540.483343  
2785.07416  
540.483343  
925.550295  
453.246998  
165.295074  
925.550295  
925.550295  
457.887509  
457.887509  
448.907964  
925.550295  
488.34545  
540.483343  
540.483343  
540.483343  
417.992252  
540.483343  
448.907964

925.550295  
540.483343  
453.246998  
453.246998  
925.550295  
488.34545  
173.576204  
925.550295  
925.550295  
540.483343  
457.887509  
925.550295  
925.550295  
457.887509  
925.550295  
925.550295  
488.34545  
540.483343  
258.613342  
925.550295  
925.550295  
457.887509  
1365.5897  
540.483343  
540.483343  
925.550295  
457.887509  
301.794828  
925.550295  
925.550295  
592.894987  
925.550295  
488.34545  
925.550295  
1651.71348  
453.014835  
488.34545  
417.992252  
540.483343  
432.12639  
448.907964  
488.34545  
165.295074

488.34545  
453.014835  
488.34545  
925.550295  
925.550295  
925.550295  
540.483343  
457.887509  
540.483343  
540.483343  
417.992252  
453.246998  
488.34545  
488.34545  
488.34545  
540.483343  
448.907964  
925.550295  
457.887509  
540.483343  
272.252128  
453.246998  
488.34545  
1205.78443  
925.550295  
925.550295  
448.907964  
540.483343  
488.34545  
457.887509  
457.887509  
173.576204  
925.550295  
540.483343  
457.887509  
488.34545  
540.483343  
540.483343  
448.907964  
488.34545  
540.483343  
457.887509  
925.550295

540.483343  
457.887509  
540.483343  
173.356974  
925.550295  
925.550295  
488.34545  
488.34545  
925.550295  
488.34545  
540.483343  
258.613342  
3072.91312  
301.794828  
925.550295  
540.483343  
540.483343  
453.014835  
448.907964  
417.992252  
488.34545  
488.34545  
488.34545  
165.295074  
925.550295  
540.483343  
457.887509  
925.550295  
540.483343  
925.550295  
453.246998  
488.34545  
540.483343  
488.34545  
488.34545  
925.550295  
540.483343  
448.907964  
453.246998  
925.550295  
488.34545  
925.550295  
540.483343

488.34545  
448.907964  
272.252128  
488.34545  
540.483343  
540.483343  
457.887509  
457.887509  
925.550295  
540.483343  
457.887509  
457.887509  
925.550295  
540.483343  
457.887509  
173.576204  
272.252128  
488.34545  
925.550295  
540.483343  
540.483343  
540.483343  
925.550295  
457.887509  
3019.88974  
540.483343  
453.246998  
925.550295  
925.550295  
925.550295  
194.276732  
925.550295  
540.483343  
453.014835  
258.613342  
488.34545  
488.34545  
488.34545  
540.483343  
417.992252  
453.246998  
540.483343  
540.483343

488.34545  
540.483343  
453.014835  
301.794828  
488.34545  
925.550295  
417.992252  
453.246998  
453.246998  
925.550295  
925.550295  
457.887509  
925.550295  
457.887509  
448.907964  
448.907964  
925.550295  
540.483343  
488.34545  
540.483343  
457.887509  
925.550295  
488.34545  
540.483343  
925.550295  
925.550295  
448.907964  
488.34545  
173.576204  
272.252128  
488.34545  
925.550295  
925.550295  
540.483343  
488.34545  
925.550295  
925.550295  
540.483343  
540.483343  
457.887509  
417.992252  
453.246998  
453.246998

453.014835  
457.887509  
925.550295  
925.550295  
925.550295  
540.483343  
457.887509  
925.550295  
457.887509  
258.613342  
925.550295  
925.550295  
540.483343