



*17A Chestnut Street
Boston, MA 02108*

September 23, 2022

To: BHAC
Re: BHAC Application for Design Review
From: Rob Ferree, President, Ferree Group, Inc. (General Contractor)

This application is for work proposed on the roof of the bump-out off the rear of 44 Chestnut Street. This application is being submitted as an Emergency Application due to chronic water infiltration into the interior living spaces of the building.

The proposed Scope Of Work is:

- Install new Carlisle EPDM roof
- Install new copper gutters in kind
- Perform spot pointing on chimney using same color mortar
- Install new roof deck on same footprint as existing roof deck

Below please find the following supporting files:

- Bird's-eye street view of subject building location
- Pic of front elevation of 44 Chestnut Street
- Pics of interior water damage and roof deck existing conditions
- Pic looking out from SE corner of roof deck to corner Branch Street and Spruce Street
- Pics of view from various angles toward existing roof deck location from Branch Street (public way)
- Proposed deck plan view (same as existing)
- Spec sheets of Bison Innovative products deck system

If you have any questions, please call me at (617) 372-6700 or email me at rob@ferreegroup.com.

Thank you.

- 1.) Bird's-eye view of 44 Chestnut Street within the surrounding streetscape. The perspective is from Beacon Street looking toward Chestnut Street – and shows the rear elevation of the subject building where the work will be performed.

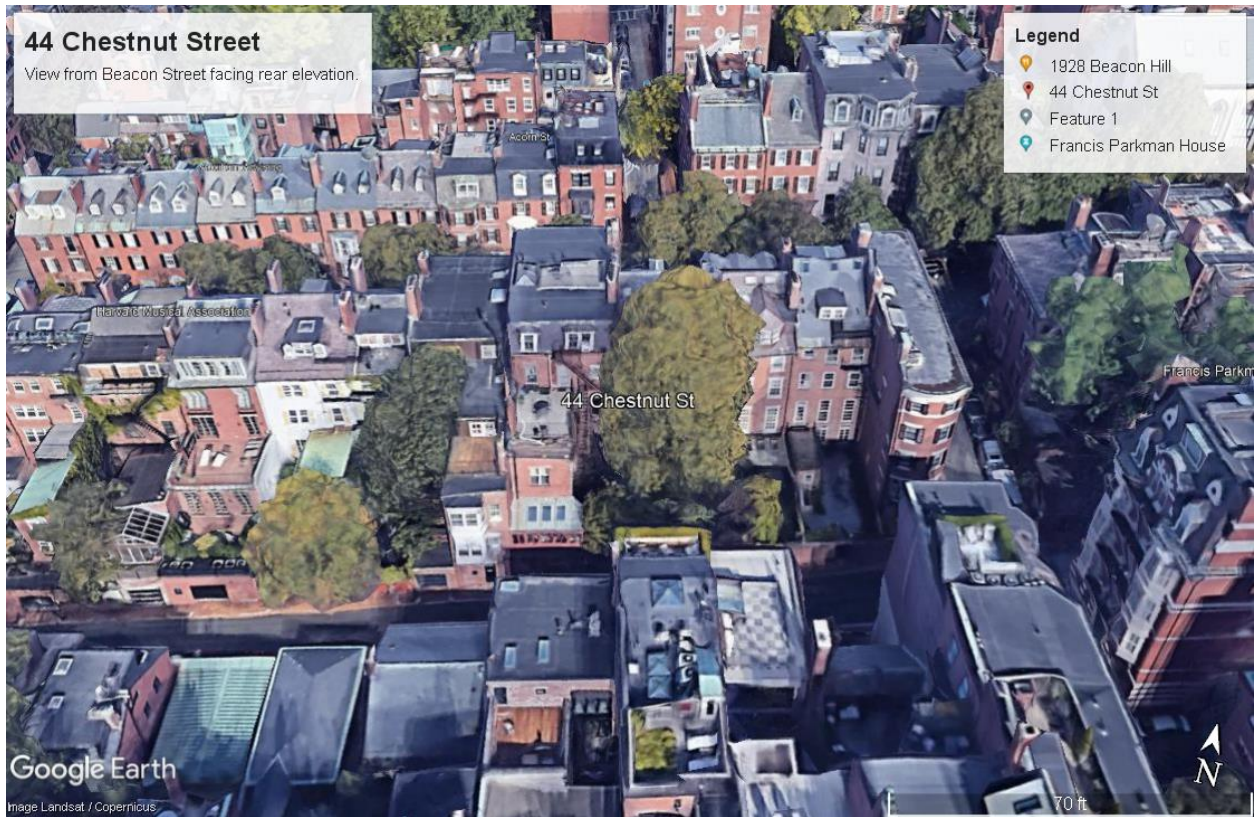

2.) Pic of the front elevation of 44 Chestnut Street as viewed from Chestnut Street.



3.) Four pics of water damage to ceiling below bump-out roof.









- 4.) Pic of the existing conditions of the roof and roof deck on the rear bump-out of 44 Chestnut Street looking across Branch Street to the rear of buildings on Beacon Street.



- 5.) Pic of the existing conditions of the roof and roof deck as seen looking from the Branch Street end of the deck to the rear elevation of 44 Chestnut Street.



6.) Existing conditions pic of roof and roof deck showing setback. View is across Branch Street to the rear of buildings on Beacon Street.



7.) View from the SE corner of existing roof deck to corner of Branch Street and Spruce Street.



8.) View from the corner of Spruce Street and Branch Street



9.) View of rear elevation of 44 Chestnut Street from Branch Street



10.)View of rear elevation of 44 Chestnut Street from further along Branch Street



11.) Proposed roof deck plan (same as existing). Existing 42" height railings to be re-used in same locations (East, South and West sides)

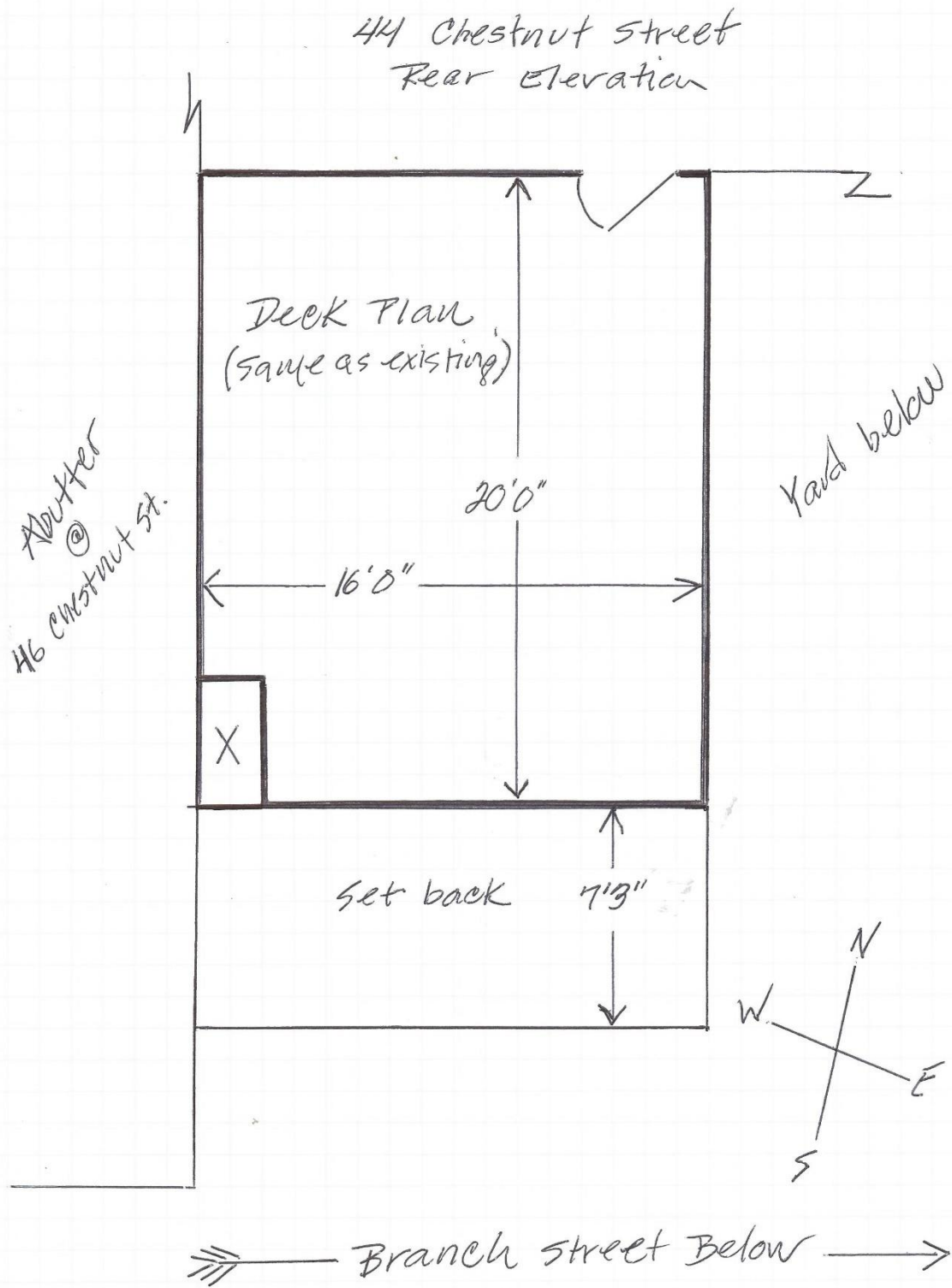

12. Bison IPE Wood Tile Spec Sheet

Bison Ipê Wood Tiles



Model: WTIPE24-SM

Model: WTIPE24-SM
Model: WTIPE24-R
Model: WTIPE3030-10PLANK-SM
Species: Ipê
Color: Brown*
ASTM E108: Class A Spread of Flame
Janka Hardness Rating: 3,680 lbs.
Dimensions: 23.875" x 23.875" x 1.69"
29.875" x 29.875" x 1.69"
Weight: 24 lbs. / 34 lbs.
Weight psf: 6 psf / 5.4 psf
Bison Continuous Kerf cut design



Model: WTIPE3030-10PLANK-SM



Model: WTIPE48
Species: Ipê
Surface: Smooth or Ribbed
Color: Brown*
ASTM E108: Class A Spread of Flame
Janka Hardness Rating: 3,680 lbs.
Dimensions: 47.9375" x 23.875" x 1.69"
Weight: 48 lbs.
Weight psf: 6 psf
Bison Continuous Kerf cut design

13.) Bison IPE Wood Tile Finished Deck Example



Bison FSC® Ipê AB Wood Tiles



Model: WTFSC-100%IPE-AB-24-8PLANK-SM

Species: Ipê

Surface: Smooth

Color: Brown*

ASTM E108: Class A Spread of Flame

Janka Hardness Rating: 3,680 lbs.

Dimensions: 23.875" x 23.875" x 1.69"

Weight: 24 lbs.

Weight psf: 6 psf

Bison Continuous Kerf cut design

BEAUTY, LONGEVITY, AND EXCEPTIONAL VALUE

BISON WOOD TILES

Bison Wood Tiles offer the design flexibility to create versatile, unique outdoor spaces. Commercial grade, responsibly harvested, hardwood tiles are weather resistant and available in standard and FSC® Certified (SCS-COC-002585) species.

- Species include: Bamboo, Cumaru, Garapa, Ipê, and Massaranduba
- Exclusive Bison FS-1 Fastening Kit and Continuous Kerf Cut Design allows for easy tile attachment, removal, and replacement
- Modular sizes 2' x 2', 4' x 2', 6' x 2', 8' x 2', and 30" x 30"
 - Pedestals to be spaced on a 2' grid for all Bison Wood Tile sizes*
- Custom sizes available
- Full System Warranty available when installed with Bison Pedestals
- May be covered by one or more Patents
- Bison Ipê Wood Tile Systems can meet:
 - ASTM E108 Class A Spread of Flame
 - ASTM C1028 Slip Resistance
 - Wind Uplift Criteria set forth in ASCE 7**
 - Seismic Design Categories (SDC) A-F



*Bison 30" x 30" Wood Tiles installed on a 30" grid.

**Wind Uplift documents not contained herein.

©2012-2021 United Construction Products, Inc. All Rights Reserved.

Covered by one or more patents or pending patents.

Bison Innovative Products | 701 Osage Street, Unit 120, Denver CO 80204 USA | 800-333-4234 | www.bisonip.com