



April 14, 2023

BY EMAIL

Boston Air Pollution Control Commission  
c/o Environment Department  
1 City Hall Square, Room 709  
Boston, MA 02201

Email: [apcc@boston.gov](mailto:apcc@boston.gov)  
Attn: Alyssa Farkas

**Re: Motor Mart Garage Redevelopment, 201 Stuart Street  
APCC Parking Permit Application**

Enclosed please find the Application of 201 STUART STREET (OWNER), LLC (the “Applicant”) to the City of Boston Air Pollution Control Commission (the “APCC”) for a modification to APCC Downtown Parking Freeze Permit No. APCC453678, in connection with the proposed redevelopment of the Motor Mart Garage, 201 Stuart Street.

The Motor Mart Garage Redevelopment Project will improve ground floor retail and/or restaurant space and add basement level retail and/or grocery space along with amenity areas, and the construction of approximately 231 residential units by converting existing parking levels on the western portion of the Garage to residential units and constructing a 20-story residential tower rising out of the Garage. The Project is subject to the City of Boston’s Article 80 Large Project Review process and was approved by the Boston Planning & Development Agency (BPDA) on October 17, 2019. The Project is in the process of coordinating a Transportation Access Plan Agreement (TAPA) with the Boston Transportation Department (BTD).

The Applicant is filing this request for a Permit Modification to reduce the number of parking spaces at the Facility in order to accommodate the redevelopment and conversion of a portion of the parking spaces within the Facility to residential excluded spaces. The Permit Modification will be effective upon the issuance of a Certificate of Occupancy for the Project. Until said Certificate of Occupancy is issued, the terms and conditions of the Existing Freeze Permit will remain in effect.

As further detailed in the enclosed materials, the Applicant seeks the APCC’s approval of a modified Parking Freeze Permit for the Motor Mart Garage from 1,021 spaces to 672 spaces of which 556 will be commercial spaces and 116 will be residential excluded spaces. The Project will return 341 commercial spaces back to the Downtown Parking Freeze Bank.



We enclose the following in support of this Application:

- A. A completed APCC Application for Parking Freeze Permit.
- B. Statement of Need
- C. Proof of Ownership.
- D. Location of Facility, including a Locus Plan, Site Plan, and Project Renderings.
- E. Garage Layout, including Garage Entrances/Exits, Parking Layouts, Location/Type of EV Charging, and Bicycle Accommodations.
- F. EVSE Equivalence Calculator
- G. Abutters List within 300 feet of existing facility.

We respectfully request to be included on the agenda for the next scheduled APCC meeting on May 17, 2023. In advance of the next APCC meeting, we also kindly request a meeting with APCC staff to discuss this application.

Hardcopies of the enclosed materials, together with a Joint Staff Report will be submitted not less than two (2) weeks before the anticipated hearing date of May 17, 2023.

If you have any questions about this matter, please do not hesitate to contact me if any additional information is required.

Sincerely,

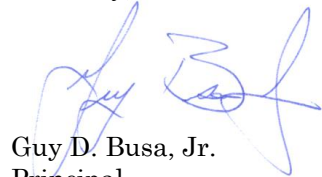

Guy D. Busa, Jr.  
Principal

Enclosures

cc (via email w/encl.):

Richard Kershaw, CIM Group  
Len Conlin, Boston Global Investors  
Michael Flannery, Goulston & Storrs  
Mitali Biswas, Goulston & Storrs  
Ian McKinnon, Howard Stein Hudson



**APPENDIX A**

**APCC PERMIT APPLICATION**

*[See Attached]*



**A. GENERAL APPLICATION INFORMATION**

1. *Project Location*

a. Street Address	b. City/Town	c. Zip Code
f. Assessors Map/Plat Number	g. Parcel/Lot Number	

2. *Applicant*

a. First Name	b. Last Name	c. Company	
d. Mailing Address			
e. City/Town		f. State	g. Zip Code
h. Phone Number	i. Fax Number	j. Email address	

3. *Property Owner*

a. First Name	b. Last Name	c. Company	
d. Mailing Address			
e. City/Town		f. State	g. Zip Code
h. Phone Number	i. Fax Number	j. Email address	

Check if more than one owner:

(If there is more than one property owner, please attach a list of these property owners to this form.)





4. Representative (if any)

a. First Name	b. Last Name	c. Company	
d. Mailing Address			
e. City/Town		f. State	g. Zip Code
h. Phone Number	i. Fax Number	j. Email address	

5. What kind of application is being filed?

Request a New Parking Freeze  
Permit or Exemption Certification

Modify an existing Parking Freeze Permit  
or Exemption Certification

6. Which Parking Freeze is your facility located in

Downtown Boston

South Boston

**B. PARKING FACILITY INFORMATION**

1. Applicant

Downtown Boston		South Boston	
Commercial Spaces		Commercial Spaces	
Exempt Spaces		Residential Included Spaces	
Residential Excluded Spaces		Residential Excluded Spaces	

2. Do you currently or will you charge for parking?

Yes

No

Not sure

3. What is your current or proposed parking method and facility type? (select all that apply)

Valet

Surface Lot

Self-Parking

Garage



4. Is your project compliant with the City's Bicycle Parking Guidelines?

Number of Long-Term Bicycle Spaces:	Number of Showers:
Number of Short-Term Bicycle Spaces:	Bikeshare Station Size and Contribution:
Number of Lockers:	Other Amenities (Please List):

5. Is your project compliant with the City's Electric Vehicle Readiness Policy?

EVSE-Installed Points: <b>A</b>	Total number of spaces: <b>C</b>
EV-Ready Points: <b>B</b>	Does <b>A + B = C</b> ? <input type="checkbox"/> Yes <input type="checkbox"/> No

Note: Please attach the Electric Vehicle Equivalency Calculator to this application, available at [www.boston.gov/recharge-boston](http://www.boston.gov/recharge-boston).

6. Please fill out the information below:

Total Number of Proposed Spaces:	Total Parking Facility Square Footage:
Number of New Spaces:	Ratio of Residential Spaces to Units:
Number of Existing Spaces:	(Optional) Number of Spaces Returned:

7. Please list the total facility square footage by use type:

Residential Sqft:	Retail Sqft:
Office/Admin Sqft:	Institutional Sqft:
Industrial Sqft:	Lodging Sqft:

8. Are you required to execute a Transportation Access Plan Agreement (TAPA)?

Yes  No

(If yes, please attach the draft or final TAPA to this form if available.)



City of Boston  
Environment

**PARKING FREEZE APPLICATION FORM**

APCC 453678

Air Pollution Control Commission

APCC Permit Number

**C. SIGNATURES AND SUBMITTAL REQUIREMENTS**

I hereby certify under the penalties of perjury that the foregoing Notice of Intent and accompanying plans, documents, and supporting data are true and complete to the best of my knowledge. I understand that the Applicant will place notification of this Application in a local newspaper at the expense of the applicant in accordance with the Procedures and Criteria for the Issuance of Parking Freeze Permits.

DocuSigned by: <i>Rich O. Kershaw</i> <small>38328C765A8F7A8</small> Signature of Applicant	4/12/2023 Date
--	-------------------

Signature of Property Owner (if different) <b>Guy Busa</b> Digitally signed by Guy Busa Date: 2023.04.11 15:19:49 -04'00' Signature of Representative (if any)	Date  Date
--	------------------

**D. ADDENDUM: IMPORTANT APPLICATION INFORMATION**

**PAYMENT**

Please include a check or money order made payable to the City of Boston, Air Pollution Control Commission. The fee is \$20 per parking space. Application and renewal fees apply to all locations within the Downtown, East Boston, and South Boston Parking Freeze Zones.

**WRITTEN PROOF**

Please attach written proof that the applicant is the owner of record or has written approval from the owner of record to file this application.

**STATEMENT OF NEED**

Please attach a general description of the facility and the parking needs of the project, local entities, and patrons that the proposed facility will serve. Any written support (letters, etc.) that you wish to supply in support of this statement should be attached



## **SITE PLANS**

Please attach a site plan of the parking facility showing:

- location of the facility;
- layout of the spaces;
- entry and exit locations;
- total square footage of the parking area;
- location, type and amount of electric vehicle parking;
- location and amount of bicycle parking and bicycle facilities.

## **OTHER APPLICABLE REVIEWS**

If you are working in a historic district or on a designated landmark, you should consult with the appropriate historic or architectural commission. If you are working in the floodplain or within 100 feet of a wetland, you should consult with the Conservation Commission. Visit [boston.gov/landmarks](http://boston.gov/landmarks) and [boston.gov/conservation](http://boston.gov/conservation) before starting any work.

## **WHERE TO SEND**

We prefer you complete the digital application using this form. Export the form as a PDF and email your application and supporting documents to [APCC@boston.gov](mailto:APCC@boston.gov). You can also mail your application, documents, and payment to: Air Pollution Control Commission, Boston City Hall, 1 City Hall Square, Room 709, Boston, MA 02201. Please notify us that you have sent an application by mail at [APCC@boston.gov](mailto:APCC@boston.gov).



## APPENDIX B

### STATEMENT OF NEED

#### MOTOR MART GARAGE REDEVELOPMENT PROJECT

##### **Existing Conditions**

**201 STUART STREET (OWNER), LLC**, a Delaware limited liability company (the “Proponent”) is the owner of the approximately 1.2 acre parcel of land generally bounded by Stuart Street to the south, Church Street to the west, Columbus Avenue to the northwest, Eliot Street to the northeast, and Park Plaice to the east (the “Property”) pursuant to that certain Quitclaim Deed dated as of October 24, 2016 and recorded with the Suffolk County Registry of Deeds in Book 56995, Page 302.

The Property is currently improved by an existing approximately 421,000 square foot, eight-story building with ground floor restaurant and retail tenants and containing an approximately 1,021 space parking garage (the “Garage”). The Garage is subject to APCC parking permit #APCC453678 (the “Existing Parking Permit”), which provides for 897 commercial parking spaces for use by the general public and 124 exempt parking spaces for use by tenants, employees, patrons, and guests of the current restaurant and retail uses at the Property. Vehicles enter and exit the Garage at two locations – one on Stuart Street at the south side of the Garage, and another at the junction of Columbus Avenue and Eliot Street at the north side of the Garage.

##### **Proposed Modifications**

The Proponent intends to redevelop the Property by improving ground floor retail and/or restaurant space and adding basement level retail and/or grocery space, adding amenity areas, and constructing approximately 231 residential units by converting existing parking levels on the western portion of the Garage to residential units and constructing a 20-story residential tower rising out of the Garage (collectively, the “Project”). The Project has received Large Project Review approval from the Boston Planning and Development Agency and zoning relief from the Boston Zoning Board of Appeal.

In connection with the Project, the Proponent requests a modification to the Existing Parking Permit to reduce the number of parking spaces in the Garage to 672 and make other changes as follows: Approximately 116 of these spaces will be exempt residential spaces used by Project residents, consistent with applicable Boston Transportation Department (“BTD”) ratio guidelines for residential condominiums. The remaining approximately 556 spaces will remain commercial



parking spaces open to the public at market rates. The reduction in the number of commercial parking spaces will result in the return of 341 commercial parking spaces to the Downtown Parking Freeze Bank. Vehicles will continue to access and exit the Garage at the same two locations.

With respect to bicycle parking, and in accordance with BTM Bike Parking Guidelines, the Proponent is committed to providing a minimum of 57 short-term bicycle spaces and 247 long-term bicycle spaces, of which 231 long-term bike spaces will be allocated for residential uses and 16 long-term bike spaces will be allocated for commercial uses. Showers, lockers, and changing facilities will be provided for the users of the commercial use long-term bike spaces, and a bike repair station will be provided for residents in the residential bike room.

With respect to electric-vehicle parking, the attached Interactive EV Requirement Equivalence Calculator demonstrates the Project's compliance with BTM's Electric Vehicle Readiness Policy for New Developments. The Proponent is committed to providing 29 EVSE-installed points and an additional 87 EV-ready points for the construction of the new residential component of the Project. The Proponent is also evaluating the feasibility of retrofitting the existing Garage to provide EV options for the remaining existing commercial parking spaces with a keen understanding that to remain competitive in the market, demand by customers for EV charging will soon necessitate adding EV charging stations.

The Owner can provide additional documentation to support its request under separate cover.



**APPENDIX C**

**PROOF OF OWNERSHIP**

*[See Attached]*

- Property Records Card
- Assessor's Map
- Quickclaim Deed

# Assessing On-Line

[« New search](#)

[Map](#)

<b>Parcel ID:</b>	0500139000
<b>Address:</b>	201-241 STUART ST BOSTON MA 02116
<b>Property Type:</b>	Commercial
<b>Classification Code:</b>	0336 (Commercial Property / COMM PKG GARAGE)
<b>Lot Size:</b>	52,416 sq ft
<b>Living Area:</b>	419,328 sq ft
<b>Year Built:</b>	1920
<b>Owner on Saturday, January 1, 2022:</b>	<a href="#">201 STUART STREET (OWNER) LLC</a>
<b>Owner's Mailing Address:</b>	C/O CUSHMAN & WAKEFIELD P.O. BOX 131237 CARLSBAD CA 92013
<b>Residential Exemption:</b>	No
<b>Personal Exemption:</b>	No

### Value/Tax

#### Assessment as of Saturday, January 1, 2022, statutory lien date.

<b>FY2023 Building value:</b>	\$44,618,100.00
<b>FY2023 Land Value:</b>	\$37,551,800.00
<b>FY2023 Total Assessed Value:</b>	\$82,169,900.00

#### FY2023 Tax Rates (per thousand):

- Residential:	\$10.74
- Commercial:	\$24.68

#### FY2023 Gross Tax: \$2,027,953.13

<a href="#">Community Preservation:</a>	\$20,254.85
- Residential Exemption:	\$0.00
- Personal Exemption:	\$0.00

#### FY2023 Net Tax: \$2,048,207.98

### Abatements/Exemptions

The deadline for filing an Abatement application for FY2023 was 2/1/2023. Applications for FY2024 will become available for download beginning 1/1/2024.

This type of parcel is not eligible for a residential or personal exemption.

### Current Owner

1 201 STUART STREET (OWNER) LLC

Owner information may not reflect any changes submitted to City of Boston Assessing after December 16, 2022.

### Value History

Fiscal Year	Property Type	Assessed Value *
2023	Commercial	\$82,169,900.00
2022	Commercial	\$82,196,000.00
2021	Commercial	\$81,998,100.00
2020	Commercial	\$81,740,200.00
2019	Commercial	\$81,330,500.00
2018	Commercial	\$83,077,000.00
2017	Commercial	\$80,648,000.00
2016	Commercial	\$67,703,500.00
2015	Commercial	\$59,311,500.00
2014	Commercial	\$51,702,000.00
2013	Commercial	\$47,489,500.00
2012	Commercial	\$44,828,500.00
2011	Commercial	\$44,816,500.00
2010	Commercial	\$47,662,000.00
2009	Commercial	\$50,749,500.00
2008	Commercial	\$50,749,500.00
2007	Commercial	\$49,390,000.00
2006	Commercial	\$45,438,500.00
2005	Commercial	\$42,934,000.00
2004	Commercial	\$42,934,000.00
2003	Commercial	\$42,934,000.00
2002	Commercial	\$42,160,000.00
2001	Commercial	\$38,857,000.00
2000	Commercial	\$20,501,500.00
1999	Commercial	\$20,501,500.00
1998	Commercial	\$19,294,000.00
1997	Commercial	\$13,836,000.00
1996	Commercial	\$13,049,000.00
1995	Commercial	\$12,375,000.00
1994	Commercial	\$11,878,000.00
1993	Commercial	\$11,878,000.00
1992	Commercial	\$12,678,500.00
1991	Commercial	\$14,279,500.00
1990	Commercial	\$14,279,500.00
1989	Commercial	\$17,187,500.00
1988	Commercial	\$13,873,000.00
1987	Commercial	\$12,063,500.00
1986	Commercial	\$10,490,000.00



1985

Commercial

\$13,012,500.00

\* Actual Billed Assessments

View [Quarterly Tax Bill and Payment Information](#) for this parcel for FY2022 and FY2023.

View [approved building permits](#) associated with this parcel.

Questions? For CURRENT fiscal year tax bill Questions, contact the [Taxpayer Referral & Assistance Center](#). For PRIOR fiscal year tax payments, interest charges, fees, etc. contact the Collector's office at 617-635-4131.

# 201 241 STUART ST, 02116

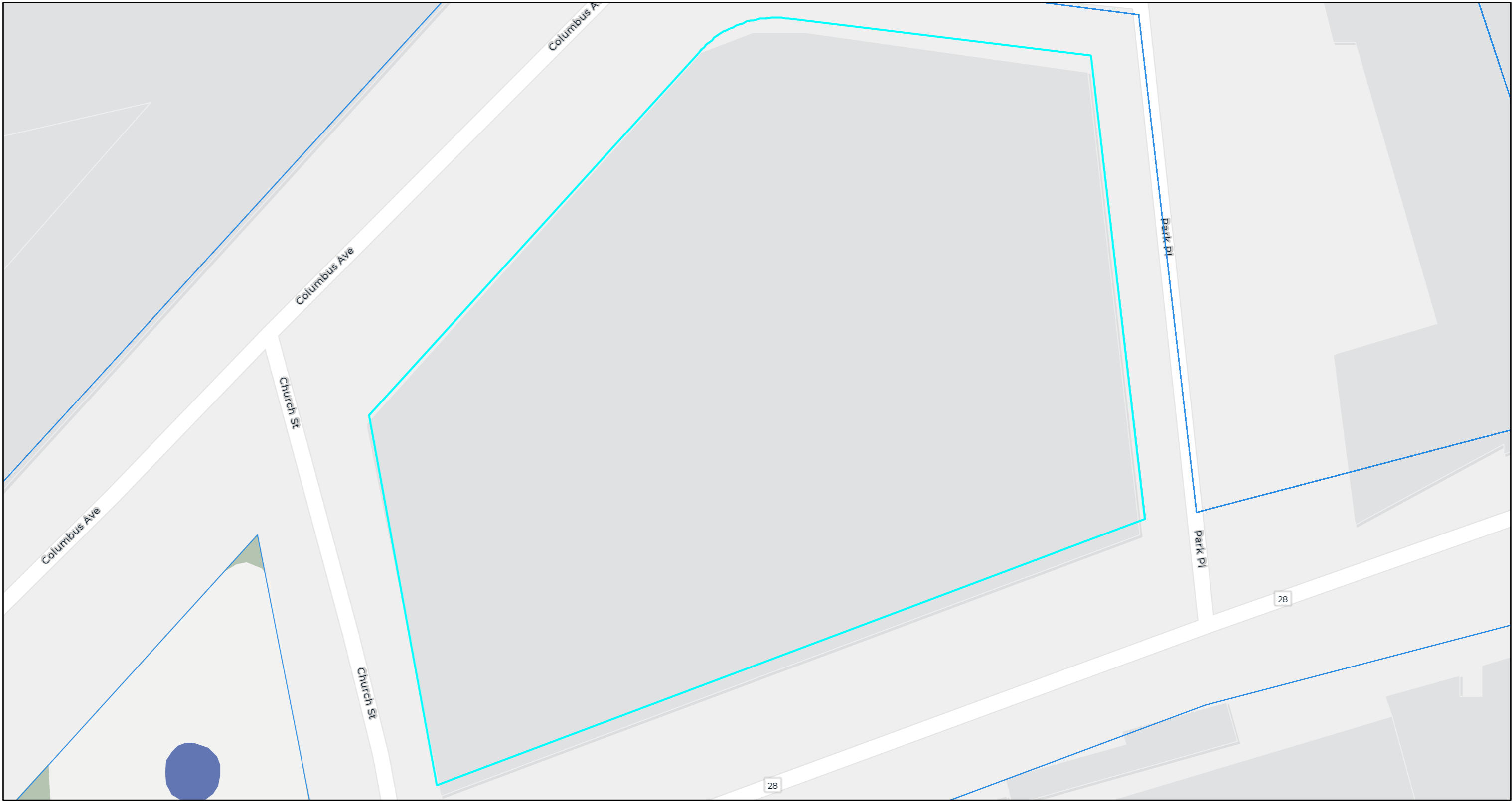

4/4/2023, 12:01:49 PM

Parcels 2021

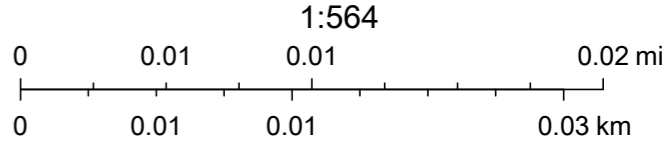

Esri Community Maps Contributors, City of Boston, City of Cambridge, MassGIS, © OpenStreetMap, Microsoft, Esri, HERE, Garmin, SafeGraph, GeoTechnologies, Inc, METI/NASA, USGS, EPA, NPS, US Census Bureau,

MASSACHUSETTS EXCISE TAX  
Suffolk County District ROD # 001  
Date: 10/24/2016 03:19 PM  
Ctrl# 164403-10048 Doc# 00100336  
Fee: \$741,000.00 Cons: \$162,500,000.00



2016 00100336  
Bk: 56995 Pg: 302 Page: 1 of 6  
Recorded: 10/24/2016 03:19 PM  
ATTEST: Thomas M Ryan, Temp Register  
Suffolk County Registry of Deeds

QUITCLAIM DEED

PARK SQUARE REVIVAL CORP., a Massachusetts corporation, having a place of business at 160 Speen Street, Suite 204, Framingham, Massachusetts 01701, for consideration of One Hundred Sixty-Two Million Five Hundred Thousand and 00/100 Dollars (\$162,500,000.00) paid, grants to 201 STUART STREET (OWNER), LLC, a Delaware limited liability company, having a place of business at c/o CIM Group, 4700 Wilshire Blvd., Los Angeles, California 90010, with QUITCLAIM COVENANTS, a certain parcel of land, together with the buildings and other improvements thereon, now known as and numbered 201 Stuart Street, Boston, Massachusetts, described in Exhibit A attached hereto and made a part hereof.

Said parcel is the same described in a deed recorded with the Suffolk County Registry of Deeds in Book 21322, Page 56.

Address of Property: 201 Stuart Street, Boston, Massachusetts

Grantor certifies that the sale of the Property is not a sale of all or substantially all of Grantor's assets in the Commonwealth of Massachusetts.

(SIGNATURES APPEAR ON THE FOLLOWING PAGE)

201 STUART STREET, BOSTON

Please Return To: sscali 799426  
First American Title Insurance Company  
National Commercial Services  
300 Boylston Street, Suite 2820  
Boston, MA 02199

WITNESS the execution under seal as of the 24<sup>th</sup> day of October, 2016.

PARK SQUARE REVIVAL CORP.,  
a Massachusetts corporation

By:   
Name: John DeMatteo II  
Title: President

By: \_\_\_\_\_  
Name: John R. Oakley  
Title: Treasurer

[Acknowledgments on Following Page]

[Signature Page to Deed]

WITNESS the execution under seal as of the 24<sup>th</sup> day of October, 2016.

PARK SQUARE REVIVAL CORP.,  
a Massachusetts corporation

By: \_\_\_\_\_

Name: John DeMatteo II

Title: President

By: \_\_\_\_\_

Name: John Oakley

Title: Treasurer

[Acknowledgments on Following Page]

[Signature Page to Deed]

Commonwealth of Massachusetts )  
 ) ss.  
County of Suffolk )

On this 20<sup>th</sup> day of October, 2016, before me, the undersigned notary public, personally appeared John DeMatteo II, President of Park Square Revival Corp., proved to me through satisfactory evidence of identification, which were driver's license, to be the person (or persons) whose name is signed on the preceding or attached document, and acknowledged to me that he signed it voluntarily for its stated purpose as President as aforesaid

Tracy S. Kirk  
Notary Public

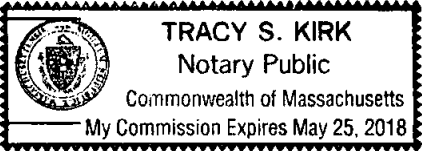

Print Name: \_\_\_\_\_  
My commission expires: \_\_\_\_\_

Commonwealth of Massachusetts )  
 ) ss.  
County of \_\_\_\_\_ )

On this \_\_\_\_\_ day of October, 2016, before me, the undersigned notary public, personally appeared John R. Oakley, Treasurer of Park Square Revival Corp., proved to me through satisfactory evidence of identification, which were \_\_\_\_\_, to be the person (or persons) whose name is signed on the preceding or attached document, and acknowledged to me that he signed it voluntarily for its stated purpose as Treasurer as aforesaid.

\_\_\_\_\_  
Notary Public

Print Name: \_\_\_\_\_  
My commission expires: \_\_\_\_\_

Commonwealth of Massachusetts )  
 ) ss.  
County of \_\_\_\_\_ )

On this \_\_\_\_\_ day of October, 2016, before me, the undersigned notary public, personally appeared John DeMatteo II, President of Park Square Revival Corp., proved to me through satisfactory evidence of identification, which were \_\_\_\_\_, to be the person (or persons) whose name is signed on the preceding or attached document, and acknowledged to me that he signed it voluntarily for its stated purpose as President as aforesaid

\_\_\_\_\_  
Notary Public

Print Name: \_\_\_\_\_  
My commission expires: \_\_\_\_\_

Commonwealth of Massachusetts )  
 ) ss.  
County of Middlesex )

On this 18th day of October, 2016, before me, the undersigned notary public, personally appeared John Oakley, Treasurer of Park Square Revival Corp., proved to me through satisfactory evidence of identification, which were a drivers license, to be the person (or persons) whose name is signed on the preceding or attached document, and acknowledged to me that he signed it voluntarily for its stated purpose as Treasurer as aforesaid.

Frances A. Porter  
\_\_\_\_\_  
Notary Public

Print Name: Frances A. Porter  
My commission expires: Feb. 10, 2023

Exhibit A

Legal Description

Real property in the City of Boston, County of Suffolk, Commonwealth of Massachusetts, described as follows:

The land situated in Boston, Massachusetts, bounded by Church Street, Columbus Avenue, Eliot Street, Broadway and Stuart Street, containing Fifty Two Thousand Three Hundred Ninety Two (52,392) square feet, more or less, together with the building thereon known as the Motor Mart, together with such rights in the land under any of said streets or avenues as the Seller may have, and subject to any public sewer running to the premises. Being the same premises conveyed to M. DeMatteo Construction Co. by Deed of Caroline Baker, dated December 24, 1959, and duly recorded with Suffolk Registry of Deeds at Book 7530, Page 281.





**APPENDIX D**

**LOCATION OF FACILITY**

*[See Attached]*

- Locus Plan
  
- Site Plan
  
- Project Renderings



Locus Plan





Site Plan

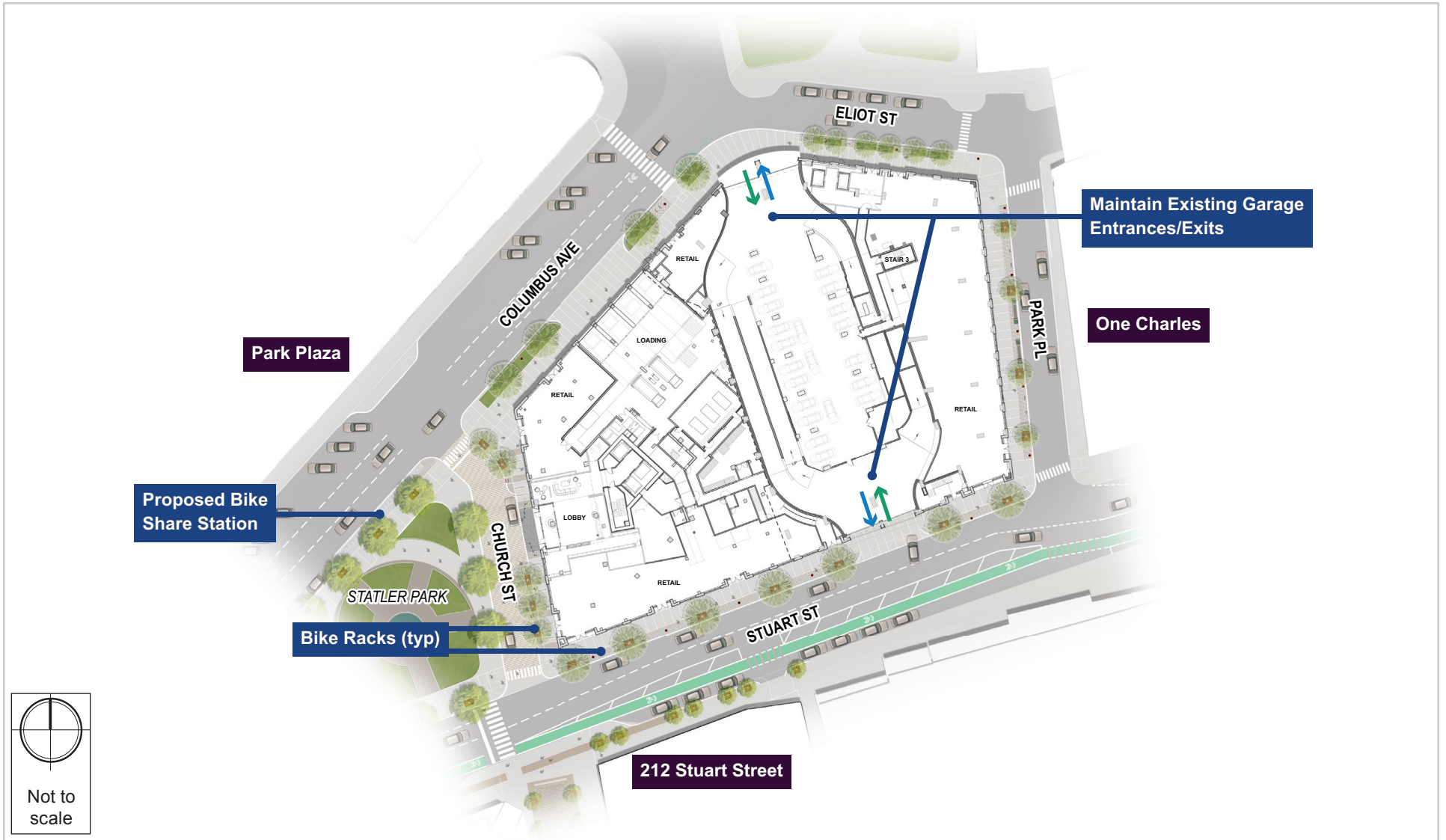





*Project Renderings*





## **APPENDIX E**

### **FLOOR PLANS OF GARAGE**

*[See Attached]*

- Garage Entrances/Exits
- Parking Layout
- Location/Type of EV Charging
- Bicycle Accommodations



**LEGEND**

- RESIDENTIAL PARKING
- COMMERCIAL PARKING
- VALET ASSIST PARKING
- BICYCLE STORAGE
- EV PROPOSED LEVEL-2 CHARGER LOCATION

MOTOR MART GARAGE - PARKING SUMMARY				
Level	Residential Parking	Commercial Parking	Valet Assist Parking	Total
Level P1	0	26	10	36
Level 1	0	18	5	23
Level 2	52	22	0	74
Level 3	64	0	0	64
Level 4	0	83	16	99
Level 5	0	83	17	100
Level 6	0	84	16	100
Level 7	0	84	16	100
Level 8	0	59	17	76
Totals	116	459	97	672

- RETAIL/COMMERCIAL BICYCLE STORAGE:**
- A. 16 BIKES TOTAL
    - 4 ON-GROUND SPACES WITH HITCH RACKS
    - 12 HIGH DENSITY SPACES WITH TWO TIER RACKS
  - B. 2 DUPLEX RECEPTACLES
  - C. 8 LOCKERS
  - D. 2 TOILET ROOMS WITH SHOWERS



Motor Mart Garage - Parking Totals				
Level	Residential Parking	Commercial Parking	Valet Assist Parking	Total
Level P1	0	26	10	36

**LEVEL P1 PARKING LAYOUT**  
 MOTOR MART GARAGE  
 201 STUART STREET  
 BOSTON, MA

3/31/2023 12:27:51 PM

- LEGEND**
- RESIDENTIAL PARKING
  - COMMERCIAL PARKING
  - VALET ASSIST PARKING
  - BICYCLE STORAGE
  - EV** PROPOSED LEVEL-2 CHARGER LOCATION

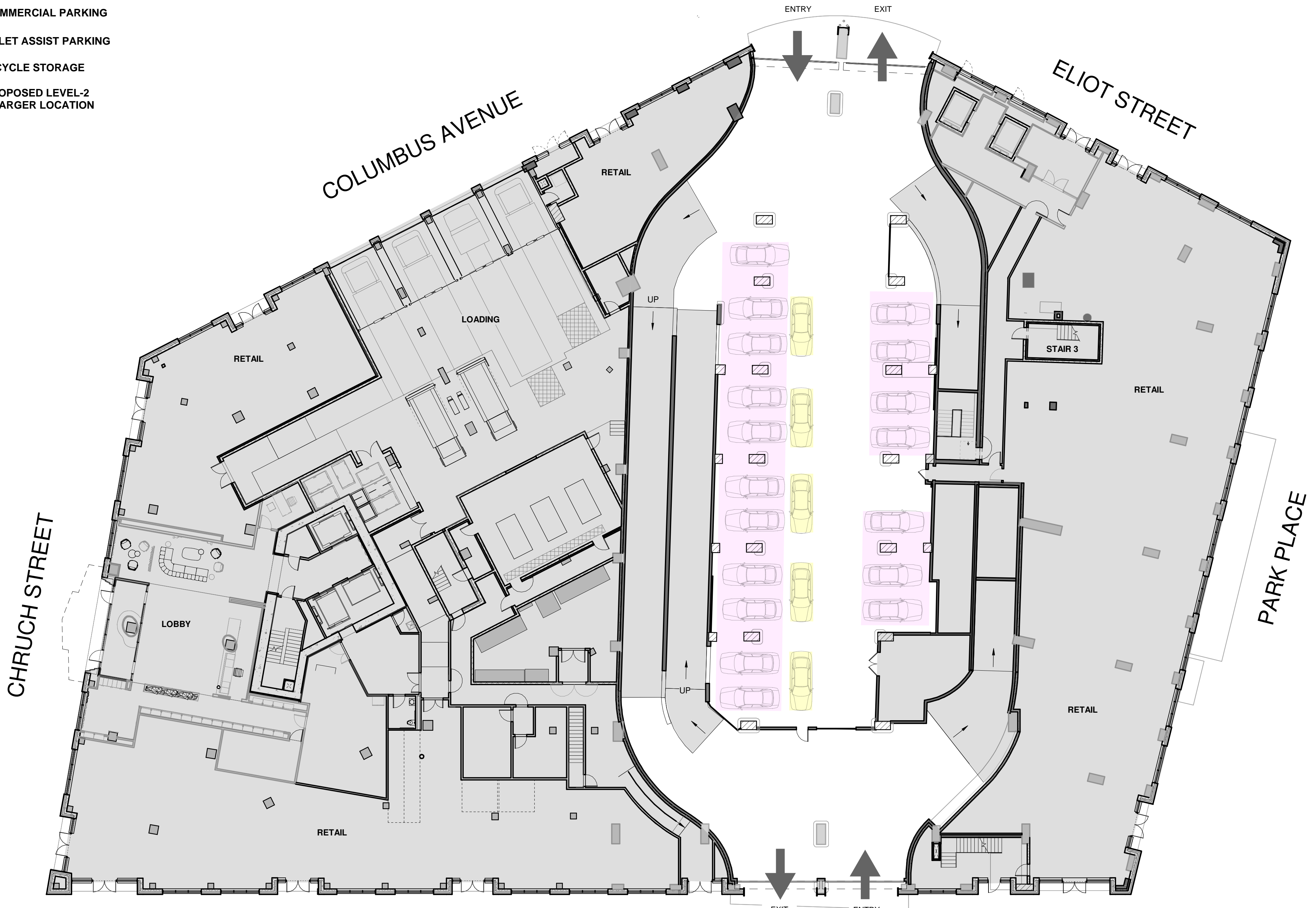

Motor Mart Garage - Parking Totals				
Level	Residential Parking	Commercial Parking	Valet Assist Parking	Total
Level 1	0	18	5	23

**LEVEL 1 PARKING LAYOUT**  
 MOTOR MART GARAGE  
 201 STUART STREET  
 BOSTON, MA

3/31/2023 12:27:53 PM



**LEGEND**

- RESIDENTIAL PARKING
- COMMERCIAL PARKING
- VALET ASSIST PARKING
- BICYCLE STORAGE
- EV PROPOSED LEVEL-2 CHARGER LOCATION

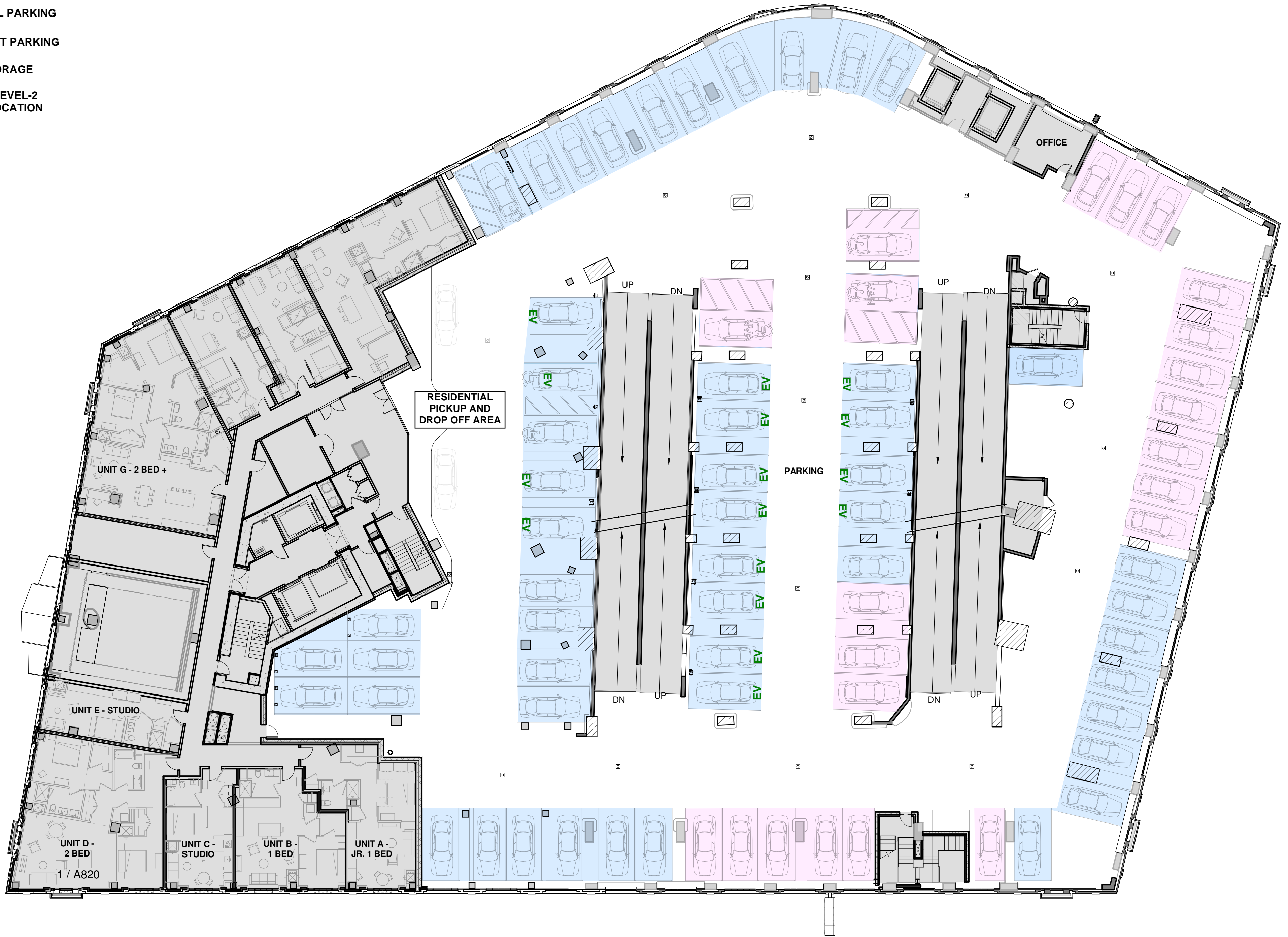

Motor Mart Garage - Parking Totals				
Level	Residential Parking	Commercial Parking	Valet Assist Parking	Total
Level 2	52	22	0	74

**LEVEL 2 PARKING LAYOUT**

MOTOR MART GARAGE  
201 STUART STREET  
BOSTON, MA



**LEGEND**

- RESIDENTIAL PARKING
- COMMERCIAL PARKING
- VALET ASSIST PARKING
- BICYCLE STORAGE
- EV PROPOSED LEVEL-2 CHARGER LOCATION



**RESIDENTIAL BICYCLE STORAGE:**  
**A. 231 BIKES TOTAL**  
 58 ON-GROUND SPACES WITH HITCH RACKS  
 173 HIGH DENSITY SPACES WITH TWO TIER RACKS  
**B. 8 DUPLEX RECEPTACLES**  
**C. BIKE REPAIR STATION**

Motor Mart Garage - Parking Totals				
Level	Residential Parking	Commercial Parking	Valet Assist Parking	Total
Level 3	64	0	0	64

**LEVEL 3 PARKING LAYOUT**

MOTOR MART GARAGE  
 201 STUART STREET  
 BOSTON, MA



**LEGEND**

- RESIDENTIAL PARKING
- COMMERCIAL PARKING
- VALET ASSIST PARKING
- BICYCLE STORAGE
- EV PROPOSED LEVEL-2 CHARGER LOCATION

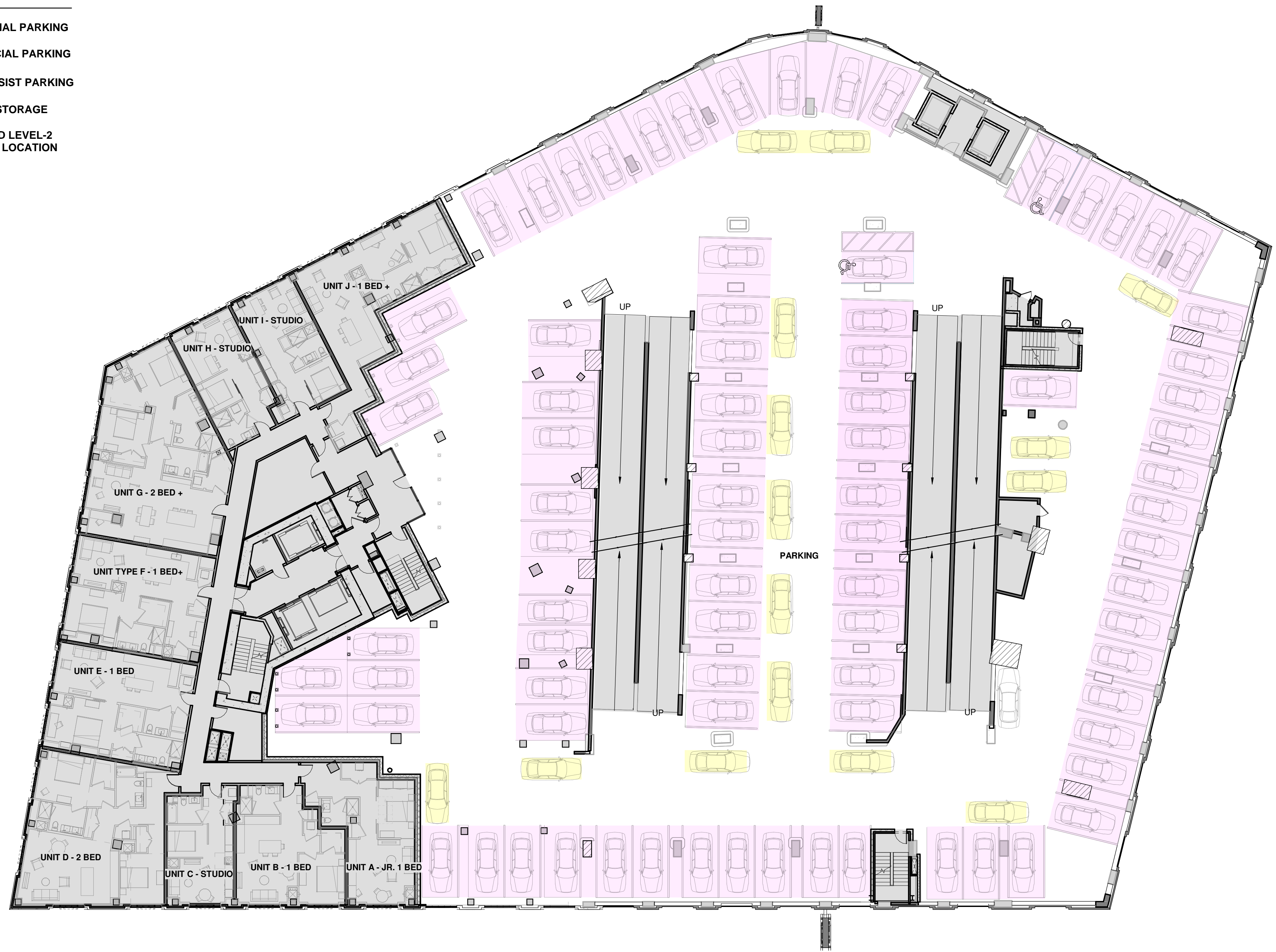

Motor Mart Garage - Parking Totals				
Level	Residential Parking	Commercial Parking	Valet Assist Parking	Total
Level 4	0	83	16	99

**LEVEL 4 PARKING LAYOUT**  
 MOTOR MART GARAGE  
 201 STUART STREET  
 BOSTON, MA



**LEGEND**

- RESIDENTIAL PARKING
- COMMERCIAL PARKING
- VALET ASSIST PARKING
- BICYCLE STORAGE
- EV PROPOSED LEVEL-2 CHARGER LOCATION

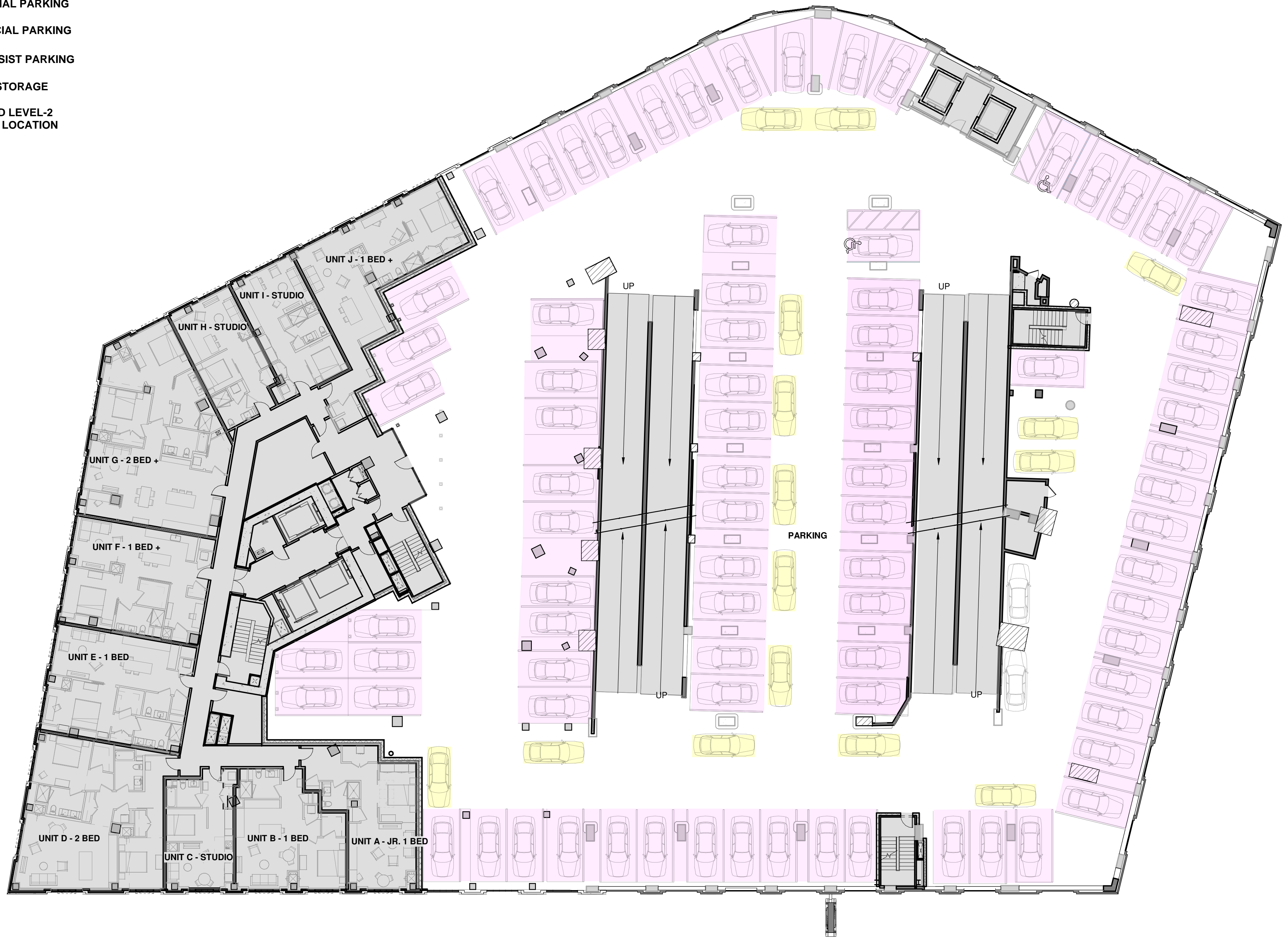

Motor Mart Garage - Parking Totals				
Level	Residential Parking	Commercial Parking	Valet Assist Parking	Total
Level 5	0	83	17	100

**LEVEL 5 PARKING LAYOUT**

MOTOR MART GARAGE  
201 STUART STREET  
BOSTON, MA



**LEGEND**

- RESIDENTIAL PARKING
- COMMERCIAL PARKING
- VALET ASSIST PARKING
- BICYCLE STORAGE
- EV PROPOSED LEVEL-2 CHARGER LOCATION

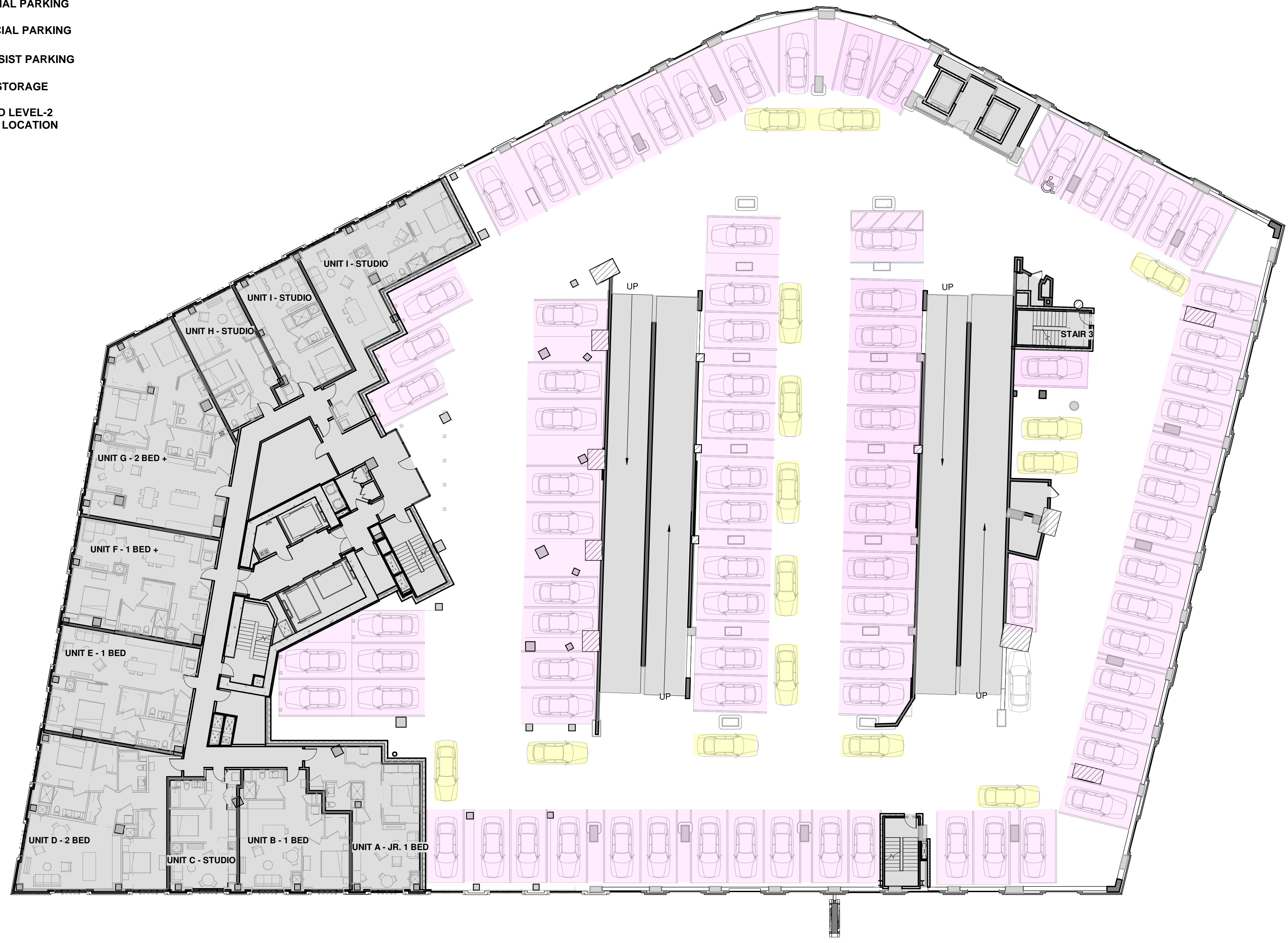

Motor Mart Garage - Parking Totals				
Level	Residential Parking	Commercial Parking	Valet Assist Parking	Total
Level 6	0	84	16	100

**LEVEL 6 PARKING LAYOUT**

MOTOR MART GARAGE  
201 STUART STREET  
BOSTON, MA



**LEGEND**

- RESIDENTIAL PARKING
- COMMERCIAL PARKING
- VALET ASSIST PARKING
- BICYCLE STORAGE
- EV PROPOSED LEVEL-2 CHARGER LOCATION

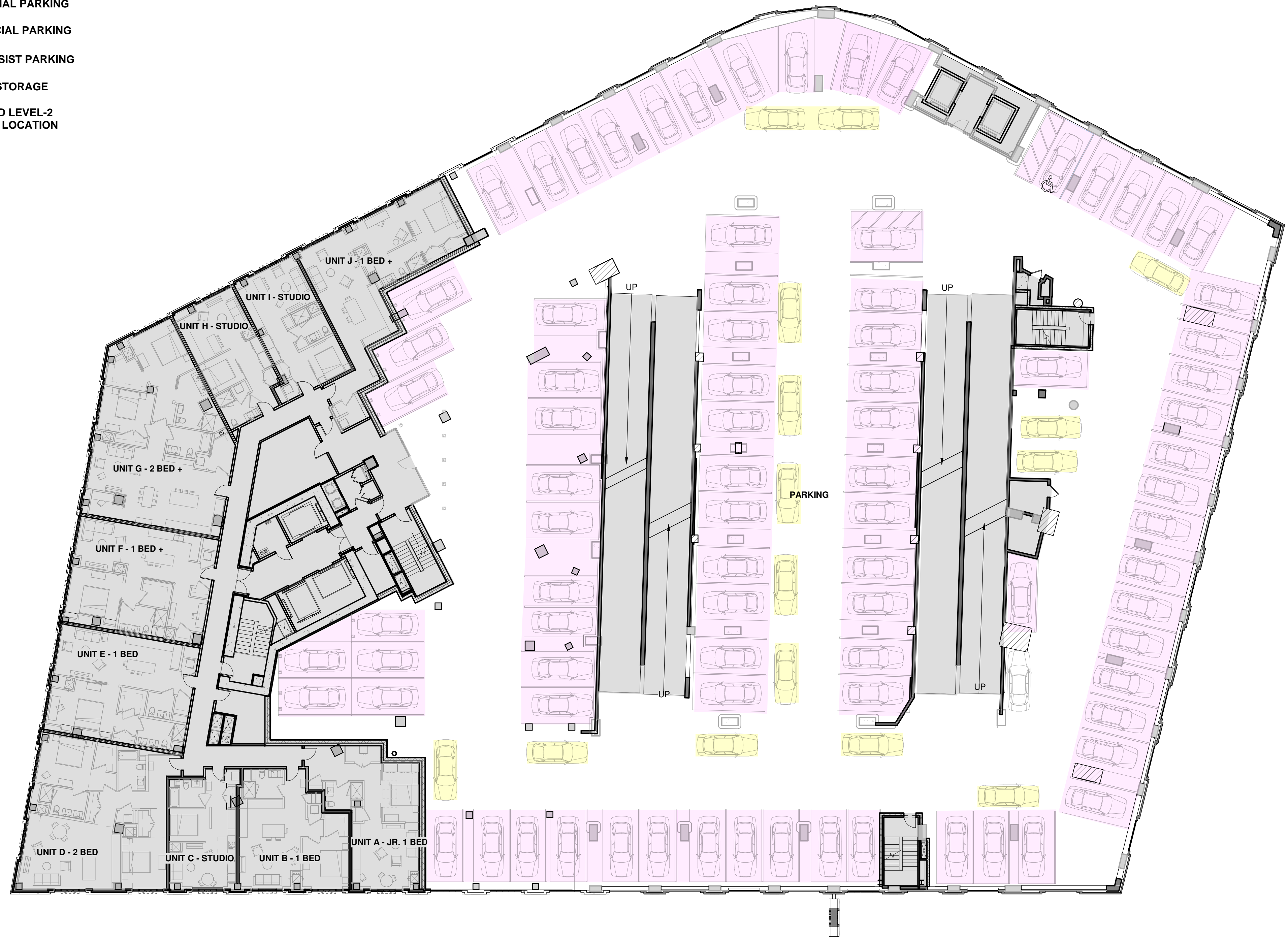

Motor Mart Garage - Parking Totals				
Level	Residential Parking	Commercial Parking	Valet Assist Parking	Total
Level 7	0	84	16	100

**LEVEL 7 PARKING LAYOUT**

MOTOR MART GARAGE  
201 STUART STREET  
BOSTON, MA



- LEGEND**
- RESIDENTIAL PARKING
  - COMMERCIAL PARKING
  - VALET ASSIST PARKING
  - BICYCLE STORAGE
  - EV PROPOSED LEVEL-2 CHARGER LOCATION



Motor Mart Garage - Parking Totals				
Level	Residential Parking	Commercial Parking	Valet Assist Parking	Total
Level 8	0	59	17	76

**LEVEL 8 PARKING LAYOUT**  
 MOTOR MART GARAGE  
 201 STUART STREET  
 BOSTON, MA

3/31/2023 12:28:13 PM



**APPENDIX F**

**EVSE EQUIVALENCE CALCULATOR**

*[See Attached]*

**Motor Mart Garage Redevelopment**  
**INTERACTIVE EV REQUIREMENT EQUIVALENCE CALCULATOR**  
**Residential Garage Component**

HOWARD STEIN HUDSON  
 April 5, 2023

PROJECT CHARACTERISTICS	<i>Fill Out Cells Below</i>
Total Parking Count -	116

TOTAL EVSE POINTS PROVIDED	TOTAL EVSE POINTS REQUIRED
116	116

**EVSE-INSTALLED EQUIVALENCE CALCULATOR**

Options	Amount of parking spaces served	Weighted Points (per mitigation measure)	Total Points	Restriction/Range
LEVEL 1 CHARGER	0	1	0	Only residential and office may offset with this option. Parking spaces must be assigned if residential.
LEVEL 2 CHARGER	24	1	24	
DCFC - 50KW	0	8	0	
DCFC - 150KW	0	24	0	
EV Carshare	0	19	0	
Electric Bike Parking Amenities	20	0.25	5	Maximum of 5 points.
<b>Total Vehicle Parking Spaces -</b>	<b>24</b>			

EVSE - INSTALLED POINTS ACCRUED	EVSE - INSTALLED POINTS REQUIRED
29	29

**EVSE-READY EQUIVALENCE CALCULATOR**

Options	Amount of parking spaces served	Weighted Points (per mitigation measure)	Total Points	Restriction/Range
LEVEL 1 CHARGER	0	1	0	Only residential and office may offset with this option. Parking spaces must be assigned if residential.
LEVEL 2 CHARGER	87	1	87	
DCFC - 50KW	0	8	0	
DCFC - 150KW	0	24	0	
<b>Total Vehicle Parking Spaces -</b>	<b>87</b>			

EVSE - READY POINTS ACCRUED	EVSE - READY POINTS REQUIRED
87	87





**APPENDIX G**

**ABUTTERS LIST (within 300 feet)**

*[See Attached]*

OWNER	MAIL_ADDRESSEE	MAIL_ADDRESS	MAIL_CS MAIL_ZIPCODE	Property_Address
GARBER MICHAEL S		2 POND CI	BEDFORD, MA, 01730	1 CHARLES STREET SOUTH 612 Boston MA 02116
MALKAWI ALI M		1 CHARLES STREET SOUTH #11G	BOSTON, MA, 02116	1 CHARLES STREET SOUTH 11G Boston MA 02116
REILLY GRETCHEN A	C/O G A REILLY	PO BOX 587	COTUIT, MA, 02635	300 BOYLSTON ST 907 Boston MA 02116
YOUNES ENAYAT		1 CHARLES STREET SOUTH #905	BOSTON, MA, 02116	1 CHARLES STREET SOUTH 905 Boston MA 02116
GOLDBERG ALAN J		1 CHARLES ST SOUTH #403	BOSTON, MA, 02116	1 CHARLES STREET SOUTH 403 Boston MA 02116
300 BOYLSTON US INC	C/O MARSH PROPERTIES/ ATT: CHERYL MARSH	30 NEWBURY ST 3RD FLR	BOSTON, MA, 02116	300 BOYLSTON ST 519 Boston MA 02116
CHARLES ACQUISITION TRUST	C/O EUGENIA ROMM	1 DALTON ST #3903	BOSTON, MA, 02115	1 CHARLES STREET SOUTH 507 Boston MA 02116
EISEN WILLIAM J TS	C/O THOMAS DESIMONE	300 BOYLSTON ST #709	BOSTON, MA, 02116	300 BOYLSTON ST 709 Boston MA 02116
BOYLSTON 250 LLC		116 FLANDERS RD STE 2000	WESTBOROUGH, MA, 01581	250 BOYLSTON ST 2B Boston MA 02116
220 BOYLSTON STREET	C/O JOSEPH CIMINO	220 BOYLSTON ST #1514	BOSTON, MA, 02116	220 BOYLSTON ST 1514 Boston MA 02116
PANTAZIS THANOS J		ONE CHARLES STREET SOUTH 2B	BOSTON, MA, 02116	1 CHARLES STREET SOUTH 2C Boston MA 02116
BJB103 LLC	C/O BARBARA BERKE	1 CHARLES STREET SOUTH #PH-103	BOSTON, MA, 02116	1 CHARLES STREET SOUTH PH-103 Boston MA 02116
SAM CHARLES STREET SOUTH NOMINEE TRUST		45 EAST HIGH ST	EAST HAMPTON, CT, 06424	1 CHARLES STREET SOUTH PH2-D Boston MA 02116
KARON THELMA H TS		220 BOYLSTON ST #1120	BOSTON, MA, 02116	220 BOYLSTON ST 1120 Boston MA 02116
STEPHEN P KELLIHER 2008	C/O STEPHEN P KELLIHER	220 BOYLSTON ST UNIT 1210	BOSTON, MA, 02116	220 BOYLSTON ST 1210 Boston MA 02116
PIOTTI LISA M		1 CHARLES STREET SOUTH #4E	BOSTON, MA, 02116	1 CHARLES STREET SOUTH 4E Boston MA 02116
NOUF HOLDINGS LLC		1 CHARLES STREET SOUTH #1506	BOSTON, MA, 02116	1 CHARLES STREET SOUTH 1506 Boston MA 02116
BLAIR HENRY E		300 BOYLSTON ST UNIT 513	BOSTON, MA, 02116	300 BOYLSTON ST 513 Boston MA 02116
WALDMAN MARVIN TS	C/O WALDMAN HIRSCH & COMPANY LLP	3 SECOND ST SUITE 204	JERSEY CITY, NJ, 07311	220 BOYLSTON ST 1011 Boston MA 02116
MAFFETT BAXTER H		1 CHARLES STREET SOUTH #501	BOSTON, MA, 02116	1 CHARLES STREET SOUTH 501 Boston MA 02116
MENDU CAPITAL LLC	C/O MENACHEM ABRAHAM	1 CHARLES STREET SOUTH #14-A	BOSTON, MA, 02116	1 CHARLES STREET SOUTH 14A Boston MA 02116
EPSTEIN ROBERT L		300 BOYLSTON ST, #703	BOSTON, MA, 02116	300 BOYLSTON ST 703 Boston MA 02116
BIGGIO ANDREW A TS	C/O MARIE RANDLOLPH	22 CROWNINSHIELD RD	MARBLEHEAD, MA, 01945	220 BOYLSTON ST 9007 Boston MA 02116
SUWELLYN LLC	C/O FAMILY OFICE MGMT SERVICES INC	50 DUNHAMRIDGE SUITE 3100	BEVERLY, MA, 01915	250 BOYLSTON ST 7 Boston MA 02116
GERALDINE M GARVIN		1 CHARLES STREET SOUTH #605	BOSTON, MA, 02116	1 CHARLES STREET SOUTH 605 Boston MA 02116
FIG CAKE REALTY TRUST	C/O REX CAPITAL ADVISORS LLC	50 PARK ROW WEST SUITE 113	PROVIDENCE, RI, 02903	1 CHARLES STREET SOUTH 1106 Boston MA 02116
NANCY J CAHN TRUST		23 PIEDMONT ST, Unit 23	BOSTON, MA, 02116	23 PIEDMONT ST 23 Boston MA 02116
GORDON PHILIP H TS		300 BOYLSTON ST #1201	BOSTON, MA, 02116	300 BOYLSTON ST 1201 Boston MA 02116
MENDU CAPITAL LLC		1 CHARLES STREET SOUTH #14A	BOSTON, MA, 02116	1 CHARLES STREET SOUTH 9C Boston MA 02116
TUCK JUDITH R		1 CHARLES ST SOUTH # 16E	BOSTON, MA, 02116	1 CHARLES STREET SOUTH 16E Boston MA 02116
SPILLANE MARY TS	C/O JOANNE HART	220 Boylston ST, Unit 9013	BOSTON, MA, 02116	220 BOYLSTON ST 9013 Boston MA 02116
DWYER MATTHEW P JR	C/O MATTHEW P DWYER JR	1 CHARLES STREET SOUTH #6D	BOSTON, MA, 02116	1 CHARLES STREET SOUTH 6D Boston MA 02116
BREWER MONTIE R		17 PIEDMONT ST #17	BOSTON, MA, 02116	17 25 PIEDMONT ST PS-5 Boston MA 02116
PRIEM WINDLE		238 VIA LAS BRISAS	PALM BEACH, FL, 33480	220 BOYLSTON ST 1412 Boston MA 02116
CASTELLI ANDREA M		1 CHARLES STREET SOUTH #3E	BOSTON, MA, 02116	1 CHARLES STREET SOUTH 3E Boston MA 02116
ULAKY CHRISTINE		1 CHARLES STREET SOUTH #305	BOSTON, MA, 02116	1 CHARLES STREET SOUTH 305 Boston MA 02116
TING DAVID T TS	C/O DAVID TING TS	222 BERKELEY ST	BOSTON, MA, 02116	1 CHARLES STREET SOUTH PH1-A Boston MA 02116
A&V ASSOCIATES LLC	C/O VALERIY KITARYEV	125 COUNTRYSIDE RD	NEWTON, MA, 02459	1 CHARLES STREET SOUTH 804 Boston MA 02116
MJR INVESTMENTS LLC		267 Boston Post RD	WAYLAND, MA, 01778-1816	300 BOYLSTON ST 606 Boston MA 02116
PANNELL SAUL TS	C/O SAUL PANNELL TS	300 BOYLSTON ST #702	BOSTON, MA, 02116	300 BOYLSTON ST 1004 Boston MA 02116
BERENSON THEODORE S ETAL		220 BOYLSTON ST #9020	BOSTON, MA, 02116	220 BOYLSTON ST 9020 Boston MA 02116
KETTENBACH FRANCES D		93 Old Sudbury RD	LINCOLN, MA, 01773-4806	1 CHARLES STREET SOUTH 6G Boston MA 02116
NANCY J CAHN TRUST		23 PIEDMONT ST, Unit 23	BOSTON, MA, 02116	17 25 PIEDMONT ST PS-2 Boston MA 02116
FSH BOYLSTON INC	C/O ACCOUNTS PAYABLE	200 BOYLSTON ST	BOSTON, MA, 02116	200 BOYLSTON ST Boston MA 02116

REGAN REMILLARD REVOCABLE TRUST OF 2020		PO BOX 1131	BOYLSTON, MA, 01505	220 BOYLSTON ST 1218 Boston MA 02116
GIANGRASSO JOSEPH SR		1 CHARLES STREET SOUTH, Unit 810	BOSTON, MA, 02116	1 CHARLES STREET SOUTH 810 Boston MA 02116
KOSTER VIRGINIA W		1 CHARLES STREET SOUTH, Unit 5C	BOSTON, MA, 02116	1 CHARLES STREET SOUTH 5C Boston MA 02116
RGM VENTURES I LLC	C/O RICHARD G MALCONIAN	251 LITTLE FALLS DRIVE	WILMINGTON, DE, 19808	1 CHARLES STREET SOUTH 706 Boston MA 02116
ZEIEN CLAUDIA L		101 SOUTH FORT LAUDERDALE BEACH BLVD	FORT LAUDERDALE, FL, 33316	300 BOYLSTON ST 1104 Boston MA 02116
SANCHEZ HERNANDO	C/O STEPHEN BORDICK	18 PIEDMONT ST	BOSTON, MA, 02116	18 20 PIEDMONT ST Boston MA 02116
HOG 808 LLC	C/O GOULSTON & STORRS PC	400 ATLANTIC AVENUE	BOSTON, MA, 02110	300 BOYLSTON ST 808 Boston MA 02116
HYLE CHARLENE K		1 CHARLES STREET SOUTH # 4-B	BOSTON, MA, 02116	1 CHARLES STREET SOUTH 4B Boston MA 02116
NEW ENGLAND SCHOOL OF LAW		56 CHARLES	BOSTON, MA, 02114	56 48 CHARLES STREET SOUTH Boston MA 02116
ALIEV SERGUEI TS	C/O MARANT INC	PO BOX 920008	NEEDHAM, MA, 02492	1 CHARLES STREET SOUTH 1502 Boston MA 02116
MENDELSON MICHAEL E TS	C/O MICHAEL E MENDELSON TS	220 BOYLSTON ST #1103	BOSTON, MA, 02116	220 BOYLSTON ST 1103 Boston MA 02116
WAMBACH VALAYA LYNN	C/O ROBERT AND VALAYA LYNN WAMBACH	1 CHARLES STREET SOUTH, UNIT #910	BOSTON, MA, 02116	1 CHARLES STREET SOUTH 910 Boston MA 02116
FARRADJ ZEIN BASSEM		1 CHARLES STREET SOUTH #1401	BOSTON, MA, 02116	1 CHARLES STREET SOUTH 1401 Boston MA 02116
ENG JAMES TS	C/O KENNETH J ENG	23 SYMPHONY DR	N EASTON, MA, 02356	220 BOYLSTON ST 1112 Boston MA 02116
DESIMONE DAVID S		1 CHARLES ST SOUTH #406	BOSTON, MA, 02116	1 CHARLES STREET SOUTH 406 Boston MA 02116
VOSS PETER S	C/O PETER VOSS	49 ROX RUN ROAD PO BOX 324	SUNAPEE, NH, 03782	1 CHARLES STREET SOUTH 7H Boston MA 02116
FELDMAN FRANCES Y		1 CHARLE STREET SOUTH #10G	BOSTON, MA, 02116	1 CHARLES STREET SOUTH 10G Boston MA 02116
HERITAGE ON GARDEN CONDO TR		75 PARK PLZ	BOSTON, MA, 02116	300 BOYLSTON ST Boston MA 02116
DIMARE REALTY TRUST		220 Boylston ST, Unit 1518	BOSTON, MA, 02116	220 BOYLSTON ST 1518 Boston MA 02116
SIXTEEN SHAWMUT STREET LLC	C/O 16 SHAWMUT ST LLC	16 SHAWMUT ST	BOSTON, MA, 02116	16 SHAWMUT ST Boston MA 02116
FINK PETER W TS	C/O PETER W FINK TS	250 BOYLSTON ST #4	BOSTON, MA, 02116	250 BOYLSTON ST 4 Boston MA 02116
ROTH REBECCA		1 CHARLES STREET SOUTH, Unit 4H	BOSTON, MA, 02116	1 CHARLES STREET SOUTH 4H Boston MA 02116
V & J NOMINEE TRUST	C/O MARIANNE MACDONALD	300 BOYLSTON ST #516	BOSTON, MA, 02116	300 BOYLSTON ST 516 Boston MA 02116
AL-KHARSA SAAD		1 CHARLES ST SOUTH # 3B	BOSTON, MA, 02116	1 CHARLES STREET SOUTH 3B Boston MA 02116
FOGAREN PETER B		24 RUSSET HILL RD	ASHLAND, MA, 01721	1 CHARLES STREET SOUTH 608 Boston MA 02116
MICHELSON ALAN D		1 CHARLES STREET SOUTH #11C	BOSTON, MA, 02116	1 CHARLES STREET SOUTH 11C Boston MA 02116
MAZER HARVEY MARK	C/O MARK MAZER	1 CHARLES STREET SOUTH #1102	BOSTON, MA, 02116	1 CHARLES STREET SOUTH 1102 Boston MA 02116
BREWER MONTIE R		17 PIEDMONT ST #17	BOSTON, MA, 02116	17 PIEDMONT ST 17 Boston MA 02116
MOSESIAN ELAINE L		300 BOYLSTON ST #904	BOSTON, MA, 02116	300 BOYLSTON ST 904 Boston MA 02116
ONE CHARLES STREET LLC	POSTERNAK BLANKSTEIN & LUND	800 BOYLSTON ST	BOSTON, MA, 02199	1 CHARLES STREET SOUTH 504 Boston MA 02116
YANG CHAO P		1 CHARLES STREET SOUTH #1207	BOSTON, MA, 02116	1 CHARLES STREET SOUTH 1207 Boston MA 02116
LULL JOAQUIN P		ONE CHARLES ST SOUTH #14E	BOSTON, MA, 02116	1 CHARLES STREET SOUTH 14E Boston MA 02116
BOLD JOYCE FIOCCA	C/O DRUKER LTD-A CERRI	50 FEDERAL ST 10TH FL	BOSTON, MA, 02110	300 BOYLSTON ST 706 Boston MA 02116
VACOVEC KENNETH J		220 BOYLSTON ST #9002-9004	BOSTON, MA, 02116	220 BOYLSTON ST 9002-9004 Boston MA 02116
CALRAE PROPERTIES LLC		PO BOX 937	W BARNSTABLE, MA, 02668	220 BOYLSTON ST 9010 Boston MA 02116
CRK BOSTON PROPERTIES LLC	C/O CARMELLA KLETJIAN	87 HUNTER RISE	CHATHAM, MA, 02633	1 CHARLES STREET SOUTH 1512 Boston MA 02116
STEPHANIE BROWN TRUST - 2003	C/O STEPHANIE BROWN	220 BOYLSTON ST #1016	BOSTON, MA, 02116	220 BOYLSTON ST 1014-1016 Boston MA 02116
SELVAGGI JOSEPH A		1 CHARLES STREET SOUTH #8A	BOSTON, MA, 02116	1 CHARLES STREET SOUTH 8A Boston MA 02116
STEPHEN J HENDRICKSON 2014	C/O STEPHEN HENDRICKSON	1 CHARLES STREET S #PH2-A	BOSTON, MA, 02116	1 CHARLES STREET SOUTH PH2-A Boston MA 02116
LEVY FAMILY 2011 TRUST FOR BENEFIT OF SUSAN D LEVY		300 BOYLSTON ST, Unit 1204	BOSTON, MA, 02116	300 BOYLSTON ST 1204 Boston MA 02116
ROBIN S WEINBERGER REVOCABLE TRUST		220 Boylston ST, Unit 1204	BOSTON, MA, 02116	220 BOYLSTON ST 1204 Boston MA 02116
RAUCH DANIEL		25 PIEDMONT ST #3	BOSTON, MA, 02116	17 25 PIEDMONT ST PS-8 Boston MA 02116
CUTLER JOEL E		220 BOYLSTON ST #1416-1418	BOSTON, MA, 02116	220 BOYLSTON ST 1416-1418 Boston MA 02116
LE JARDIN CONDO TRUST		244 BOYLSTON ST	BOSTON, MA, 02116	244 250 BOYLSTON ST Boston MA 02116
CHI B VU LIVING TRUST		1 CHARLES STREET SOUTH, Unit 801	BOSTON, MA, 02116	1 CHARLES STREET SOUTH 801 Boston MA 02116

FOSTER DIANE		220 BOYLSTON ST #1008	BOSTON, MA, 02116	220 BOYLSTON ST 1008 Boston MA 02116
LUBIN KATE E TS	C/O KATE E LUBIN	1 CHARLES ST SOUTH #PH1-D	BOSTON, MA, 02116	1 CHARLES STREET SOUTH PH1-D Boston MA 02116
TSAI VICKI		ONE CHARLES ST SOUTH #1112	BOSTON, MA, 02116	1 CHARLES STREET SOUTH 1112 Boston MA 02116
RAUCH DANIEL		25 PIEDMONT ST #3	BOSTON, MA, 02116	25 PIEDMONT ST 3 Boston MA 02116
BOSTON 1927 OWNER LLC		200 SPECTRUM CENTER DR 21ST FL	IRVINE, CA, 92618	50 PARK PZ HOTEL Boston MA 02116
PETERSON KEVIN L		220 BOYLSTON ST #9016	BOSTON, MA, 02116	220 BOYLSTON ST 9016 Boston MA 02116
CHARLES ACQUISITION TRUST	C/O LEV ROMM	1 DALTON ST #3903	BOSTON, MA, 02115	1 CHARLES STREET SOUTH 807 Boston MA 02116
ANDERSON CAROL JANE		300 BOYLSTON ST #603	BOSTON, MA, 02116	300 BOYLSTON ST 603 Boston MA 02116
GG REALTY TRUST	RUTH/SHELDON BRAMSON	1 CHARLES STREET SOUTH UNIT 3H	BOSTON, MA, 02116	1 CHARLES STREET SOUTH 3H Boston MA 02116
SEBAOUN JEAN DAVID	C/O CHARLESGATE REALTY GROUP	867 BOYLSTON ST 3RD FL	BOSTON, MA, 02115	1 CHARLES STREET SOUTH 1607 Boston MA 02116
SLOCUM PHYLLIS S		1 CHARLES STREET SOUTH #12E	BOSTON, MA, 02116	1 CHARLES STREET SOUTH 12E Boston MA 02116
WEISS HUGH E		1 CHARLES ST SOUTH # 214	BOSTON, MA, 02116	1 CHARLES STREET SOUTH 214 Boston MA 02116
DALY JANE F	C/O JANE DALY	300 BOYLSTON ST #805	BOSTON, MA, 02116	300 BOYLSTON ST 805 Boston MA 02116
JRJM LLC		99 BROOK ST	WELLESLEY , MA, 02482	1 CHARLES STREET SOUTH 703 Boston MA 02116
PHILLIPS ASA E III	C/O MITCHELL A KASSLER TS	1 CHARLE STREET SOUTH #1002	BOSTON, MA, 02116	1 CHARLES STREET SOUTH 1002 Boston MA 02116
ALLISON ELIZABETH K		69 PINEHURST RD	BELMONT, MA, 02478	300 BOYLSTON ST 1101 Boston MA 02116
ARCHIVES CONDOMINIUM TRUST		22-24 PIEDMONT ST	BOSTON, MA, 02116	22 24 PIEDMONT ST Boston MA 02116
GRAVES BERNARD		1 CHARLES STREET SOUTH #602	BOSTON, MA, 02116	1 CHARLES STREET SOUTH 602 Boston MA 02116
PHILLIPS CONSTANTINE		1 CHARLES STREET SOUTH #5F	BOSTON, MA, 02116	1 CHARLES STREET SOUTH 5F Boston MA 02116
PTP LLC		150 NEWPORT AVE EXT	QUINCY, MA, 02171	300 BOYLSTON ST 614 Boston MA 02116
FRUSZTAJER BORUCH B		300 BOYLSTON ST #515	BOSTON, MA, 02116	300 BOYLSTON ST 901 Boston MA 02116
MDA PARK LLC	C/O HYUN D KIM	35 BOGLE ST	WESTON, MA, 02493	1 CHARLES STREET SOUTH 709 Boston MA 02116
UNIT 10C ONE CHARLES ST	C/O SONJA YATES	1 CHARLES STREET SOUTH #10C	BOSTON, MA, 02116	1 CHARLES STREET SOUTH 10C Boston MA 02116
SAPIENZA LLC		100 ALINGTON STREET UNIT 14D	BOSTON, MA, 02116	1 CHARLES STREET SOUTH 15G Boston MA 02116
SILVERSTEIN LAWRENCE I	C/O MARTIN M HALE	220 BOYLSTON ST #1018-1020	BOSTON, MA, 02116	220 BOYLSTON ST 1018-1020 Boston MA 02116
REMILLARD JANE E		220 BOYLSTON ST #1116	BOSTON, MA, 02116	220 BOYLSTON ST 1116 Boston MA 02116
BILAZARIAN MELANIE		1 CHARLES STREET SOUTH, Unit 1405	BOSTON, MA, 02116	1 CHARLES STREET SOUTH 1405 Boston MA 02116
K AND K REALTY (KACHADURIAN) LLC		300 BOYLSTON ST, Unit 502	BOSTON, MA, 02116	300 BOYLSTON ST 502 Boston MA 02116
MARGARET MCCARTHY REVOCABLE TRUST PO BOX 641		C/O MARGARET M MCCARTHY	CHATHAM, MA, 02633	300 BOYLSTON ST 712 Boston MA 02116
201 STUART STREET (OWNER) LLC	C/O CUSHMAN & WAKEFIELD	P.O. BOX 131237	CARLSBAD, CA, 92013	201 241 STUART ST Boston MA 02116
BOYCE JOHN		1 CHARLES STREET SOUTH #3C	BOSTON, MA, 02116	1 CHARLES STREET SOUTH 3C Boston MA 02116
FISHER JOHN H		1 CHARLES STREET SOUTH # 8D	BOSTON, MA, 02116	1 CHARLES STREET SOUTH 8D Boston MA 02116
SITZMANN THOMAS G TS	C/O THOMAS G SITZMANN TS	300 BOYLSTON ST #707	BOSTON, MA, 02116	300 BOYLSTON ST 707 Boston MA 02116
RANDO CAROL		93 OLD SUDBURY RD	LINCOLN, MA, 01773	1 CHARLES STREET SOUTH 401 Boston MA 02116
SMITH STEVEN R	C/O SANDRA R & STEVEN R SMITH	300 BOYLSTON ST # 517	BOSTON, MA, 02116	300 BOYLSTON ST 517 Boston MA 02116
NLH HOLDINGS LLC		81 BEACON ST	BOSTON, MA, 02108	1 CHARLES STREET SOUTH 1210 Boston MA 02116
WEZNIAK FRANK J		1 CHARLES ST SOUTH #14G	BOSTON, MA, 02116	1 CHARLES STREET SOUTH 14G Boston MA 02116
CAROLE KAY REVOCABLE TRUST	C/O CAROLE KAY	25 PIEDMONT ST #2	BOSTON, MA, 02116	17 25 PIEDMONT ST PS-11 Boston MA 02116
KARABELAS ARGERIS N		461 COURT ST	PORTSMOUTH, NH, 03801	220 BOYLSTON ST 9005 Boston MA 02116
CATALFANO ANTHONY		220 BOYLSTON ST #9011	BOSTON, MA, 02116	220 BOYLSTON ST 9011 Boston MA 02116
250B1 LLC		85 BOSTON ST	EVERETT, MA, 02149	220 BOYLSTON ST 1614 Boston MA 02116
SIMHA VIKRAM	C/O MATTHEW R NOVAK	1 CHARLES STREET SOUTH, Unit 1504	BOSTON, MA, 02116	1 CHARLES STREET SOUTH 1504 Boston MA 02116
FALCONE JOSEPH P		220 BOYLSTON ST #1009	BOSTON, MA, 02116	220 BOYLSTON ST 1009 Boston MA 02116
MARSHALL JANE W		220 BOYLSTON ST #1015	BOSTON, MA, 02116	220 BOYLSTON ST 1015 Boston MA 02116
PAUL BIMLA		1 CHARLES STREET SOUTH # 902	BOSTON, MA, 02116	1 CHARLES STREET SOUTH 902 Boston MA 02116

CANOE NOMINEE TRUST FARRER LAWRENCE	C/O ATHENA CAPITAL ADVISORS LLC	55 OLD BEDFORD ROAD SUITE 302 1 CHARLES ST SOUTH #11D	LINCOLN, MA, 01773 BOSTON, MA, 02116	250 BOYLSTON ST 5 Boston MA 02116 1 CHARLES STREET SOUTH 11D Boston MA 02116 Boston MA
THENEP 2018 IRREVOCABLE TRUST MARGARET MCCARTHY REVOCABLE TRUST PO BOX 641 ALI EJAZ	C/O THANOS PANTAZIS	1 CHARLES STREET SOUTH #2A C/O MARGARET M MCCARTHY 1 CHARLES STREET SOUTH #802	BOSTON, MA, 02116 CHATHAM, MA, 02633 BOSTON, MA, 02116	1 CHARLES STREET SOUTH 2A Boston MA 02116 300 BOYLSTON ST 1002 Boston MA 02116 1 CHARLES STREET SOUTH 802 Boston MA 02116
HERNANDEZ GARY A TS BOYLSTON JARDIN LLC MASS LLC 200 STUART STREET BURTON JEREMY	C/O GARY A HERNANDEZ C/O C TALANIAN REALTY CO INC C/O PEBBLEBROOK HOTEL TRUST	56 ARROWWOOD DRIVE 137 NEWBURY ST 9TH FLR 7315 WISCONSIN AV STE 1100W 1 CHARLES STREET SOUTH, Unit 1104	SCITUATE, MA, 02066 BOSTON, MA, 02116 BETHESDA, MD, 20814 BOSTON, MA, 02116	1 CHARLES STREET SOUTH PH-101 Boston MA 02116 250 BOYLSTON ST 1 Boston MA 02116 210 196 STUART ST Boston MA 02116 1 CHARLES STREET SOUTH 1104 Boston MA 02116
VONDRAN STEVEN BRIDGEPORT ASSOCIATES INC DOUBLE Z INC WELLER SIMCHA J	C/O HOWARD COX C/O DOUBLE Z, INC.	19 PIEDMONT ST #19 220 BOYLSTON ST #1510 PO BOX 7 220 Boylston ST, Unit 1003	BOSTON, MA, 02116 BOSTON, MA, 02116 ROSLYN HEIGHTS, NY, 11577 BOSTON, MA, 02116	19 PIEDMONT ST 19 Boston MA 02116 220 BOYLSTON ST 1510 Boston MA 02116 1 CHARLES STREET SOUTH 1201 Boston MA 02116 220 BOYLSTON ST 1003 Boston MA 02116
NORMAN KNIGHT REVOCABLE TRUST MONTERO WILLIAM A MAH HARRY SN TS SHEILA F GEOGHEGAN TRUST HATCH ROBERT F	C/O NORMAN KNIGHT C/O TIMOTHY MAH	220 BOYLSTON ST #1216 1 CHARLES STREET SOUTH #1605 1 SHERWOOD PL 13 WINCHESTER ST 1 CHARLES STREET SOUTH #6B	BOSTON, MA, 02116 BOSTON, MA, 02116 SCARSDALE, NY, 10583 BOSTON, MA, 02116 BOSTON, MA, 02116	220 BOYLSTON ST 1216 Boston MA 02116 1 CHARLES STREET SOUTH 1605 Boston MA 02116 1 CHARLES STREET SOUTH 1610 Boston MA 02116 13 WINCHESTER ST 13 Boston MA 02116 1 CHARLES STREET SOUTH 6B Boston MA 02116
FIGLER 2017 FUNDING TRUST HASEOTES GEORGE P PARK PLAZA CONDO TRUST BROWN DOUGLAS R ROBERTS EDWARD B TS LIPMAN STEPHEN I TS	AVIVA FIGLER	25 PIEDMONT ST #4 2 WALNUT ST 20 PARK PZ 1200 GULF BLVD APT 2005 300 BOYLSTON ST #1102 1 CHARLES STREET SOUTH #808	BOSTON, MA, 02116 HALIFAX, MA, 02338 BOSTON, MA, 02116 CLEARWATER, FL, 33767 BOSTON, MA, 02116 BOSTON, MA, 02116	25 PIEDMONT ST 4 Boston MA 02116 220 BOYLSTON ST 1220 Boston MA 02116 20 54 PARK PZ Boston MA 02116 1 CHARLES STREET SOUTH 704 Boston MA 02116 300 BOYLSTON ST 1102 Boston MA 02116 1 CHARLES STREET SOUTH 808 Boston MA 02116
YAZDANSETA KIANOOSH TS SILBEY SUSAN S MILLER PAUL R GANNET REALTY HOLDINGS US LLC ELIAS HOWARD D TS PARK PLAZA RETAIL LLC DEAN JEFFERY J AVK LLC A MASS LLC PLATT MARJORIE A LATORRE JAMES J CJA BOYLSTON LLC HERLIVERT LLC MASS LLC SILVERMAN HELAINE E HASMA HOLDINGS LTD SAUNDERS ROGER TS CHABAD-LUBAVITCH INC DIMAMBRO ANTONIO G MESSING ARNOLD P GIDGET LLC MORAN DONALD F	C/O KIANOOSH YAZDANSETA TS C/O SUSAN S SELBEY C/O SOTOMAYOR CPA/ ATTN: IVAN SOTOMAYOR C/O HOWARD D ELIAS TS C/O D DAVID GOBEN C/O JEFFERY DEAN C/O BRIAN R BOISVERT MGR C/O MHC-USA, INC./GERARD TETO C/O ROGER A SAUNDERS C/O CHABAD-LUBAVITCH, INC C/O ANTONIO DIMAMBRO C/O BARBARA M GINADER	1 CHARLES STREET SOUTH, Unit 5A 300 BOYLSTON ST #609 17 WINCHESTER ST 540 S MARENGO AVE 300 BOYLSTON ST #806 1790 BROADWAY 5TH FL 18 SUMMER ST 125 COUNTRYSIDE RD 1 CHARLES STREET SOUTH #5G 20 ORCHARD LN 450 LEXINGTON STREET SUITE 101 54 PIEDMONT ST 1 CHARLES STREET SOUTH #7F 1270 6TH AVE, STE 2220 220 BOYLSTON ST #1117 491 COMMONWEALTH AV 1 CHARLES STREET SOUTH #1006 1 CHARLES STREET SOUTH # 15H 11924 FOREST HILL BLVD, STE 10A-343 1 CHARLES STREET SOUTH #10-D	BOSTON, MA, 02116 BOSTON, MA, 02116 BOSTON, MA, 02116 PASADENA , CA, 91101 BOSTON, MA, 02116 NEW YORK, NY, 10019 WINCHESTER, MA, 01890 NEWTON, MA, 02459 BOSTON, MA, 02116 DUXBURY, MA, 02332 NEWTON, MA, 02466 BOSTON, MA, 02116 BOSTON, MA, 02116 NEW YORK, NY, 10020 BOSTON, MA, 02116 BOSTON, MA, 02215 BOSTON, MA, 02116 BOSTON, MA, 02116 WELLINGTON, FL, 33414 BOSTON, MA, 02116	1 CHARLES STREET SOUTH 5A Boston MA 02116 300 BOYLSTON ST 609 Boston MA 02116 26 28 PIEDMONT ST Boston MA 02116 300 BOYLSTON ST 505 Boston MA 02116 300 BOYLSTON ST 806 Boston MA 02116 1 CHARLES STREET SOUTH COMM A Boston MA 02116 1 CHARLES STREET SOUTH 312 Boston MA 02116 1 CHARLES STREET SOUTH 603 Boston MA 02116 300 BOYLSTON ST 701 Boston MA 02116 300 BOYLSTON ST 511 Boston MA 02116 PIEDMONT ST Boston MA 02116 1 CHARLES STREET SOUTH 7F Boston MA 02116 220 BOYLSTON ST 8020 Boston MA 02116 220 BOYLSTON ST 1117 Boston MA 02116 16 14 PIEDMONT ST Boston MA 02116 1 CHARLES STREET SOUTH 1006 Boston MA 02116 1 CHARLES STREET SOUTH 15H Boston MA 02116 1 CHARLES STREET SOUTH PH-203 Boston MA 02116 1 CHARLES STREET SOUTH 10D Boston MA 02116

TRUST DAVID ANDREW	C/O DAVID ANDREW TRUST TS	220 BOYLSTON ST #1110	BOSTON, MA, 02116	220 BOYLSTON ST 1110 Boston MA 02116
COVE PLAZA ASSOCIATES LLP	C/O MARK DONOHUE - WESTON ASSOCIATES	170 NEWBURY ST	BOSTON, MA, 02116	246 224 STUART ST Boston MA 02116
JAGANATHAN ARUN MARCEL		1 CHARLES STREET SOUTH #1410	BOSTON, MA, 02116	1 CHARLES STREET SOUTH 1410 Boston MA 02116
ANNMARIE SASDI TRUST-2013		300 Boylston ST, Unit 715	BOSTON, MA, 02116	300 BOYLSTON ST 715 Boston MA 02116
ONE HUNDRED ARLINGTON	100 ARLINGTON ACQUISITION CO	500 BOYLSTON ST #1880	BOSTON, MA, 02116	100 ARLINGTON ST Boston MA 02116
KIM JOHN J-H		1 CHARLES STREET SOUTH #14C	BOSTON, MA, 02116	1 CHARLES STREET SOUTH 14C Boston MA 02116
MARCIA C MORRIS 2013		220 BOYLSTON ST #9008	BOSTON, MA, 02116	220 BOYLSTON ST 9008 Boston MA 02116
BDD HAK BOSTON REALTY LLC		134 MADISON AVE	NEW YORK, NY, 10016	200 STUART ST RETAIL UNIT Boston MA 02116
SCERBO RICHARD W	C/O RICHARD SCERBO	1 CHARLES ST SOUTH #11H	BOSTON, MA, 02116	1 CHARLES ST SOUTH 11H Boston MA 02116
KCW BOSTON PROPERTIES LLC	C/O KENNETH C WEISS	116 GLANDERS RD SUITE 3000	WESTBOROUGH, MA, 01581	1 CHARLES STREET SOUTH 906 Boston MA 02116
GOLDEN LLC	C/O MIGRATION CAPITAL	60 DEDHAM AVE STE 203	NEEDHAM HEIGHTS, MA, 02492	250 BOYLSTON ST 3A Boston MA 02116
YASHINSKY MARK E		1 CHARLES STREET SOUTH #8G	BOSTON, MA, 02116	1 CHARLES STREET SOUTH 8G Boston MA 02116
CHARLESPARTNER REAL ESTATE CORP	C/O CHARLESPARTNER R E CORP	21 CEDAR RD	CHESTNUT HILL, MA, 02467	1 CHARLES STREET SOUTH 2D Boston MA 02116
GERSTEN SAMUEL		1 CHARLES STREET SOUTH #4F	BOSTON, MA, 02116	1 CHARLES STREET SOUTH 4F Boston MA 02116
HERITAGE ON THE GARDEN LLC	C/O MIAE CHO	2200 N OCEAN BLVD UNIT N804	FORT LAUDERDALE, FL, 33305	300 BOYLSTON ST 514 Boston MA 02116
MOIN KAMBIZ		1 CHARLES STREET SOUTH #502	BOSTON, MA, 02116	1 CHARLES STREET SOUTH 502 Boston MA 02116
BAUM JAMES		1 CHARLES STREET SOUTH #9G	BOSTON, MA, 02116	1 CHARLES STREET SOUTH 9G Boston MA 02116
STEPANIAN IRA		300 BOYLSTON ST #704	BOSTON, MA, 02116	300 BOYLSTON ST 704 Boston MA 02116
BASS MICHAEL A TS	C/O BASS DOHERTY & FINKS PC	40 SOLDIERS FIELD PLACE	BOSTON, MA, 02135	220 BOYLSTON ST 1201 Boston MA 02116
DRAY JOANNE		1 CHARLES STREET SOUTH #606	BOSTON, MA, 02116	1 CHARLES STREET SOUTH 606 Boston MA 02116
GIRSHICK BIRGIT	C/O BIRGIT GIRSHICK	1 CHARLES STREETSOUTH #1507	BOSTON, MA, 02116	1 CHARLES STREET SOUTH 1507 Boston MA 02116
KATHLEEN R MURPHY 2011	C/O JOHN V MURPHY	300 BOYLSTON ST #902	BOSTON, MA, 02116	300 BOYLSTON ST 902 Boston MA 02116
BOSTON AMA LLC	C/O WALTHER & SHUFFAIN PC	ONE INTERNATIONAL PL SUITE 1010	BOSTON, MA, 02110	220 BOYLSTON ST 1012 Boston MA 02116
GORESH ANDREW C TS	C/O ANDREW C GORESH TS	1 CHARLES ST SOUTH #1205	BOSTON, MA, 02116	1 CHARLES STREET SOUTH 1205 Boston MA 02116
MEYER ANDREW C JR		240 FAIRHAVEN HILL RD	CONCORD, MA, 01742	220 BOYLSTON ST 9014 Boston MA 02116
RAMTEKE SMITA B		1 CHARLES ST SOUTH #1107	BOSTON, MA, 02116	1 CHARLES STREET SOUTH 1107 Boston MA 02116
251 PIEDMONT LLC		25 PIEDMONT ST #1	BOSTON, MA, 02116	25 PIEDMONT ST 1 Boston MA 02116
FLETCHER PAUL M		1 CHARLES STREET SOUTH #1601	BOSTON, MA, 02116	1 CHARLES STREET SOUTH 1601 Boston MA 02116
ONE CHARLES ST SOUTH PH1B LLC	C/O GML ASSOCIATES, LLC.	400 COMMONWEALTH AV	BOSTON, MA, 02215	1 CHARLES STREET SOUTH PH1-B Boston MA 02116
NLH HOLDINGS LLC		81 BEACON ST	BOSTON, MA, 02108	220 BOYLSTON ST 1006 Boston MA 02116
LIVIS DOREEN E TS		220 BOYLSTON ST #1213	BOSTON, MA, 02116	220 BOYLSTON ST 1213 Boston MA 02116
GHASSEMI-TARY SARA		1 CHARLES STREET SOUTH #3F	BOSTON, MA, 02116	1 CHARLES STREET SOUTH 3F Boston MA 02116
ADELSON DAVID		300 BOYLSTON ST, #910	BOSTON, MA, 02116	300 BOYLSTON ST 910 Boston MA 02116
HERITAGE PUBLIC GARDEN LLC	C/O MMP MANAGEMENT LLC	31 ST JAMES AVENUE SUITE 740	BOSTON, MA, 02116	300 BOYLSTON ST 1005 Boston MA 02116
APARNA & URVASHI UPADHYAY IRREVOCABLE TRUST		1 CHARLES STREET SOUTH, Unit 510	BOSTON, MA, 02116	1 CHARLES STREET SOUTH 510 Boston MA 02116
MARK DENNIS P		1 CHARLES STREET SOUTH #6E	BOSTON, MA, 02116	1 CHARLES STREET SOUTH 6E Boston MA 02116
BORISENKO VALERY	C/O LIANA BORISENKO	3 COMMONWEALTH AV #601	BOSTON, MA, 02116	300 BOYLSTON ST 601 Boston MA 02116
UNIT 1414 NOMINEE TRUST	C/O JOEL E CUTLER	220 BOYLSTON ST #1414	BOSTON, MA, 02116	220 BOYLSTON ST 1414 Boston MA 02116
PLIMPTON CHARLES A		1 CHARLES STREET SOUTH # 805	BOSTON, MA, 02116	1 CHARLES STREET SOUTH 805 Boston MA 02116
VONDRAN STEVEN		19 PIEDMONT ST #19	BOSTON, MA, 02116	17 25 PIEDMONT ST PS-3 Boston MA 02116
DALLAI RICCARDO		1 CHARLES STREET SOUTH, Unit 5D	BOSTON, MA, 02116	1 CHARLES STREET SOUTH 5D Boston MA 02116
KAUFMAN LORNA		300 BOYLSTON ST #612	BOSTON, MA, 02116	300 BOYLSTON ST 612 Boston MA 02116
GARDILL MARY E		1 CHARLES STREET SOUTH #308	BOSTON, MA, 02116	1 CHARLES STREET SOUTH 308 Boston MA 02116
HOUARD ALAIN		182 AVENUE DE VERSAILLES	PARIS, FRANCE, 75016	1 CHARLES STREET SOUTH 6H Boston MA 02116
GUARRACINO-SILVER NOMINEE TRUST		1 CHARLES ST SOUTH, Unit 16-D	BOSTON, MA, 02116	1 CHARLES STREET SOUTH 707 Boston MA 02116

WESTWIN REALTY TRUST		300 BOYLSTON ST, Unit 1105	BOSTON, MA, 02116	300 BOYLSTON ST 1105 Boston MA 02116
DODGE ASEMENA T		300 BOYLSTON ST, #508	BOSTON, MA, 02116	300 BOYLSTON ST 508 Boston MA 02116
DEW 2020 IRREVOCABLE TRUST		10 SPRUCE HILL RD	WESTON, MA, 02493	300 BOYLSTON ST 809 Boston MA 02116 Boston MA
MACKIE FLORENCE M	C/O FLORENCE M MACKIE	1 CHARLES STREET SOUTH #4C	BOSTON, MA, 02116	1 CHARLES STREET SOUTH 4C Boston MA 02116
HASHIM HASHIM		1 CHARLES STREET SOUTH #1012	BOSTON, MA, 02116	1 CHARLES STREET SOUTH 1012 Boston MA 02116
SHOMALI MARYAM		1 CHARLES STREET SOUTH #912	BOSTON, MA, 02116	1 CHARLES STREET SOUTH 912 Boston MA 02116
DEROETH CHRISTOPHER		220 BOYLSTON ST #1114	BOSTON, MA, 02116	220 BOYLSTON ST 1114 Boston MA 02116
HALE PALMER G ETAL		20 SHAWMUT ST	BOSTON, MA, 02116	20 SHAWMUT ST Boston MA 02116
FALCIONE RONALD D		ONE CHARLES STREET SOUTH #7C	BOSTON, MA, 02116	1 CHARLES STREET SOUTH 7C Boston MA 02116
PARK FAMILY TRUST	C/O CHARLIE PARK	5415 SURREY ST	CHEVY CHASE, MD, 20817	1 CHARLES STREET SOUTH 701 Boston MA 02116
ROMANO JOSEPH J TS		220 BOYLSTON ST #8014	BOSTON, MA, 02116	220 BOYLSTON ST 8014 Boston MA 02116
MOWSCHENSON NADINE BERMAN		1 CHARLES STREET SOUTH #15-D	BOSTON, MA, 02116	1 CHARLES STREET SOUTH 15D Boston MA 02116
KCW BOSTON PROPERTIES LLC	C/O KENNETH C WEISS	PO BOX 11976	FORT LAUDERDALE, FL, 33339	1 CHARLES STREET SOUTH 210 Boston MA 02116
DEW 2020 IRREVOCABLE TRUST		10 SPRUCE HILL RD	WESTON, MA, 02493	300 BOYLSTON ST 803 Boston MA 02116
ALBANYAN ESAM ABDULLAH		1 CHARLES STREET SOUTH #409	BOSTON, MA, 02116	1 CHARLES STREET SOUTH 409 Boston MA 02116
MOONEY JAMES F III		166 EDMUNDS ROAD	WELLESLEY, MA, 02481	220 BOYLSTON ST 1107 Boston MA 02116
BARRY V ENGEL AND HARRIET M	C/O BARRY V ENGEL	1 CHARLES STREET SOUTH #505	BOSTON, MA, 02116	1 CHARLES STREET SOUTH 505 Boston MA 02116
THERESA LUISI WARD LIVING TRUST	C/O THERESA L WARD	1 CHARLES STREET SOUTH #1101	BOSTON, MA, 02116	1 CHARLES STREET SOUTH 1101 Boston MA 02116
PIEDMONT PARK SQUARE		17-25 PIEDMONT ST	BOSTON, MA, 02116	17 25 PIEDMONT ST Boston MA 02116
KETT MARY E		1 CHARLES STREET SOUTH #34	BOSTON, MA, 02116	1 CHARLES STREET SOUTH 3A Boston MA 02116
FELDSCHER BARBARA		1 CHARLES STREET SOUTH #907	BOSTON, MA, 02116	1 CHARLES STREET SOUTH 907 Boston MA 02116
LEORA MAYER TRUST	CHARLES P MAYER	1 CHARLES STREET SOUTH #8B	BOSTON, MA, 02116	1 CHARLES STREET SOUTH 8B Boston MA 02116
FIFTY 2 CHURCH ST REALTY LLC MASS LLC		52 CHURCH ST	BOSTON, MA, 02116	52 CHURCH ST Boston MA 02116
FRUSZTAJER BORUCH B		300 BOYLSTON ST #515	BOSTON, MA, 02116	300 BOYLSTON ST 515 Boston MA 02116
WURTMAN RICHARD J		300 BOYLSTON ST, #1205	BOSTON, MA, 02116	300 BOYLSTON ST 1205 Boston MA 02116
WAMBACH VALAYA LYNN	C/O ROBERT AND VALYAY LYNN WAMBACH	1 CHARLES STREET SOUTH, UNIT #910	BOSTON, MA, 02116	1 CHARLES STREET SOUTH 609 Boston MA 02116
MENDU CAPITAL LLC		ONE CHARLES ST SOUTH #14A	BOSTON, MA, 02116	1 CHARLES STREET SOUTH 16A Boston MA 02116
GLAUBER BARBARA		300 BOYLSTON ST, Unit 905	BOSTON, MA, 02116	300 BOYLSTON ST 905 Boston MA 02116
BARBARA J PADOS REVOCABLE TRUST	C/O FRANK J PADOS JR	1 CHARLES STREET SOUTH #11A	BOSTON, MA, 02116	1 CHARLES STREET SOUTH 11A Boston MA 02116
ATKINS MARK E	C/O MARK ATKINS	1 CHARLES STREET S #PH2-B	BOSTON, MA, 02116	1 CHARLES STREET SOUTH PH2-B Boston MA 02116
STEIN JAY		220 BOYLSTON ST UNIT 1208	BOSTON, MA, 02116	220 BOYLSTON ST 1208 Boston MA 02116
LANGBORT MELVIN B	C/O MERYL L LANGBORT	1 CHARLES STREET SOUTH #9H	BOSTON, MA, 02116	1 CHARLES STREET SOUTH 9H Boston MA 02116
KWT 4 SEASONS REAL ESTATE TRUST	C/O BOWDITCH & DEWEY LLP	101 FEDERAL STREET - SUITE 1405	BOSTON, MA, 02110	220 BOYLSTON ST 1610 Boston MA 02116
CHAIMATTAYOMPOL NOPSARAN	C/O NOPSARAN CHIAMATTAYOMPOL	1 CHARLES STREET SOUTH #303	BOSTON, MA, 02116	1 CHARLES STREET SOUTH 303 Boston MA 02116
PATTERSON SHEILA M TS	C/O SHEILA M PATTERSON TS	220 BOYLSTON ST #1007	BOSTON, MA, 02116	220 BOYLSTON ST 1007 Boston MA 02116
BERMAN HAL Z		1 CHARLES ST SOUTH #1206	BOSTON, MA, 02116	1 CHARLES STREET SOUTH 1206 Boston MA 02116
21 PIEDMONT LLC		21 Piedmont ST, Unit 21	BOSTON, MA, 02116	17 25 PIEDMONT ST PS-9 Boston MA 02116
MJE 1214 LLC MASS LLC		220 Boylston ST, Unit 1214	BOSTON, MA, 02116	220 BOYLSTON ST 1214 Boston MA 02116
SNIDER ANDREW E		1 CHARLES STREET SOUTH, Unit 8H	BOSTON, MA, 02116	1 CHARLES STREET SOUTH 8H Boston MA 02116
RASS HOLDINGS	C/O MHC-USA, INC. GERARD TETO	1270 6TH AVE, STE 2220	NEW YORK, NY, 10020	220 BOYLSTON ST 9017 Boston MA 02116
YAP HOLSON ADI		1 CHARLES ST SOUTH #1602	BOSTON, MA, 02116	1 CHARLES STREET SOUTH 1602 Boston MA 02116
CITY OF BOSTON		PARK PLZ	BOSTON, MA, 02116	PARK PZ Boston MA 02116
KIRSHNER JEFFREY TS	C/O JEFFREY KIRSHNER TS	PO BOX 492494	LOS ANGELES, CA, 90049	300 BOYLSTON ST 911 Boston MA 02116
HERITAGE PUBLIC GARDEN LLC	C/O MMP MANAGEMENT LLC	31 ST JAMES AVENUE SUITE 740	BOSTON, MA, 02116	300 BOYLSTON ST 1006 Boston MA 02116

CLARKE RICHARD		1 CHARLES STREET SOUTH #512	BOSTON, MA, 02116	1 CHARLES STREET SOUTH 512 Boston MA 02116
CAROLE KAY REVOCABLE TRUST	C/O CAROLE KAY	2643 DICK WILSON DR	SARASOTA, FL, 34240	25 PIEDMONT ST 2 Boston MA 02116
JORDAN REID CHARLES	C/O CHARLES REID JORDAN	1 CHARLES STREET SOUTH #12A	BOSTON, MA, 02116	1 CHARLES STREET SOUTH 12A Boston MA 02116
ROSIELLO ROBERT		300 BOYLSTON ST #604	BOSTON, MA, 02116	300 BOYLSTON ST 604 Boston MA 02116
FUCCILLO GREGORY P		1 CHARLES STREET SOUTH #309	BOSTON, MA, 02116	1 CHARLES STREET SOUTH 309 Boston MA 02116
VITALINI WILLIAM J TS	C/O WILLIAM J VITALINI TS	67 CAPE RD	MENDON, MA, 01756	1 CHARLES STREET SOUTH 12G Boston MA 02116
WILLIAMS IAN R		22 PEIDMONT ST # 22	BOSTON, MA, 02116	22 PIEDMONT ST 22 Boston MA 02116
HUGHES MICHAEL		121 VINE ST #1003	SEATTLE, WA, 98121	1 CHARLES STREET SOUTH 1004 Boston MA 02116
HOG 804 LLC MASS LLC	C/O THE DRUKER CO LTD	50 FEDERAL ST #1000	BOSTON, MA, 02110	300 BOYLSTON ST 804 Boston MA 02116
ENTINE GERALD TS	C/O STEVEN ENTINE	6747 DIVERSITY RD	MIDDLETON, WI, 53562	300 BOYLSTON ST 509 Boston MA 02116
YOUNG SERENA		1 CHARLES STREET SOUTH #5E	BOSTON, MA, 02116	1 CHARLES STREET SOUTH 5E Boston MA 02116
RICH HOWARD	C/O PENELOPE S & FRANK A CIERI MGRS	329 WASHINGTON ST	WOBURN, MA, 01801	300 BOYLSTON ST 613 Boston MA 02116
MICHAEL A COGGIN REVOCABLE	C/O MICHAEL A COGGIN	1 CHARLES STREET SOUTH #4D	BOSTON, MA, 02116	1 CHARLES STREET SOUTH 4D Boston MA 02116
SHAUGHNESSY ANNA C	C/O DANIEL R SHAUGHNESSY	1 CHARLES ST SOUTH #710	BOSTON, MA, 02116	1 CHARLES STREET SOUTH 710 Boston MA 02116
MASSACHUSETTS DEPARTMENT OF		10 CHARLES ST SOUTH	BOSTON, MA, 02116	TREMONT ST Boston MA 02116
DARVISH MANOUCH		14 SUTTON DR	BOYNTON BEACH, FL, 33436	1 CHARLES STREET SOUTH PH-201 Boston MA 02116
WONG ROBERT W TS	C/O ROBERT W WONG TS	220 BOYLSTON ST #8016	BOSTON, MA, 02116	220 BOYLSTON ST 8016 Boston MA 02116
FAZIO MICHAEL	C/O MICHAEL FAZIO	50 LIBERTY DRIVE #9-F	BOSTON, MA, 02210	220 BOYLSTON ST 1101 Boston MA 02116
COMMON REALTY TRUST		220 BOYLSTON ST, Unit 1115	BOSTON, MA, 02116	220 BOYLSTON ST 1115 Boston MA 02116
CRAIG L WESTON 2015	C/O CRAIG L WESTON	1 CHARLES ST SO #1406	BOSTON, MA, 02116	1 CHARLES STREET SOUTH 1406 Boston MA 02116
SUSAN G KAUFMAN FAMILY TRUST		321 NEWBUR ST 2ND FL	BOSTON, MA, 02116	1 CHARLES STREET SOUTH 15E Boston MA 02116
COMMONWEALTH OF MASS		CHARLES STREET SOUTH	BOSTON, MA, 02116	CHARLES STREET SOUTH Boston MA 02116
GST EXEMPT TRUST	C/O IRA ZALEZNIK	300 BOYLSTON ST #503	BOSTON, MA, 02116	300 BOYLSTON ST 503 Boston MA 02116
AGGARWAL JYOTI		1 CHARLES STREET SOUTH #404	BOSTON, MA, 02116	1 CHARLES STREET SOUTH 404 Boston MA 02116
GUARRACINO PAUL A TS	C/O PAUL A GUARRACINO	527 SALEM ST #17	LYNNFIELD, MA, 01940	1 CHARLES STREET SOUTH 410 Boston MA 02116
LINDA STONE 2015 REVOCABLE TRUST	LINDA STONE	1 CHARLES STREET #7D	BOSTON, MA, 02116	1 CHARLES STREET SOUTH 7D Boston MA 02116
SCHOTTLAND NANCY R TS	C/O NANCY R SCHOTTLAND	1 CHARLES STREET SOUTH, Unit 702	BOSTON, MA, 02116	1 CHARLES STREET SOUTH 702 Boston MA 02116
KCW PROPERTIES LLC	C/O KENNETH C WEISS	PO BOX 11976	FORT LAUDERDALE, FL, 33339	1 CHARLES STREET SOUTH 212 Boston MA 02116
COHEN GERARD H		680 SALEM END RD	FRAMINGHAM, MA, 01701	300 BOYLSTON ST 713 Boston MA 02116
ORR JAMES F		220 BOYLSTON ST #1108	BOSTON, MA, 02116	220 BOYLSTON ST 1108 Boston MA 02116
WOODCOCK WILLIAM A	C/O WILLIAM WOODCOCK	1 CHARLES STREET SOUTH #8E	BOSTON, MA, 02116	1 CHARLES STREET SOUTH 8E Boston MA 02116
KELIHER CYNTHIA B		1 CHARLES STREET SOUTH #904	BOSTON, MA, 02116	1 CHARLES STREET SOUTH 904 Boston MA 02116
RITA CUKER REVOCABLE TRUST	C/O RITA CUKER TS	1 HUNTINGTON AV #804	BOSTON, MA, 02116	1 CHARLES STREET SOUTH 508 Boston MA 02116
COLLEEN M BAIN REVOCABLE TRUST	COLLEEN M BAIN REVOCABLE TR	425 WORTH AVENUE #3D	PALM BEACH, FL, 33480	300 BOYLSTON ST 710 Boston MA 02116
SBROGNA DEBRA		13675 VANDERBILT DR #906	NAPLES, FL, 34110	1 CHARLES STREET SOUTH 7A Boston MA 02116
HERBOS INVESTMENTS LLC	C/O MARCI DEW	PO BOX 435	WAYLAND, MA, 01778	300 BOYLSTON ST 908 Boston MA 02116
NKOTB OWNER LLC		7315 WISCONSIN AV STE 1100W	BETHESDA, MD, 20814	200 STUART ST Boston MA 02116
SST BOSTON LLC	C/O JAMES R HAGERTY	888 17TH ST NW SUITE 1000	WASHINGTON, DC, 20006	220 BOYLSTON ST 1010 Boston MA 02116
EISENSTEIN JAMES S	C/O CRAIG P GILMARTIN	220 Boylston ST, Unit 1515	BOSTON, MA, 02116	220 BOYLSTON ST 1515 Boston MA 02116
SELTZ WILLIAM E		220 BOYLSTON ST #1616	BOSTON, MA, 02116	220 BOYLSTON ST 1616 Boston MA 02116
CHAKRAVARTHY REVOCABLE INTERVIVOS TRUST		1 CHARLES STREET SOUTH, Unit 11-E	BOSTON, MA, 02116	1 CHARLES STREET SOUTH 11E Boston MA 02116
YODER MAUREEN B		1 CHARLES STREET SOUTH, Unit PH-104	BOSTON, MA, 02116	1 CHARLES STREET SOUTH PH-104 Boston MA 02116
GIANGRASSO JOSEPH D JR		1 CHARLES STREET SOUTH #1212	BOSTON, MA, 02116	1 CHARLES STREET SOUTH 1212 Boston MA 02116
SANDERSON R SCOTT TS		62 HINGHAM WAY	PEMBROKE, MA, 02359	18 SHAWMUT ST Boston MA 02116
WILLIAMS WILLIAM II TS	C/O CHARLESGATE PROP MGT LLC	867 BOYLSTON ST 3RD FL	BOSTON, MA, 02116	220 BOYLSTON ST 9006 Boston MA 02116



DAVID LONG CATTLE CO	C/O MARY LONG GORDON	7675 MAR AVENUE	LA JOLLA, CA, 92037	1 CHARLES STREET SOUTH 803 Boston MA 02116
MILLER SYDNEY L TS	C/O LISA MILLER	24 BUCKSKIN DR	WESTON, MA, 02493	300 BOYLSTON ST 512 Boston MA 02116
HERITAGE UNIT 1202 NOMINEE TRUST	C/O THOMAS & LISA RAGNO	300 BOYLSTON ST #1202	BOSTON, MA, 02116	300 BOYLSTON ST 1202 Boston MA 02116
PANTAZIS THANOS J		1 CHARLES ST SOUTH #2B	BOSTON, MA, 02116	1 CHARLES STREET SOUTH 2B Boston MA 02116
LEWIS SYLVIA D	C/O SYLVIA LEWIS	1 CHARLES STREET SOUTH #9D	BOSTON, MA, 02116	1 CHARLES STREET SOUTH 9D Boston MA 02116
21 PIEDMONT LLC		21 Piedmont ST, Unit 21	BOSTON, MA, 02116	21 PIEDMONT ST 21 Boston MA 02116
NNA ASSOCIATES MASS GP		875 EAST ST	TEWKSBURY, MA, 01876	220 BOYLSTON ST 1211 Boston MA 02116
DOUBLE Z INC	C/O ROLACO SERVICES INC	PO BOX 7	ROSLYN HEIGHTS, NY, 11577	1 CHARLES STREET SOUTH 1202 Boston MA 02116
DRAY ISAAC		1 CHARLES STREET SOUTH #606	BOSTON, MA, 02116	1 CHARLES STREET SOUTH 16G Boston MA 02116
BREWER MONTIE R		17 PIEDMONT ST #17	BOSTON, MA, 02116	17 25 PIEDMONT ST PS-6 Boston MA 02116
BOYLSTON 250 LLC		116 FLANDERS RD STE 2000	WESTBOROUGH, MA, 01581	250 BOYLSTON ST 2A Boston MA 02116
SOUTH CORNER REALTY TRUST	C/O WILLIAM C TOBIN	1 CHARLES STREET SOUTH #306	BOSTON, MA, 02116	1 CHARLES STREET SOUTH 306 Boston MA 02116
GILFORD ROSE M	C/O ROSE M. GILFORD	220 BOYLSTON ST #1004	BOSTON, MA, 02116	220 BOYLSTON ST 1004 Boston MA 02116
DIAMOND KAREN		526 WHITEHALL RD	CHATTANOOGA, TN, 37405	1 CHARLES STREET SOUTH 1612 Boston MA 02116
PATRICIA A EGAN 2014 DECLARATION OF TRUST		300 BOYLSTON ST, Unit 607	BOSTON, MA, 02116	300 BOYLSTON ST 607 Boston MA 02116
NORLAND LLC		1 CHARLES STREET SOUTH #6C	BOSTON, MA, 02116	1 CHARLES STREET SOUTH 6C Boston MA 02116
KLETJIAN CARMELLA		220 BOYLSTON ST #1217	BOSTON, MA, 02116	220 BOYLSTON ST 1217 Boston MA 02116
FOUR SEASONS 1410 TRUST		581 BOYLSTON ST	BOSTON, MA, 02116	220 BOYLSTON ST 1410 Boston MA 02116
ONE CHARLES STREET SOUTH	C/O HOLLAND & KNIGHT LLP	10 ST JAMES AVE	BOSTON, MA, 02116	1 CHARLES STREET SOUTH 1606 Boston MA 02116
CHRISTOPHER MARK M	C/O HERBERT & DEBORAH MAGID	300 Boylston ST, Unit 1003	BOSTON, MA, 02116	300 BOYLSTON ST 1003 Boston MA 02116
CERCE-SISTO LYNNMARIE		29 Suffolk WAY	Lincoln, RI, 02865-4547	PIEDMONT ST Boston MA 02116
QUINTAL JOHN J		15 WINCHESTER ST #15	BOSTON, MA, 02116	15 WINCHESTER ST 15 Boston MA 02116
JEJALO LLC	C/O MARCO FINKIELSZTEIN	10 BISHOPSGATE RD	NEWTON, MA, 02459	1 CHARLES STREET SOUTH 1412 Boston MA 02116
CURTIS CHRISTOPHER C TS	C/O DOROTHY A REMONDI	300 BOYLSTON ST #507	BOSTON, MA, 02116	300 BOYLSTON ST 506 Boston MA 02116
400 BOYLSTON STREET REALTY TRUST	C/O HICHAM ALI HASSAN	218 NEWBURY ST #3	BOSTON, MA, 02116	220 BOYLSTON ST 1001 Boston MA 02116
TWENTY PARK PLAZA LLC MASS LLC	C/O DONALD L SAUNDERS	20 PARK PLAZA #7TH FLOOR	BOSTON, MA, 02116	20 PARK PZ Boston MA 02116
FISHBEIN EVALYN LIPTON		1 CHARLES STREET SOUTH #506	BOSTON, MA, 02116	220 BOYLSTON ST 8010 Boston MA 02116
EDWARDS JOSEPH R		1 CHARLES STREET SOUTH #6F	BOSTON, MA, 02116	1 CHARLES STREET SOUTH 6F Boston MA 02116
HERITAGE 807 NOMINEE TRUST	SUE SCHENCK	300 Boylston ST, Unit 807	BOSTON, MA, 02116	300 BOYLSTON ST 807 Boston MA 02116
WRIGHT GEORGE DENNY		1 CHARLES STREET SOUTH #5B	BOSTON, MA, 02116	1 CHARLES STREET SOUTH 5B Boston MA 02116
ONE CHARLES UNIT 812 NOMINEE TRUST	C/O MARANT INC	PO BOX 920008	NEEDHAM, MA, 02492	1 CHARLES STREET SOUTH 812 Boston MA 02116
BRENTA INVESTMENTS LIMITED	C/O DANIELLE GARCIA	2955 PRIVET DRIVE	HILLSBOROUGH, CA, 94010	300 BOYLSTON ST 610 Boston MA 02116
JEFFREY A WEINSTEIN		2 AVERY ST, Unit APT-26G	BOSTON, MA, 02111	1 CHARLES STREET SOUTH 4A Boston MA 02116
PARK PLAZA RETAIL LLC	C/O D DAVID GOBEN	1790 BROADWAY 5TH FL	NEW YORK, NY, 10019	1 CHARLES STREET SOUTH COMM B Boston MA 02116
HERITAGE 702 REALTY TRUST	C/O JOHN PANTEKIDIS	300 BOYLSTON ST #702	BOSTON, MA, 02116	300 BOYLSTON ST 702 Boston MA 02116
KOHANLOO MICHELLE		1 CHARLES STREET SOUTH #1402	BOSTON, MA, 02116	1 CHARLES STREET SOUTH 1402 Boston MA 02116
LEED STEVEN B	C/O STEVEN LEED	1 CHARLES STREET SOUTH #1501	BOSTON, MA, 02116	1 CHARLES STREET SOUTH 1501 Boston MA 02116
TDC HERITAGE LLC	C/O DRUKER CO.	50 FEDERAL ST	BOSTON, MA, 02110	300 BOYLSTON ST Boston MA 02116
9001-9003 REALTY TRUST		220 Boylston ST, Unit 9001-9003	BOSTON, MA, 02116	220 BOYLSTON ST 9001-9003 Boston MA 02116
DIMAMBRO ANTONIO G	C/O ANTONIO DIMAMBRO	1 CHARLES STREET SOUTH #1006	BOSTON, MA, 02116	1 CHARLES STREET SOUTH 1007 Boston MA 02116
MEGAN ELIZABETH WEEKS REVOCABLE TRUST OF 2020		1 CHARLES STREET SOUTH, Unit PH-204	BOSTON, MA, 02116	1 CHARLES STREET SOUTH PH-204 Boston MA 02116
SCHEUER ALAN		220 BOYLSTON ST #1104	BOSTON, MA, 02116	220 BOYLSTON ST 1104 Boston MA 02116
BETTY ANN BLUM TRUST		220 BOYLSTON ST #1111	BOSTON, MA, 02116	220 BOYLSTON ST 1111 Boston MA 02116
MORRISON JEFFREY D		1 CHARLES STREET SOUTH #10H	BOSTON, MA, 02116-5450	1 CHARLES STREET SOUTH 10H Boston MA 02116
BABSON DEBORAH E		300 BOYLSTON ST #801	BOSTON, MA, 02116	300 BOYLSTON ST 801 Boston MA 02116

FARES MICHELLE KARINA	C/O MARC ROOS	484 COMMONWEALTH AV	BOSTON, MA, 02215	1 CHARLES STREET SOUTH 407 Boston MA 02116
ONE CHARLES ST LLC	H.GREGO R/1ST BOSTON RLTY INTL	165 TREMONT ST	BOSTON, MA, 02111	1 CHARLES STREET SOUTH 7G Boston MA 02116
COHOON JAMES DOUGLAS		1 CHARLES ST SOUTH # 1510	BOSTON, MA, 02116	1 CHARLES STREET SOUTH 1510 Boston MA 02116
PILTCH RICHARD		220 BOYLSTON ST, Unit 1013	BOSTON, MA, 02116	220 BOYLSTON ST 1013 Boston MA 02116
PANAS ALEXANDER		1 CHARLES STREET SOUTH #14D	BOSTON, MA, 02116	1 CHARLES STREET SOUTH 14D Boston MA 02116
MALM DAVID P	C/O WEBSTER CAPITAL	220 BOYLSTON ST #9009	BOSTON, MA, 02115	220 BOYLSTON ST 9009 Boston MA 02116
SHIEF C SUSAN		250 BOYLSTON ST #3B	BOSTON, MA, 02116	250 BOYLSTON ST 3B Boston MA 02116
JAMES H MESSENGER REVOCABLE LIVING TRUST		1605 Middle Gulf DR, Unit Unit 327	SANIBEL, FL, 33957-7618	1 CHARLES STREET SOUTH 7B Boston MA 02116
LANZILLO LOUIS J		300 BOYLSTON ST, Unit 909	BOSTON, MA, 02116	300 BOYLSTON ST 909 Boston MA 02116
MERLIS JOAN L	C/O JOAN & SCOTT MERLIS	1 CHARLES ST SOUTH #8F	BOSTON, MA, 02116	1 CHARLES STREET SOUTH 8F Boston MA 02116 Boston MA
AP ONE CHARLES LLC		1 CHARLES STREET SOUTH, Unit 4G	BOSTON, MA, 02116	1 CHARLES STREET SOUTH 4G Boston MA 02116
200 STUART STREET (GARAGE OWNER) LLC		PO BOX 131237	CARLSBAD, CA, 92013	200 STUART ST GARAGE UNIT Boston MA 02116
FAROOQUI MOHAMMED		1 CHARLES STREET SOUTH, Unit 503	BOSTON, MA, 02116	1 CHARLES STREET SOUTH 503 Boston MA 02116
STEPANIAN IRA		300 BOYLSTON ST, #705	BOSTON, MA, 02116	300 BOYLSTON ST 705 Boston MA 02116
RGM VENTURES II LLC	C/O RICHARD G MALCONIAN	10501 S GARDENS DR #107	PALM BEACH GARDEN, FL, 33418	1 CHARLES STREET SOUTH 607 Boston MA 02116
TJRE INVESTMENTS LLC		398 COLUMBUS AVE #345	BOSTON, MA, 02116	69 CHURCH ST Boston MA 02116
GOLDBERG NORMAN L TS	C/O NORMAN L GOLDBERG TS	300 BOYLSTON ST #903	BOSTON, MA, 02116	300 BOYLSTON ST 903 Boston MA 02116
JUNO TRUST	C/O J BERGSTROM	220 BOYLSTON ST #1516	BOSTON, MA, 02116	220 BOYLSTON ST 1516 Boston MA 02116
YADAV PRAMILA R		1 CHARLES STREET SOUTH # 712	BOSTON, MA, 02116	1 CHARLES STREET SOUTH 712 Boston MA 02116
LEE DONALD P		1 CHARLES STREET SOUTH, Unit PH-105	BOSTON, MA, 02116	1 CHARLES STREET SOUTH PH-105 Boston MA 02116
BAKER JON M		300 BOYLSTON ST, Unit 1203	BOSTON, MA, 02116	300 BOYLSTON ST 1203 Boston MA 02116
COONEY PETER R TS	C/O PETER R COONEY TS	220 BOYLSTON ST #1202	BOSTON, MA, 02116	220 BOYLSTON ST 1202 Boston MA 02116
FOX JOSHUA		1 CHARLES STREET SOUTH, Unit 9E	BOSTON, MA, 02116	1 CHARLES STREET SOUTH 9E Boston MA 02116
STEVEN R ZOGG REVOCABLE	C/O STEVEN R ZOGG	131 LORIAN DR	N SYRACUSE, NY, 13212	1 CHARLES STREET SOUTH 16H Boston MA 02116
RETALS LLC	PARK PROPERTY MGT GROUP LLC	1963 COMMONWEALTH AV SUITE #1	BRIGHTON, MA, 02135	220 BOYLSTON ST 9015 Boston MA 02116
MIRCHANDANI SANJIV		1 CHARLES STREET SOUTH #1204	BOSTON, MA, 02116	1 CHARLES STREET SOUTH 1204 Boston MA 02116
FIGLER 2017 FUNDING TRUST	AVIVA FIGLER	25 PIEDMONT ST #4	BOSTON, MA, 02116	17 25 PIEDMONT ST PS-7 Boston MA 02116
GK7 REALTY TRUST	C/O MARK A DALTON	P O BOX 748	FORKED RIVER, NJ, 08731	220 BOYLSTON ST 1415 Boston MA 02116
FINK PETER W		1 CHARLES STREET S #PH1-C	BOSTON, MA, 02116	1 CHARLES STREET SOUTH PH1-C Boston MA 02116
MANNOS RAYMOND		220 BOYLSTON ST #1005	BOSTON, MA, 02116	220 BOYLSTON ST 1005 Boston MA 02116
MURRAY TERRENCE TS		220 BOYLSTON ST #1212	BOSTON, MA, 02116	220 BOYLSTON ST 1212 Boston MA 02116
DUNN JUDITH		1 CHARLES STREET SOUTH, Unit 806	BOSTON, MA, 02116	1 CHARLES STREET SOUTH 806 Boston MA 02116
TOM WERNER LIVING TRUST	C/O THOMAS WERNER	1880 CENTURY PARK EAST STE 1600	LOS ANGELES, CA, 90067	300 BOYLSTON ST 602 Boston MA 02116
LEESWADTRAKUL SUCHADA	C/O BANGKPK BANK	29 BROADWAY 19TH FL	NEW YORK, NY, 10006	300 BOYLSTON ST 608 Boston MA 02116
PARLAVECCHIO JOSEPH A		1 CHARLES STREET SOUTH, Unit 509	BOSTON, MA, 02116	1 CHARLES STREET SOUTH 509 Boston MA 02116
ANGELA L SQUARCIA 2014 TRUST	C/O PAUL SQUARCIA	1 CHARLES STREET SOUTH #1110	BOSTON, MA, 02116	1 CHARLES STREET SOUTH 1110 Boston MA 02116
WILLIAM M STEUL FAMILY TRUST		1 CHARLES STREET SOUTH, Unit 3G	BOSTON, MA, 02116	1 CHARLES STREET SOUTH 3G Boston MA 02116
DAVIS CHARLES HOWARD II TS	C/O CHARLES DAVIS	300 BOYLSTON ST #611	BOSTON, MA, 02116	300 BOYLSTON ST 611 Boston MA 02116
TONG ARTHUR K		85 DARTMOUTH ST	NEWTON, MA, 02465	1 CHARLES STREET SOUTH 1001 Boston MA 02116
FITZGERALD JOHN F TS	C/O JOHN F FITZGERALD	116 FLANDERS RD	WESTBOROUGH, MA, 01581	1 CHARLES STREET SOUTH 15A Boston MA 02116
CURTIS CHRISTOPHER C TS	C/O DOROTHY A REMONDI	300 BOYLSTON ST #507	BOSTON, MA, 02116	300 BOYLSTON ST 507 Boston MA 02116
BRINNER FAMILY INVESTMENT LLC	C/O ROGER BRINNER	6885 NORTH OCEAN BLVD #205	OCEAN RIDGE, FL, 33435	220 BOYLSTON ST 1002 Boston MA 02116
RAJ SHREYA		1 CHARLES STREET SOUTH #601	BOSTON, MA, 02116	1 CHARLES STREET SOUTH 601 Boston MA 02116
21 PIEDMONT LLC		21 Piedmont ST, Unit 21	BOSTON, MA, 02116	17 25 PIEDMONT ST PS-4 Boston MA 02116

GWC REALTY LLC MASS LLC		1 NASSAU ST	BOSTON, MA, 02111	220 BOYLSTON ST 8012 Boston MA 02116
ABU-EID NASSER Z		432 GLEN ROAD	WESTON, MA, 02493	1 CHARLES STREET SOUTH 307 Boston MA 02116
CHIN COB TRUST		1 CHARLES STREET SOUTH, Unit 9-A	BOSTON, MA, 02116	1 CHARLES STREET SOUTH 9A Boston MA 02116
HENSON KRISTINA KARA	C/O KRISTINA K HENSON	1 CHARLES STREET SOUTH #708	BOSTON, MA, 02116	1 CHARLES STREET SOUTH 708 Boston MA 02116
BENDER SANDRA MARIE		22 SHAWMUT ST	BOSTON, MA, 02116	22 SHAWMUT ST Boston MA 02116
PEARLMAN DORIS M TS	C/O MARVIN GOLDENBERG TS	300 BOYLSTON ST #1106	BOSTON, MA, 02116	300 BOYLSTON ST 1106 Boston MA 02116
PARK PLAZA RETAIL LLC	C/O MILLENNIUM PARTNERS	1995 BROADWAY 3RD FL	NEW YORK, NY, 10023	1 CHARLES STREET SOUTH COMM C Boston MA 02116
RHF BOSTON LP MASS LP	C/O RINET CO LLC	101 FEDERAL ST 14TH FL	BOSTON, MA, 02110	300 BOYLSTON ST 810 Boston MA 02116
CRANEBRIDGE CAPITAL LLC	C/O CRANEBRIDGE LLC	31 ST JAMES STREET	BOSTON, MA, 02116	1 CHARLES STREET SOUTH 408 Boston MA 02116
ROBERT RITA		1 CHARLES STREET SOUTH #10A	BOSTON, MA, 02116	1 CHARLES STREET SOUTH 10A Boston MA 02116
MALHOTRA URVASHI PAUL		1 CHARLES STREET SOUTH #1010	BOSTON, MA, 02116	1 CHARLES STREET SOUTH 1010 Boston MA 02116
KINGETER MONICA M TS	C/O MONICA M KINGETER	1 CHARLES STREET SOUTH, Unit 1404	BOSTON, MA, 02116	1 CHARLES STREET SOUTH 1404 Boston MA 02116
HERITAGE GARDEN REAL ESTATE TRUST	C/O LUCIANO LAURETTI	300 BOYLSTON ST UNIT 501	BOSTON, MA, 02116	300 BOYLSTON ST 501 Boston MA 02116
BERGER MERLE J TS	C/O MERLE BERGER	220 BOYLSTON ST #1618	BOSTON, MA, 02116	220 BOYLSTON ST 1618 Boston MA 02116
PAI SARA I		220 BOYLSTON ST #1106	BOSTON, MA, 02116	220 BOYLSTON ST 1106 Boston MA 02116
390 COMMONWEALTH AVENUE LLC	C/O VIVEK NARENDRAN	11205 GRANDON RIDGE CIR	CINCINNATI, OH, 45249	1 CHARLES STREET SOUTH PH-205 Boston MA 02116
MILSTEIN RICHARD S		300 BOYLSTON ST #711	BOSTON, MA, 02116	300 BOYLSTON ST 711 Boston MA 02116
PHEONIX SERIES BOSTON LLC		282D NEWTON ST	BROOKLINE, MA, 02445	300 BOYLSTON ST 802 Boston MA 02116
BROWN DOUGLAS R		1200 GULF BLVD APT #2005	CLEARWATER, FL, 33767	1 CHARLES STREET SOUTH 402 Boston MA 02116
WEISMAN JONATHAN ASHER		300 BOYLSTON ST # 518	BOSTON, MA, 02116	300 BOYLSTON ST 518 Boston MA 02116
SAINI AJAY		1 CHARLES STREET SOUTH #3-D	BOSTON, MA, 02116	1 CHARLES STREET SOUTH 3D Boston MA 02116
NLH HOLDINGS LLC		81 BEACON ST	BOSTON, MA, 02108	1 CHARLES STREET SOUTH 610 Boston MA 02116
BLOOSTEIN MARC J TS	UNIT 906 HERITAGE ON THE GARDEN	276 HIGHLAND ST	NEWTON, MA, 02465	300 BOYLSTON ST 906 Boston MA 02116
FISHBEIN EVALYN LIPTON		1 CHARLES STREET SOUTH #506	BOSTON, MA, 02116	1 CHARLES STREET SOUTH 506 Boston MA 02116
HERITAGE GARDEN REALTY LLC	C/O DENNIS M DONOVAN	8787 BAY COLONY DR #801	NAPLES, FL, 34108	300 BOYLSTON ST 708 Boston MA 02116
WU JINGCHUN		1 CHARLES STREET SOUTH # 901	BOSTON, MA, 02116	1 CHARLES STREET SOUTH 901 Boston MA 02116
BELCHER DANIEL P		1 CHARLES ST #1505	BOSTON, MA, 02114	1 CHARLES STREET SOUTH 1505 Boston MA 02116
RATTIGAN JOHN JR TS	C/O ANTHONY PANGARO	1 CHARLES STREET SOUTH #16D	BOSTON, MA, 02116	1 CHARLES STREET SOUTH 16D Boston MA 02116
LUNDER PETER		TWO MONUMENT SQUARE SUITE 704	PORTLAND, ME, 04101	220 BOYLSTON ST 1017 Boston MA 02116
DRISCOLL DAVID J		1 CHARLES STREET SOUTH #8C	BOSTON, MA, 02116	1 CHARLES STREET SOUTH 8C Boston MA 02116
AHER MARK J		1 CHARLES STREET S #PH-102	BOSTON, MA, 02116	1 CHARLES STREET SOUTH PH-102 Boston MA 02116
HAMERMESH RICHARD TS	C/O RICHARD HAMERMESH	1 CHARLES STREET S #PH2-C	BOSTON, MA, 02116	1 CHARLES STREET SOUTH PH2-C Boston MA 02116
UNIT 1206 REALTY TRUST	C/O PHYLLIS C MEYER	300 BOYLSTON ST #1206	BOSTON, MA, 02116	300 BOYLSTON ST 1206 Boston MA 02116
CLAUDIA R SCHWARTZ TRUST	C/O ANTHONY SCHWARTZ	220 BOYLSTON ST #1118	BOSTON, MA, 02116	220 BOYLSTON ST 1118 Boston MA 02116
CHAMBERS HERBERT G		47 EASTERN BLVD	GLASTONBURY, CT, 06033	220 BOYLSTON ST 1209 Boston MA 02116
251 PIEDMONT LLC		25 PIEDMONT ST #1	BOSTON, MA, 02116	17 25 PIEDMONT ST PS-10 Boston MA 02116
250B1 LLC		85 BOSTON ST	EVERETT, MA, 02149	220 BOYLSTON ST 1612 Boston MA 02116
LANDRY KEVIN		250 BOYLSTON ST #6	BOSTON, MA, 02116	250 BOYLSTON ST 6 Boston MA 02116
HALL JANET TS	C/O HERITAGE 605 NOMINEE TR	PO BOX #540	PORTSMOUTH, NH, 03802	300 BOYLSTON ST 605 Boston MA 02116
CHARTOFF BRENDA R		1 CHARLES STREET SOUTH #304	BOSTON, MA, 02116	1 CHARLES STREET SOUTH 304 Boston MA 02116
CONNOLLY MARIANNE		1 CHARLES STREET SOUTH #1105	BOSTON, MA, 02116	1 CHARLES STREET SOUTH 1105 Boston MA 02116
KRANE DIANE TS	C/O DIANE KRANE TS	220 BOYLSTON ST #1512	BOSTON, MA, 02116	220 BOYLSTON ST 1512 Boston MA 02116
FLATTO GAIL		220 BOYLSTON ST #9012	BOSTON, MA, 02116	220 BOYLSTON ST 9012 Boston MA 02116
AL-SALEH ABDULLA		1 CHARLES STREET SOUTH #1604	BOSTON, MA, 02116	1 CHARLES STREET SOUTH 1604 Boston MA 02116
THOMAS J SWAN JR 1999	C/O CHOATE, HALL & STEWART	PO BOX 961989	BOSTON, MA, 02196	220 BOYLSTON ST 1215 Boston MA 02116

SHIELDS JOHN R	C/O JOHN SHIELDS	1 CHARLES STREET SOUTH #12-D	BOSTON, MA, 02116	1 CHARLES STREET SOUTH 12-D Boston MA 02116
NANCY J CAHN TRUST		23 PIEDMONT ST, Unit 23	BOSTON, MA, 02116	17 25 PIEDMONT ST PS-1 Boston MA 02116
MCGRATH JOANN TS	C/O DAVID MCGRATH	78 PORTER RD	ANDOVER, MA, 01810	300 BOYLSTON ST 1001 Boston MA 02116
TSAI ELIZABETH HON-YU		1 CHARLES STREET SOUTH #6A	BOSTON, MA, 02116	1 CHARLES STREET SOUTH 6A Boston MA 02116
CAROLYN O CARLSON TRUST	C/O CAROLYN CARLSON	220 BOYLSTON ST #9018	BOSTON, MA, 02116	220 BOYLSTON ST 9018 Boston MA 02116
SING MING CHAN REVOCABLE TRUST	SING MING CHAN	64 G STREET	SOUTH BOSTON, MA, 02127	51 53 CHURCH ST Boston MA 02116
FLAGG R EDWARD		38 PINE TREE DRIVE	BUZZARDS BAY, MA, 02532	1 CHARLES STREET SOUTH 809 Boston MA 02116
MCENCHROE REIT LLC	C/O CROWE	ONE WOOD LN	WINCHESTER, MA, 01890	220 BOYLSTON ST 1109 Boston MA 02116
HATFIELD JONATHAN C		24 Piedmont ST, Unit 24	BOSTON, MA, 02116	24 PIEDMONT ST 24 Boston MA 02116
EMMA PHIL		1 CHARLES STREET SOUTH, Unit 310	BOSTON, MA, 02116	1 CHARLES STREET SOUTH 310 Boston MA 02116
MOIN ROYA		1 CHARLES STREET SOUTH, Unit 12H	BOSTON, MA, 02116	1 CHARLES STREET SOUTH 12H Boston MA 02116
TOOMEY CONSTANCE M		1 CHARLES STREET SOUTH #705	BOSTON, MA, 02116	1 CHARLES STREET SOUTH 705 Boston MA 02116
MORRIS JOANNE M	C/O JOANNE MORRIS	1 CHARLES STREET SOUTH, Unit 1005	BOSTON, MA, 02116	1 CHARLES STREET SOUTH 1005 Boston MA 02116
FSH BOYLSTON INC	C/O ACCOUNTS PAYABLE	200 BOYLSTON ST	BOSTON, MA, 02116	CHARLES STREET SOUTH Boston MA 02116
WERNER THOMAS C		1880 CENTURY PARK EAST STE 1600	LOS ANGELES, CA, 90067	300 BOYLSTON ST 504 Boston MA 02116
300 BOYLSTON STREET #1103 REALTY TRUST		300 Boylston ST, Unit 1103	BOSTON, MA, 02116	300 BOYLSTON ST 1103 Boston MA 02116
ONE CHARLES CONDOMINIUM		1 CHARLES STR SOUTH	BOSTON, MA, 02116	1 CHARLES STREET SOUTH Boston MA 02116
TURNER ALVIN N		1 CHARLES STREET SOUTH #604	BOSTON, MA, 02116	1 CHARLES STREET SOUTH 604 Boston MA 02116
TITUS ETHAN		1 CHARLES STREET SOUTH #5H	BOSTON, MA, 02116	1 CHARLES STREET SOUTH 5H Boston MA 02116
HERBERT P GRAY 2001 TRUST		300 BOYLSTON ST #510	BOSTON, MA, 02116	300 BOYLSTON ST 510 Boston MA 02116
HASEOTES GEORGE P	C/O POLYXENI T HASEOTES	220 Boylston ST, Unit 1102	BOSTON, MA, 02116	220 BOYLSTON ST 1102 Boston MA 02116
TJRE INVESTMENTS LLC		398 COLUMBUS AVE #345	BOSTON, MA, 02116	67 CHURCH ST Boston MA 02116
GUGV II 212 STUART PROPERTY OWNING L ONE FEDERAL ST, SUITE 1804		C/O GREYSTAR REAL ESTATE PARTNERS	BOSTON, MA, 02110	212 222 STUART ST Boston MA 02116
RABOY S CAESAR		220 Boylston ST, Unit 8018	BOSTON, MA, 02116	220 BOYLSTON ST 8018 Boston MA 02116
HAWKINS DAVID		1 CHARLES ST UNIT 14H	BOSTON, MA, 02116	1 CHARLES STREET SOUTH 14H Boston MA 02116
LAPMAN MARK		1 CHARLES STREET SOUTH #PH202	BOSTON, MA, 02116	1 CHARLES STREET SOUTH PH-202 Boston MA 02116
NOTKIN BRETT		1 CHARLES STREET SOUTH #405	BOSTON, MA, 02116	1 CHARLES STREET SOUTH 405 Boston MA 02116
HOROVITZ BRACHA		1 CHARLES STREET SOUTH, Unit 412	BOSTON, MA, 02116	1 CHARLES STREET SOUTH 412 Boston MA 02116
RUSSELL DAVID		1 CHARLES STREET SOUTH #7E	BOSTON, MA, 02116	1 CHARLES STREET SOUTH 7E Boston MA 02116
THEATRE DISTRICT LLC	C/O WILDER COMPANIES LTD	800 BOYLSTON ST SUITE #1300	BOSTON, MA, 02199	133 135 STUART ST Boston MA 02116
FOUR SEASONS PLACE		220 BOYLSTON ST	BOSTON, MA, 02116	220 200 BOYLSTON ST Boston MA 02116
CITY OF BOSTON		STUART	BOSTON, MA, 02116	STUART ST Boston MA 02116
NILOFF JONATHAN M		1 CHARLES STREET SOUTH #10E	BOSTON, MA, 02116	1 CHARLES STREET SOUTH 10E Boston MA 02116
BROWN DOUGLAS R		1200 GULF BLVD APT #2005	CLEARWATER, FL, 33767	1 CHARLES STREET SOUTH 1407 Boston MA 02116
BFO LLC MASS LLC		300 BOYLSTON ST #714	BOSTON, MA, 02116	300 BOYLSTON ST 714 Boston MA 02116