



*Improvements to*  
MARY HANNON  
PLAYGROUND



# AGENDA

---

1

**PROJECT TEAM INTRODUCTION**

---

2

**PROJECT OVERVIEW**

---

3

**PRESENTATION**

---

4

**LISTENING & DISCUSSION**

---

5

**CLOSING REMARKS & NEXT STEPS**

---

# PROJECT TEAM

---

## **Nathan Frazee**

Project Manager

[Nathan.frazee@boston.gov](mailto:Nathan.frazee@boston.gov) or 617-961-3167

## **Marchelle Jacques-Yarde**

Outreach Coordinator, External Affairs

[marchelle.jacques-yarde@boston.gov](mailto:marchelle.jacques-yarde@boston.gov) or 617-961-3006

## **Jef Fasser**

Director of Planning + Landscape Architecture, BSC Group

## **Monique Hall**

Landscape Architect, BSC Group

## **Alexandra Echandi**

Ecological Scientist, BSC Group

## **Nancy Goodin**

Landscape Designer, BSC Group

## **Flavio Daveiga**

Office of Neighborhood Services

[Flavio.Daveiga@boston.gov](mailto:Flavio.Daveiga@boston.gov) or 617-635-1880





Stage

Playground

Softball

Basketball

# PROJECT SCHEDULE & FUNDING

---

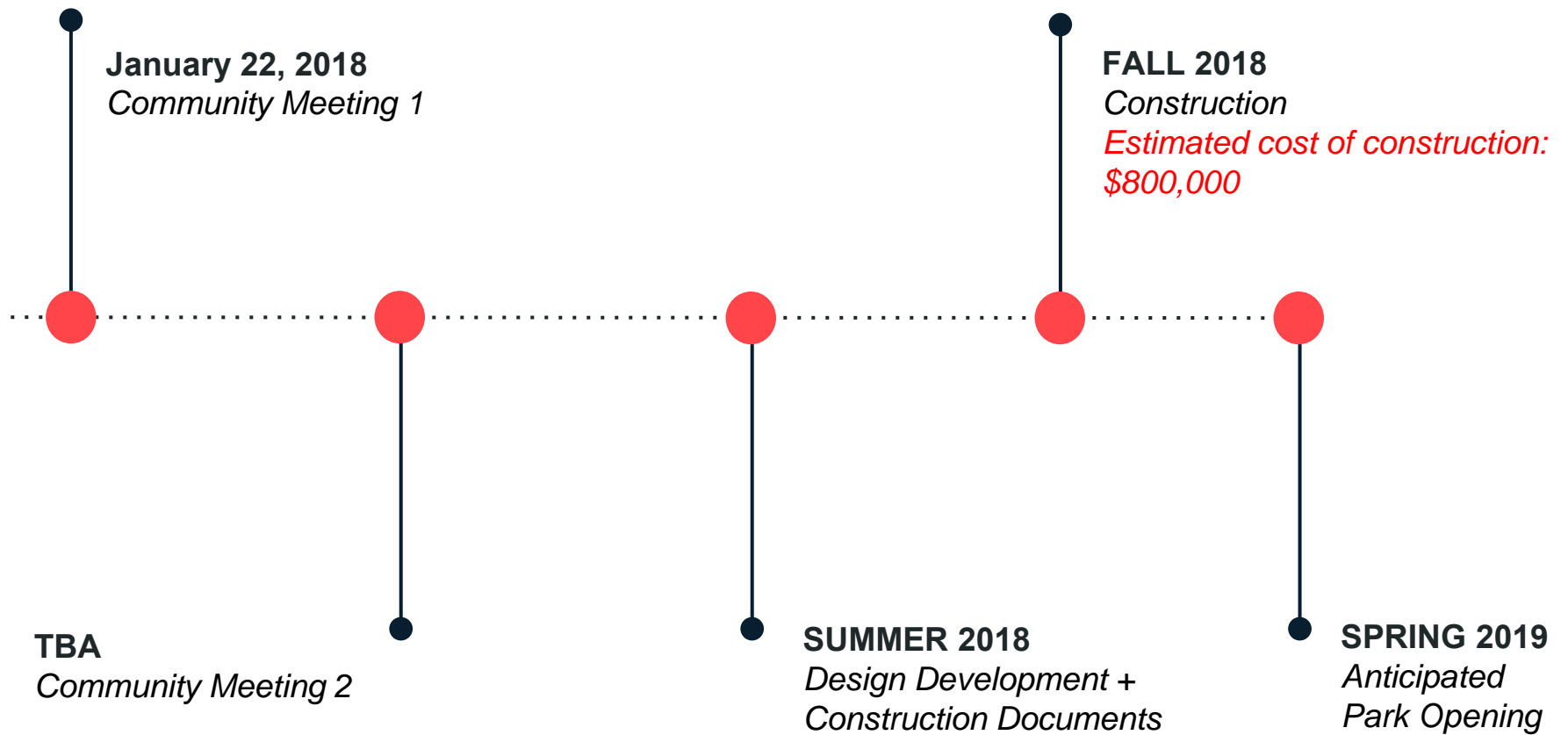





# CITY OF BOSTON INITIATIVES

---

- **Inclusion**
- **Shade**
- **Access to Parks**
- **Drinking / Bottle Filling Stations**
- **Water Play**
- **Climate Resiliency**





# PARK & RECREATION GOALS

---

- **Preserve and protect existing trees**
- **Expand usable park area**
- **Improve universal access**
- **Enhance park visibility**
- **Improve access to parks**
- **Design flexible, multi-functional park spaces**





# PARK TIMELINE

---

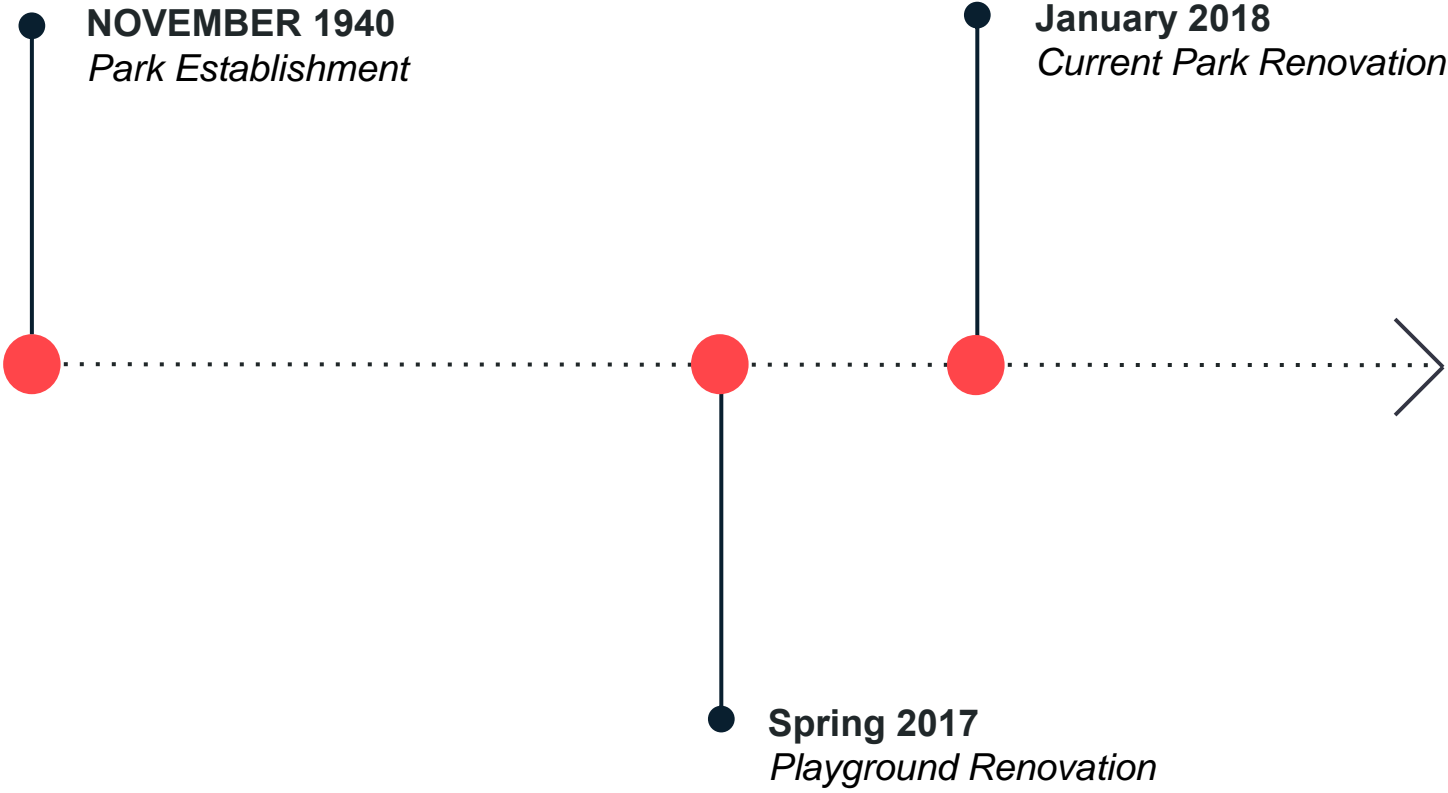

# SITE ANALYSIS



# PROXIMITY TO OTHER BALLFIELDS







# SITE ANALYSIS - EXISTING CONDITIONS





# SITE ANALYSIS - EXISTING CONDITIONS







# SITE ANALYSIS - EXISTING CONDITIONS







join your neighbors and their families & friends  
**kicking it in the park**  
all ages welcome  
informal kickball games



Sundays @ about 11a  
until about 2p

Mary Hannon Park  
Dudley Street

great fun  
great conversations  
like "back in the days"



parents encouraged to play



## SITE ANALYSIS - EXISTING USES





# SITE ANALYSIS - EXISTING USES







# SITE ANALYSIS - EXISTING USES







## SITE ANALYSIS - EXISTING USES



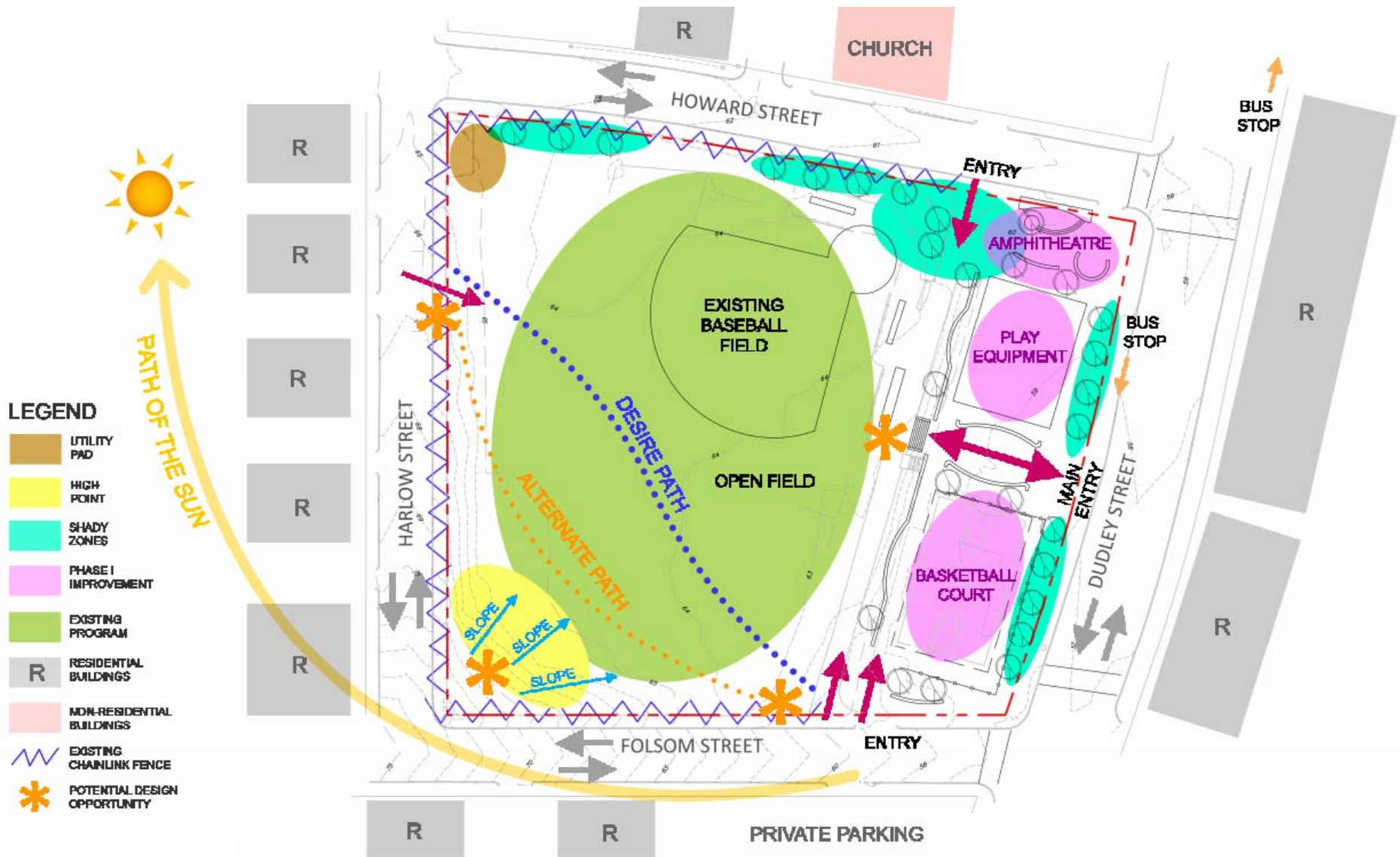

**LEGEND**

- UTILITY PAD
- HIGH POINT
- SHADY ZONES
- PHASE I IMPROVEMENT
- EXISTING PROGRAM
- RESIDENTIAL BUILDINGS
- NON-RESIDENTIAL BUILDINGS
- EXISTING CHAINLINK FENCE
- POTENTIAL DESIGN OPPORTUNITY

**SITE ANALYSIS**



**INSPIRATION**





INSPIRATION – REFINISH EXISTING SOFTBALL FIELD







INSPIRATION – COMMON LAWN WITH PATHS







INSPIRATION – COMMON LAWN WITH PATHS







INSPIRATION – COMMON LAWN FOR SPORTS





INSPIRATION – TELL US WHAT YOU THINK !!!





# LISTENING & DISCUSSION

Help us build great parks.  
Let us know what matters to you.





THANK YOU!

Next Meeting April 25, 2017  
BYCF Pino at 6:30pm

Nathan Frazee, Project Manager  
nathan.frazee@boston.gov or 617-961-3167

Marchelle Jacques-Yarde, Outreach Coordinator, External Affairs  
marchelle.jacques-yarde@boston.gov or 617-961-3006

Flavio Daveiga, Office of Neighborhood Services  
Flavio.daveiga@boston.gov or 617-635-1880

For questions, maintenance requests or concerns  
regarding any of our parks contact 311



January 22, 2018  
Boston Parks and Recreation

