



Improvements to
**JAMAICA
POND
PATHWAYS
AND ENTRIES**



AGENDA

1

PROJECT TEAM

2

PROJECT STATUS/RECAP

3

PRESENTATION OF RECOMMENDATIONS

4

LISTENING AND DISCUSSION

5

CLOSING REMARKS & NEXT STEPS

PROJECT TEAM

Lauren Bryant

Project Manager

lauren.bryant@boston.gov or 617-961-3019

Margaret Dyson

Director of Historic Parks

margaret.dyson@boston.gov or 617-961-3028

Marchelle Jacques-Yarde

Outreach Coordinator, External Affairs

marchelle.jacques-yarde@boston.gov or 617-961-3006

Kyle Zick

Principal, Kyle Zick Landscape Architecture, Inc.

Brian Kuchar

Senior Landscape Architect and Engineer, Horsley Witten Group

Alexandra Valdez

Office of Neighborhood Services

alexandra.valdez@boston.gov or 617-635-2185





JAMAICA POND PATHWAYS SCOPE OF WORK

- **Rehabilitate pathways and entrances**
- **Improve pathway accessibility**
- **Connections to buildings, stairs and dock**
- **Site furnishings**
- **Signage**
- **Landscape rehabilitation**



PROJECT OVERVIEW

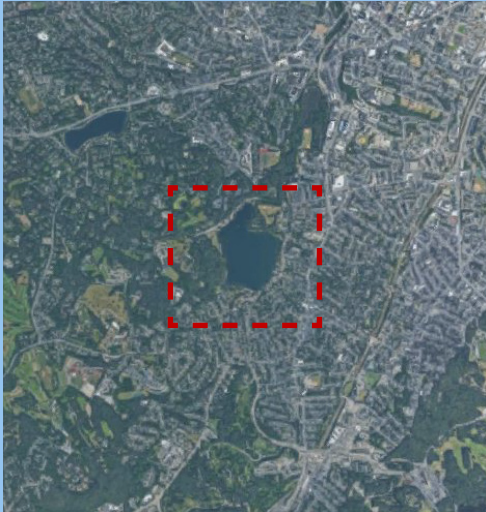

SURROUNDINGS



HISTORIC LANDSCAPE

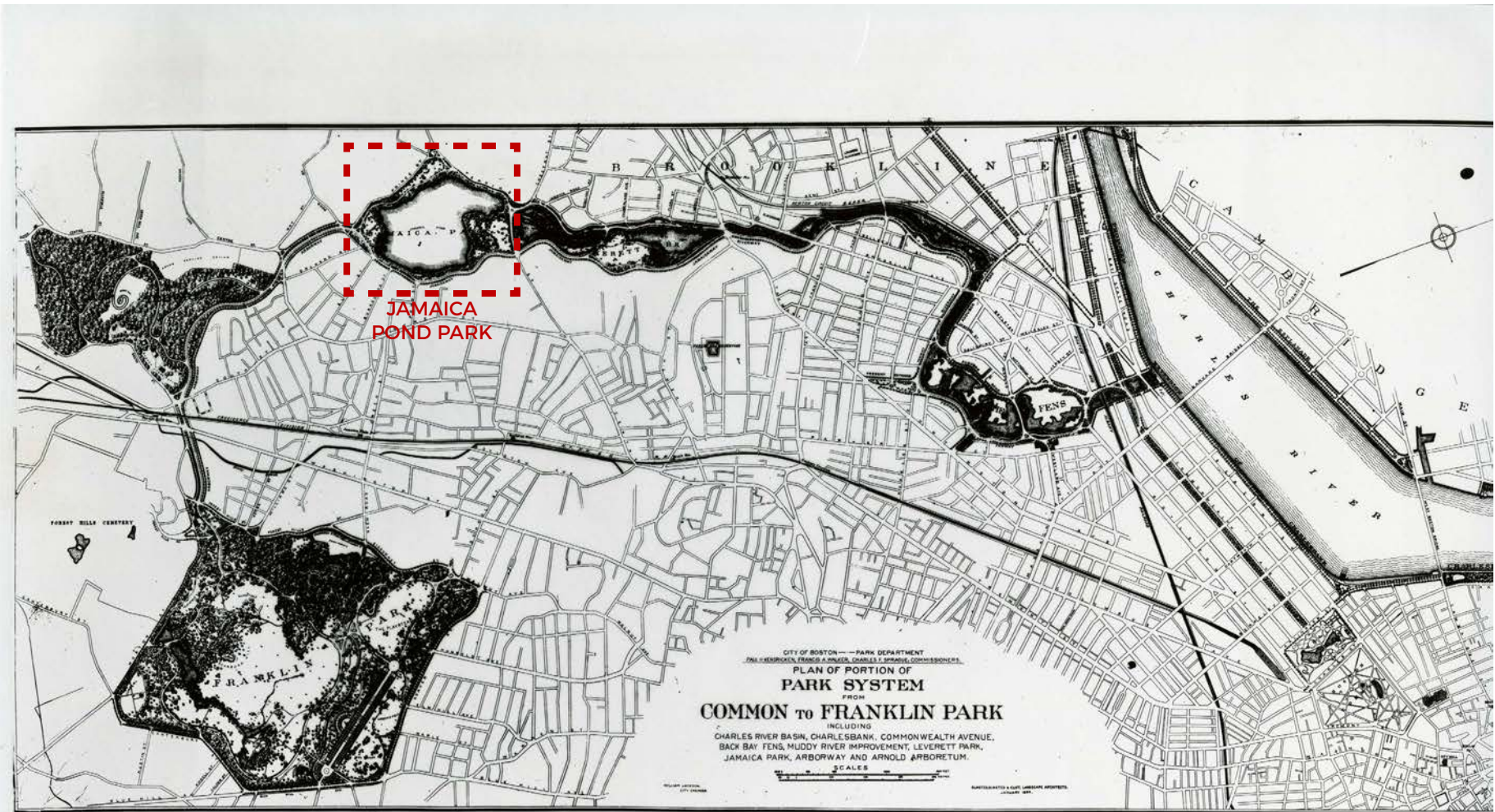

PROJECT SCHEDULE - PHASING



PROJECT SCHEDULE - TIMELINE

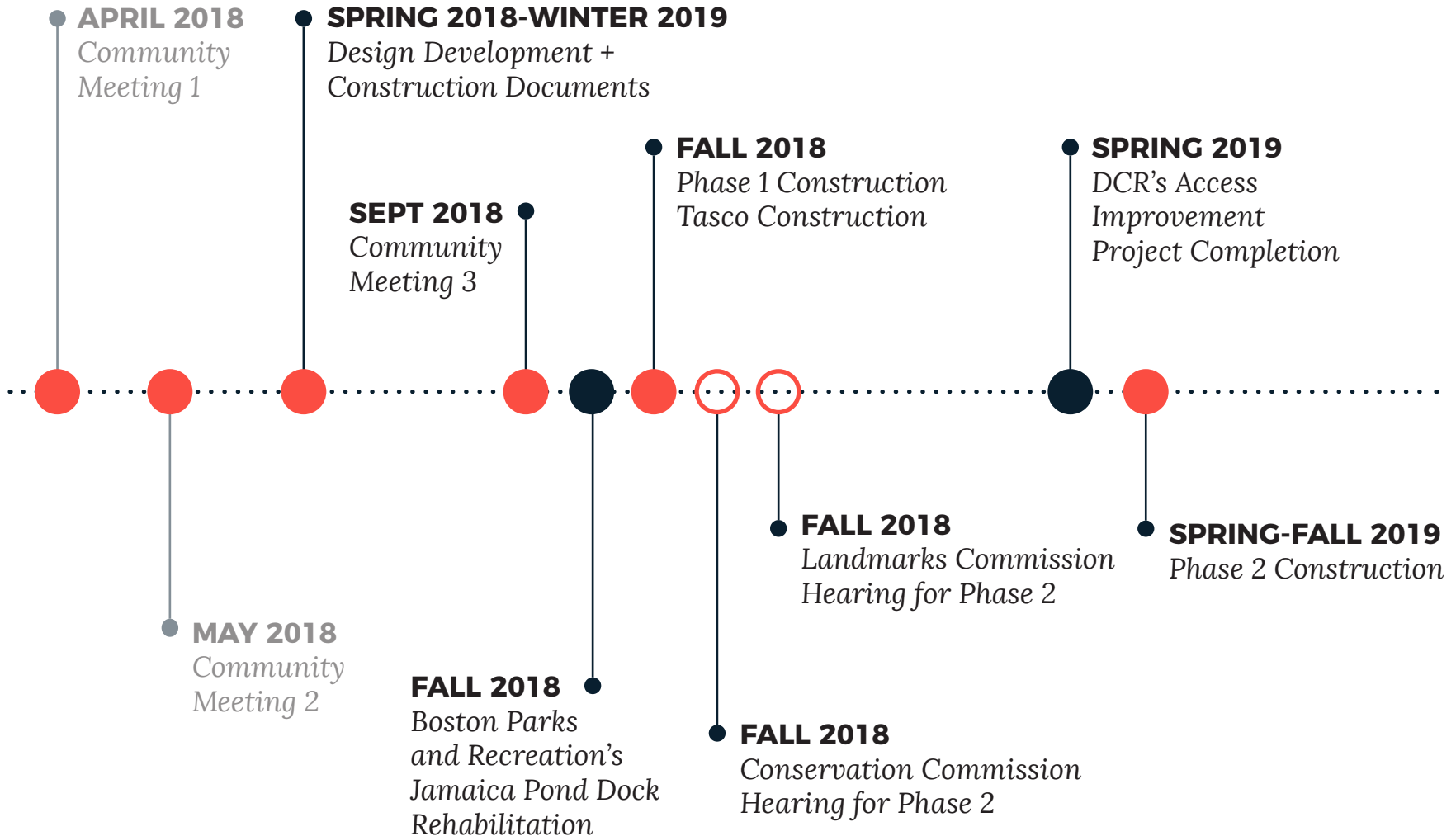

PHASE 1 - UPDATE

Since May 2018 (Community Meeting #2), we have:

- **Completed site design**
- **Gone through permitting**
- **Bid out the site work - repaving, tree planting, stormwater improvements, signage, and site entrances**
- **Moved all stair-related work into Phase 2**

Now, we are:

- **In the contract process**
- **Anticipating construction will start in October**

Phase 1 has a contracted cost of \$478,000, out of the total construction budget of \$4,060,000.

PHASE 2 - SCOPE

PHASE 2 will address:

- **Rehabilitation of pathways and entrances**
 - + Improving pathway accessibility and accessibility to buildings
 - + Potential resurfacing of the bike path
- **Stormwater Improvements**
 - + Erosion and stormwater issues on the perimeter path
- **Related Site Improvements**
 - + Updating and unifying site benches
 - + Adding other site furnishings such as water fountains and bike racks
 - + Signage, consistent with choices made in Phase 1, and with the Emerald Necklace
 - + Landscape rehabilitation and protection along perimeter path and on the hillside around Pinebank
 - + Companion spaces at benches, accessible fishing area, and accessible drinking water fountains

PATHS & STORMWATER - EXISTING



WORN TRAIL; EROSION



PUDDLING



EROSION

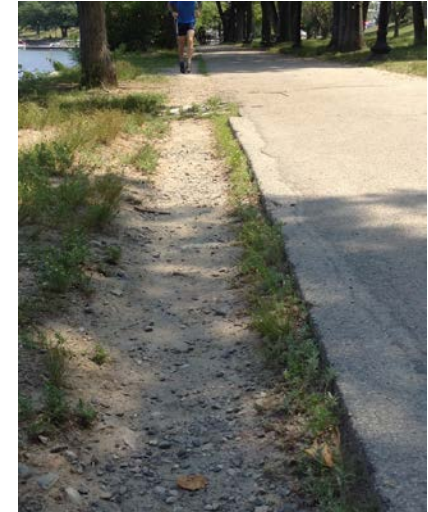

WORN TRAIL



DAMAGED EDGES; EROSION



WORN TRAIL; EROSION

EXISTING CONCERNS

PATHS & STORMWATER - EXISTING



----- Informal "running paths"

PATHS & STORMWATER - PROPOSED



 Parallel Paths - 4100 linear feet

 Shared Path - 3100 linear feet

PATHS & STORMWATER - PROPOSED

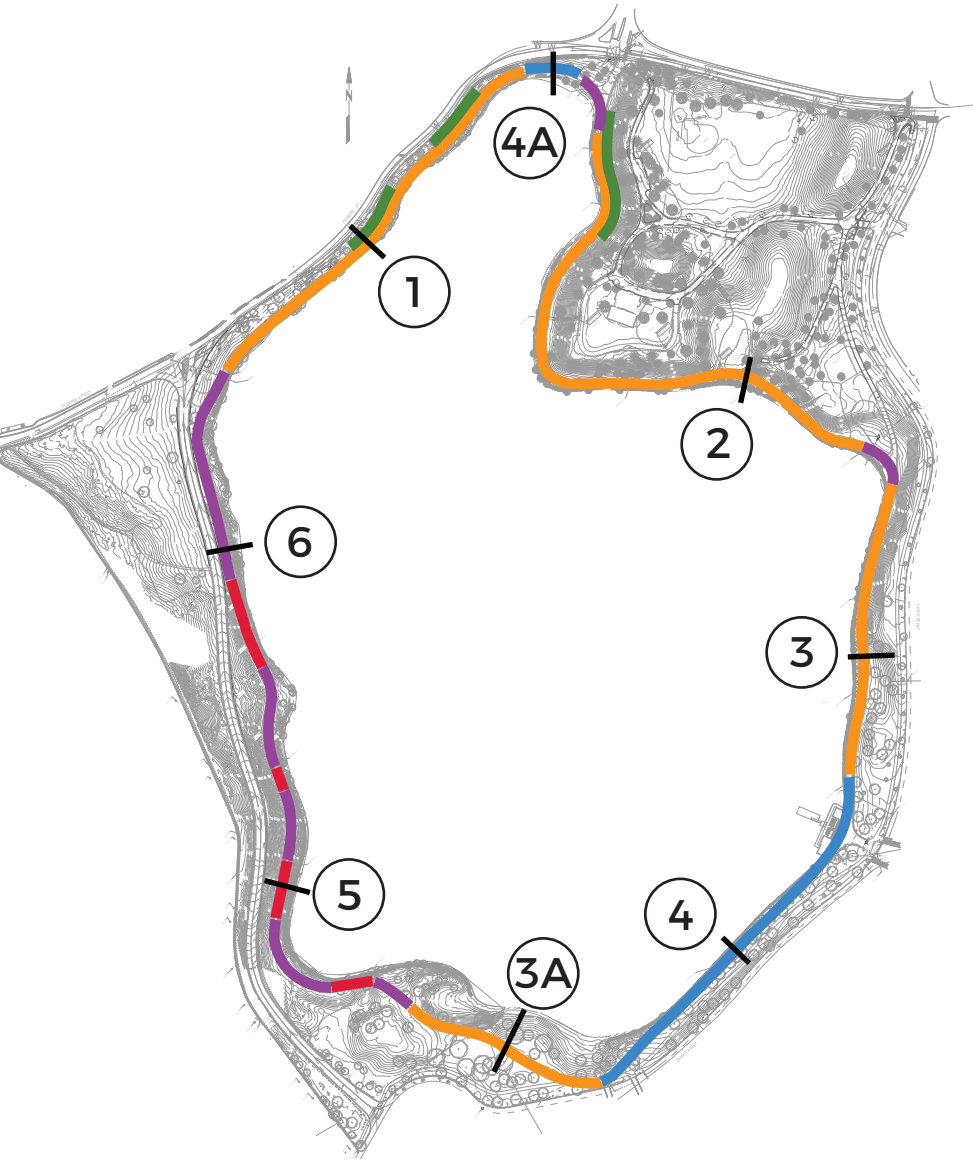

Parallel Path:

 Pondsides Running Berm, Sediment Trap in cobble swales

 Grass Swale on uphill side of path

Shared Path:

 Slope path to existing cobble swales or catch basins

 Vegetated Buffer at timber walls; No room for parallel running path

 Pondsides Curb to direct flows to existing cobble swales or catch basins and protect slopes

 Section Cut number

PATHS & STORMWATER - PARALLEL PATH



EXISTING CONDITION

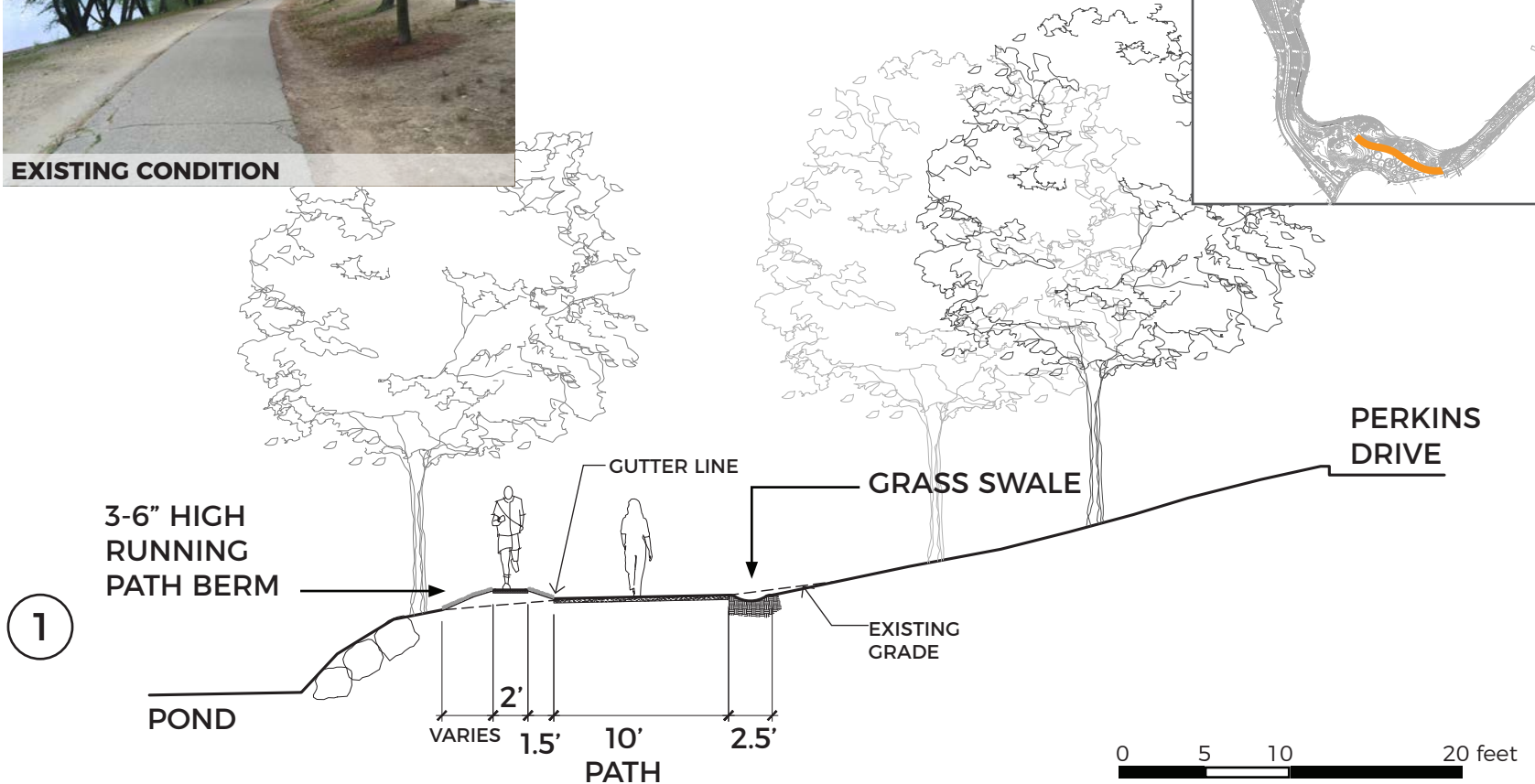

CONCEPT: PONDSIDE BERM



CONCEPT: SWALE



PATHS & STORMWATER - PARALLEL PATH

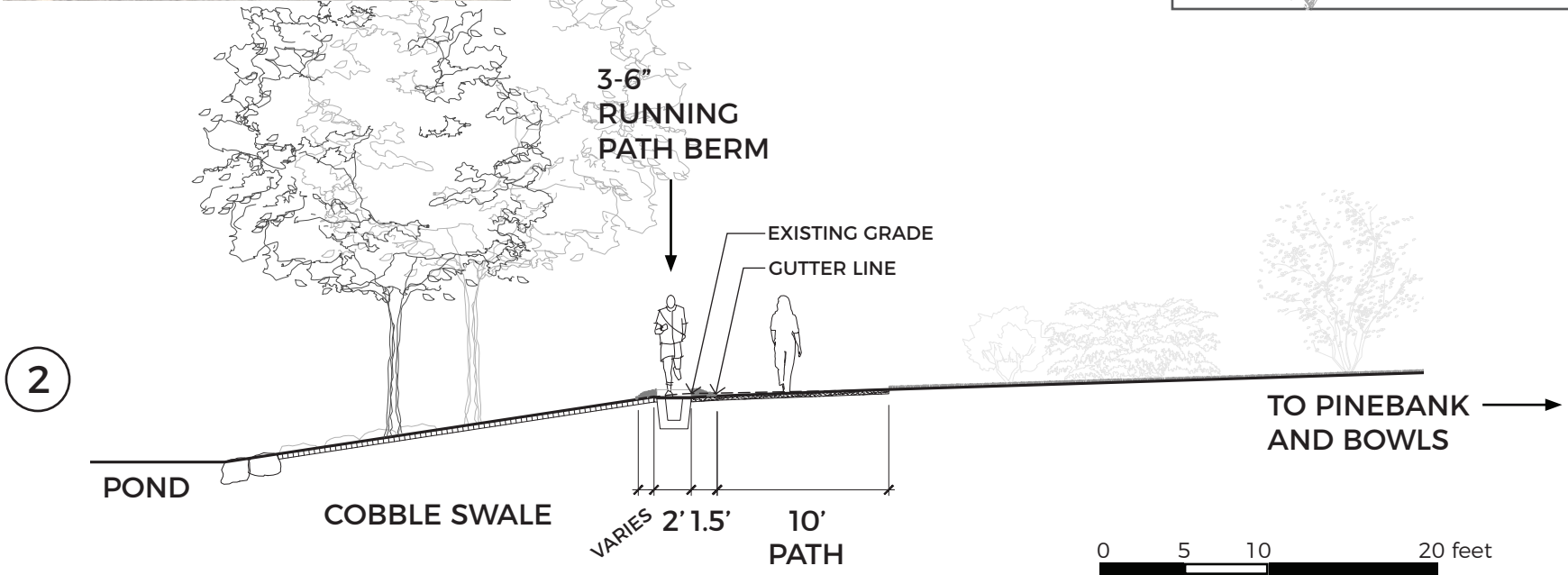

CONCEPT: PONDSIDE BERM, SEDIMENT TRAP IN COBBLE SWALE

PATHS & STORMWATER - PARALLEL PATH



EXISTING CONDITION

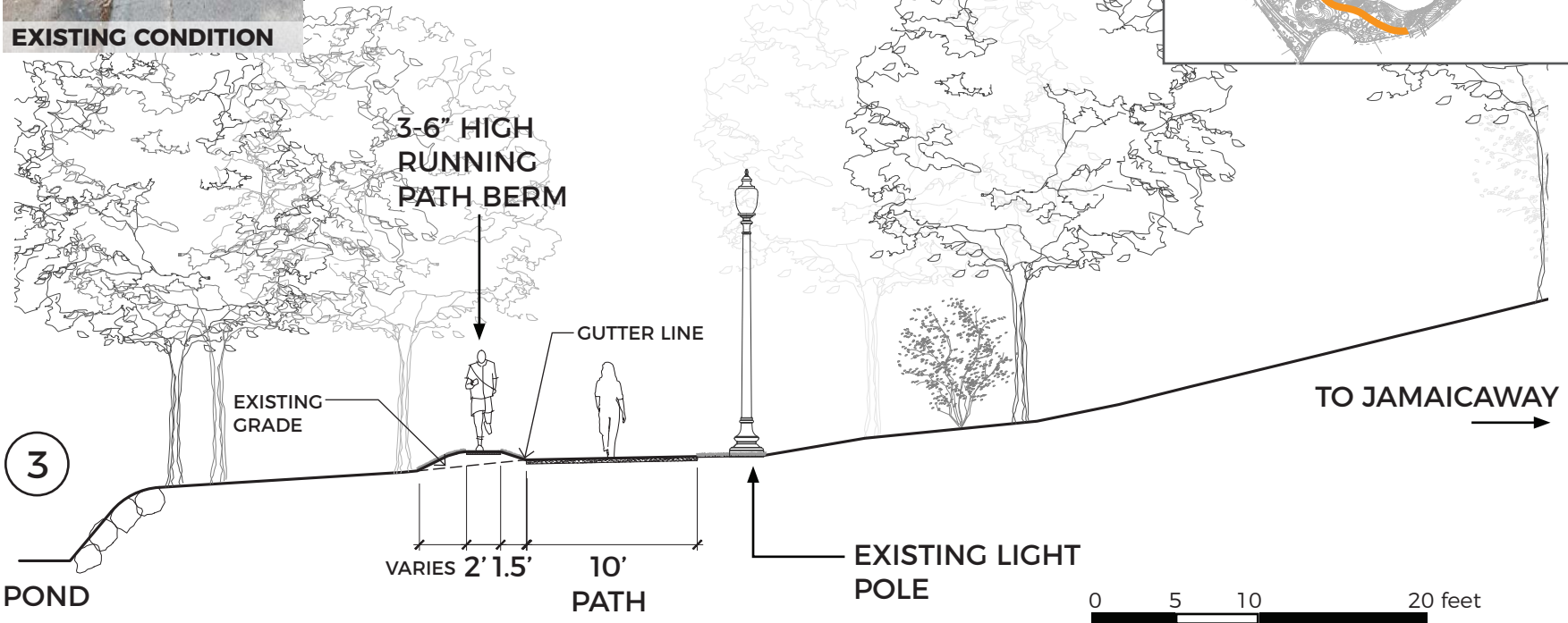

CONCEPT: PONDSIDE BERM

PATHS & STORMWATER - PARALLEL PATH



EXISTING CONDITION

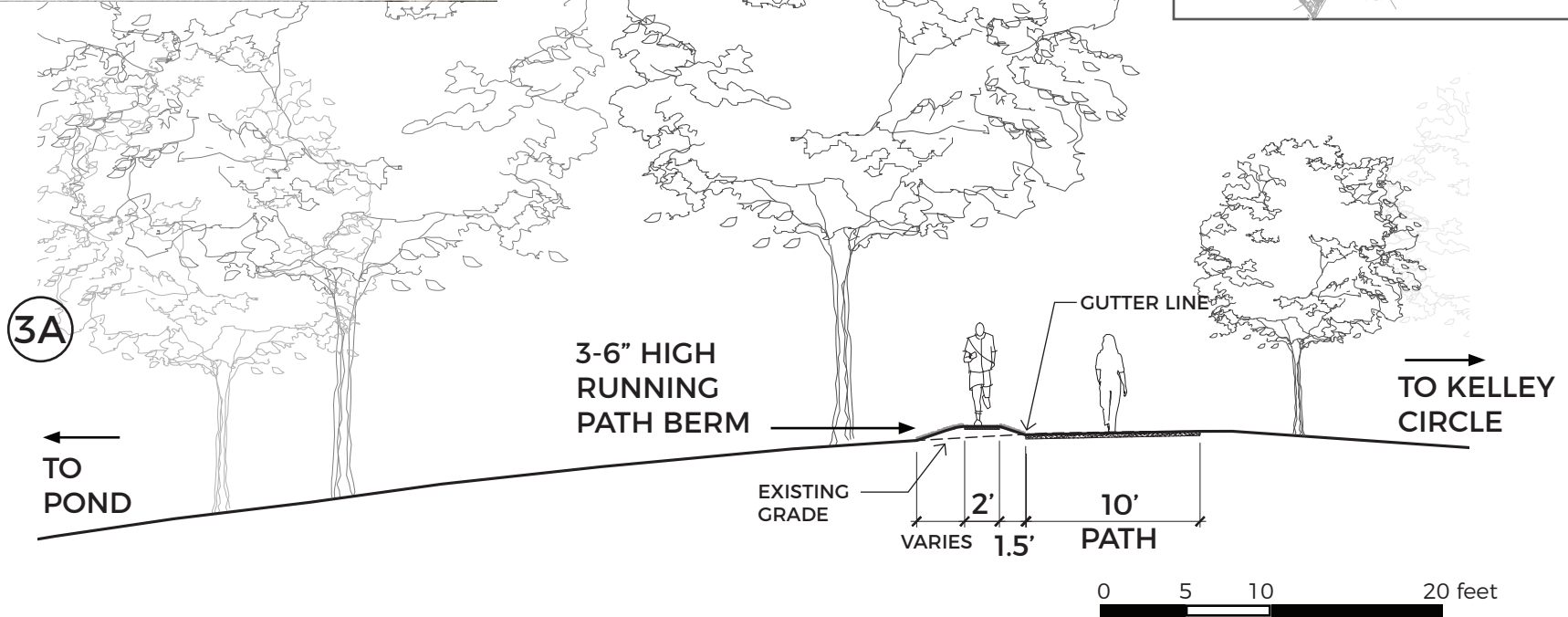

CONCEPT: PONDSIDE BERM

PATHS & STORMWATER - SHARED PATH

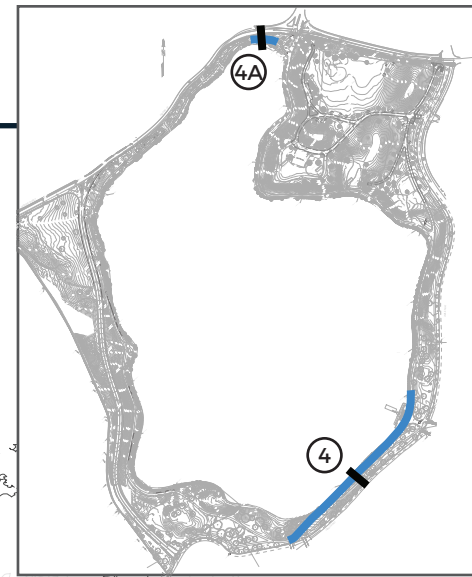

4A

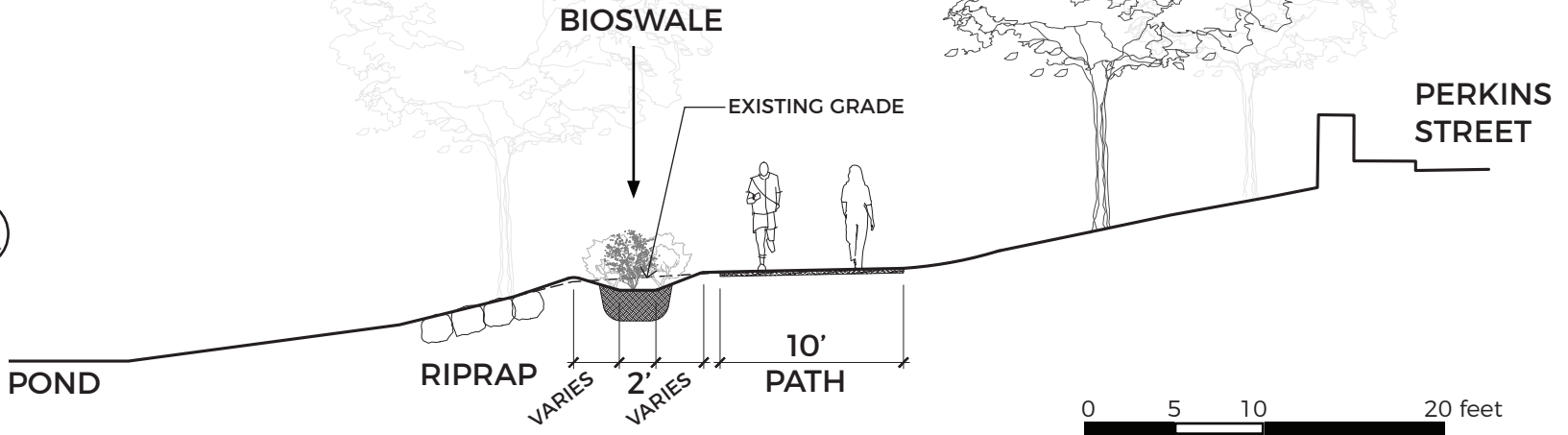

CONCEPT: BIOSWALE NEXT TO SHARED PATH

PATHS & STORMWATER - SHARED PATH

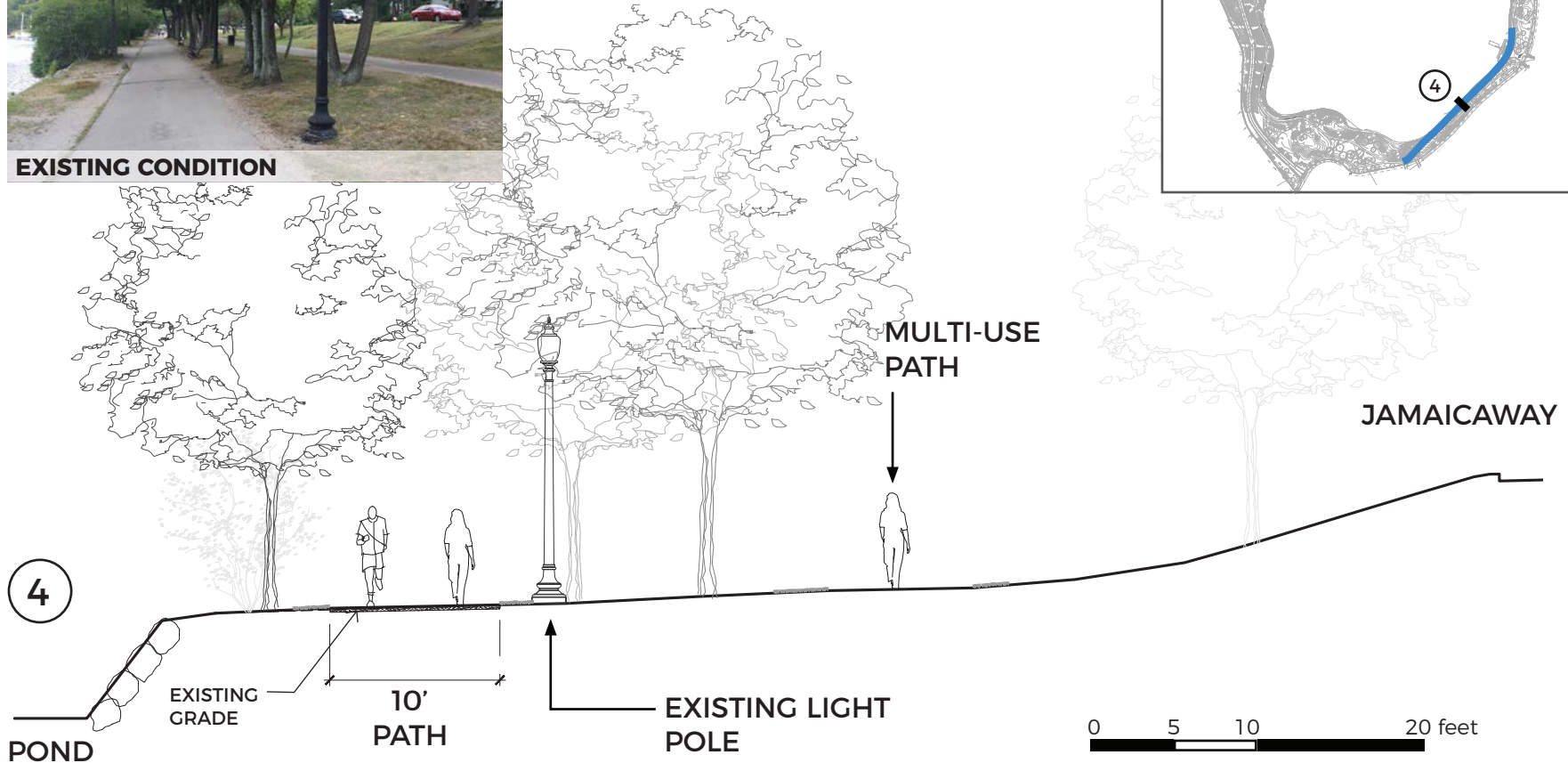
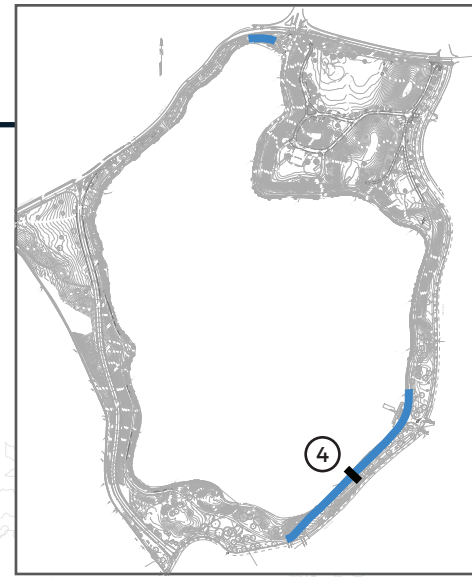

CONCEPT: SLOPE TO EXISTING STORMWATER ELEMENTS

PATHS & STORMWATER - SHARED PATH

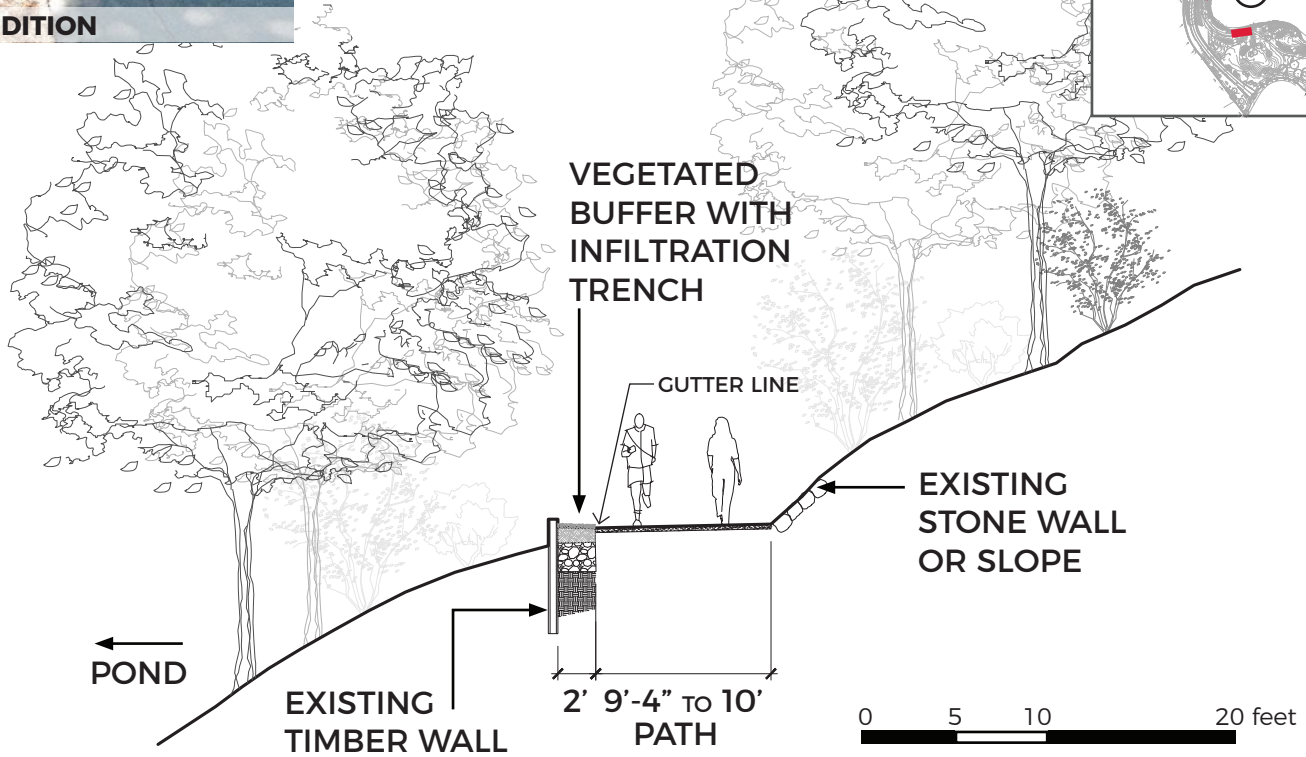
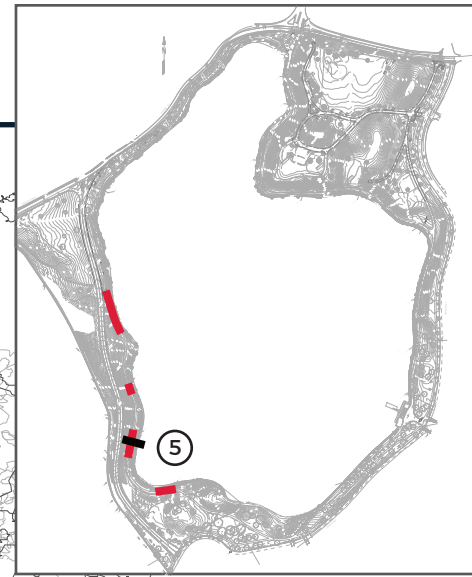

CONCEPT: AT TIMBER WALLS ALONG FRANCIS PARKMAN DRIVE

PATHS & STORMWATER - SHARED PATH

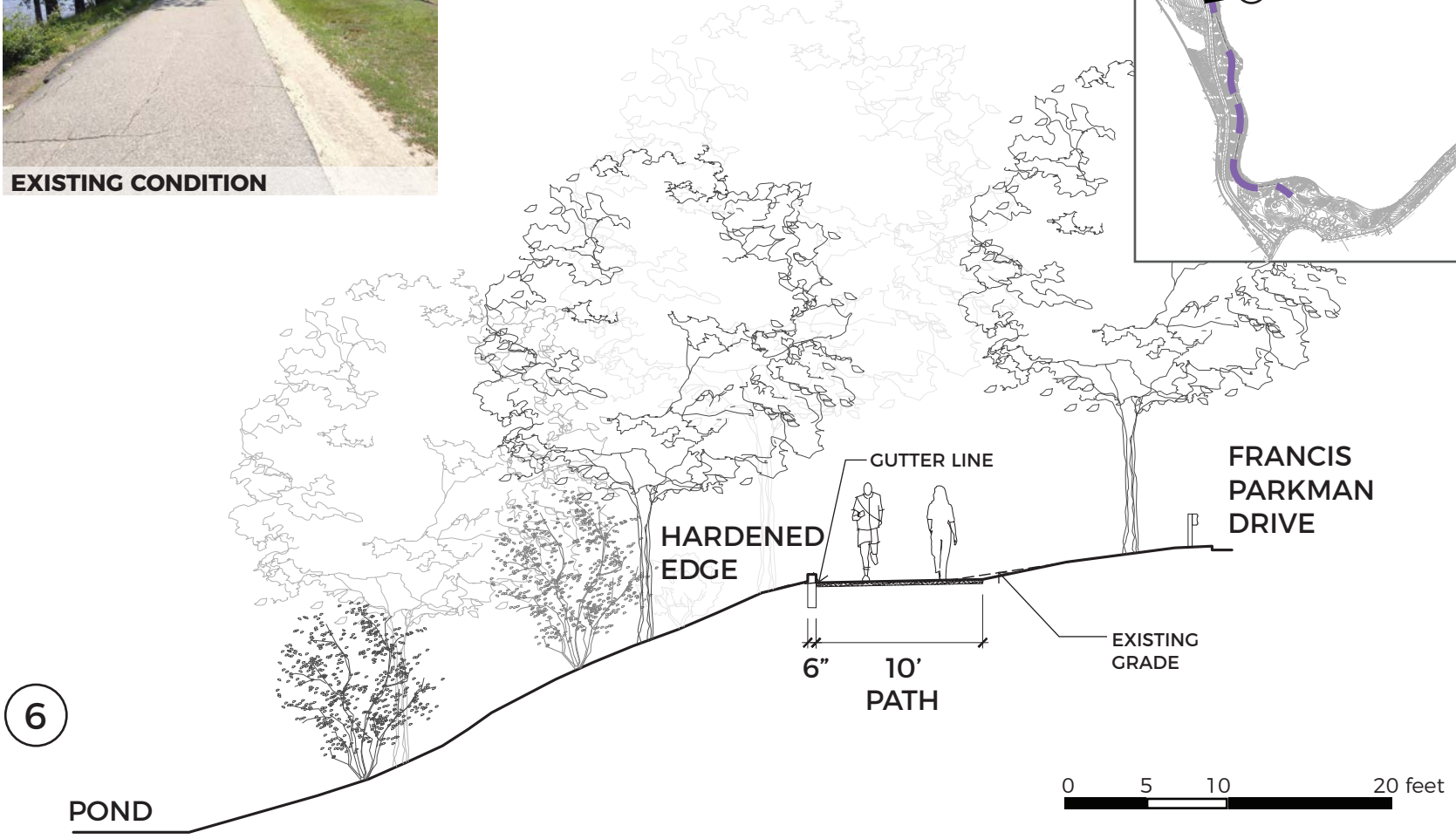
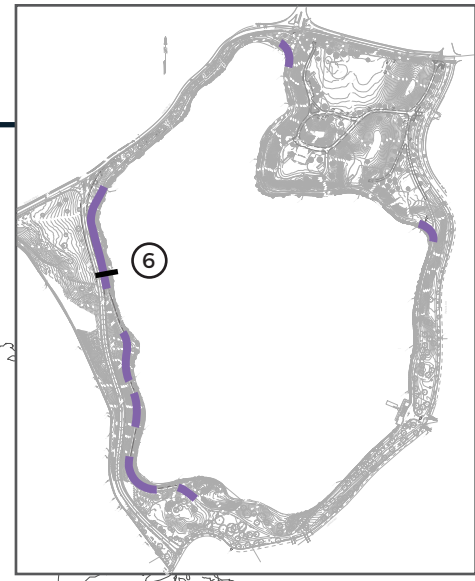

CONCEPT: ADDITION OF PONDSIDE EDGE

PATHS & STORMWATER - INFORMAL CONNECTIONS



Can formalize connections, if paths can be made compliant

PARK ENTRANCES



PARK ENTRANCES - PHASE 2



POND STREET & THE BOATHOUSE PROPOSED DESIGN

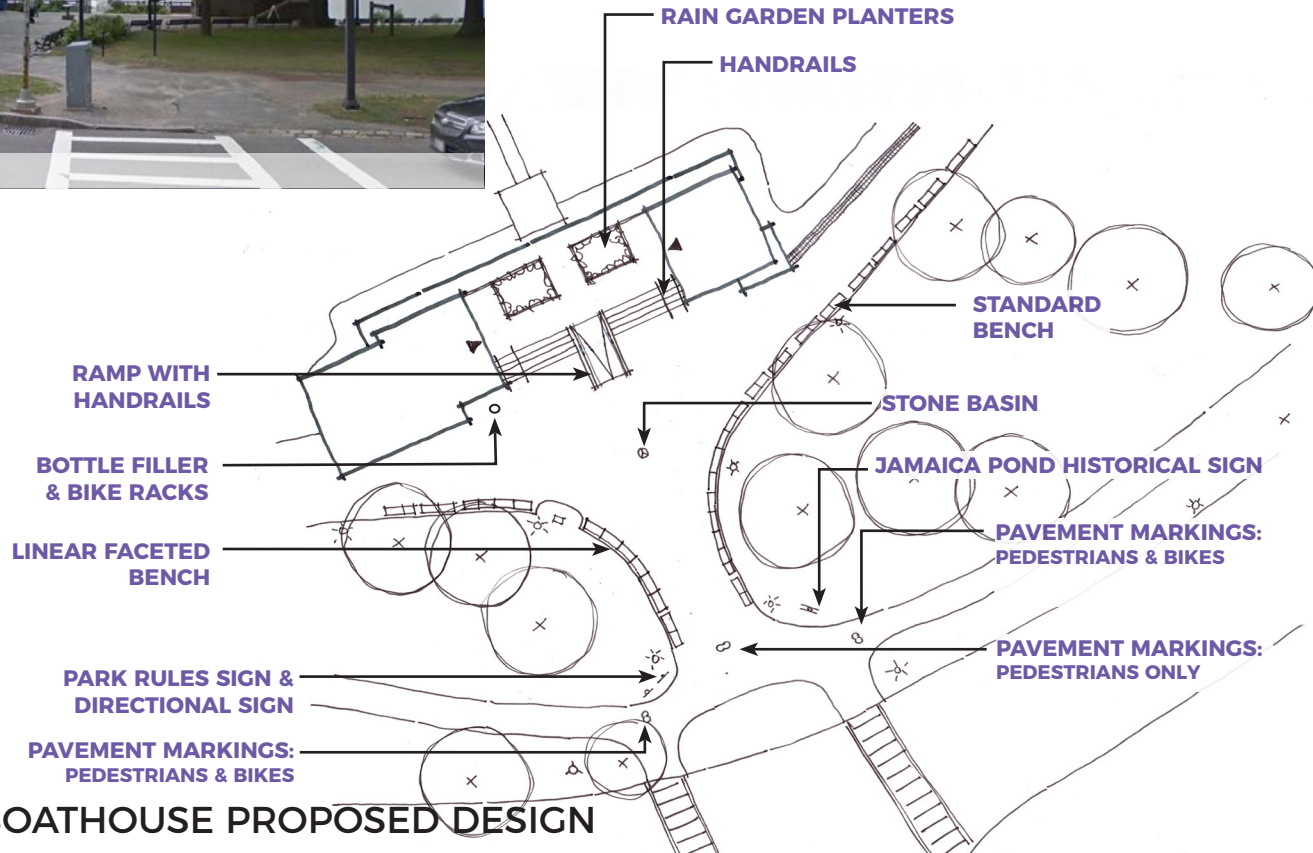

PARK ENTRANCES - PHASE 2

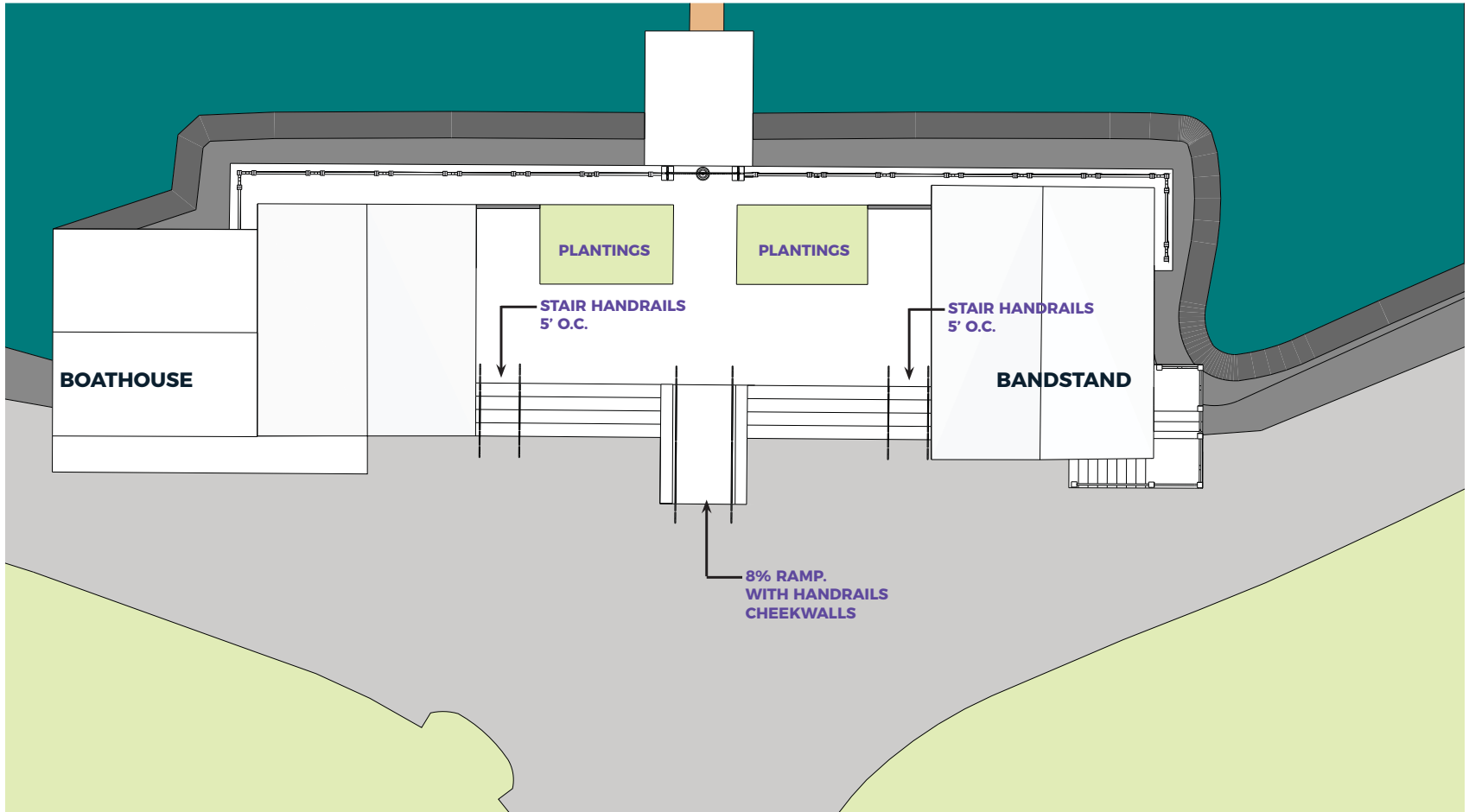

BOATHOUSE AREA PROPOSED DESIGN - PLAN VIEW

PARK ENTRANCES - PHASE 2

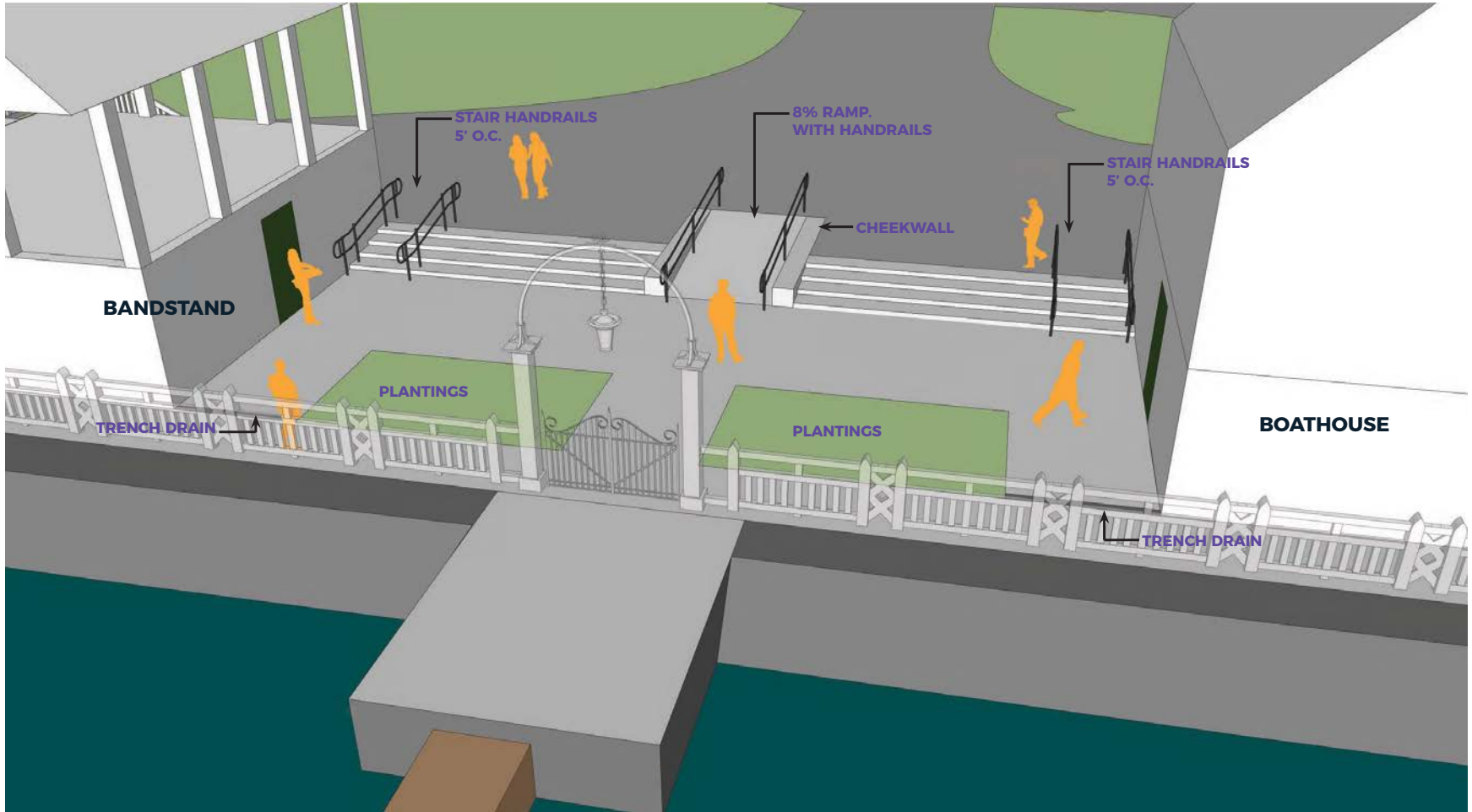

BOATHOUSE AREA PROPOSED DESIGN - BIRD'S EYE VIEW

PARK ENTRANCES - PHASE 2

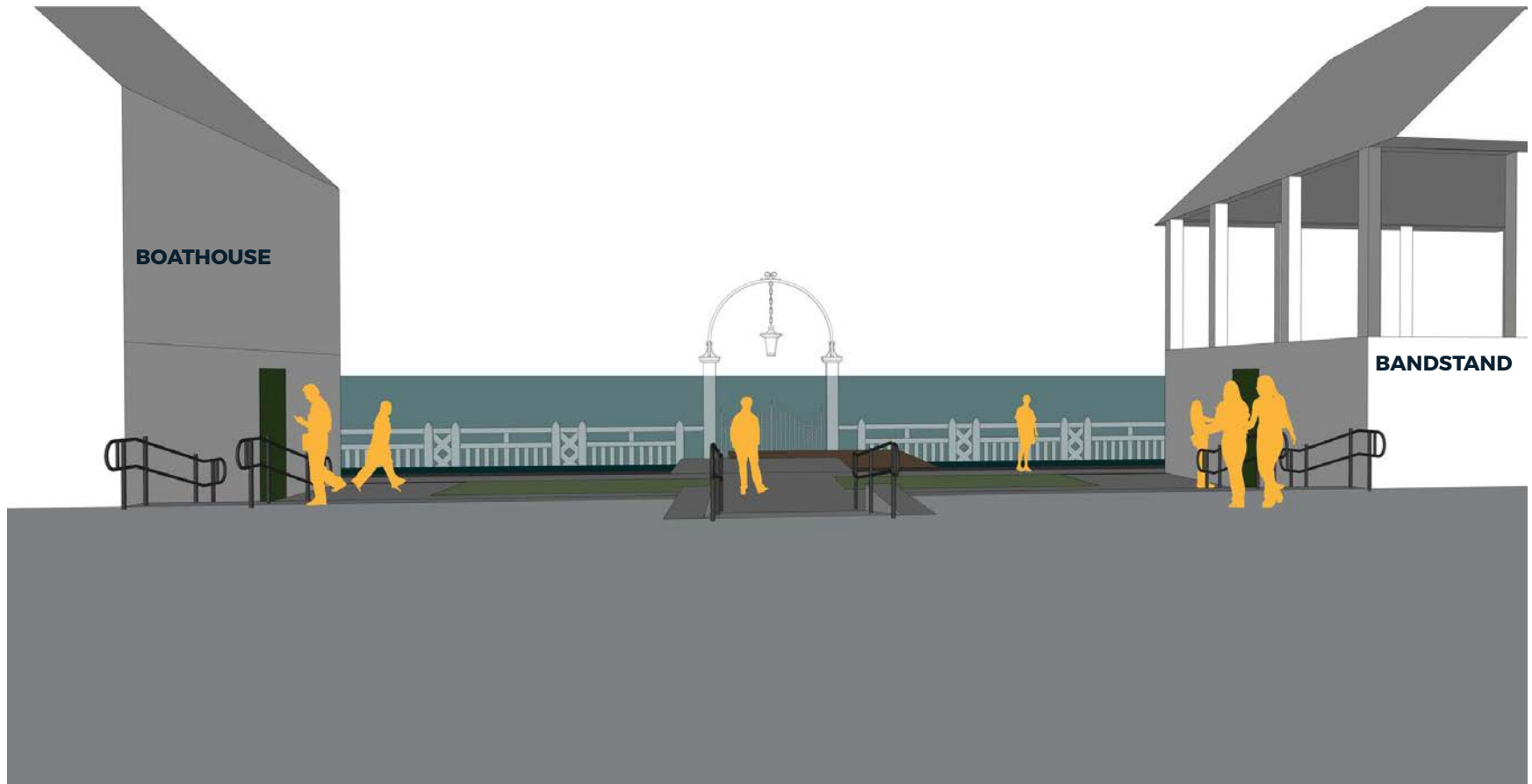

BOATHOUSE AREA PROPOSED DESIGN - APPROACHING FROM POND STREET

PARK ENTRANCES - PHASE 2



BOATHOUSE AREA PROPOSED DESIGN - APPROACHING FROM THE SOUTH

PARK ENTRANCES - PHASE 2

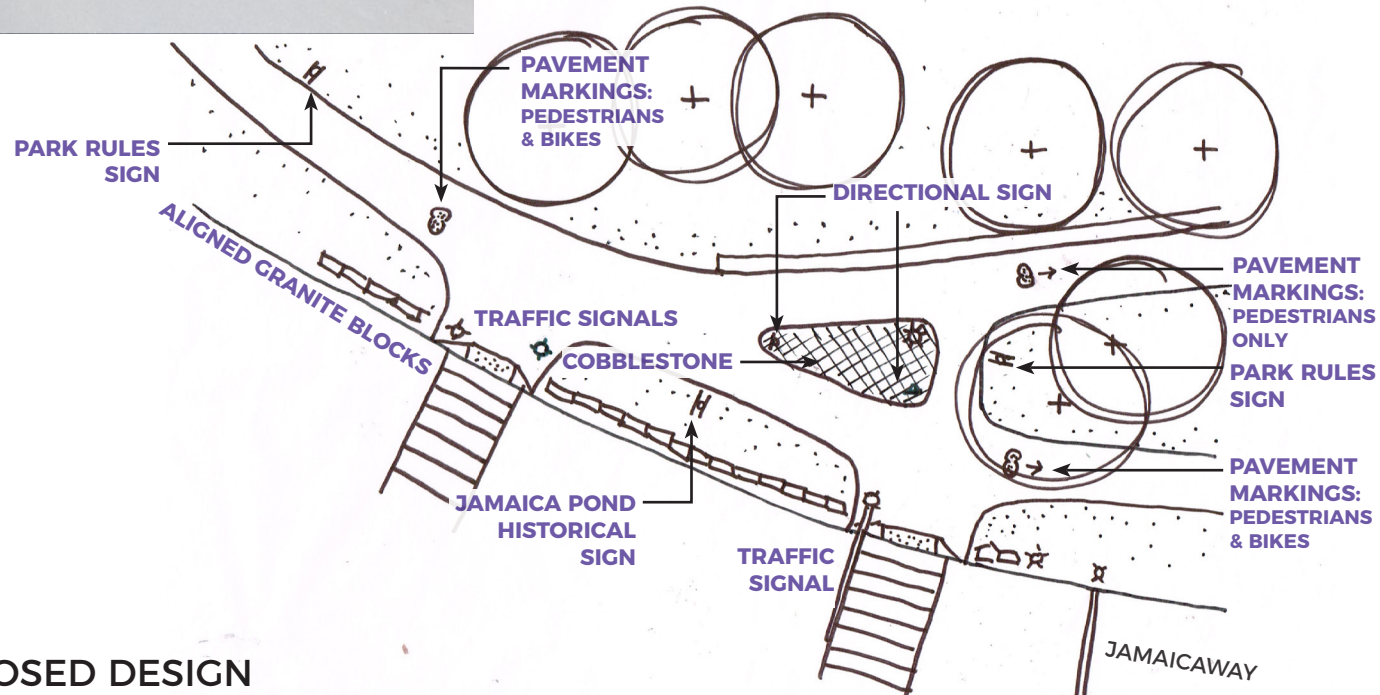

ELIOT STREET PROPOSED DESIGN

PARK ENTRANCES - PHASE 2

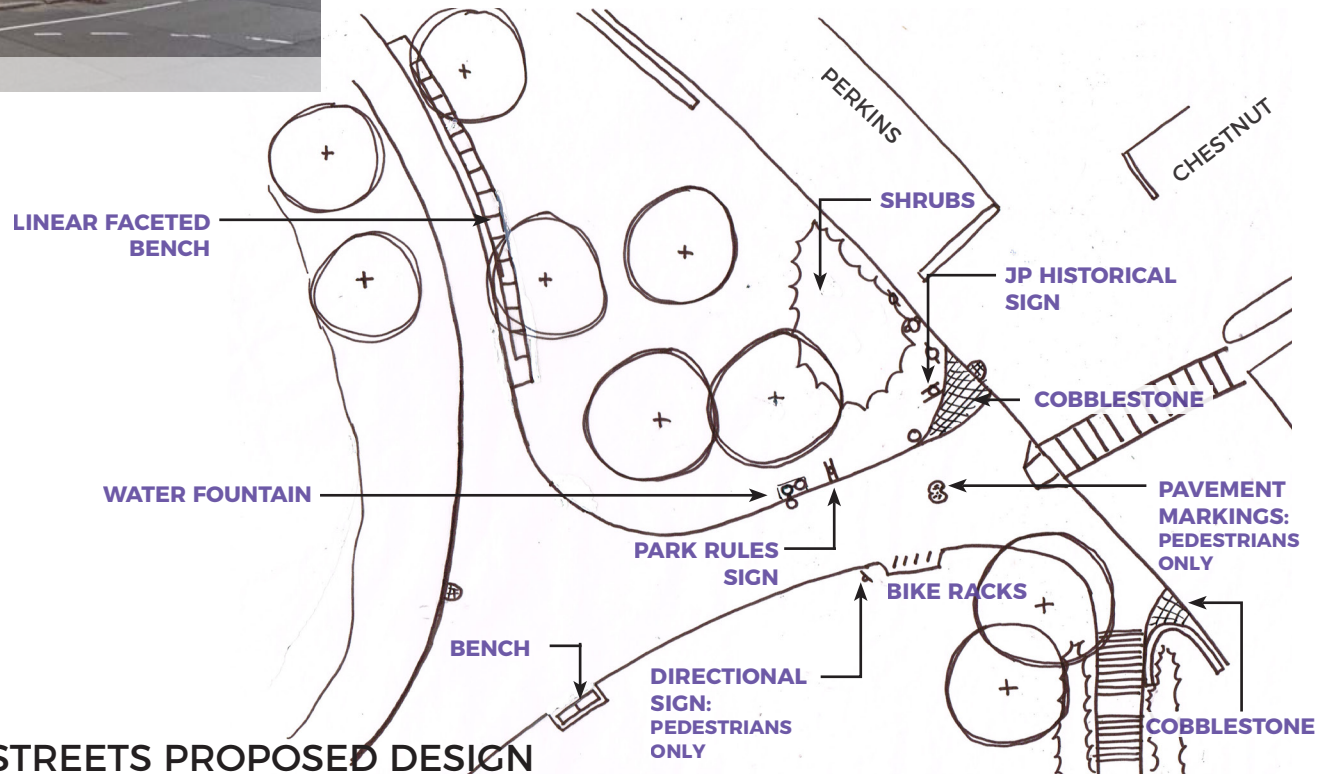

PERKINS & CHESTNUT STREETS PROPOSED DESIGN

PARK ENTRANCES - PHASE 2

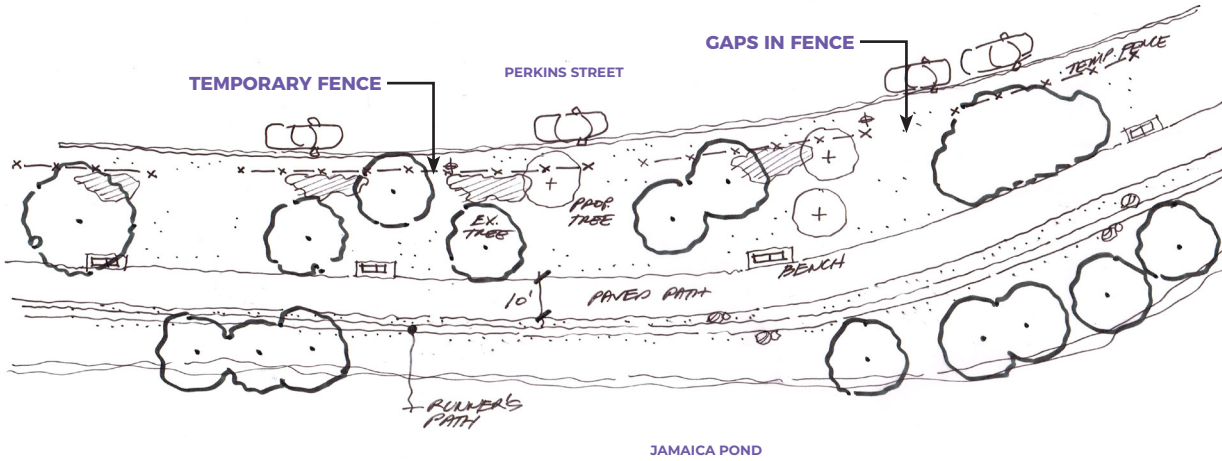

EXISTING CONDITION

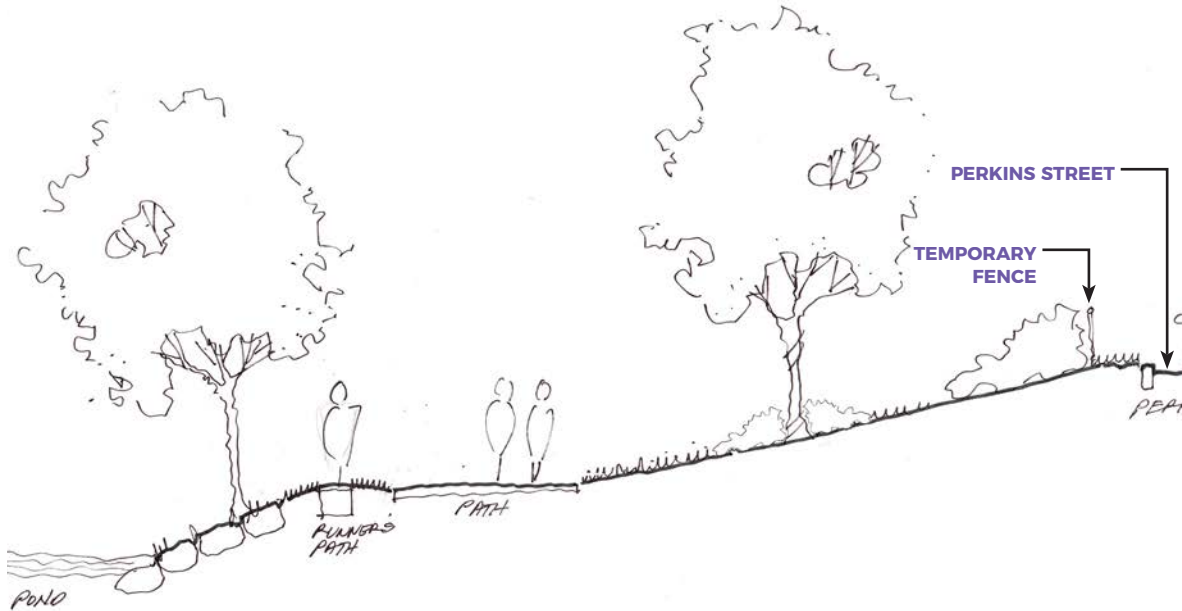

PERKINS STREET EDGE - PROPOSED DESIGN

STAIRCASES - PHASE 2



STAIRCASES - PHASE 2



EXISTING CONDITION

PERKINS AND CHESTNUT STREET

STAIRCASES - PHASE 2

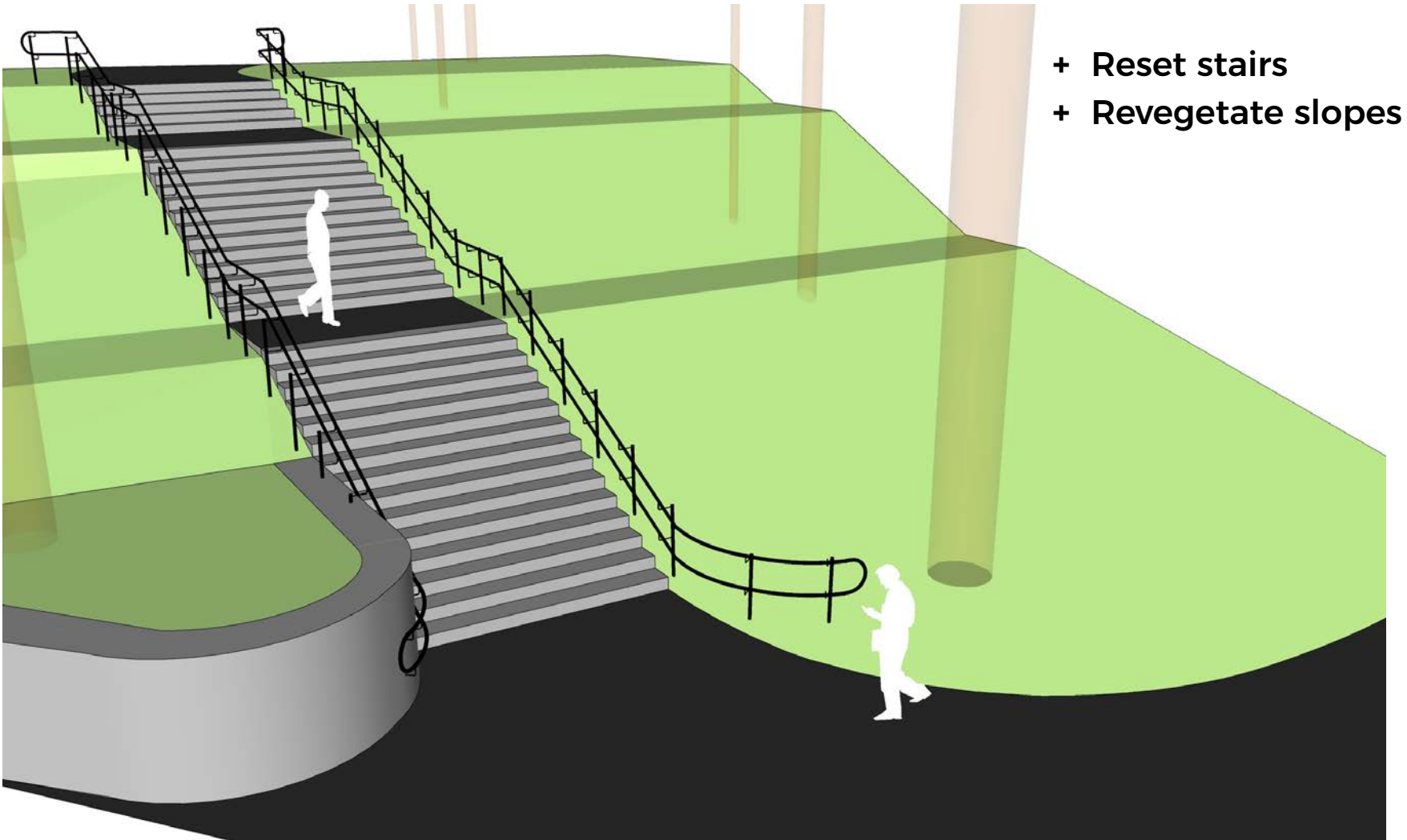

PERKINS AND CHESTNUT STREET - PROPOSED DESIGN

STAIRCASES - PHASE 2



EXISTING CONDITION

PUDDINGSTONE STAIRS



EXISTING STAIR TREADS

- **Reset stairs to preserve them**
- **Prune vegetation; Remove invasives**

STAIRCASES - PHASE 2



EXISTING CONDITION

POND STAIRS

STAIRCASES - PHASE 2

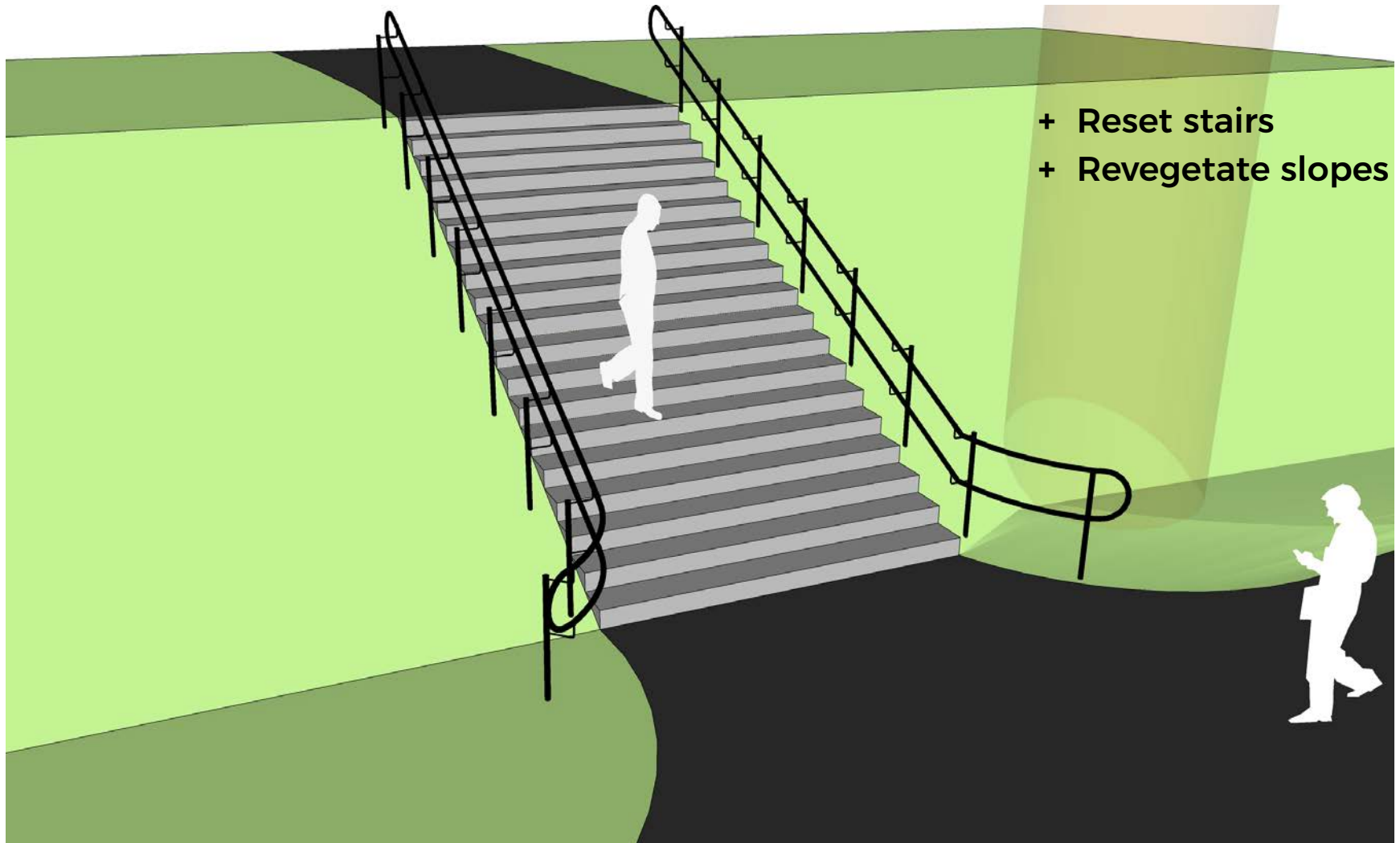

POND STAIRS - PROPOSED DESIGN

SITE FURNISHINGS - PHASE 2

CUSTOM STANCHION similar to the late 20th century bench design

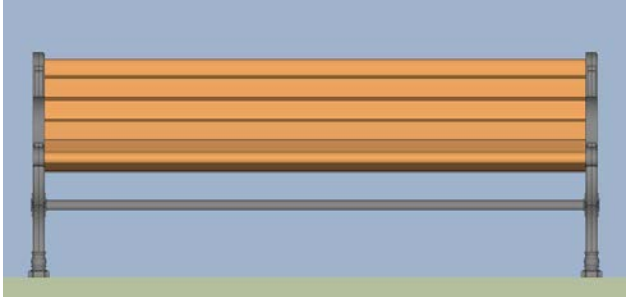

FRONT ELEVATION

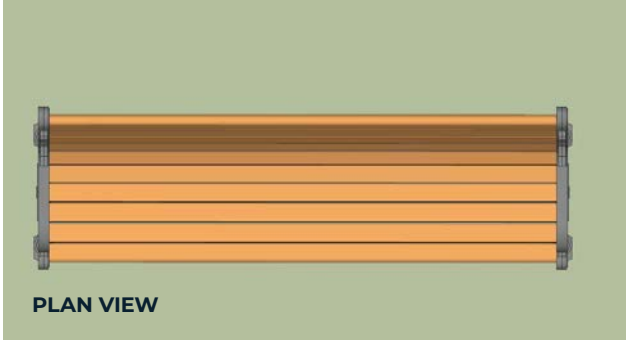

PLAN VIEW

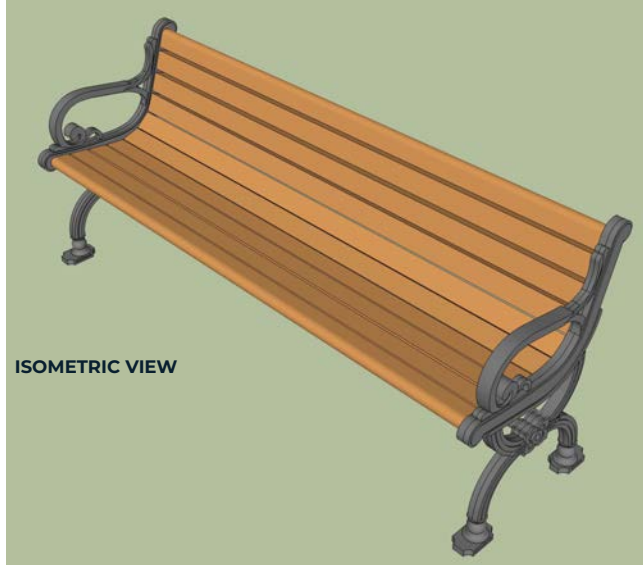

ISOMETRIC VIEW



SIDE ELEVATION



ORIGINAL STANCHION AT JAMAICA POND

SITE FURNISHINGS - PROPOSED

EXISTING:

59 BENCHES in 5 different styles

4 empty bench pads

PROPOSED:

61 BENCHES in uniform style

176 feet of LINEAR BENCHES

POTENTIAL:

35% INCREASE

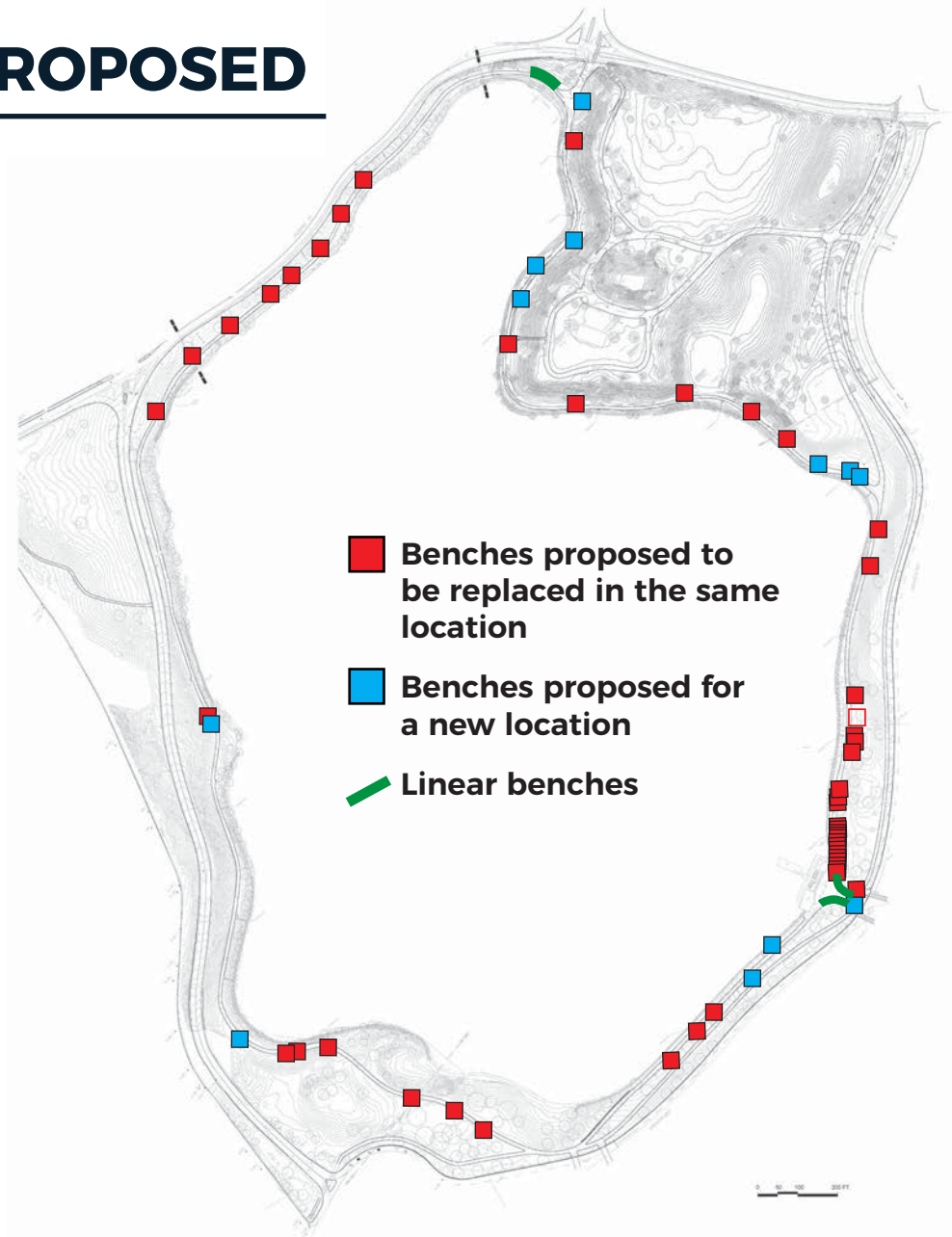

SITE FURNISHINGS - PROPOSED

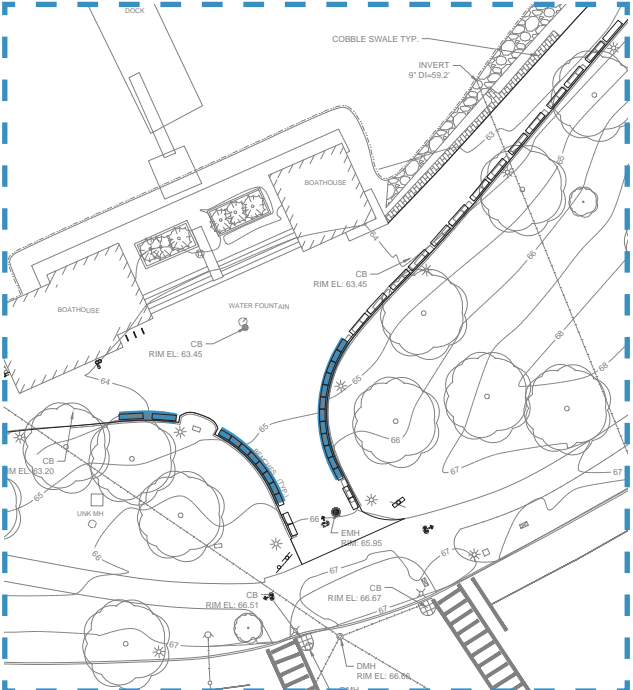
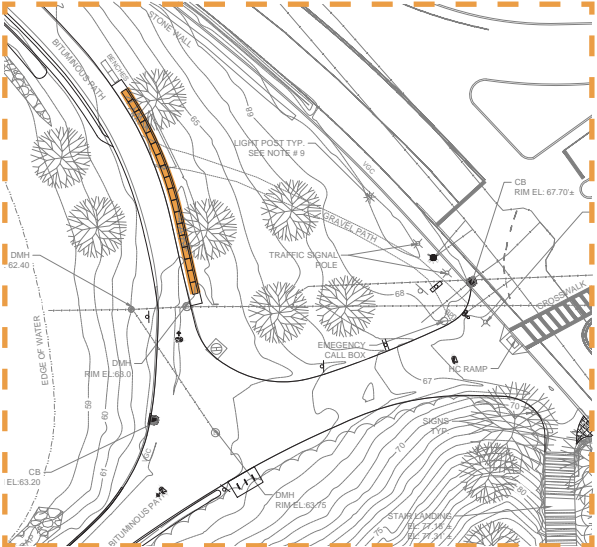
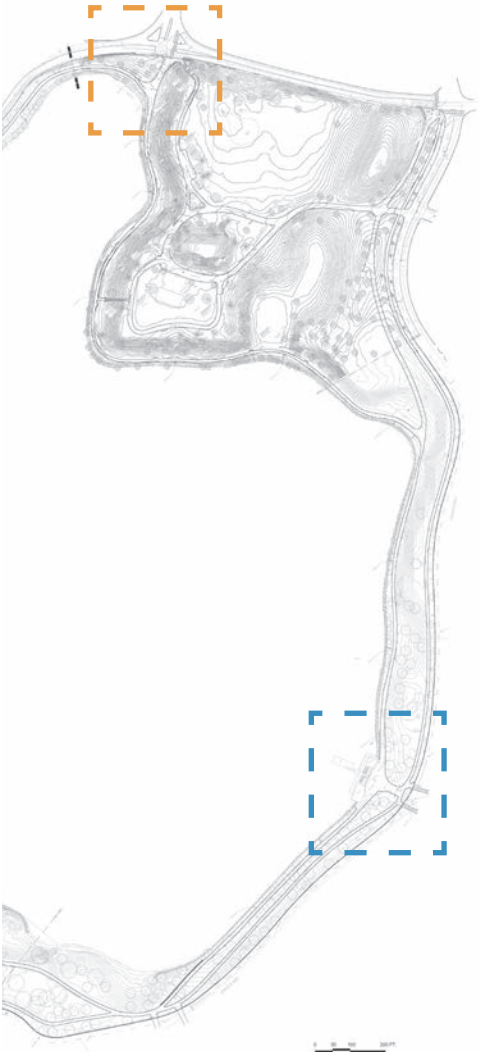

LINEAR BENCHES AT ENTRIES

SIGNAGE - PHASE 2



EXISTING SIGNAGE CONDITION

EXISTING PARK SIGNAGE

SIGNAGE - PHASE 2

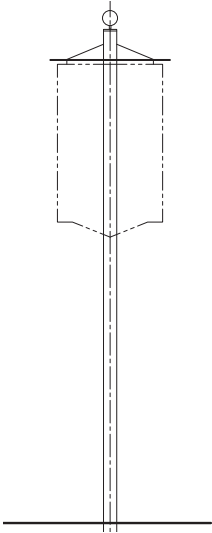

EMERALD NECKLACE
**JAMAICA
 POND**
 A DESIGNATED
 BOSTON LANDMARK
 ESTABLISHED
1892

VISITORS PLEASE TAKE NOTICE

*Please use trash barrels
 No motorized vehicles
 No alcoholic beverages
 Dogs on leash only
 Permit required for organized events
 Park hours- down to dusk
 No smoking- \$250.00 fine*



Public take notice: per order of the Boston Parks Commission
 to appear on all signs and signs on all signs.

JAMAICA POND
 A DESIGNATED
 BOSTON LANDMARK

VISITORS PLEASE TAKE NOTICE

*Park hours- down to dusk
 No alcoholic beverages
 Dogs must be leashed
 Pick up after your dog
 No bicycling on pedestrian path
 No private boating
 No swimming or wading
 No ice skating
 Authorized vehicles only*

All violations may be punishable by \$50
 fine per occurrence.
 Per order of Parks Commission



Public take notice: per order of the Boston Parks Commission
 to appear on all signs and signs on all signs.

JAMAICA POND HISTORICAL SIGN

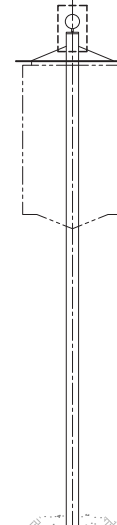

**PINEBANK
 PROMONTORY**

*Dogs must be leashed
 Pick up after your dog
 No skateboarding or rollerblading
 No alcoholic beverages
 Please use trash barrels*



Public take notice: per order of the Boston Parks Commission
 to appear on all signs and signs on all signs.

PINEBANK PROMONTORY SIGN

UPDATED PARK SIGNAGE



**BOSTON
 PARKS &
 RECREATION**

Enjoy Your Park

Visitors Please Take Notice

- Park closes at dusk unless otherwise posted
- No alcoholic beverages
- No vehicular access
- No skateboarding, rollerskating or bicycling
- Dogs on leashes only
- Clean up after your dog

NO SMOKING - \$250.00 FINE!



Park users are subject to the rules and regulations of the Boston Parks Commission.
 For inquiries regarding this park, please call 311-1
 In case of emergency, please call 911.

PARK RULES SIGN



**BOSTON
 PARKS &
 RECREATION**

Disfruta Tu Parque

Visitantes, atención por favor

*Este parque cierra al atardecer a menos que se indique lo contrario.
 Prohibido el consumo de bebidas alcohólicas.
 Prohibido el uso de vehículos de motor.
 Prohibido el uso de patineta,
 patines, o bicicletas.
 Perros sujetos con collar y correa solamente.
 Favor de limpiar el excremento de su perro.*

NO FUMAR - \$250.00 MULTA



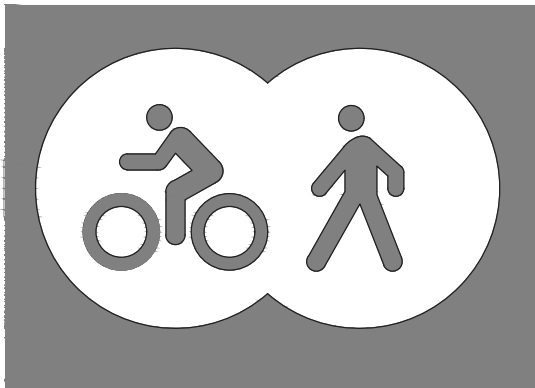
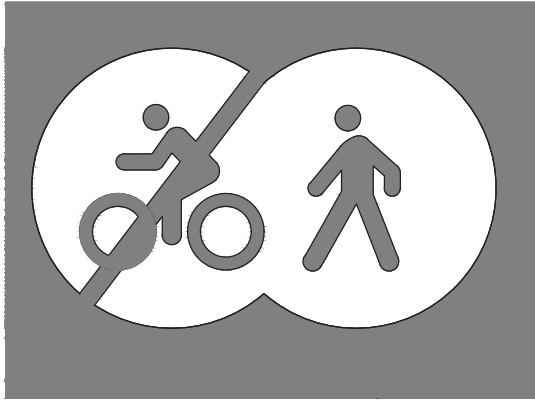

El parque está sujeto a las reglas y regulaciones de la Comisión de Recreación de Boston.
 Para preguntas relacionadas con este parque, por favor llame al 311-1.
 En caso de una emergencia, por favor llame al 911.

SIGNAGE - PHASE 2

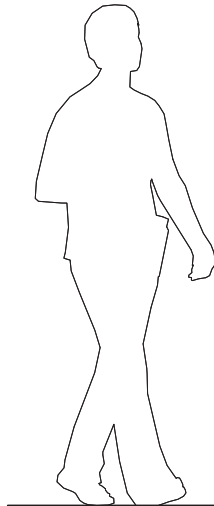

PAVEMENT MARKINGS



DIRECTIONAL SIGN POSTS

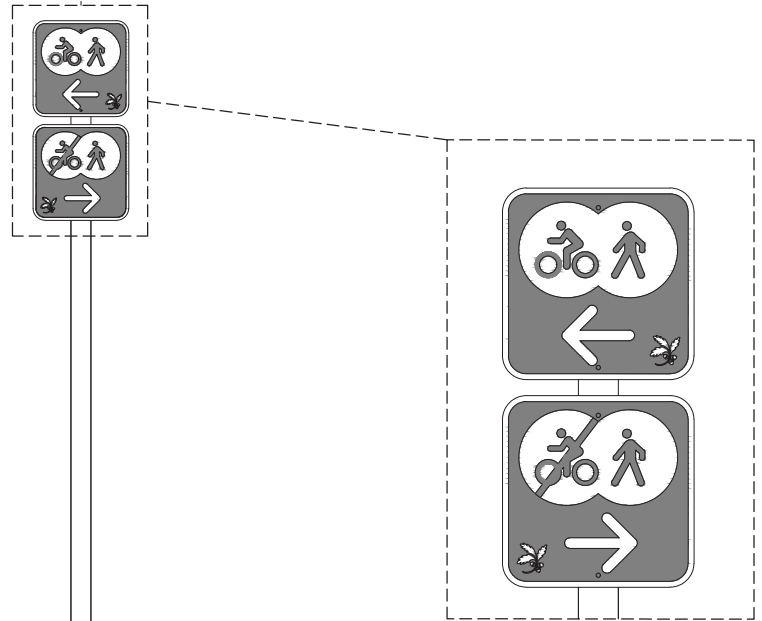

NEW DIRECTIONAL SIGNAGE

VEGETATION - INVASIVES AND RESTORATION



VEGETATION MANAGEMENT

■ Primary Targets for Removal:

- Knotweed
- Tree of Heaven
- Norway Maple
- Black Locust
- Bittersweet
- Buckthorn

----- Restoration Goals

- Areas degraded from erosion or foot traffic
- Path edges
- Areas of fallen trees or tree removals

VEGETATION IN THE HISTORIC LANDSCAPE



Bank stabilizing vegetation, circa 1905



Shrubs behind benches
at boathouse and bandstand, circa 1920



Pond edge with open views, circa 1900



Shrubs behind benches
at Perkins & Chestnut Street entrance, 1900

VEGETATION - RESTORATION AREAS



CHESTNUT/PERKINS STAIRS



POND STAIRS



FALLEN TREES ON HILLSIDE



FALLEN TREES ON HILLSIDE



SLOPE BELOW BALLFIELD

VEGETATION RESTORATION AREAS

VEGETATION - RESTORATION AREAS



PERKINS STREET SLOPE



EXISTING POND BANK



POND STREET ENTRANCE

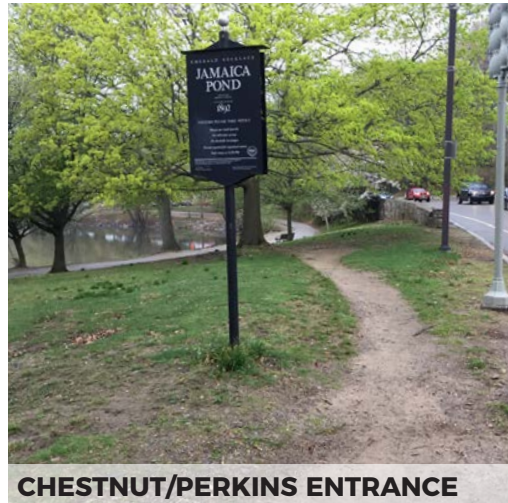

CHESTNUT/PERKINS ENTRANCE



EXISTING POND BANK

VEGETATION RESTORATION AREAS

VEGETATION - SAMPLE PLANTING

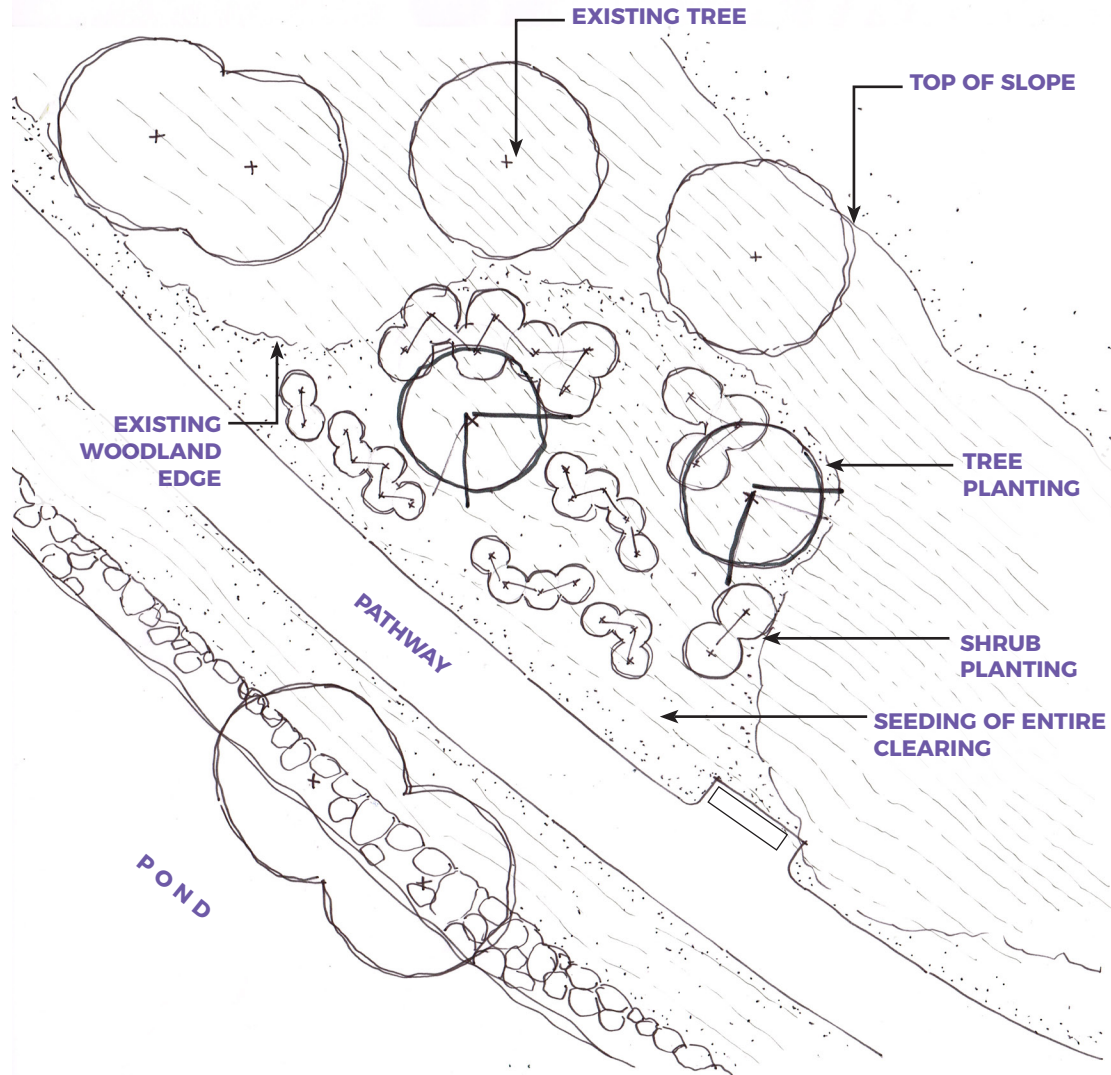

Sample planting:

- Plant species selected from Olmsted palette
- Native species
- 1-2 trees
- Selection of large & smaller shrubs
- Seeding with species to aid with slope stabilization

VEGETATION RESTORATION AREAS: SAMPLE PLANTING ARRANGEMENT FOR A SLOPE

VEGETATION - PLANT PALETTE



Black Tupelo



Tuliptree



Willow (multiple species)



Swamp White Oak



Sassafras



Hackberry

POTENTIAL PALETTE: CANOPY TREES

VEGETATION - PLANT PALETTE



POTENTIAL PALETTE: SMALL TREES

VEGETATION - PLANT PALETTE



Red Chokeberry



Sweetfern



St. Johnswort



Sweet Pepperbush



Fragrant Sumac

POTENTIAL PALETTE: SHRUBS

VEGETATION - PLANT PALETTE



EXISTING BOATHOUSE PLANTINGS



EXISTING BOATHOUSE PLANTINGS



Dwarf sweet pepperbush



Redtwig dogwood



New England aster



Northern sea oats

POTENTIAL PALETTE: BOATHOUSE RAIN GARDENS



Butterfly weed

FEEDBACK - ACCESSIBLE FISHING

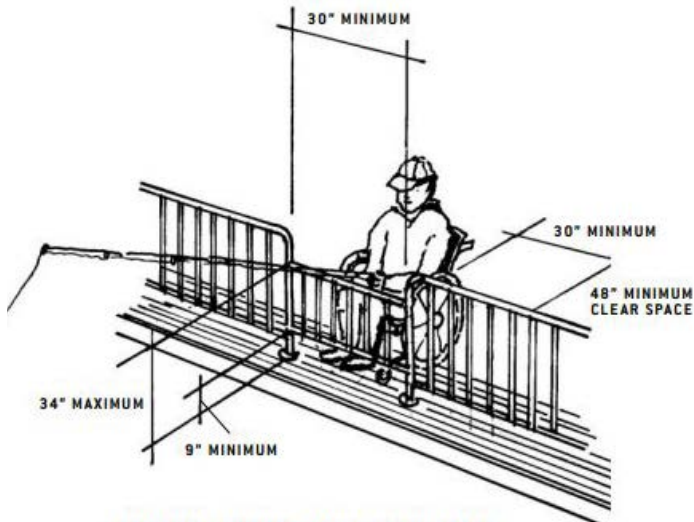
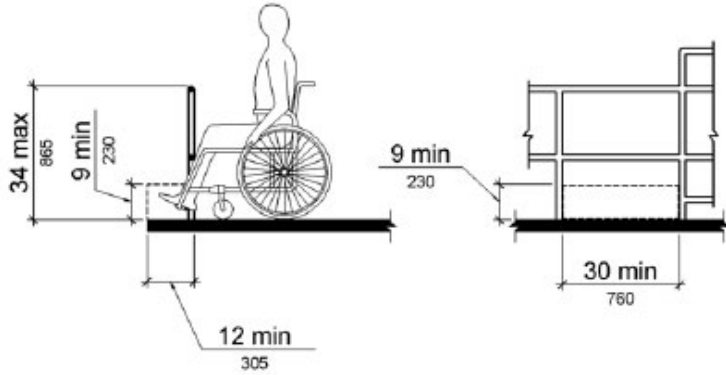

RAILING HEIGHTS AND CLEAR SPACE

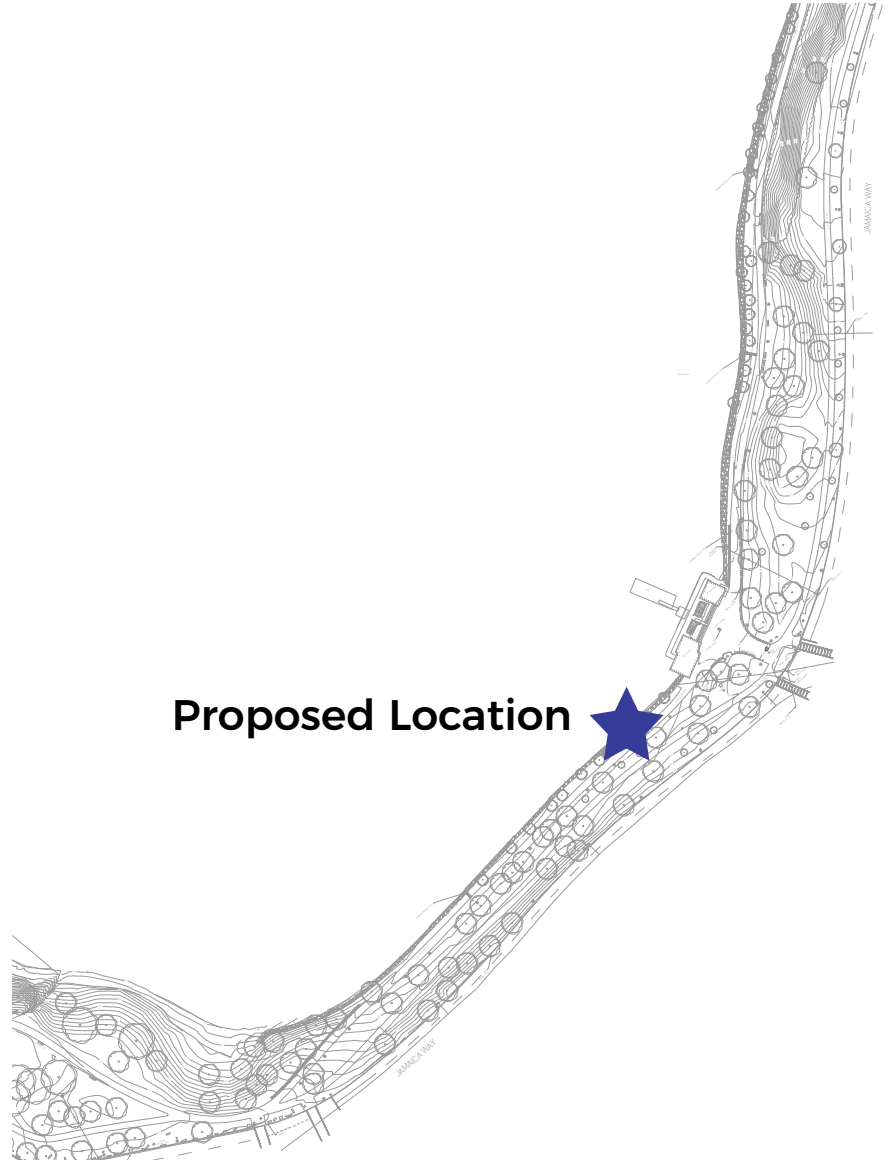

PROJECT SCHEDULE - PHASE 2 CONSTRUCTION

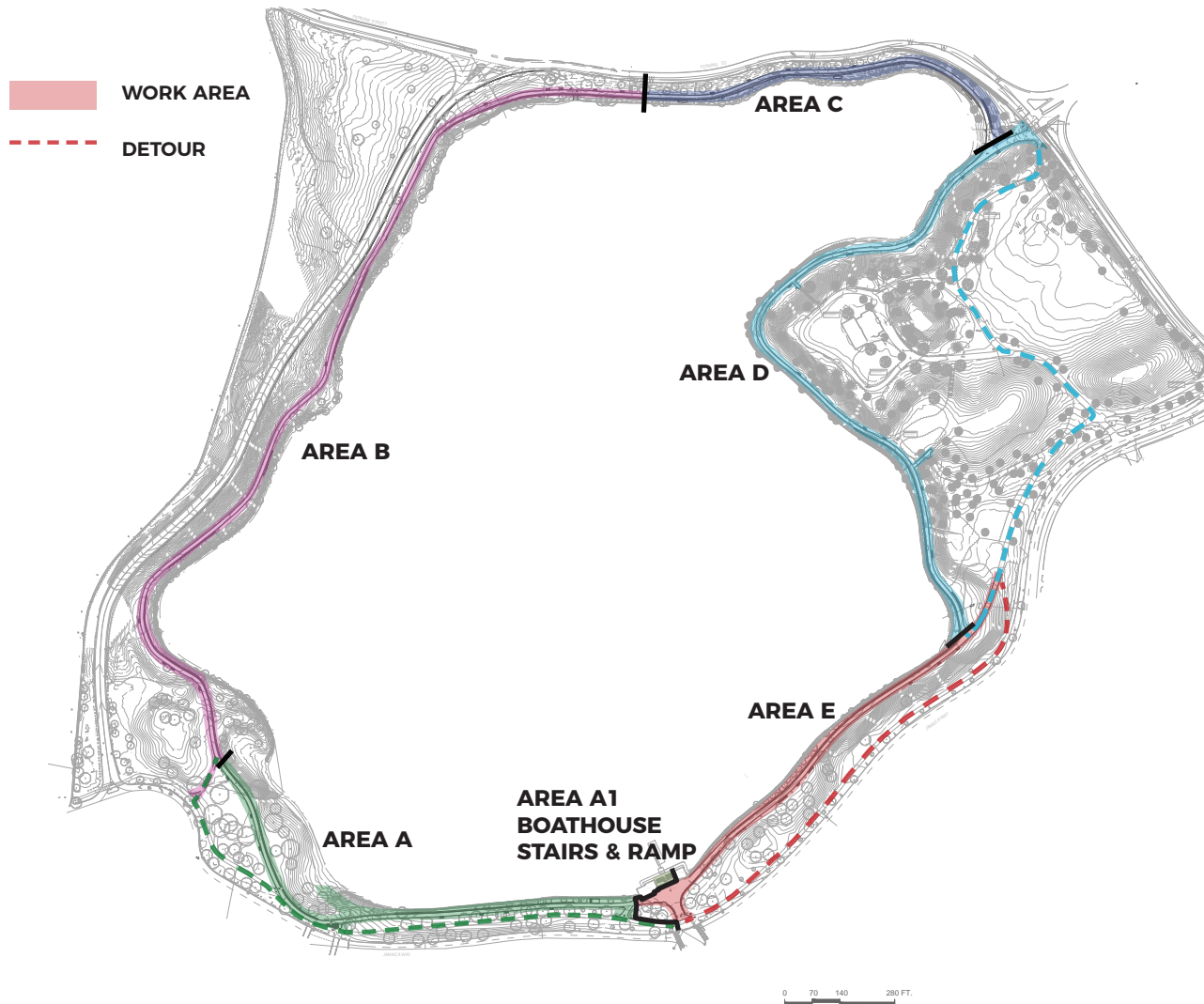

Areas A, D & E

- **Detours will be made available during construction**

Areas B & C

- **No detours available; area will be closed during construction**



LISTENING & DISCUSSION

Help us build great parks.
Let us know what matters to you.



THANK YOU!

See the project website for future updates.

For questions, maintenance requests or
concerns regarding any of our
parks contact 311

